

F.A.P. RTE.	SECTION	COUNTY	TOTAL SHEETS	SHEET NO.
704	(UN & TS-1)	McLEAN	497	103
STA. 2+200.000		TO STA. 2+450.000		
FED. ROAD DIST. NO.		ILLINOIS FED. AID PROJECT		
CONTRACT NO. 70514				

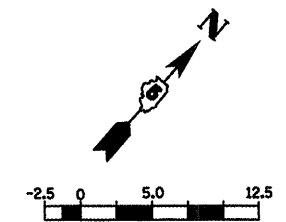

- 1:250  
LEGEND
- DRUM, BARRICADE OR VERTICAL BARRICADE WITH STEADY BURNING MONO DIRECTIONAL LIGHT
  - ↑ SIGN
  - ▨ WORK AREA
  - ▨ TEMPORARY PAVEMENT
  - ↔ DIRECTION OF TRAFFIC

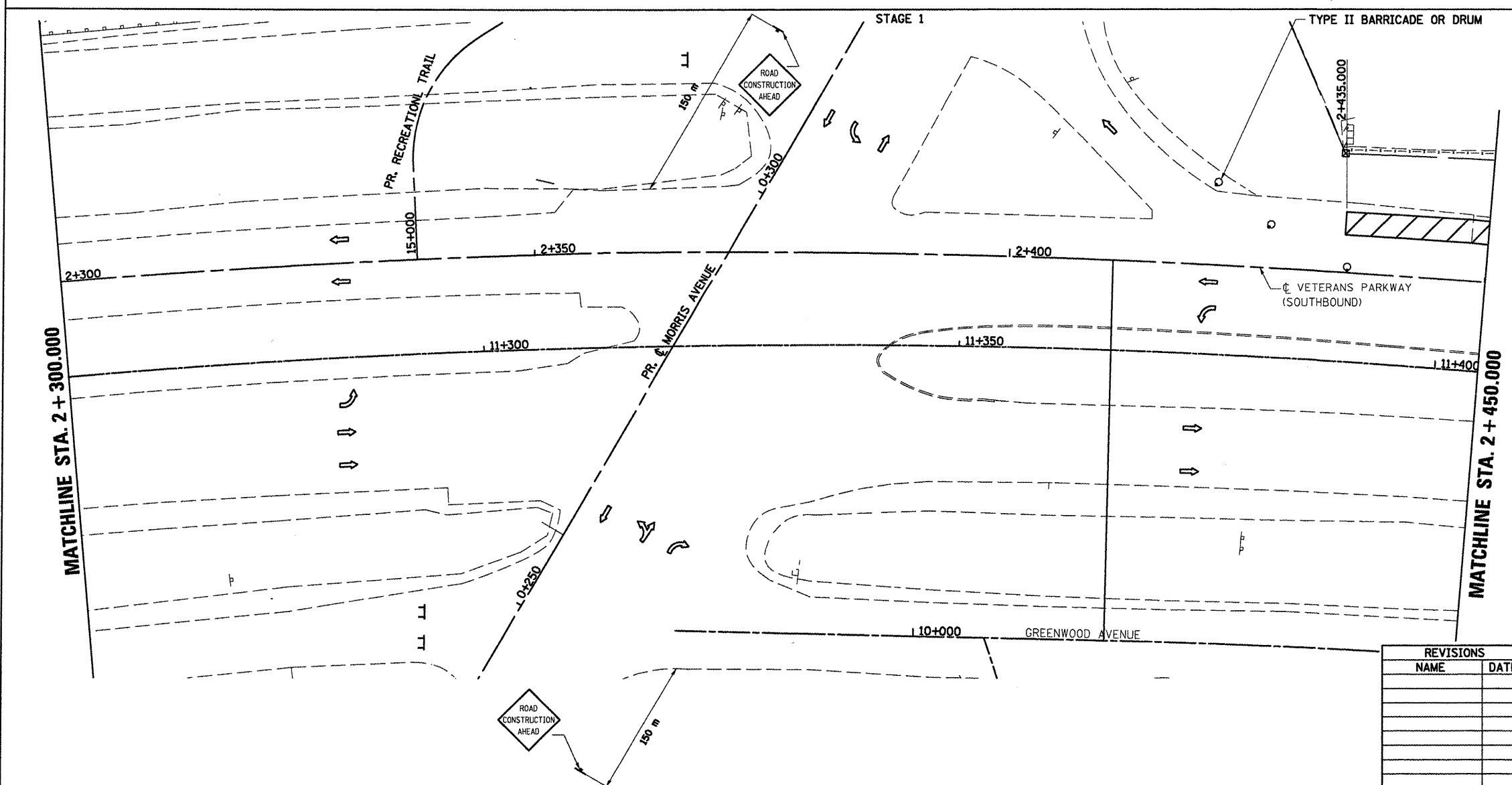
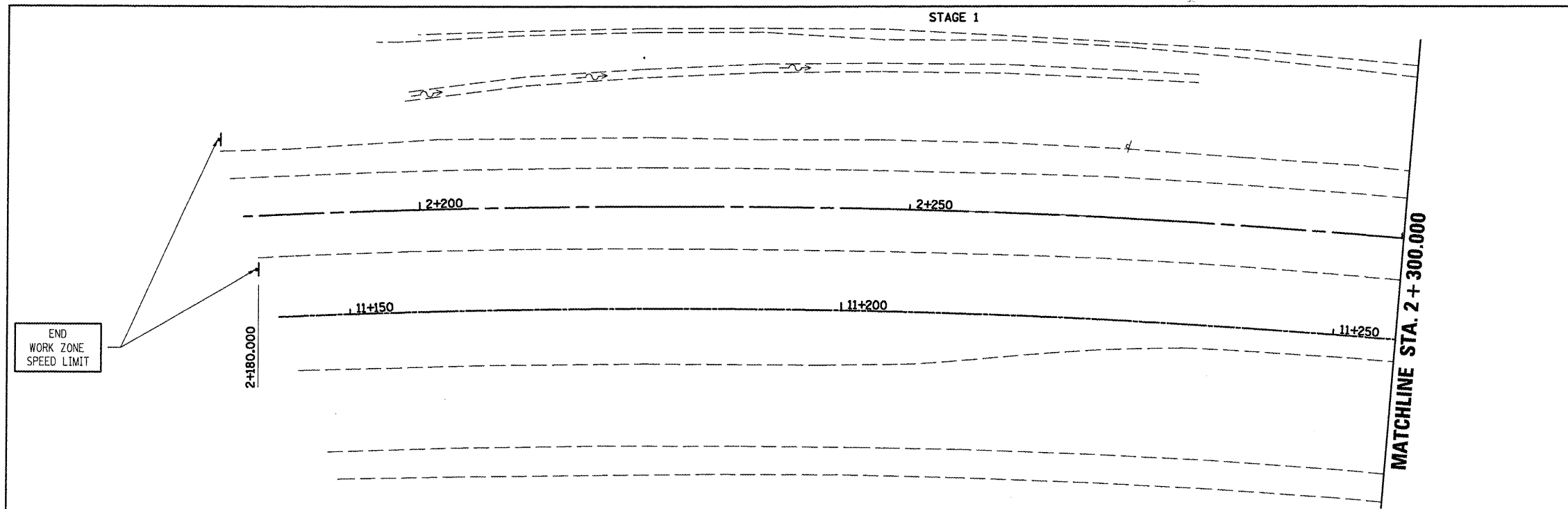

WORK TO BE COMPLETED IN STAGE I  
CONSTRUCT VETERANS PARKWAY PAVEMENT FROM  
STA. 2+435.000 TO STA. 3+050.000, LEFT.

SEE STANDARD 701422-01 FOR ADDITIONAL  
DETAILS.

VETERANS PARKWAY WORK ZONE SPEED LIMIT: 35  
MPH.

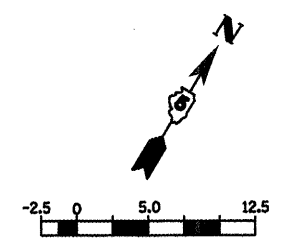

- 1:250  
LEGEND
- DRUM, OR BARRICADE WITH STEADY BURNING MONO DIRECTIONAL LIGHT
  - ↑ SIGN
  - ▨ WORK AREA
  - ▨ TEMPORARY PAVEMENT
  - FLEXIBLE DELINEATORS
  - ↔ DIRECTION OF TRAFFIC

PLOT DATE = 8/12/2009  
 PLOT SCALE = 1/8" = 100' IN.  
 USER NAME = draign

REVISIONS	
NAME	DATE

ILLINOIS DEPARTMENT OF TRANSPORTATION

STAGING PLANS  
STAGE 1 VETERANS PARKWAY

DRAWN BY SAM  
CHECKED BY PMH

DATE 05-27-09

**STAGING PLANS, STAGE 1 VETERANS PARKWAY**