

F.A.P. RTE.	SECTION	COUNTY	TOTAL SHEETS	SHEET NO.
704	(UN & TS-1	MCLEAN	497	108
STA. 0+850.000		TO STA. 1+097.343		
FED. ROAD DIST. NO.	ILLINOIS FED. AID PROJECT		CONTRACT NO. 70514	

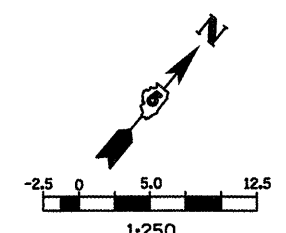

- LEGEND**
- TT TYPE III BARRICADE
 - SIGN
 - ▨ WORK AREA
 - ⇨ DIRECTION OF TRAFFIC

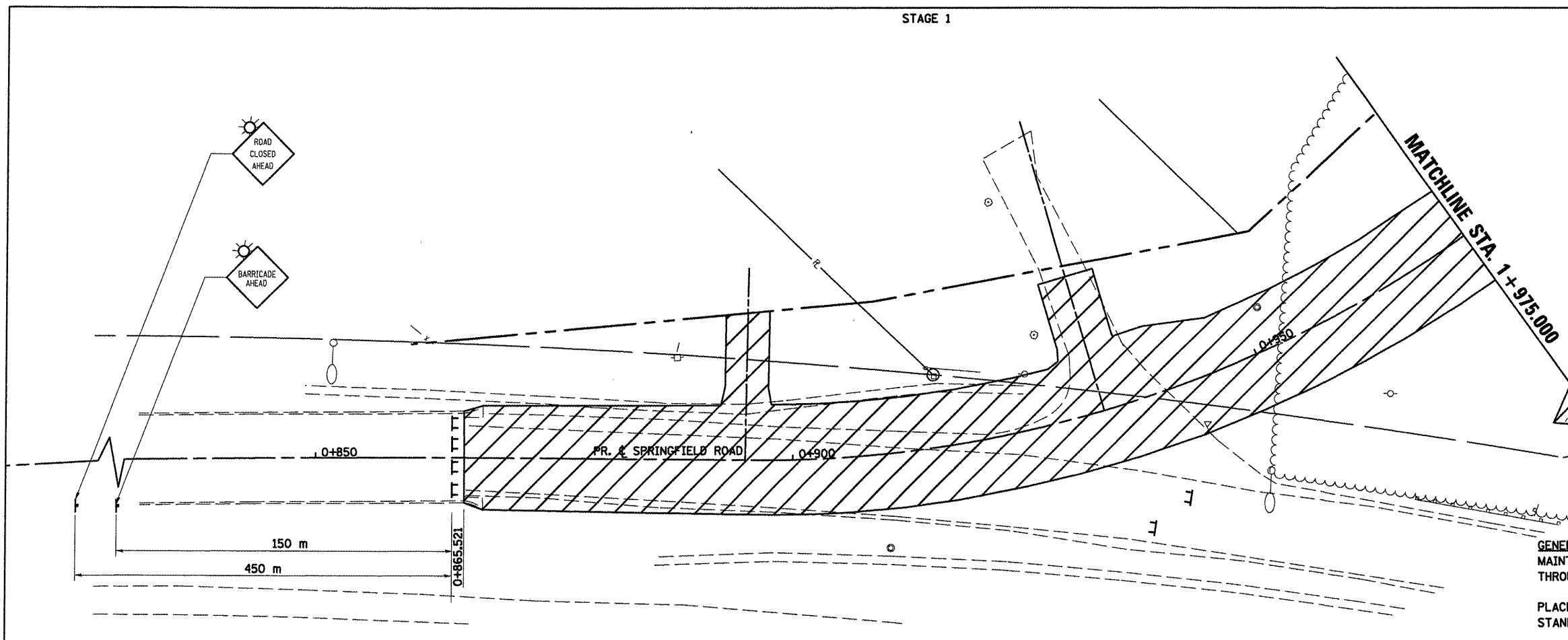

GENERAL STAGING NOTES
 MAINTAIN ACCESS TO ALL ADJACENT PROPERTIES THROUGHOUT THE DURATION OF THE PROJECT.

PLACE TYPE III BARRICADES IN ACCORDANCE WITH STANDARD 701901.

PROVIDE TEMPORARY MAILBOX SERVICE

WORK TO BE COMPLETED IN STAGE I
 CONSTRUCT 1950 mm CULVERT FROM SOUTH OF SIX POINTS ROAD TO VETERANS PARKWAY

CONSTRUCT SPRINGFIELD ROAD FROM STA. 0+865.521 TO STA. 1+065.

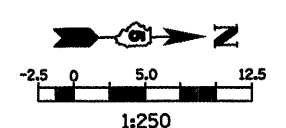

- LEGEND**
- SIGN
 - ▨ WORK AREA
 - ⇨ DIRECTION OF TRAFFIC

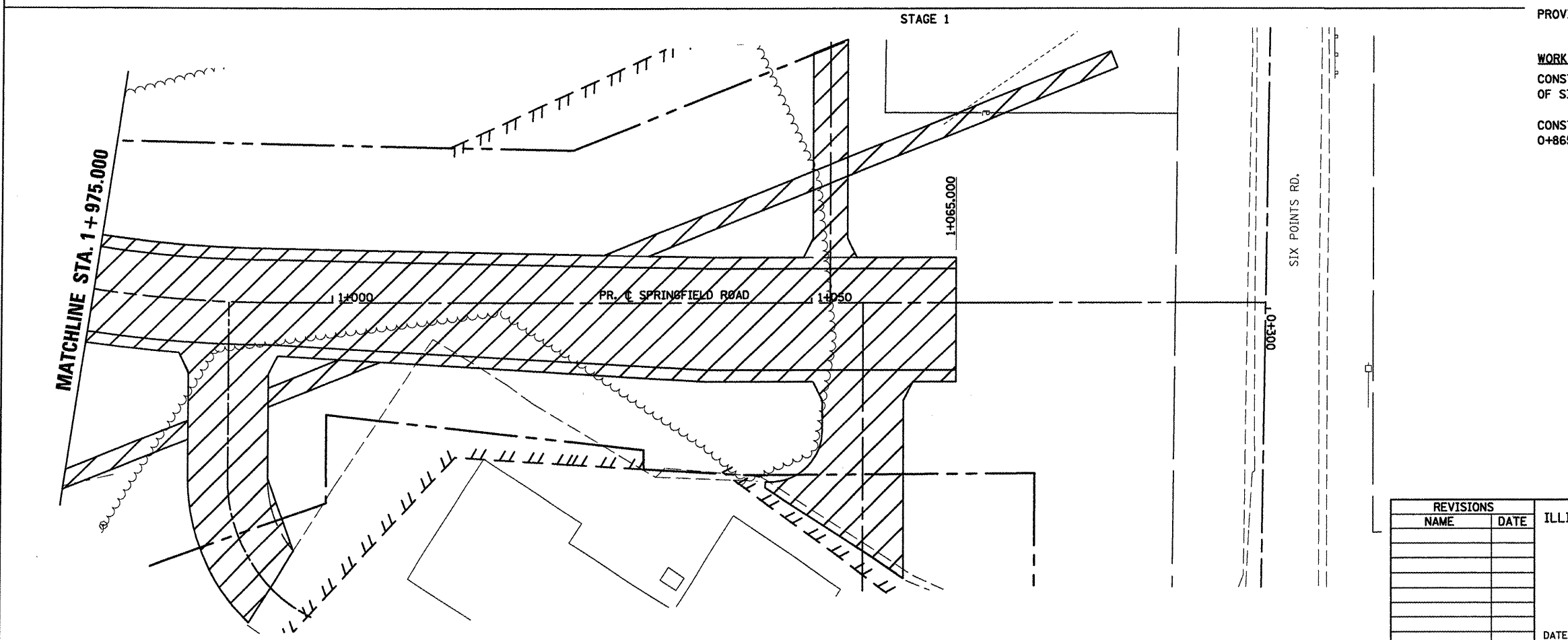

REVISIONS	
NAME	DATE

ILLINOIS DEPARTMENT OF TRANSPORTATION

STAGING PLANS
STAGE 1 SPRINGFIELD ROAD (WEST)

DRAWN BY SAM
 CHECKED BY PMH
 DATE 05-27-09

PLOT DATE = 8/22/09
 FILE NAME = \\pds01\projects\70514\stage1\staging\stage1.dwg
 PLOT SCALE = 1:250
 USER NAME = craig

STAGING PLANS, STAGE 1 SPRINGFIELD ROAD (WEST)