

F.A.P. RTE.	SECTION	COUNTY	TOTAL SHEETS	SHEET NO.
704	(LN & TS-1)	McLEAN	497	110
STA. 10+000.000		TO STA. 10+300.000		
FED. ROAD DIST. NO.	ILLINOIS FED. AID PROJECT		CONTRACT NO. 70514	

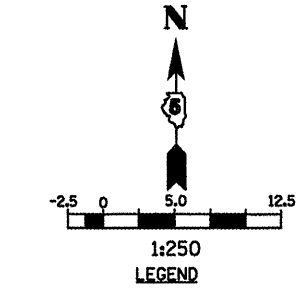

↑ SIGN
 ⇨ DIRECTION OF TRAFFIC

GENERAL STAGING NOTES
 MAINTAIN ACCESS TO ALL ADJACENT PROPERTIES THROUGHOUT THE DURATION OF THE PROJECT.
 PLACE TYPE III BARRICADES IN ACCORDANCE WITH STANDARD 701901.
 PROVIDE TEMPORARY MAILBOX SERVICE.

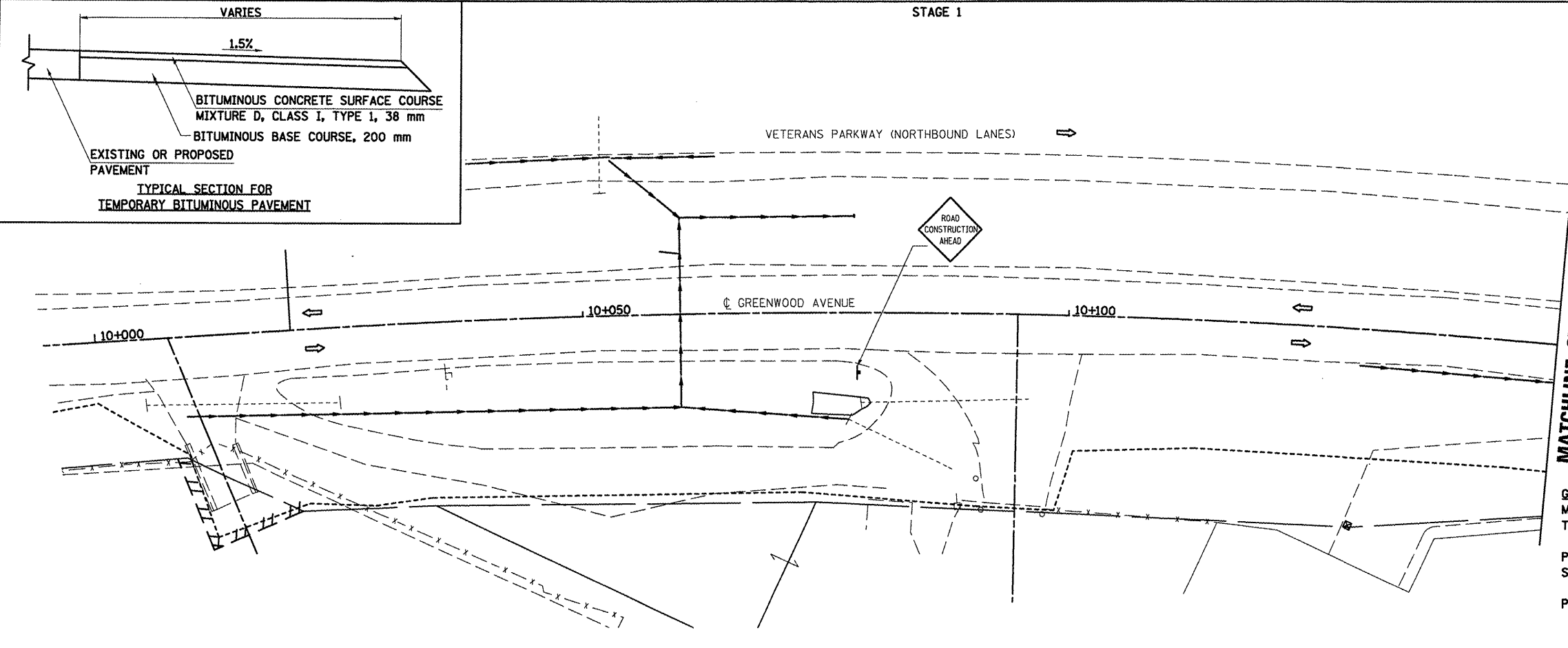
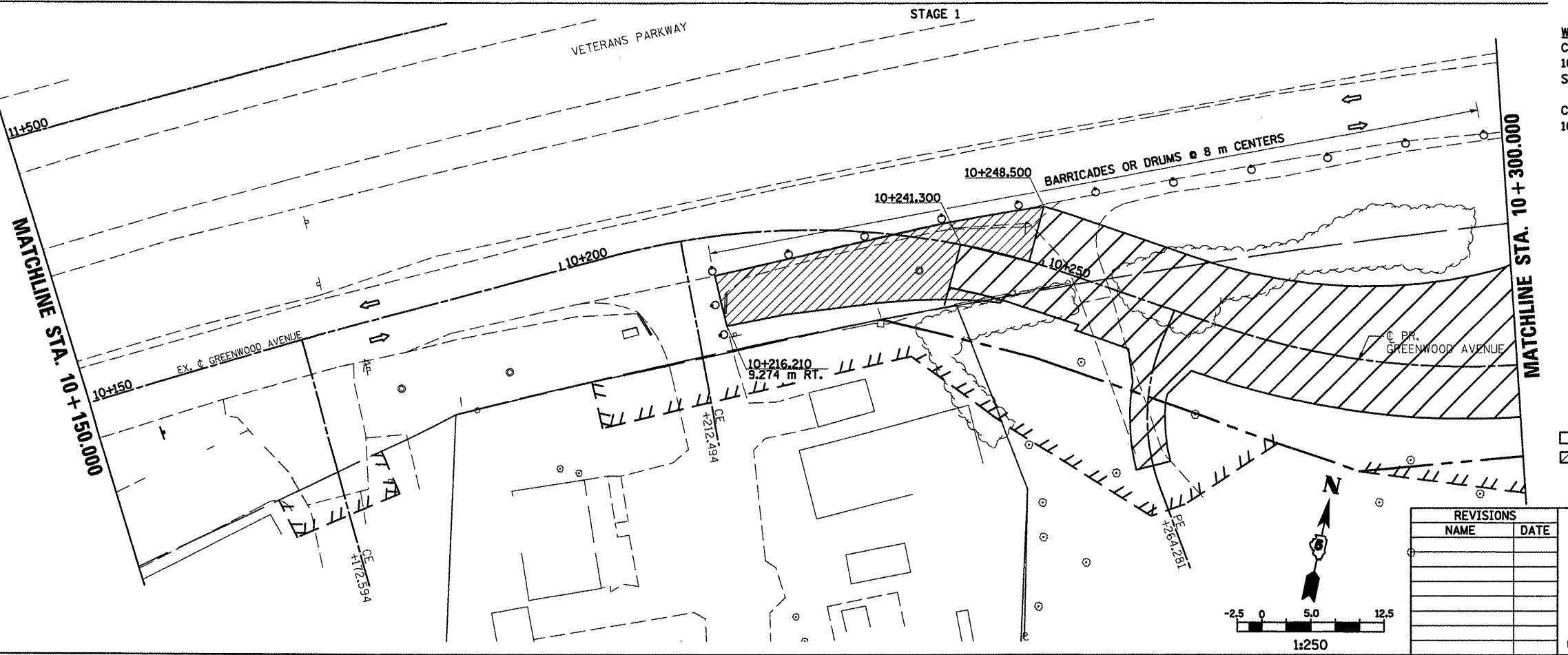

WORK TO BE COMPLETED IN STAGE 1
 CONSTRUCT FINAL PAVEMENT FROM STATION 10+241.3 RIGHT AND STATION 10+248.5 LEFT TO STATION 10+414.1 RIGHT AND 10+405.8 LEFT.
 CONSTRUCT TEMPORARY PAVEMENT FROM STATION 10+216.210 TO STA. 10+248.5.

LEGEND
 ↑ SIGN
 ○ DRUM, BARRICADE OR VERTICAL BARRICADE WITH STEADY BURNING LIGHT
 [Hatched Box] WORK AREA
 [Diagonal Lines Box] CONSTRUCT TEMPORARY PAVEMENT
 ⇨ DIRECTION OF TRAFFIC

REVISIONS	
NAME	DATE

ILLINOIS DEPARTMENT OF TRANSPORTATION
 STAGING PLANS
 STAGE 1 GREENWOOD AVENUE (EAST)
 DRAWN BY SAM
 CHECKED BY PMH
 DATE 05-27-09

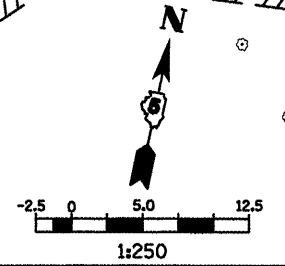

STAGING PLANS, STAGE 1 GREENWOOD AVENUE (EAST)

PLOT DATE = 6/12/2009
 PLOT SCALE = 1:2500
 USER NAME = crasgr