

F.A.P. RTE.	SECTION	COUNTY	TOTAL SHEETS	SHEET NO.
704	(LN & TS-1)	McLEAN	497	111
STA. 10+300.000		TO STA. 10+600.000		
FED. ROAD DIST. NO.		ILLINOIS FED. AID PROJECT		
CONTRACT NO. 70514				

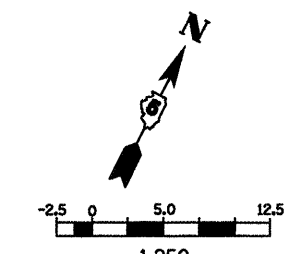

- LEGEND**
- TT TYPE III BARRICADE
  - T SIGN
  - DRUM, BARRICADE OR VERTICAL BARRICADE WITH STEADY BURNING LIGHT
  - ▨ WORK AREA
  - ▩ CONSTRUCT TEMPORARY PAVEMENT
  - ⇨ DIRECTION OF TRAFFIC

**GENERAL STAGING NOTES**  
 MAINTAIN ACCESS TO ALL ADJACENT PROPERTIES THROUGHOUT THE DURATION OF THE PROJECT.  
 PLACE TYPE III BARRICADES IN ACCORDANCE WITH STANDARD 701901.  
 PROVIDE TEMPORARY MAILBOX SERVICE

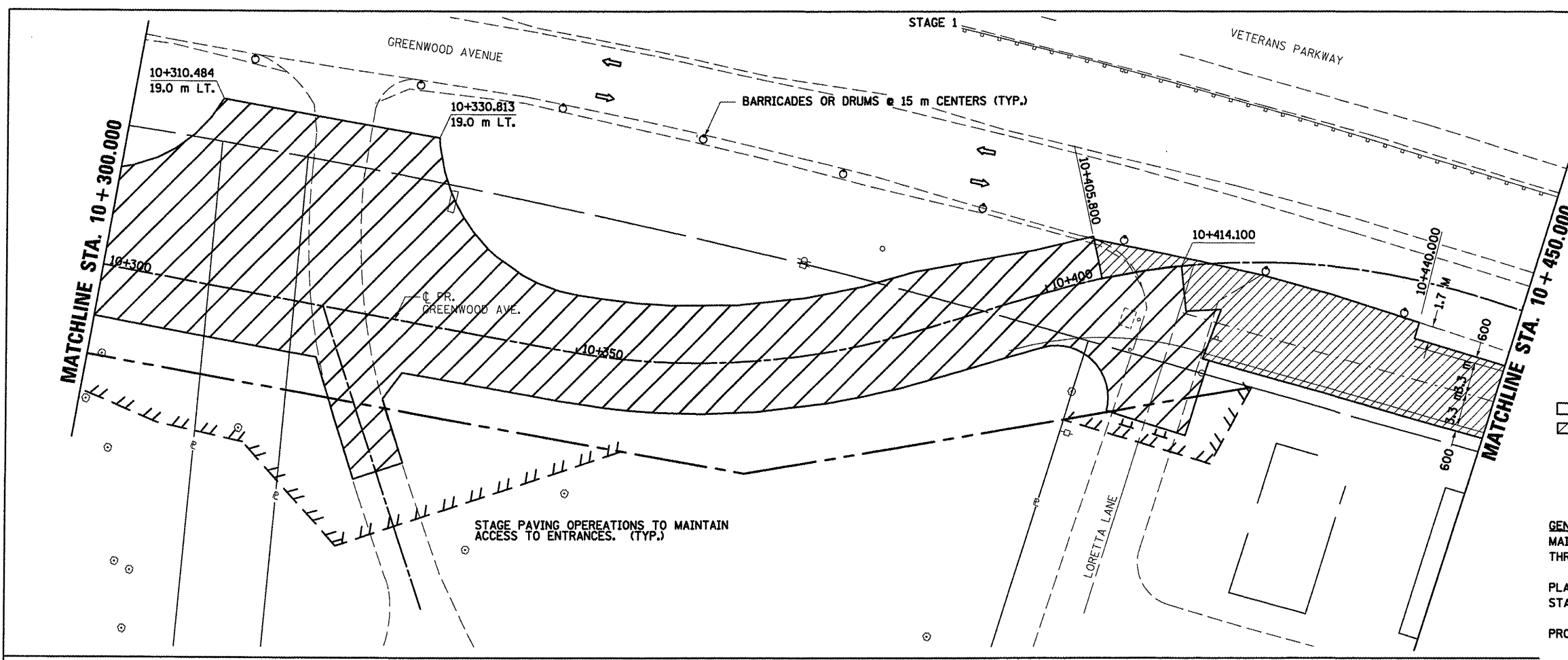

STAGE 1

**WORK TO BE COMPLETED IN STAGE 1**  
 CLOSE LORETTA LANE  
 CONSTRUCT FINAL PAVEMENT FROM STATION 10+241.3 RIGHT AND STATION 10+248.5 LEFT TO STATION 10+414.1 RIGHT AND 10+405.8 LEFT.  
 CONSTRUCT TEMPORARY PAVEMENT FROM STATION 10+414.1 RIGHT AND STATION 10+399.73 LEFT TO STATION 10+631.2.

- LEGEND**
- T SIGN
  - DRUM, BARRICADE OR VERTICAL BARRICADE WITH STEADY BURNING LIGHT
  - ▨ WORK AREA
  - ▩ CONSTRUCT TEMPORARY PAVEMENT
  - ⇨ DIRECTION OF TRAFFIC

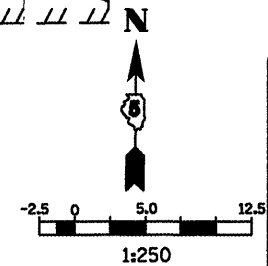
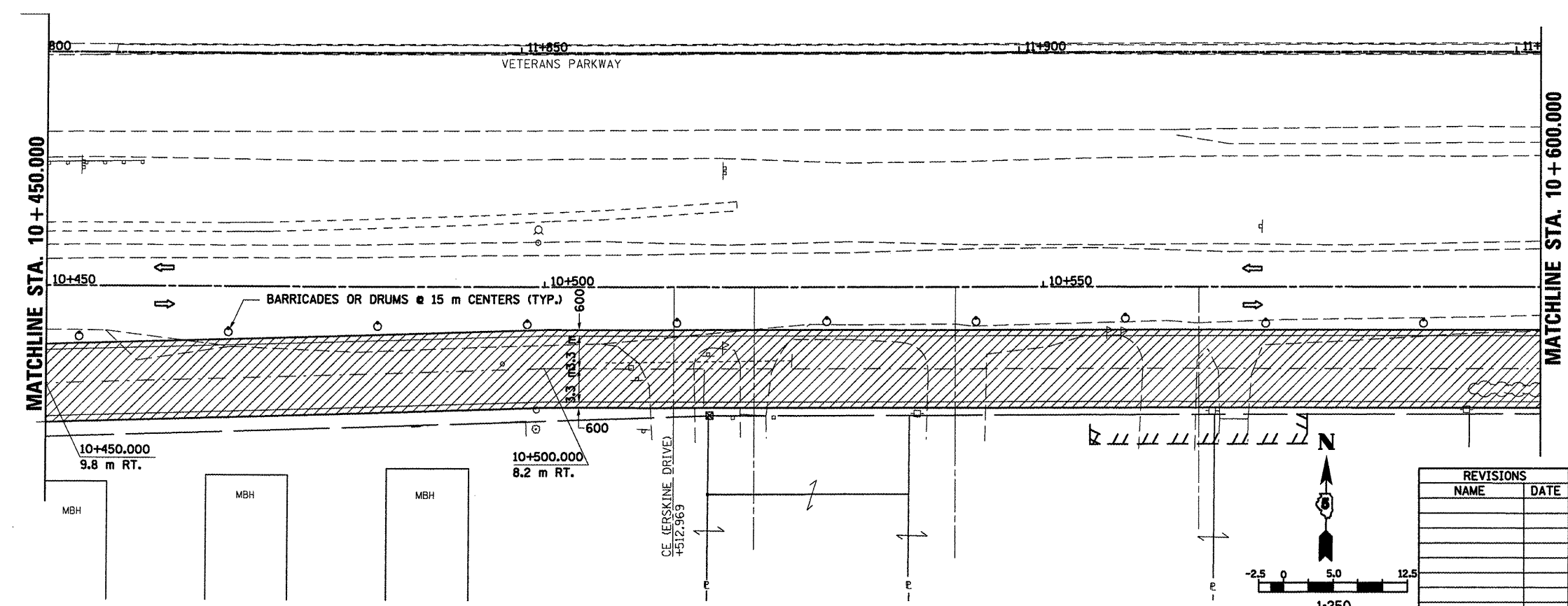

REVISIONS	
NAME	DATE

ILLINOIS DEPARTMENT OF TRANSPORTATION  
 STAGING PLANS  
 STAGE 1 GREENWOOD AVENUE (EAST)  
 DRAWN BY SAM  
 CHECKED BY PMH  
 DATE 05-27-09

PLOT DATE = 6/12/2009  
 FILE NAME = c:\pva\work\projects\70514\stage1\stage1.dwg  
 PLOT SCALE = 1:250  
 USER NAME = cregg

**STAGING PLANS, STAGE 1 GREENWOOD AVENUE (EAST)**