

F.A.P. RTE.	SECTION	COUNTY	TOTAL SHEETS	SHEET NO.
704	(1)N & TS-1	McLEAN	497	119
STA. 10+000.000		TO STA. 10+300.000		
FED. ROAD DIST. NO.		ILLINOIS FED. AID PROJECT		
CONTRACT NO. 70514				

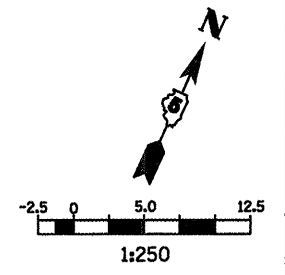

- LEGEND**
- ⊥ SIGN
 - DRUM, BARRICADE OR VERTICAL BARRICADE WITH STEADY BURNING LIGHT
 - ▨ WORK AREA
 - ⇨ DIRECTION OF TRAFFIC

GENERAL STAGING NOTES
 MAINTAIN ACCESS TO ALL ADJACENT PROPERTIES THROUGHOUT THE DURATION OF THE PROJECT.
 PLACE TYPE III BARRICADES IN ACCORDANCE WITH STANDARD 701901.
 PROVIDE TEMPORARY MAILBOX SERVICE.

WORK TO BE COMPLETED IN STAGE 2
 CONSTRUCT TEMPORARY PAVEMENT FROM STATION 9+994.000 TO STA. 10+216.210
 CONSTRUCT FINAL PAVEMENT FROM STATION 10+419.500 LEFT TO STATION 10+747 LEFT AND FROM STATION 10+449.000 RIGHT TO STATION 10+634.000 RIGHT.

- LEGEND**
- ⊥ TYPE III BARRICADE
 - ⊥ SIGN
 - DRUM, BARRICADE OR VERTICAL BARRICADE WITH STEADY BURNING LIGHT
 - ▨ WORK AREA
 - ▨ TEMPORARY PAVEMENT
 - ⇨ DIRECTION OF TRAFFIC

REVISIONS	
NAME	DATE

ILLINOIS DEPARTMENT OF TRANSPORTATION
 STAGING PLANS
 STAGE 2 GREENWOOD AVENUE (EAST)
 DRAWN BY SAM
 CHECKED BY PMH
 DATE 05-27-09

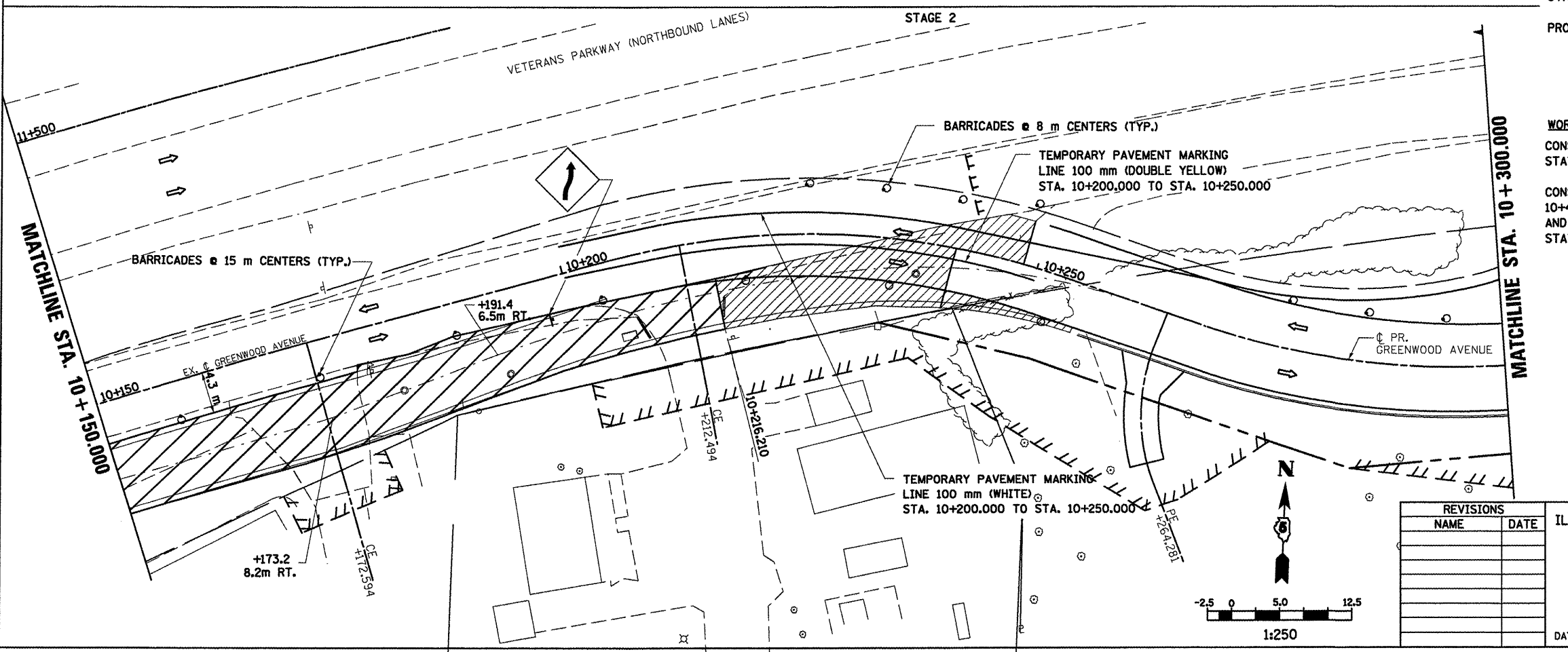
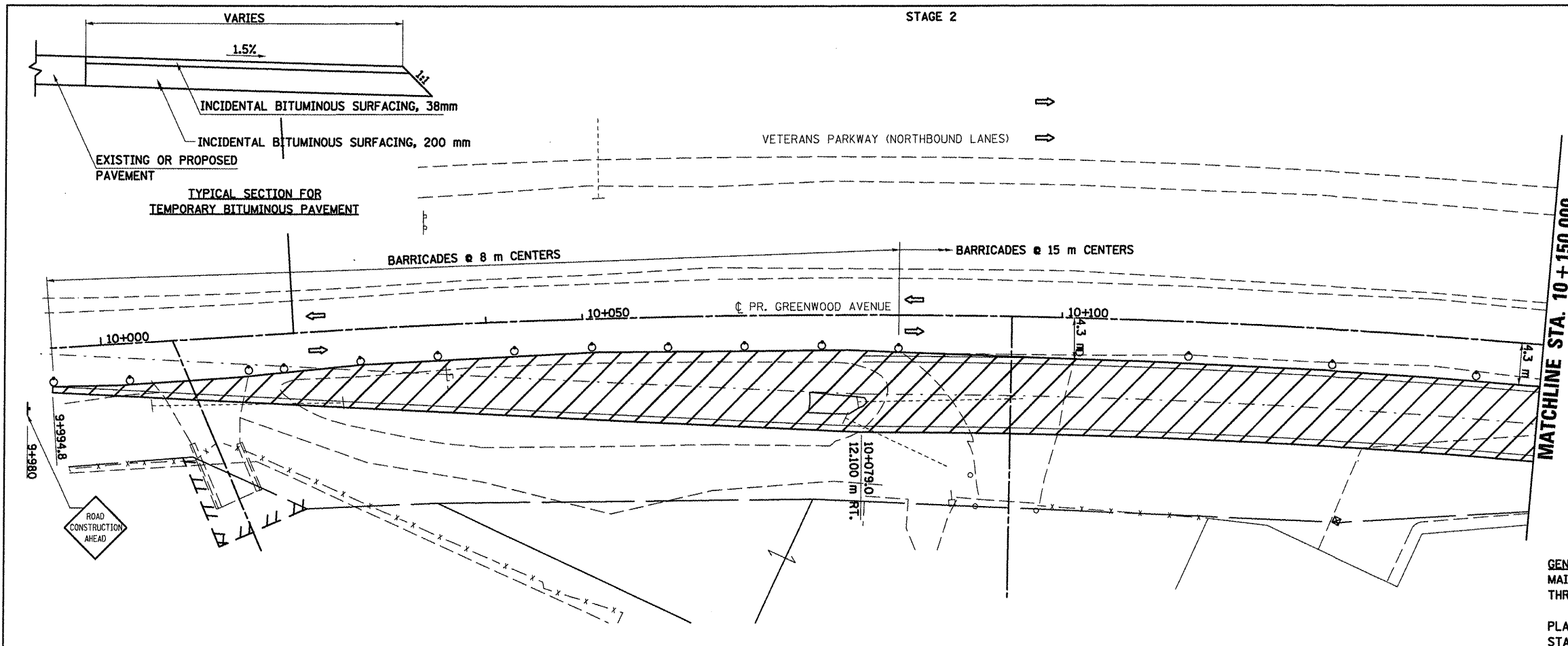

PLOT DATE = 6/10/09
 FILE NAME = \\s:\work\projects\70514\stage2\stage2.dwg
 PLOT SCALE = 1:250
 USER NAME = aseng

STAGING PLANS, STAGE 2 GREENWOOD AVENUE (EAST)