

F.A.P. RTE.	SECTION	COUNTY	TOTAL SHEETS	SHEET NO.
704	(1)N & TS-1	McLEAN	497	120
STA. 10+300.000		TO STA. 10+600.000		
FED. ROAD DIST. NO.	ILLINOIS FED. AID PROJECT		CONTRACT NO. 70514	

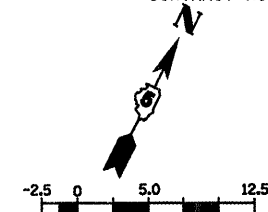

- LEGEND**
- TT TYPE III BARRICADE
 - ↑ SIGN
 - DRUM, BARRICADE OR VERTICAL BARRICADE WITH STEADY BURNING LIGHT
 - ▨ WORK AREA
 - ▩ TEMPORARY PAVEMENT
 - ↔ DIRECTION OF TRAFFIC

GENERAL STAGING NOTES
 MAINTAIN ACCESS TO ALL ADJACENT PROPERTIES THROUGHOUT THE DURATION OF THE PROJECT.
 PLACE TYPE III BARRICADES IN ACCORDANCE WITH STANDARD 701901.
 PROVIDE TEMPORARY MAILBOX SERVICE.

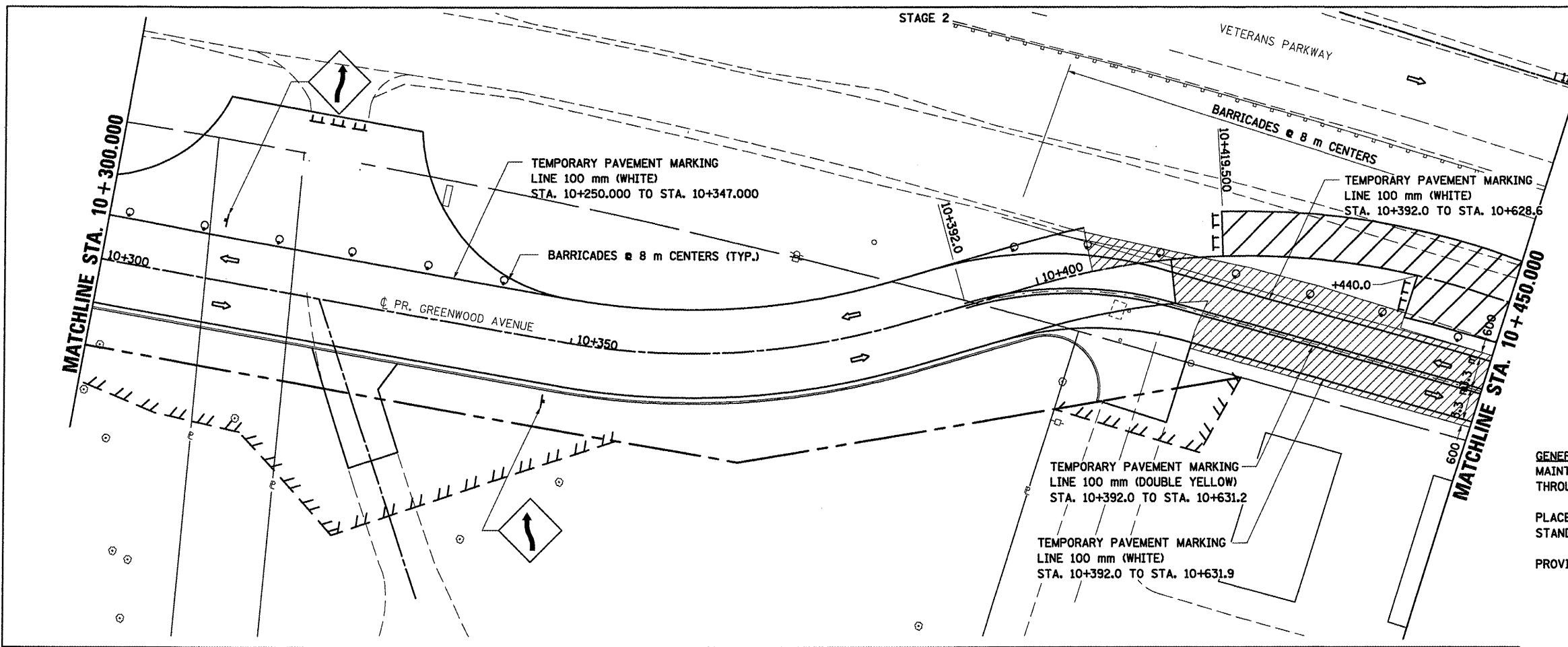

STAGE 2

WORK TO BE COMPLETED IN STAGE 2
 CONSTRUCT FINAL PAVEMENT FROM STATION 10+419.500 LEFT TO END OF CUL-DE-SAC AND FROM STATION 10+440.000 RIGHT TO STATION 10+634.000 RIGHT.

- LEGEND**
- ↑ SIGN
 - DRUM, BARRICADE OR VERTICAL BARRICADE WITH STEADY BURNING LIGHT
 - ▨ WORK AREA
 - ▩ TEMPORARY PAVEMENT
 - ↔ DIRECTION OF TRAFFIC

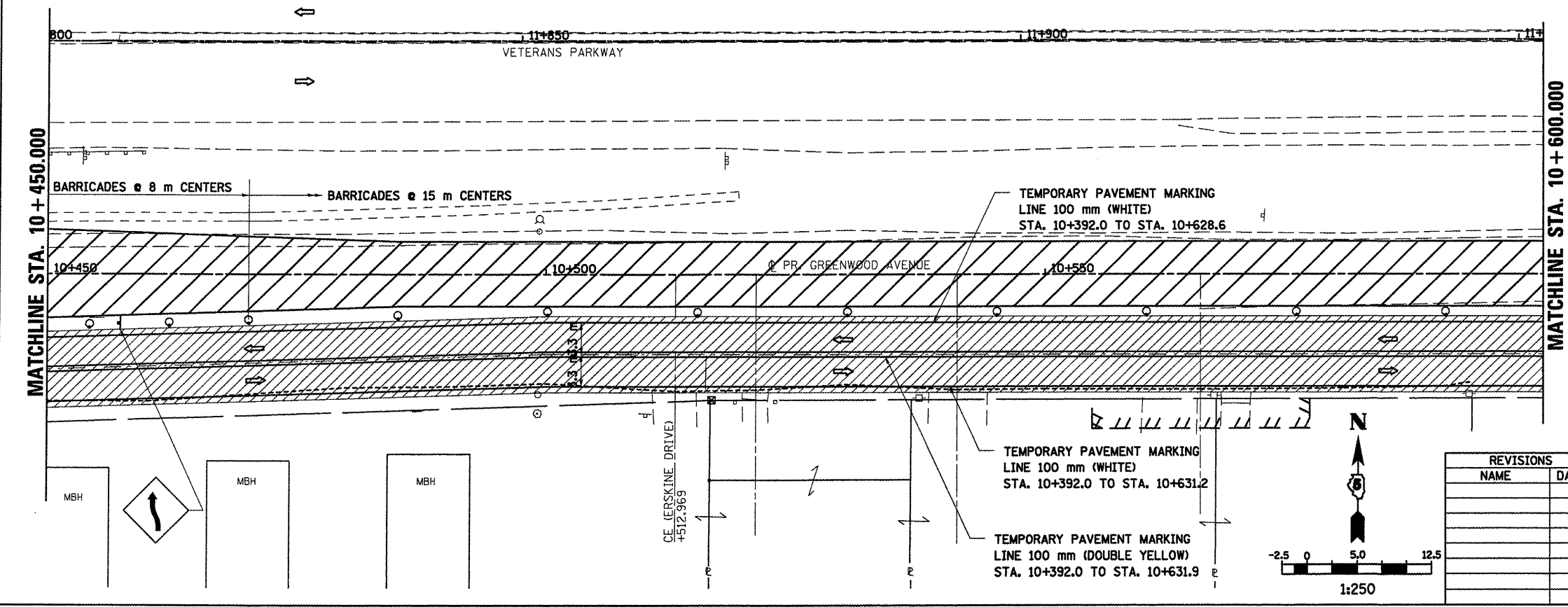

REVISIONS	
NAME	DATE

ILLINOIS DEPARTMENT OF TRANSPORTATION
 STAGING PLANS
 STAGE 2 GREENWOOD AVENUE (EAST)
 DRAWN BY SAM
 CHECKED BY PMH
 DATE 05-27-09

STAGING PLANS, STAGE 2 GREENWOOD AVENUE (EAST)

PLOT DATE = 8/12/2008
 FILE NAME = 0:\pav\work\staging\stage2\stage2.dwg
 PLOT SCALE = 1:250
 USER NAME = orange