

F.A.P. RTE.	SECTION	COUNTY	TOTAL SHEETS	SHEET NO.
704	(DN & TS-1)	McLEAN	497	123
STA. 2+200.000		TO STA. 2+450.000		
FED. ROAD DIST. NO.		ILLINOIS FED. AID PROJECT		
CONTRACT NO. 70514				

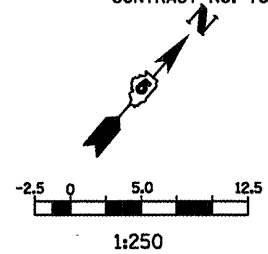

LEGEND

- SIGN
- DRUM, BARRICADE OR VERTICAL BARRICADE WITH STEADY BURNING LIGHT
- ▨ WORK AREA
- ⇨ DIRECTION OF TRAFFIC
- ⇨ DIRECTION INDICATOR BARRICADE WITH STEADY BURN MONODIRECTIONAL LIGHT

GENERAL STAGING NOTES

MAINTAIN ACCESS TO ALL ADJACENT PROPERTIES THROUGHOUT THE DURATION OF THE PROJECT.

PLACE TYPE III BARRICADES IN ACCORDANCE WITH STANDARD 702001.

WORK TO BE COMPLETED IN STAGE 3
 CONSTRUCT RIGHT TURN LANE, GUARDRAIL, AND INTERSECTION WITH GREENWOOD AVE. FROM STA. 2+500.00 TO STA. 2+760.500

SEE STANDARD 701422-01 FOR ADDITIONAL DETAILS.

WORK ZONE SPEED LIMIT 35 MPH.

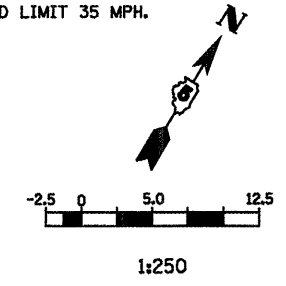

LEGEND

- TT TYPE III BARRICADE
- SIGN
- DRUM, OR BARRICADE WITH STEADY BURNING LIGHT
- ▨ WORK AREA
- ⇨ DIRECTION OF TRAFFIC

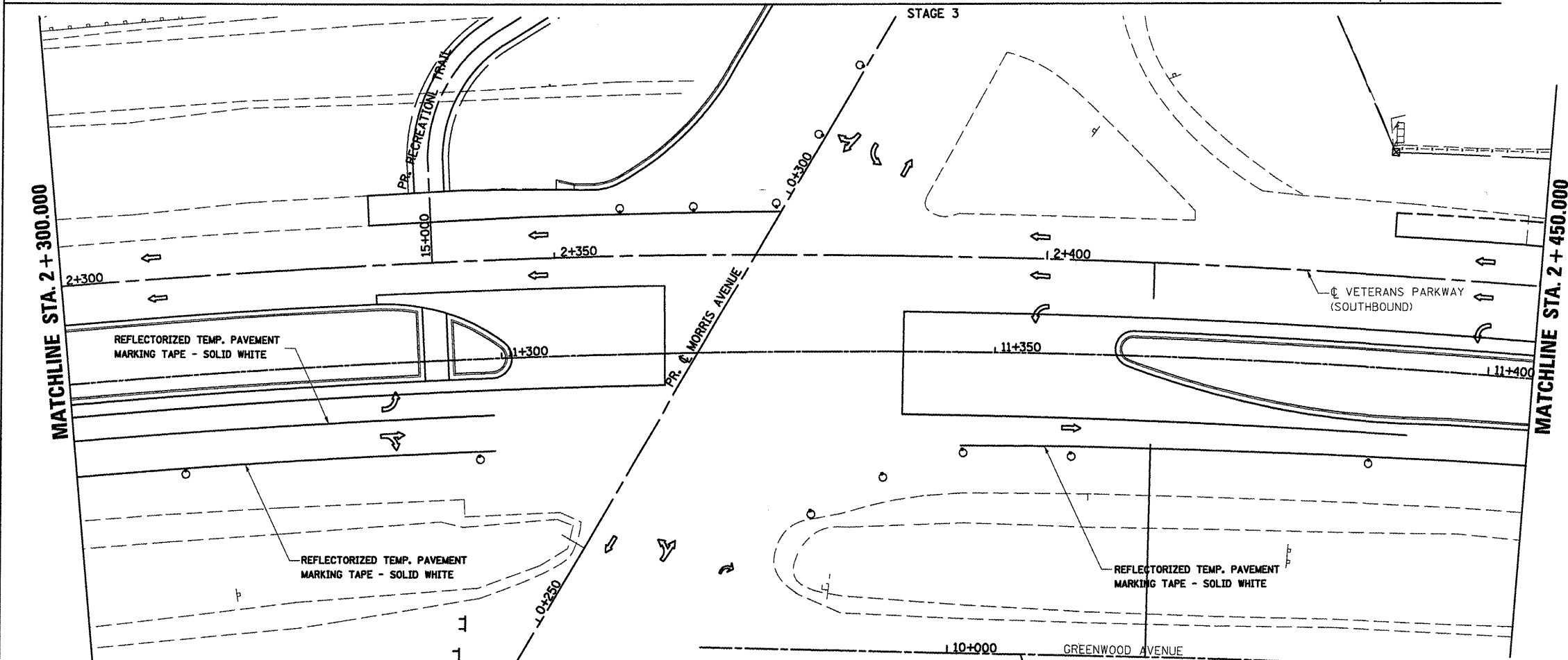
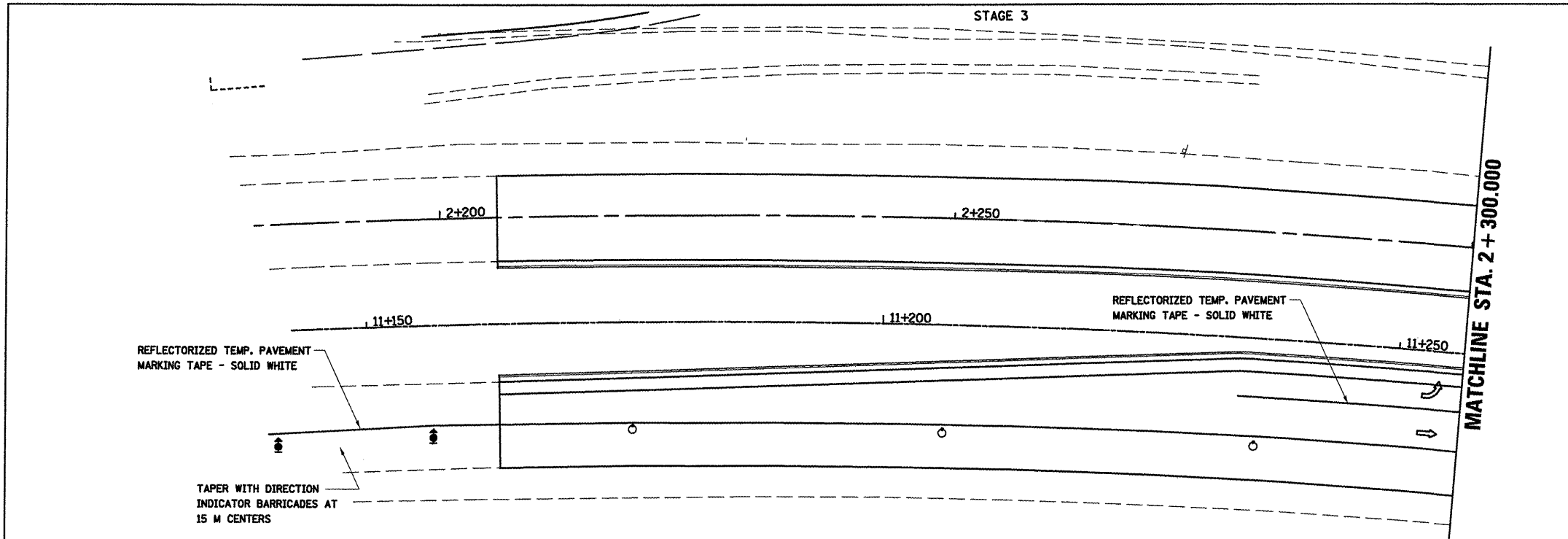

REVISIONS	
NAME	DATE

ILLINOIS DEPARTMENT OF TRANSPORTATION

**STAGING PLANS
 STAGE 3 VETERANS PARKWAY**

DRAWN BY SAM
 CHECKED BY PMH

DATE 05-27-09

PLOT DATE = 6/12/2009
 PLOT SCALE = 1:2500
 USER NAME = craig

STAGING PLANS, STAGE 3 VETERANS PARKWAY