

F.A.P. RTE.	SECTION	COUNTY	TOTAL SHEETS	SHEET NO.
704	(1)N & TS-1	McLEAN	497	125
STA. 2+750.000		TO STA. 3+050.400		
FED. ROAD DIST. NO.		ILLINOIS FED. AID PROJECT		
CONTRACT NO. 70514				

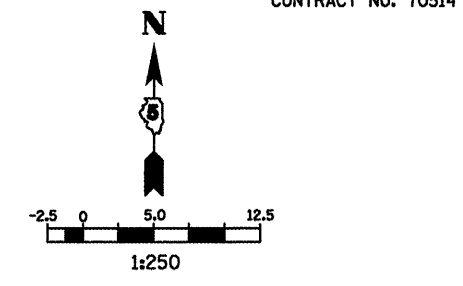
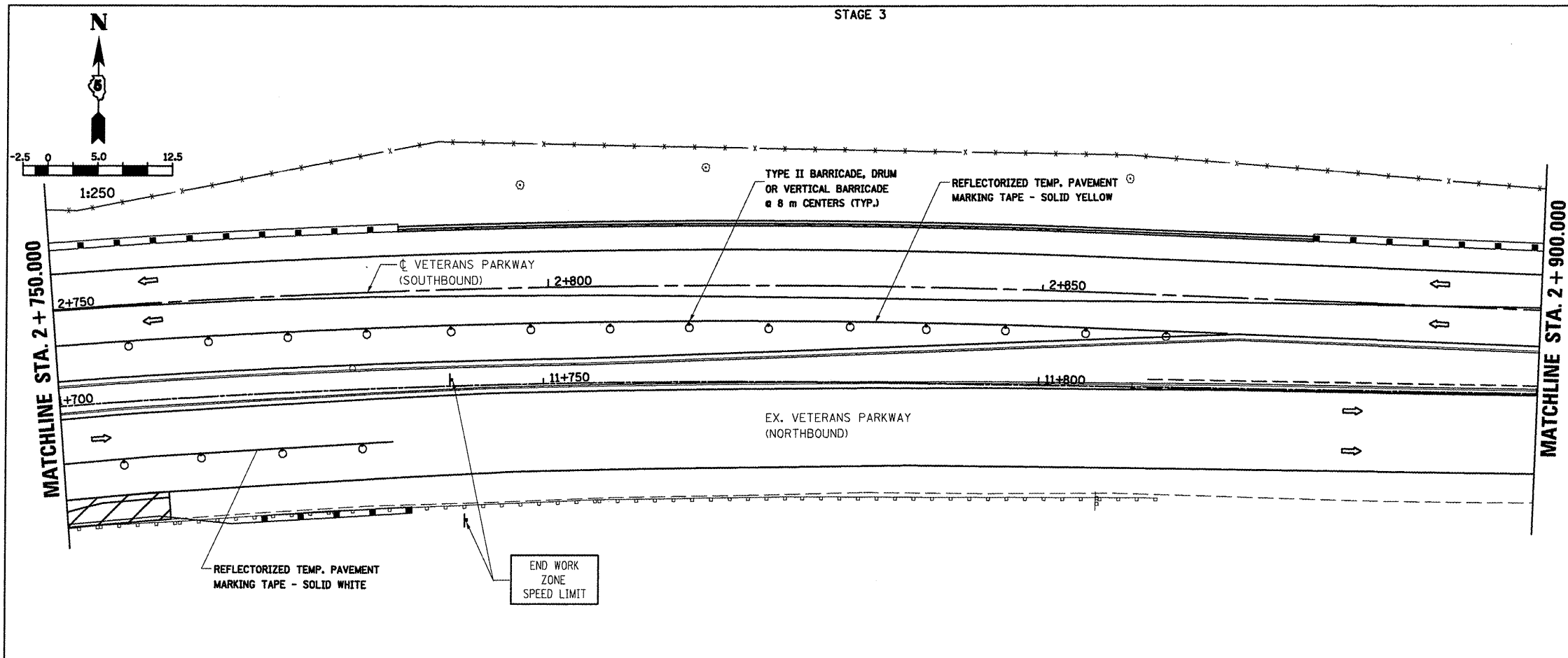

- LEGEND**
- SIGN
  - DRUM, BARRICADE OR VERTICAL BARRICADE WITH STEADY BURNING LIGHT
  - ▨ WORK AREA
  - ⇐ DIRECTION OF TRAFFIC

WORK TO BE COMPLETED IN STAGE 3  
 CONSTRUCT RIGHT TURN LANE, GUARDRAIL, AND INTERSECTION WITH GREENWOOD AVE. FROM STA. 2+586.300 TO STA. 2+785.2.

SEE STANDARD 701422-02 FOR ADDITIONAL DETAILS.

WORK ZONE SPEED LIMIT 35 MPH.

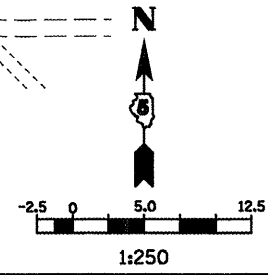
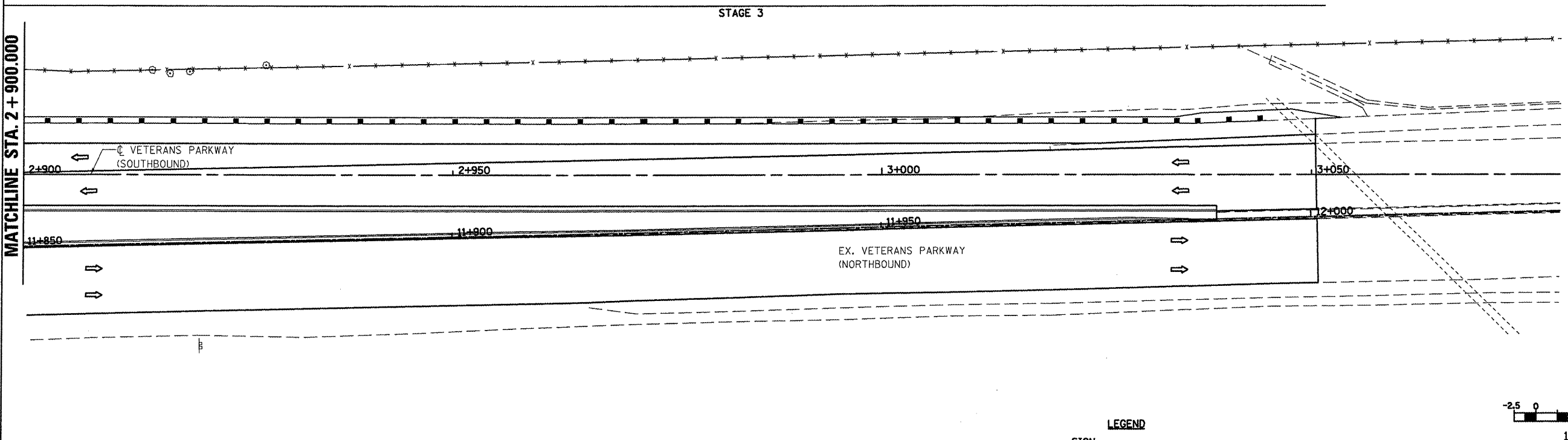

- LEGEND**
- SIGN
  - DRUM, BARRICADE OR VERTICAL BARRICADE WITH STEADY BURNING LIGHT
  - ▨ WORK AREA
  - ⇐ DIRECTION OF TRAFFIC

REVISIONS	
NAME	DATE

ILLINOIS DEPARTMENT OF TRANSPORTATION

STAGING PLANS  
 STAGE 3 VETERANS PARKWAY

DRAWN BY SAM  
 CHECKED BY PMH

DATE 05-27-09

PLOT DATE = 8/12/2009  
 PLOT SCALE = 1:2500  
 USER NAME = crosign

**STAGING PLANS, STAGE 3 VETERANS PARKWAY**