

F.A.P. RTE.	SECTION	COUNTY	TOTAL SHEETS	SHEET NO.
704	(DN & TS-1)	MGLEAN	497	140
STA. 10+300.000		TO STA. 10+600.000		
FED. ROAD DIST. NO.		ILLINOIS FED. AID PROJECT		
CONTRACT NO. 70514				

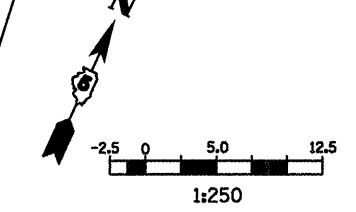

- LEGEND**
- TT TYPE III BARRICADE
  - ⊥ SIGN
  - DRUM, BARRICADE OR VERTICAL BARRICADE WITH STEADY BURNING LIGHT
  - ▨ WORK AREA
  - ▩ TEMPORARY PAVEMENT
  - ⇄ DIRECTION OF TRAFFIC

**GENERAL STAGING NOTES**  
 MAINTAIN ACCESS TO ALL ADJACENT PROPERTIES THROUGHOUT THE DURATION OF THE PROJECT.

PLACE TYPE III BARRICADES IN ACCORDANCE WITH STANDARD 701901.

PROVIDE TEMPORARY MAILBOX SERVICE.

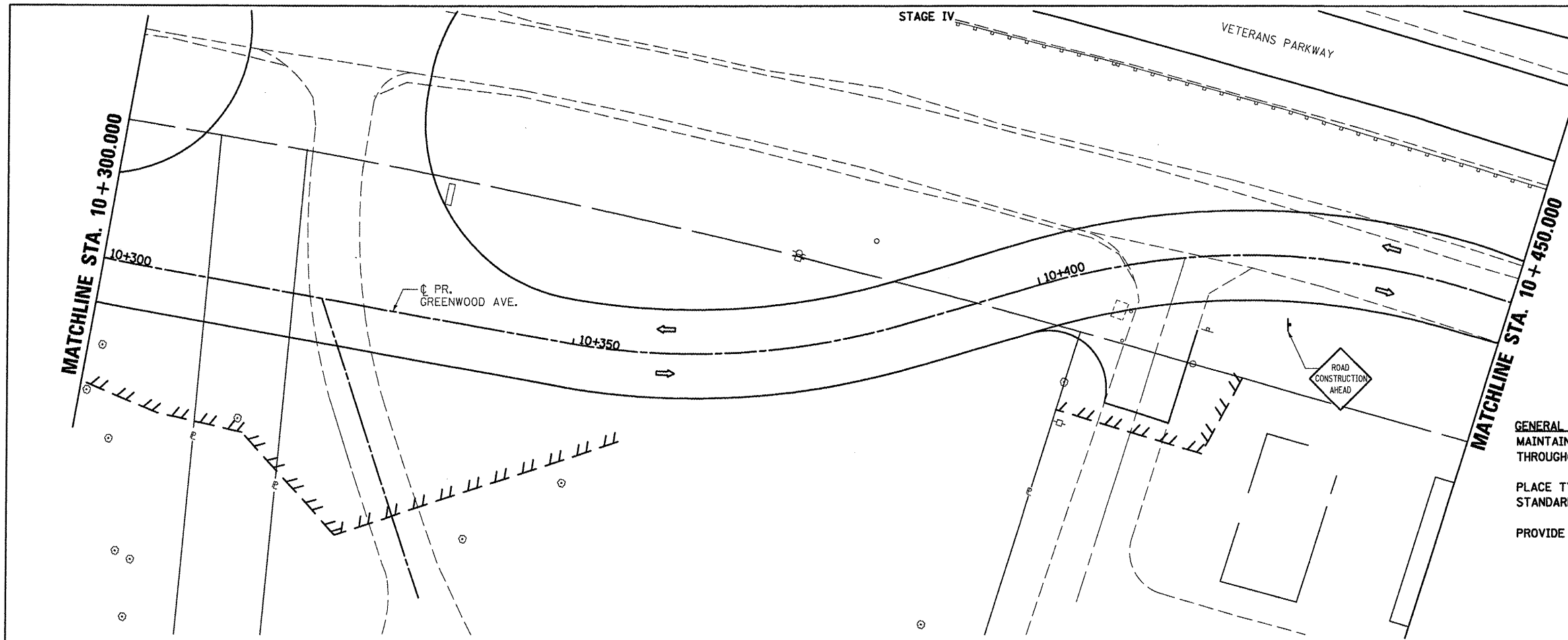

**GENERAL STAGING NOTES**  
 REMOVE TEMPORARY PAVEMENT FROM STATION 10+560.0 TO STATION 10+694.2

- LEGEND**
- ⊥ SIGN
  - DRUM, BARRICADE OR VERTICAL BARRICADE WITH STEADY BURNING LIGHT
  - ▨ WORK AREA
  - ▩ TEMPORARY PAVEMENT
  - ⇄ DIRECTION OF TRAFFIC

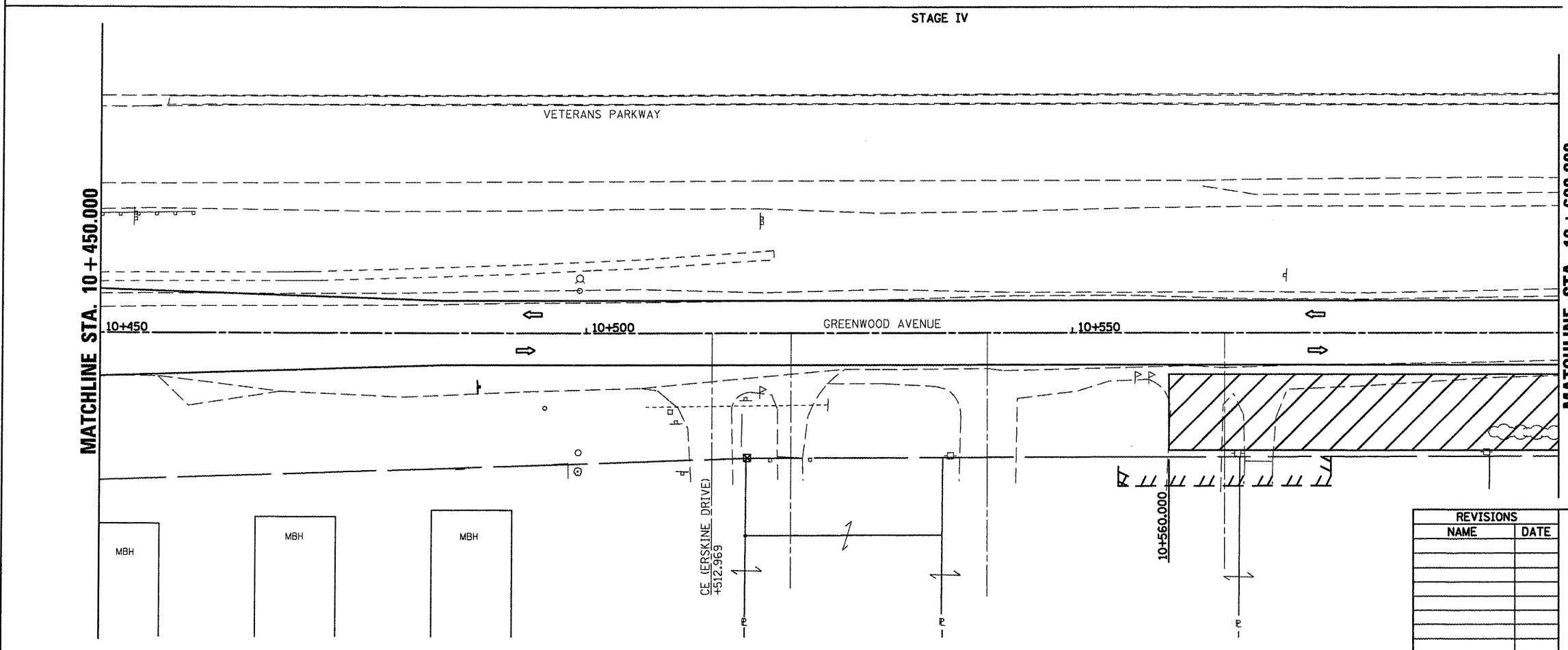

REVISIONS	
NAME	DATE

ILLINOIS DEPARTMENT OF TRANSPORTATION

STAGING PLANS  
 STAGE 4 GREENWOOD AVENUE (EAST)

DRAWN BY SAM  
 CHECKED BY PMH

DATE 05-27-09

PLOT DATE = 6/12/2018  
 PLOT SCALE = 1" = 250'  
 USER NAME = erouge

**STAGING PLANS, STAGE 4 GREENWOOD AVENUE (EAST)**