

F.A.P. RTE.	SECTION	COUNTY	TOTAL SHEETS	SHEET NO.
704	(DN & TS-1)	MGLEAN	497	170
STA. 0+515.000		TO STA. 0+650.000		
FED. ROAD DIST. NO.		ILLINOIS FED. AID PROJECT		

CONTRACT NO. 70514

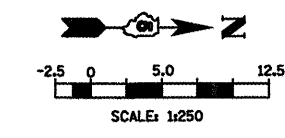

- LEGEND**
- 1.2 m
  - EXCAVATION NOT TO EXCEED LISTED DEPTH UNLESS APPROVED BY THE ENGINEER
  - TRENCH BACKFILL QUANTITY

NO.	AREAS CHECKED	TEMPLATE	NO.	BY	DATE

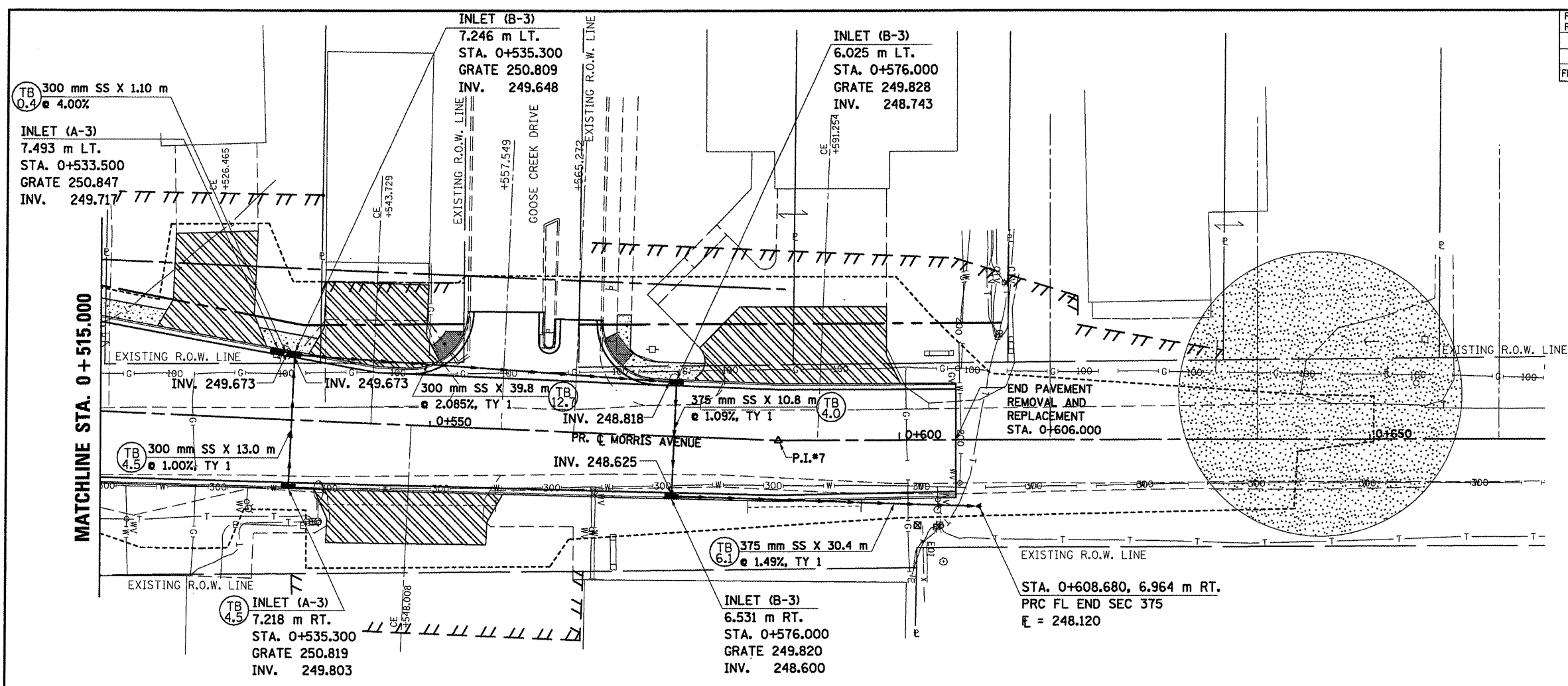

DATE OF LAST REVISION:  
05-27-09

NO.	AREAS CHECKED	TEMPLATE	NO.	BY	DATE

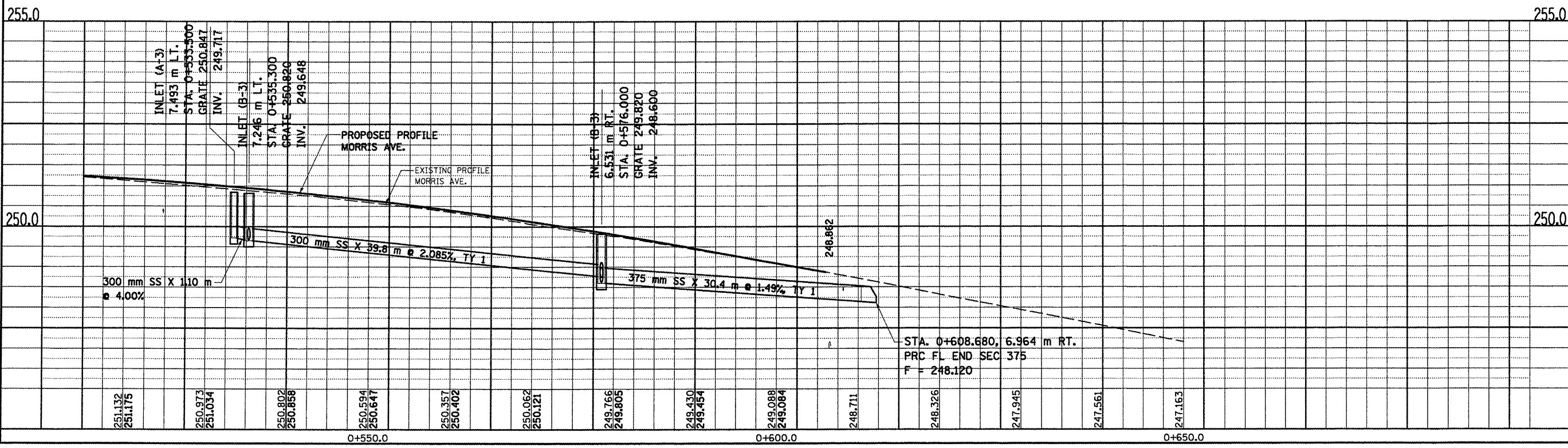

MORRIS AVENUE, DRAINAGE & UTILITIES SHEETS, STA. 0+515.000 TO STA. 0+650.000