

F.A.P. RTE.	SECTION	COUNTY	TOTAL SHEETS	SHEET NO.
704	(1N & TS-1)	McLEAN	497	173
STA. 0+150,000		TO STA. 0+275,000		
FED. ROAD DIST. NO.		ILLINOIS FED. AID PROJECT		
CONTRACT NO. 70514				

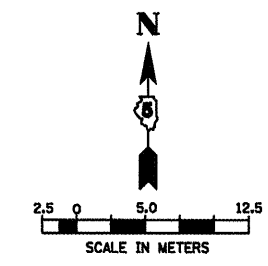

- LEGEND:
- S-R DRAINAGE STRUCTURE (SEE TABULATION)
  - S16 STORM SEWER (SEE TABULATION)

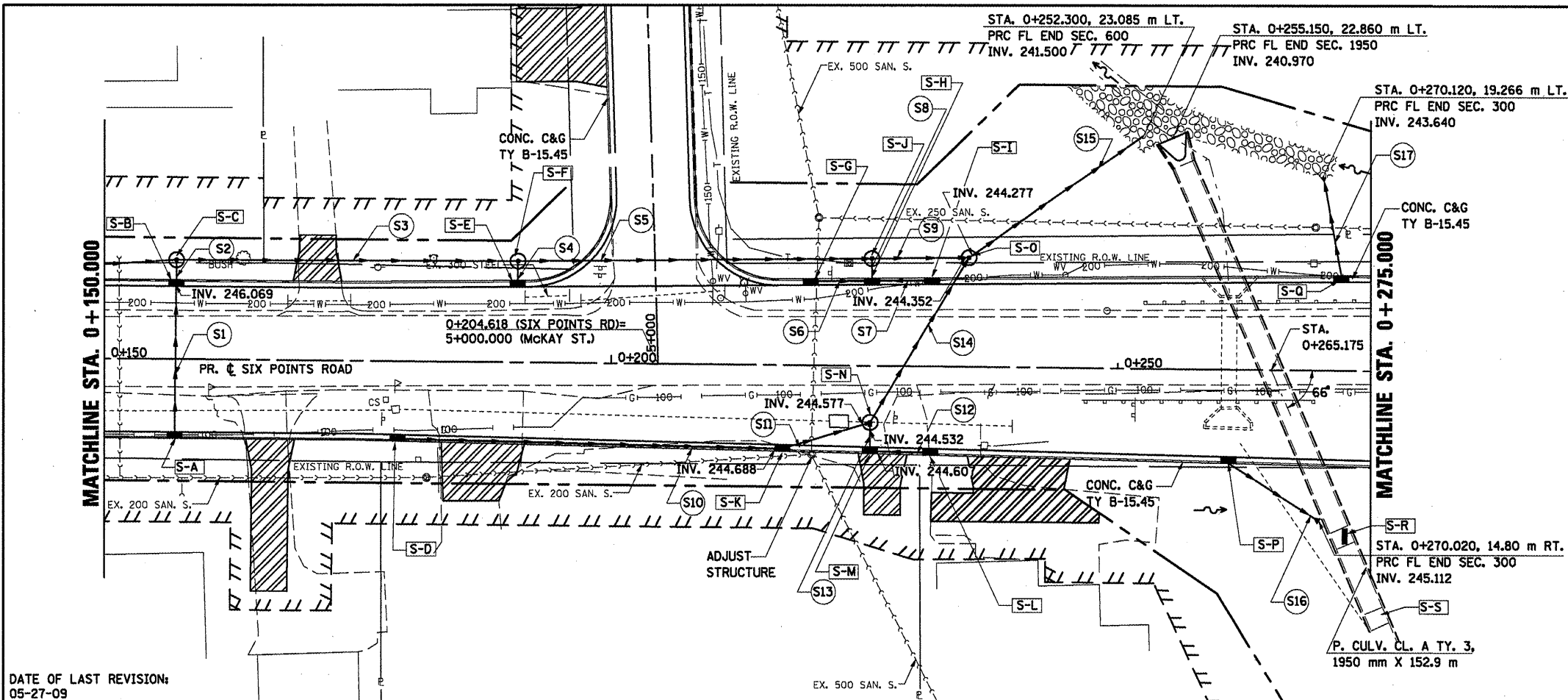

DATE OF LAST REVISION:  
05-27-09

BY	DATE

FINAL SURVEY PLOTTED  
NOTE BOOK TEMPLATE AREAS CHECKED

BY	DATE

ORIGINAL SURVEY PLOTTED  
NOTE BOOK TEMPLATE AREAS CHECKED

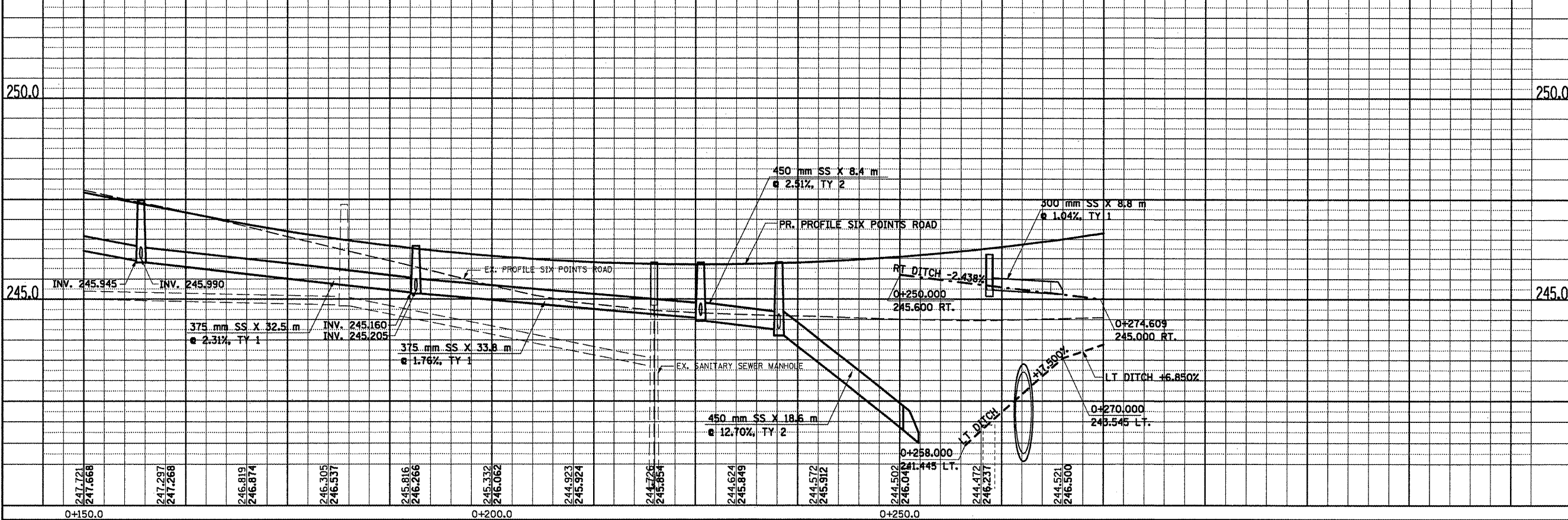

SIX POINTS ROAD, DRAINAGE & UTILITIES SHEETS, STA. 0+150.000 TO STA. 0+275.000