

F.A.P. RTE.	SECTION	COUNTY	TOTAL SHEETS	SHEET NO.
704	(1)N & TS-1	McLEAN	497	192
STA. N/A		TO STA. N/A		
FED. ROAD DIST. NO.		ILLINOIS FED. AID PROJECT		

CONTRACT NO. 70514

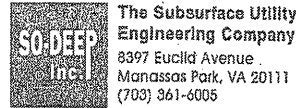

The Subsurface Utility Engineering Company
8397 Euclid Avenue
Manassas Park, VA 20111
(703) 361-6005

So-Deep Test Hole Certification Form - Metric

© So-Deep, Inc. 1988, 1994

City, County, State **McLEAN CO., IL**
Gen. Loc. **N.W. INT. VETERANS PKWY. & MORRIS AVE.**
Recorded Size/Material/Type **UNK. SIZE STEEL CASING PIPE**
Foreman/Truck#/Form By **J. HARLIN /221/M. LOSE**

Condition of paving prior to work
NO PAVING

Control # **SILA093**
Test Hole # **1**
Plan Scale **1:250**
Sheet # **11**
Proposed **STORM X-ING**
Date **OCTOBER 24, 2005**

B.M. 1 Elev. = **251.463M**
is **GIVEN**
Description: **(TRAV 2000) TOP OF RR SPIKE FOUND; 20.40M ± RIGHT OF STATION 0+402.80±, S. MORRIS AVE.**

B.M. 2 Elev. = **250.851M**
is **CALCULATED**
Description: **CHIS. "X" SET TOP RIM SSMH; 14.0M± LEFT OF STATION 0+418.20±, S. MORRIS AVE.**

Benchmarks check **BY 0.004M**
Elevations are referenced to **B.M.#2**

SO-DEEP will attempt to use the BM#4 most applicable to your design. If however, BMs differ by more than .05', resulting differences could cause design conflicts.

Recorded Size/Type of utility **WAS FOUND**

There **WERE** additional utilities in the test hole

The utility **WAS** in good condition.

Paving Thickness and type **NO PAVE**

Color of ribbon installed **ORANGE**

Soil Type **MOIST, HEAVY MUD**

Field Condition **GRASS RW**

T.H. tied to **PEG**

***406MM STEEL CASING PIPE**
Size/Material/Type
Portion of pipe exposed for O.D. measurement:
FULL

Remarks: ***ALSO FOUND IN TEST HOLE A 19MM STEEL PIPE RUNNING ABOVE & PARALLEL TO THE 406MM O.D. TELE CASING PIPE.**

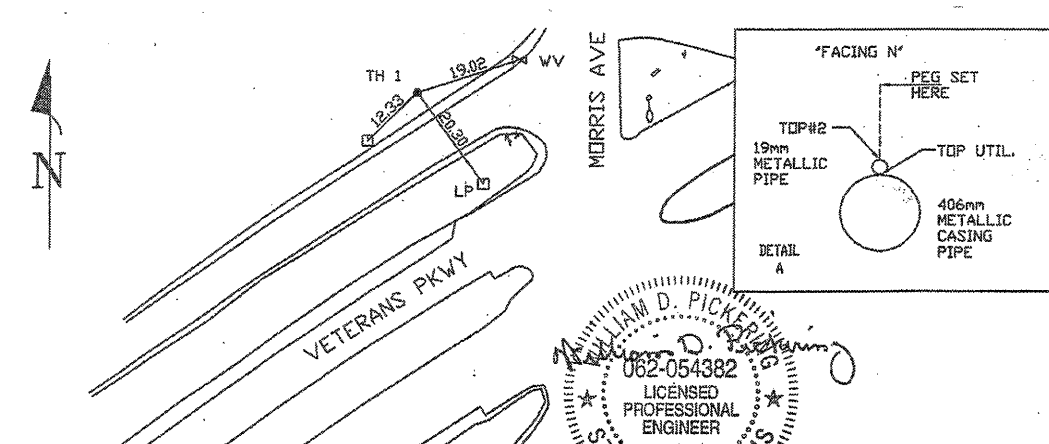
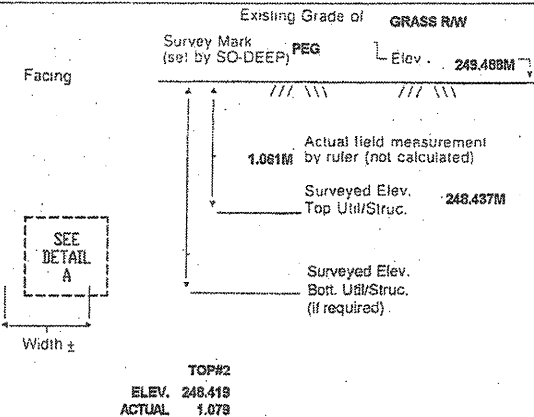

- R.W. = Rights of Way
- N.T.S. = Not to Scale
- * = Not Shown on Plan
- P.C.C. = Precast Concrete
- COND. = Conduit
- CONC. = Concrete
- O.D. = Outside Diameter
- C.I. = Cast Iron
- D.I. = Ductile Iron
- RPC = Rough Pour Concrete
- CL = Centerline
- T.C. = Terra Cotta
- PLAS. = Plastic
- BL = Base Line
- ELEC. = Electric
- TELE = Telephones
- T.H. = Test Hole
- SW = Sidewalk
- DW = Driveway
- BM = Benchmark
- C.B. = Catch Basin
- GV = Gas Valve

Performing out-of-sight work...with vision!
All values are shown in meters (m) or millimeters (mm). To convert to feet multiply meters by 3.2808.
Note: To eliminate mistakes and check this work, So-Deep suggests you scale and plot all dimensions onto the plans and review all elevations carefully. So-Deep is responsible only for information shown on our forms.

- Sewer Manhole
- Test Hole
- ⊕ Fire Hydrant
- ⊙ Pole
- ⊗ Fences Line
- ⊙ Electric Manhole
- ⊙ T.S. = Traversa Station
- ⊙ Valve
- ⊙ Water Meter
- ⊙ Telephone Manhole
- ⊙ Telephone Pedestal

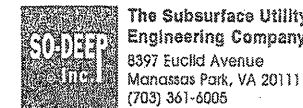
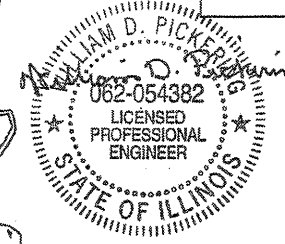

The Subsurface Utility Engineering Company
8397 Euclid Avenue
Manassas Park, VA 20111
(703) 361-6005

So-Deep Test Hole Certification Form - Metric

© So-Deep, Inc. 1988, 1994

City, County, State **McLEAN CO., IL**
Gen. Loc. **W. MEDIAN OF VETERANS PKWY. & MORRIS AVE INT.**
Recorded Size/Material/Type **102MM STEEL GAS LINE**
Foreman/Truck#/Form By **J. HARLIN /221/M. LOSE**

Condition of paving prior to work
NO PAVING

Control # **SILA093**
Test Hole # **2**
Plan Scale **1:250**
Sheet # **11**
Proposed **STORM X-ING**
Date **OCTOBER 22, 2005**

B.M. 1 Elev. = **251.463M**
is **GIVEN**
Description: **(TRAV 2000) TOP OF RR SPIKE FOUND; 20.40M ± RIGHT OF STATION 0+402.80±, S. MORRIS AVE.**

B.M. 2 Elev. = **250.851M**
is **CALCULATED**
Description: **CHIS. "X" SET TOP RIM SSMH; 14.0M± LEFT OF STATION 0+418.20±, S. MORRIS AVE.**

Benchmarks check **BY 0.004M**
Elevations are referenced to **B.M.#2**

SO-DEEP will attempt to use the BM#4 most applicable to your design. If however, BMs differ by more than .05', resulting differences could cause design conflicts.

Recorded Size/Type of utility **WAS FOUND**

There **WERE** additional utilities in the test hole

The utility **WAS** in good condition.

Paving Thickness and type **NO PAVE**

Color of ribbon installed **YELLOW**

Soil Type **MOIST, HEAVY**

Field Condition **GRASS RW**

T.H. tied to **PEG**

***121MM WRAPPED STEEL GAS LINE**
Size/Material/Type
Portion of pipe exposed for O.D. measurement:
FULL

Remarks: ***PIPE IS MAKING A NOTICABLE GRADE CHANGE IN A NORTH-EASTERLY DIRECTION.**

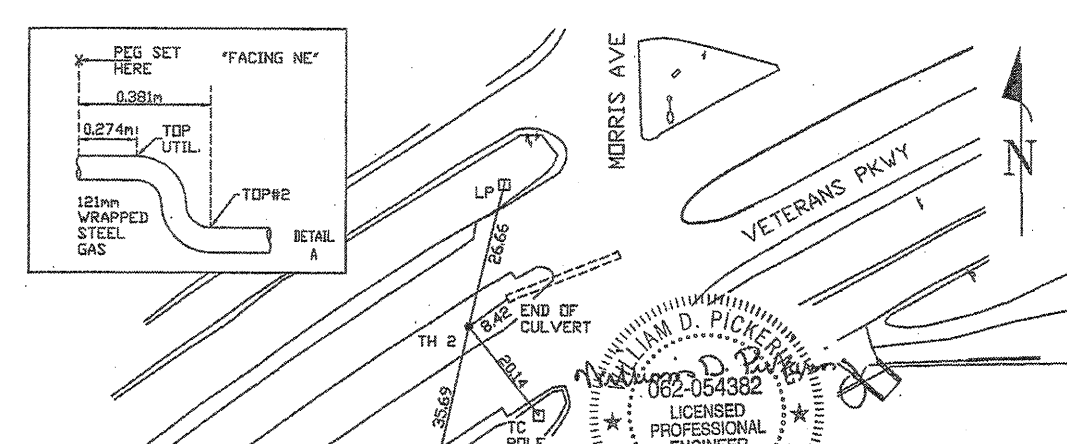
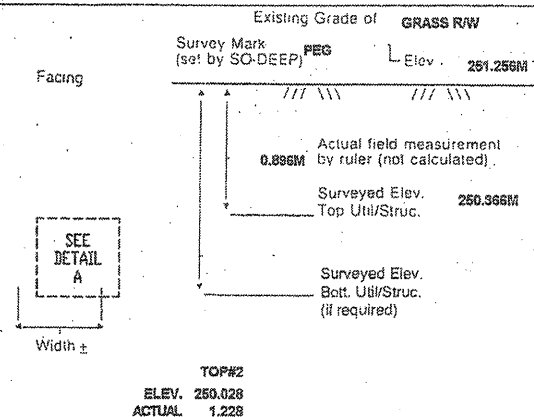

- R.W. = Rights of Way
- N.T.S. = Not to Scale
- * = Not Shown on Plan
- P.C.C. = Precast Concrete
- COND. = Conduit
- CONC. = Concrete
- O.D. = Outside Diameter
- C.I. = Cast Iron
- D.I. = Ductile Iron
- RPC = Rough Pour Concrete
- CL = Centerline
- T.C. = Terra Cotta
- PLAS. = Plastic
- BL = Base Line
- ELEC. = Electric
- TELE = Telephone
- T.H. = Test Hole
- SW = Sidewalk
- DW = Driveway
- BM = Benchmark
- C.B. = Catch Basin
- GV = Gas Valve

Performing out-of-sight work...with vision!
All values are shown in meters (m) or millimeters (mm). To convert to feet multiply meters by 3.2808.
Note: To eliminate mistakes and check this work, So-Deep suggests you scale and plot all dimensions onto the plans and review all elevations carefully. So-Deep is responsible only for information shown on our forms.



REVISIONS	
NAME	DATE

ILLINOIS DEPARTMENT OF TRANSPORTATION
SUBSURFACE UTILITY ENGINEERING DETAILS
SHEET 1 OF 11
DRAWN BY **SAM**
CHECKED BY **FMH**
DATE **5/27/09**