

F.A.P. RTE.	SECTION	COUNTY	TOTAL SHEETS NO.	SHEET NO.
704	(1W & TS-1)	McLEAN	497	199
STA. N/A		TO STA. N/A		
FED. ROAD DIST. NO.		ILLINOIS FED. AID PROJECT		
CONTRACT NO. 70514				

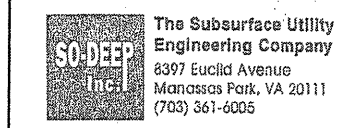

So-Deep Test Hole Certification Form - Metric

© So-Deep, Inc. 1988, 1994

Control # **SILA053**
 Test Hole # **16**
 Plan Scale **1:250**
 Sheet # **3**
 Proposed Date **STORM X-ING**
 Date **OCTOBER 19, 2005**

City, County, State **MCLEAN CO., IL**
 Gen. Loc. **N. CORNER OF MORRIS AVE. & SPRINGFIELD RD.**
 Recorded Size/Material/Type **(2) 13MM TELE. CABLES**
 Foreman/Truck#/Form By **J. HARLIN /221 /M. LOSE**

B.M. 1 Elev. = **251.463M**
 IS **GIVEN**
 Description: **(TRAV 2000) TOP OF RR SPIKE FOUND; 20.40M ± RIGHT OF STATION 0+418.20±, S. MORRIS AVE.**

B.M. 2 Elev. = **250.851M**
 IS **CALCULATED**
 Description: **CHIS. "X" SET TOP RIM SSMH; 14.0M± LEFT OF STATION 0+418.20±, S. MORRIS AVE.**

SO-DEEP will attempt to use the BM#1 most applicable to your design. If however, BMs differ by more than .05', resulting differences could cause design conflicts.

Benchmarks check **BY 0.003M**
 Elevations are referenced to **B.M.#2**

Recorded Size/Type of utility **WAS FOUND**

There **WERE NOT** additional utilities in the test hole.

The utility **WAS** in good condition.

Paving Thickness and type **NO PAVE**

Color of ribbon installed **ORANGE**

Soil Type **MOIST DIRT**

Field Condition **GRASS R/W**

T.H. tied to **PEG**

(2) 13MM TELE. CABLES
 Size/Material/Type
 Portion of pipe exposed for O.D. measurement:
OTHER, (SEE REMARKS)

Remarks: **THE (2) 13MM TELE. CABLES ARE MAKING A NOTICABLE VERTICAL GRADE CHANGE IN A S. EASTERLY DIRECTION.**

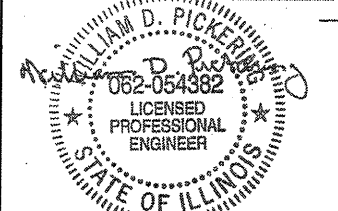
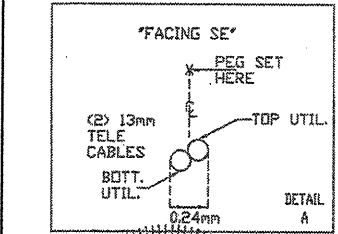
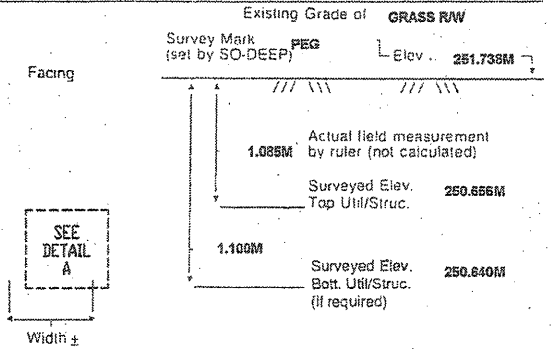

- RAW = Rights of Way
- N.T.S. = Not to Scale
- * = Not Shown on Plan
- PCC = Precast Concrete
- COND. = Conduit
- CONC. = Concrete
- O.D. = Outside Diameter
- C.I. = Cast Iron
- D.I. = Ductile Iron
- RPC = Rough Pour Concrete
- CL = Centerline
- T.C. = Terra Cotta
- PLAS. = Plastic
- BL = Base Line
- ELEC. = Electric
- TELE. = Telephone
- T.H. = Test Hole
- SW = Sidewalk
- DW = Driveway
- BM = Benchmark
- C.B. = Catch Basin
- GV = Gas Valve

Performing out-of-sight work...with vision!

All values are shown in meters (m) or millimeters (mm).
 Note: To eliminate mistakes and check this work, So-Deep suggests you scale and plot all dimensions onto the plans and review all elevations carefully. So-Deep is responsible only for information shown on our forms.

- Sewer Manhole
- Test Hole
- Fire Hydrant
- Pole
- x---x---x--- Fence Line
- Electric Manhole
- = T.S. = Traverso Station
- Valve
- Water Meter
- Telephone Manhole
- Telephone Pedestal

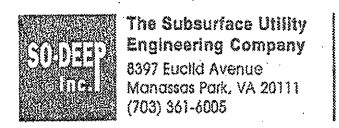

So-Deep Test Hole Certification Form - Metric

© So-Deep, Inc. 1988, 1994

Control # **SILA053**
 Test Hole # **16**
 Plan Scale **1:250**
 Sheet # **3**
 Proposed Date **STORM X-ING**
 Date **OCTOBER 19, 2005**

City, County, State **MCLEAN CO., IL**
 Gen. Loc. **W. OF INT., MORRIS AVE. & SIX POINTS RD.**
 Recorded Size/Material/Type **305MM LINK. TYPE WATER LINE**
 Foreman/Truck#/Form By **J. HARLIN /221 /M. LOSE**

B.M. 1 Elev. = **251.463M**
 IS **GIVEN**
 Description: **(TRAV 2000) TOP OF RR SPIKE FOUND; 20.40M ± RIGHT OF STATION 0+418.20±, S. MORRIS AVE.**

B.M. 2 Elev. = **250.851M**
 IS **CALCULATED**
 Description: **CHIS. "X" SET TOP RIM SSMH; 14.0M± LEFT OF STATION 0+418.20±, S. MORRIS AVE.**

SO-DEEP will attempt to use the BM#1 most applicable to your design. If however, BMs differ by more than .05', resulting differences could cause design conflicts.

Benchmarks check **BY 0.003M**
 Elevations are referenced to **B.M.#2**

Recorded Size/Type of utility **WAS FOUND**

There **WERE NOT** additional utilities in the test hole.

The utility **WAS** in good condition.

Paving Thickness and type **203MM ASPH.**

Color of ribbon installed **BLUE**

Soil Type **DRY, SANDY SOIL**

Field Condition **LIGHT RD. TRAFFIC**

T.H. tied to **P.K. NAIL**

305MM CORRODED METALLIC WATER LINE
 Size/Material/Type
 Portion of pipe exposed for O.D. measurement:
FULL

Remarks: **THE CREW FOUND THE 305MM LINK. MATERIAL WATER LINE HEAVILY CORRODED @ THIS LOCATION.**

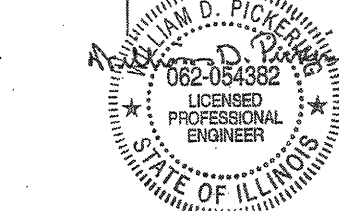
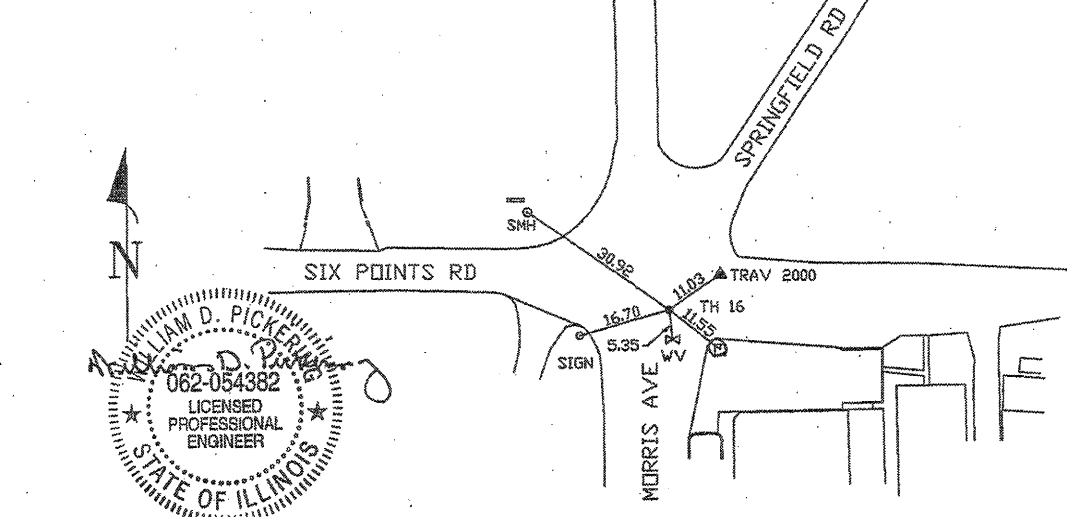
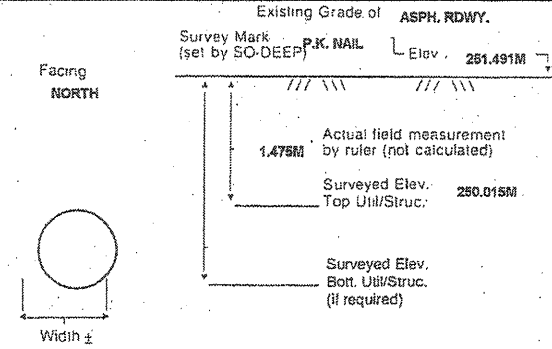

- RAW = Rights of Way
- N.T.S. = Not to Scale
- * = Not Shown on Plan
- PCC = Precast Concrete
- COND. = Conduit
- CONC. = Concrete
- O.D. = Outside Diameter
- C.I. = Cast Iron
- D.I. = Ductile Iron
- RPC = Rough Pour Concrete
- CL = Centerline
- T.C. = Terra Cotta
- PLAS. = Plastic
- BL = Base Line
- ELEC. = Electric
- TELE. = Telephone
- T.H. = Test Hole
- SW = Sidewalk
- DW = Driveway
- BM = Benchmark
- C.B. = Catch Basin
- GV = Gas Valve

Performing out-of-sight work...with vision!

All values are shown in meters (m) or millimeters (mm).
 Note: To eliminate mistakes and check this work, So-Deep suggests you scale and plot all dimensions onto the plans and review all elevations carefully. So-Deep is responsible only for information shown on our forms.

- Sewer Manhole
- Test Hole
- Fire Hydrant
- Pole
- x---x---x--- Fence Line
- Electric Manhole
- = T.S. = Traverso Station
- Valve
- Water Meter
- Telephone Manhole
- Telephone Pedestal

REVISIONS	
NAME	DATE

ILLINOIS DEPARTMENT OF TRANSPORTATION

SUBSURFACE UTILITY ENGINEERING DETAILS
 SHEET 8 OF 11

DRAWN BY **SAM**
 CHECKED BY **PMH**

DATE **5/27/09**