

F.A.P. RTE.	SECTION	COUNTY	TOTAL SHEETS	SHEET NO.
T04	(DN & TS-1)	McLEAN	497	216
STA.		TO STA.		
FED. ROAD DIST. NO.		ILLINOIS FED. AID PROJECT		
CONTRACT NO. 70514				

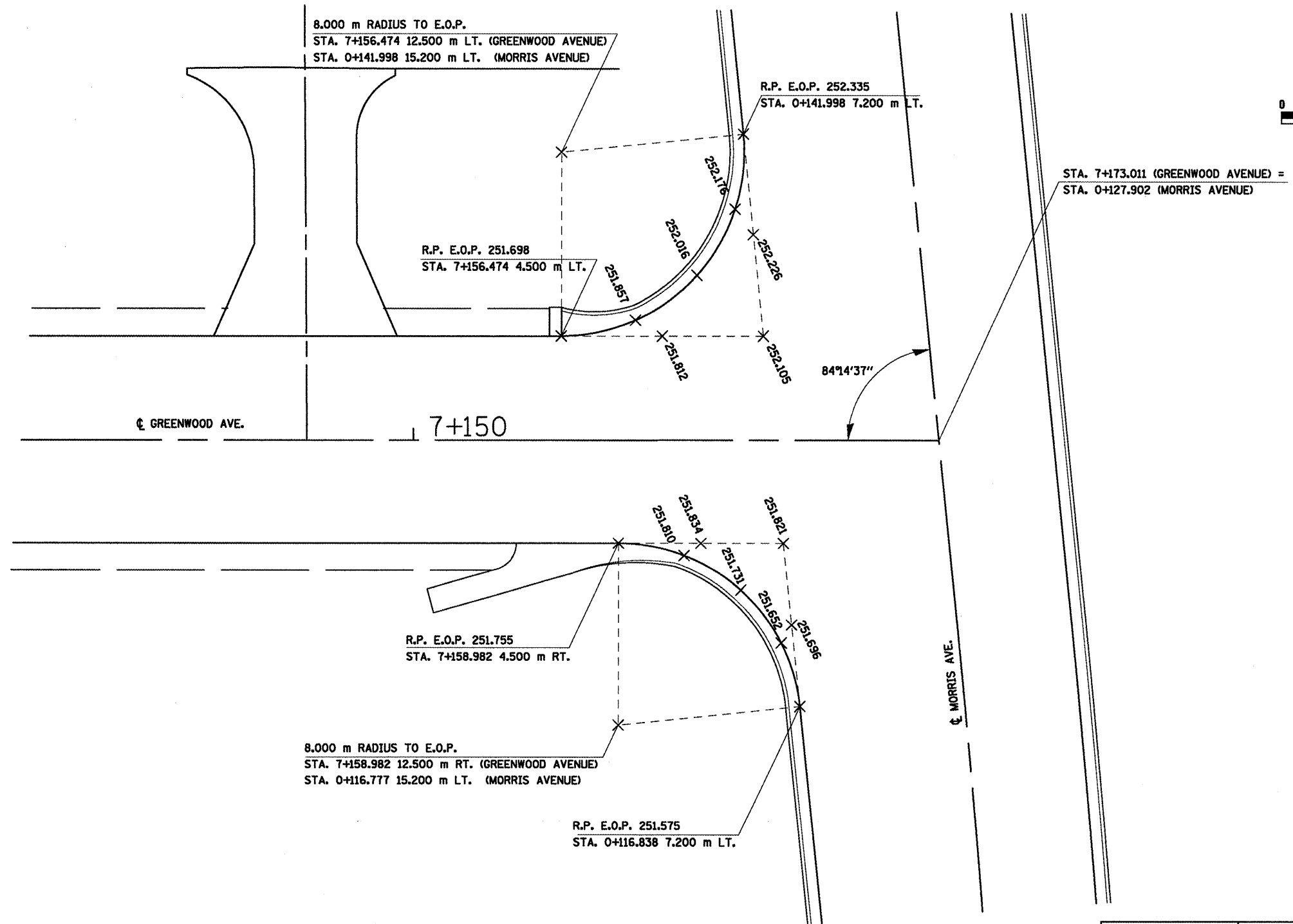
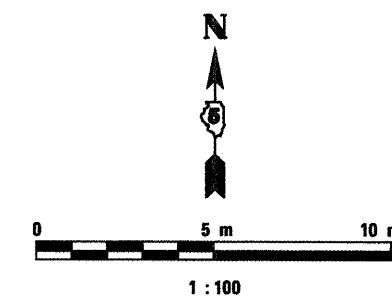

**NOTES:**

1. ALL PROPOSED CONCRETE CURB AND GUTTER SHOWN IS B-15.45 UNLESS NOTED OTHERWISE.
2. ELEVATIONS LISTED ALONG THE EDGE OF PAVEMENT BETWEEN THE RETURN POINTS ARE QUARTER POINTS OF THE TOTAL CURVE LENGTH.

REVISIONS		ILLINOIS DEPARTMENT OF TRANSPORTATION
NAME	DATE	
		MORRIS AVENUE AND GREENWOOD AVENUE INTERSECTION DETAILS
DATE 05-27-09		DRAWN BY BER CHECKED BY PMH