

F.A.P. RTE.	SECTION	COUNTY	TOTAL SHEETS	SHEET NO.
704	(LN & TS-1	McLEAN	497	218
STA.		TO STA.		
FED. ROAD DIST. NO.		ILLINOIS FED. AID PROJECT		
CONTRACT NO. 70514				

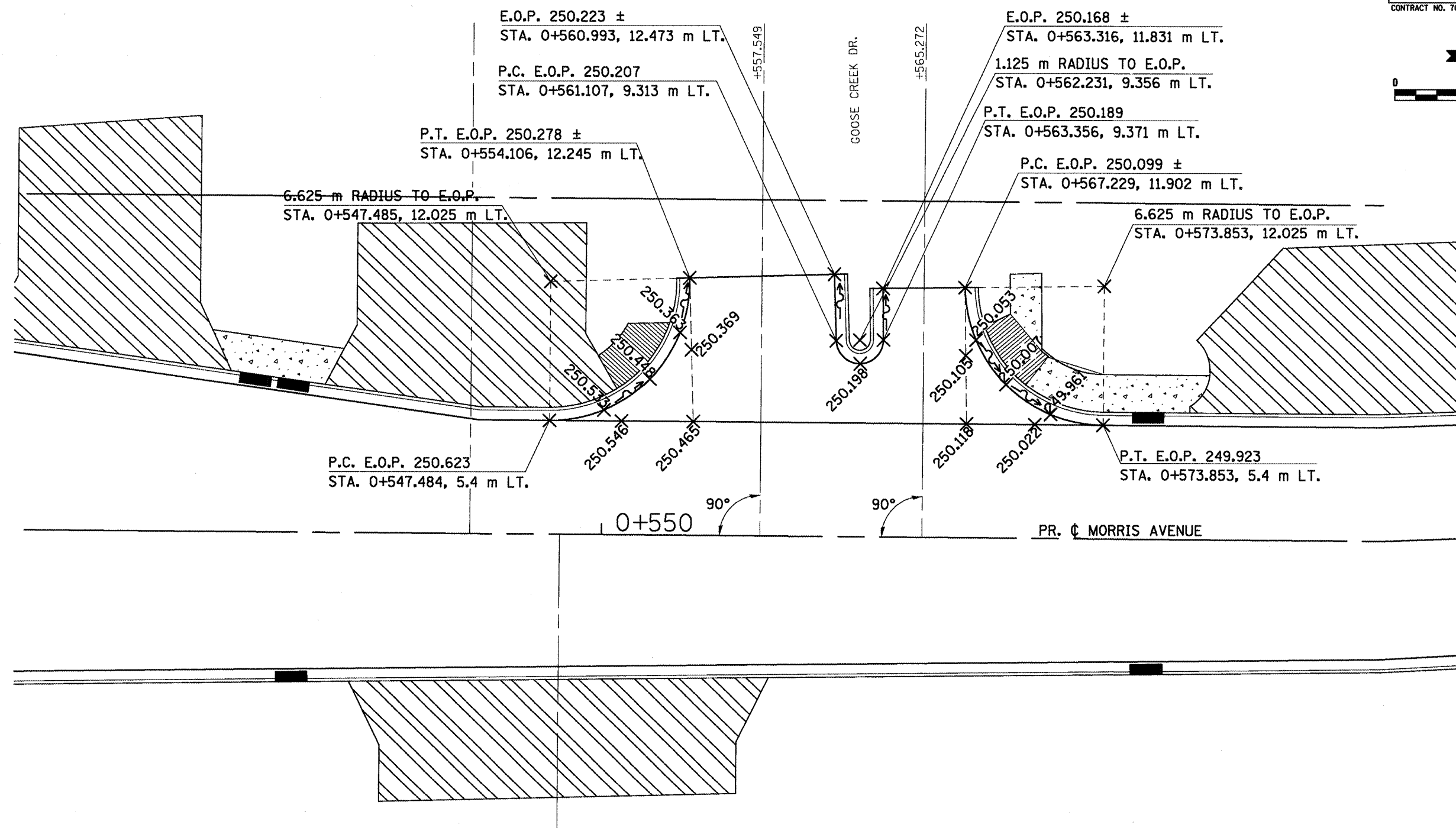
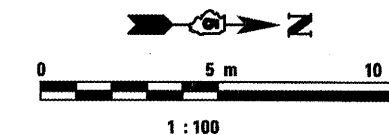

NOTES:

1. ALL PROPOSED CONCRETE CURB AND GUTTER SHOWN IS B-15.45 UNLESS NOTED OTHERWISE.
2. ELEVATIONS LISTED ALONG THE EDGE OF PAVEMENT BETWEEN THE RETURN POINTS ARE QUARTER POINTS OF THE TOTAL RADIUS LENGTH.

REVISIONS	
NAME	DATE

ILLINOIS DEPARTMENT OF TRANSPORTATION

GOOSE CREEK DR. AND MORRIS AVE.
INTERSECTION DETAILS

DATE 05-27-09
DRAWN BY SAM
CHECKED BY PMH

GOOSE CREEK DR. AND MORRIS AVE. INTERSECTION DETAILS