

F.A.P. RTE.	SECTION	COUNTY	TOTAL SHEETS	SHEET NO.
704	11N & TS-1	MoLEAN	497	331
STA. 2+430.000		TO STA. 2+440.000		
FED. ROAD DIST. NO.	ILLINOIS	FED. AID PROJECT		
28	30	32	34	36
CONTRACT NO. 70514				

36 34 32 30 28 26 24 22 20 18 16 14 12 10 8 6 4 2 0 2 4 6 8 10 12 14 16 18 20 22 24 26

DATE _____
 BY _____
 SURVEYED _____
 SURVEY _____
 NOTE BOOK _____
 TEMPLATE _____
 AREAS _____
 CHECKED _____
 NO. _____

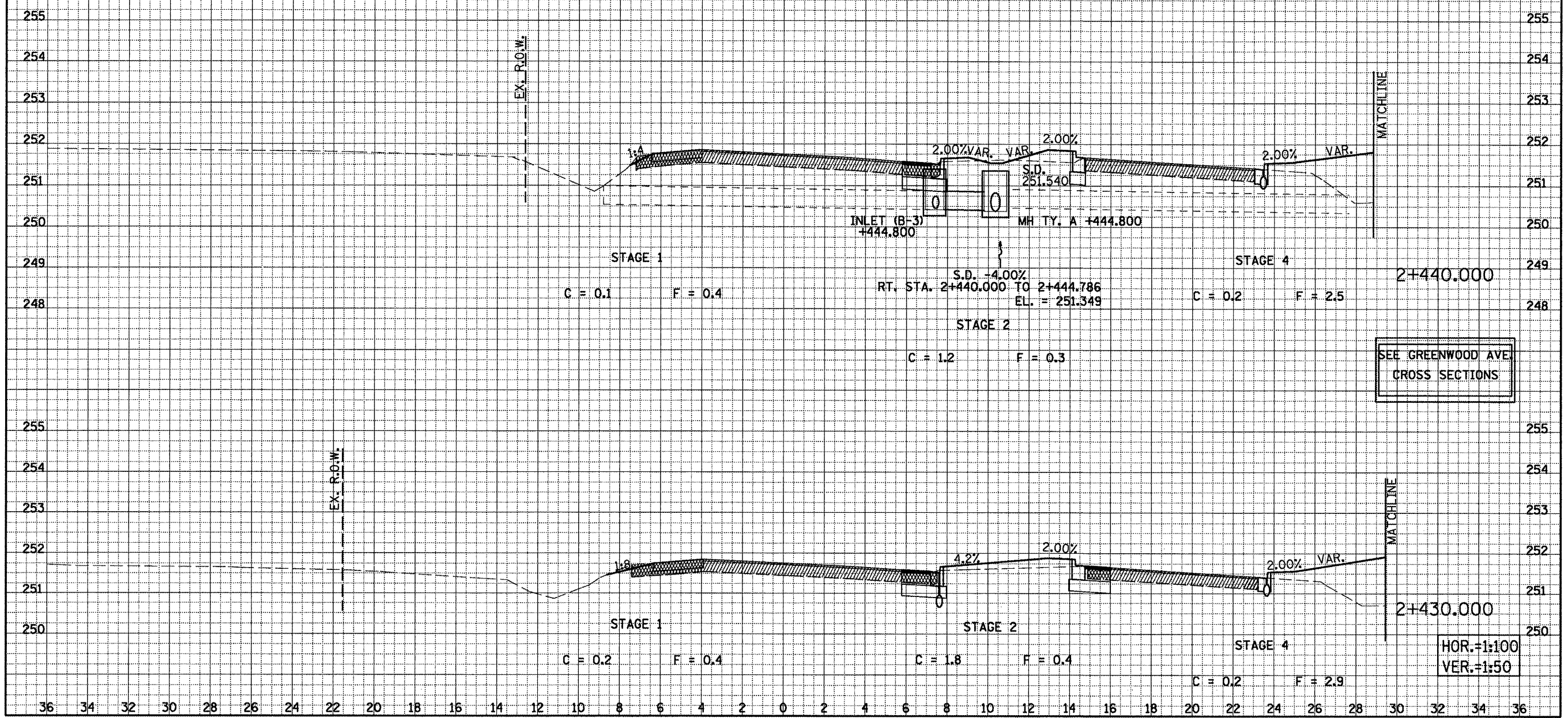

DATE _____
 BY _____
 SURVEYED _____
 SURVEY _____
 NOTE BOOK _____
 TEMPLATE _____
 AREAS _____
 CHECKED _____
 NO. _____

VETERANS PARKWAY CROSS SECTIONS, STA. 2+430.000 TO STA. 2+440.000