

36 34 32 30 28 26 24 22 20 18 16 14 12 10 8 6 4 2 0 2 4 6 8 10 12 14 16 18 20 22 24 26

F.A.P. RTE.	SECTION	COUNTY	TOTAL SHEETS	SHEET NO.
704	(1)N & TS-1	McLEAN	497	368
STA. 0+200.000		TO STA. 0+210.000		
FED. ROAD DIST. NO.		ILLINOIS FED. AID PROJECT		

CONTRACT NO. 70514

FINAL SURVEY NOTE BOOK NO. _____
 BY _____ DATE _____
 QUANTIFIED AREAS CHECKED _____
 UNQUANTIFIED AREAS CHECKED _____

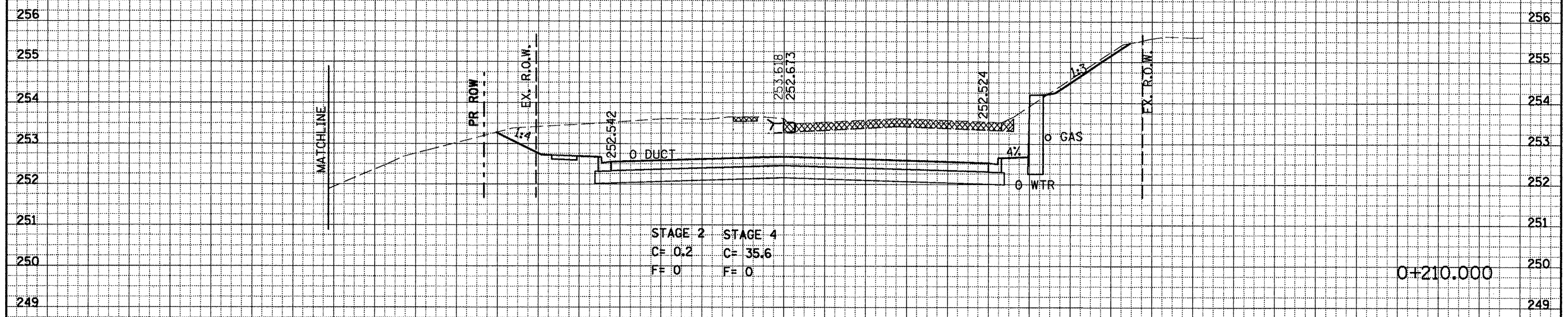

ORIGINAL SURVEY NOTE BOOK NO. _____
 BY _____ DATE _____
 QUANTIFIED AREAS CHECKED _____
 UNQUANTIFIED AREAS CHECKED _____

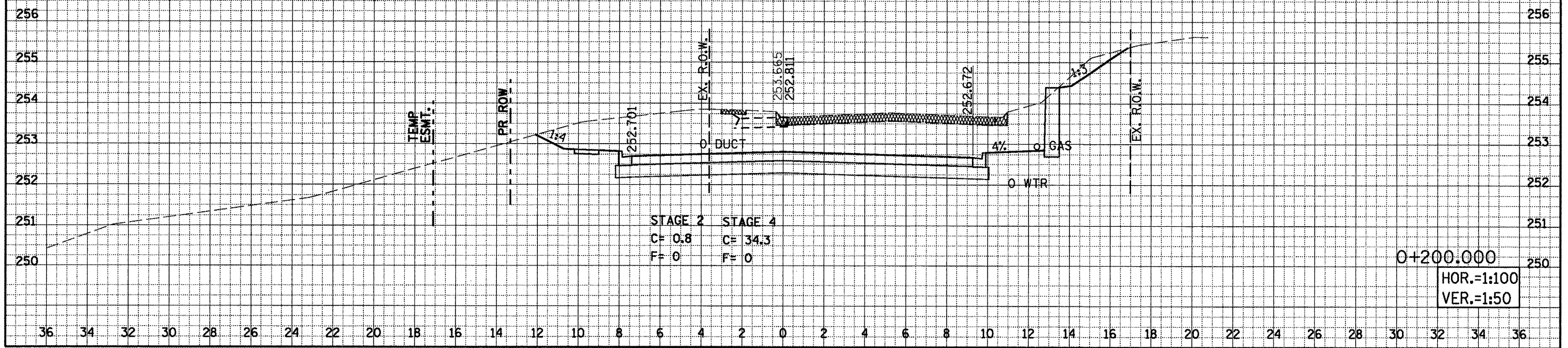

HOR.=1:100
 VER.=1:50