

F.A.S. RTE.	SECTION	COUNTY	TOTAL SHEETS	SHEET NO.
704	(1)N & TS-1	McLEAN	497	391
STA. 0+220.000		TO STA. 0+230.000		
FED. ROAD DIST. NO.	ILLINOIS	FED. AID PROJECT		

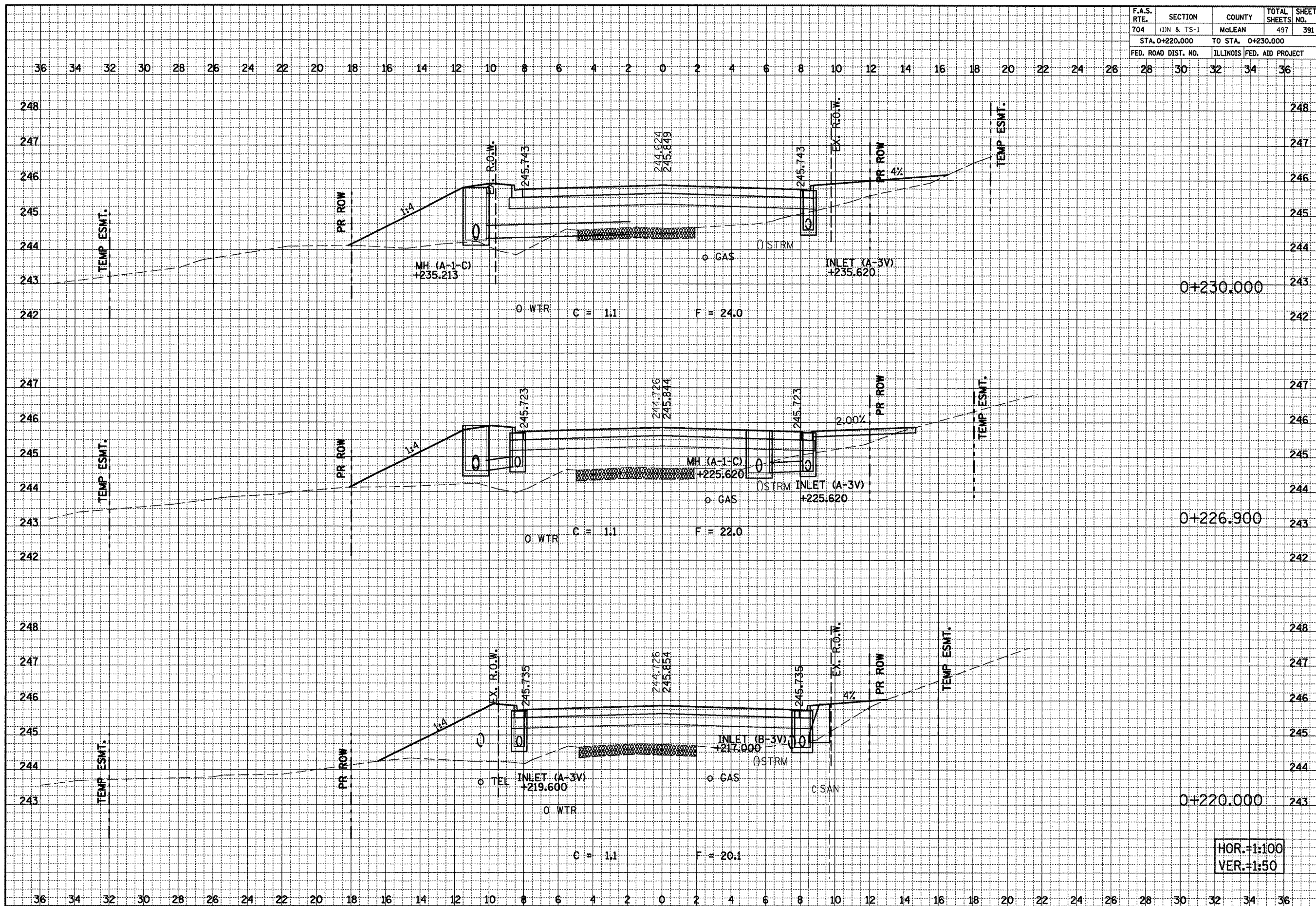

FINAL SURVEY NOTE BOOK NO. \_\_\_\_\_  
 SURVEYED BY \_\_\_\_\_  
 DATE \_\_\_\_\_  
 AREAS CHECKED \_\_\_\_\_

ORIGINAL SURVEY NOTE BOOK NO. \_\_\_\_\_  
 SURVEYED BY \_\_\_\_\_  
 DATE \_\_\_\_\_  
 AREAS CHECKED \_\_\_\_\_

HOR.=1:100  
 VER.=1:50

SIX POINTS ROAD CROSS SECTIONS, STA. 0+220.000 TO STA. 0+230.000