

F.A.S. RTE.	SECTION	COUNTY	TOTAL SHEETS NO.	SHEET NO.
704	(1)N & TS-1	McLEAN	497	396
STA. 0+270.000		TO STA. 0+270.000		
FED. ROAD DIST. NO.		ILLINOIS FED. AID PROJECT		

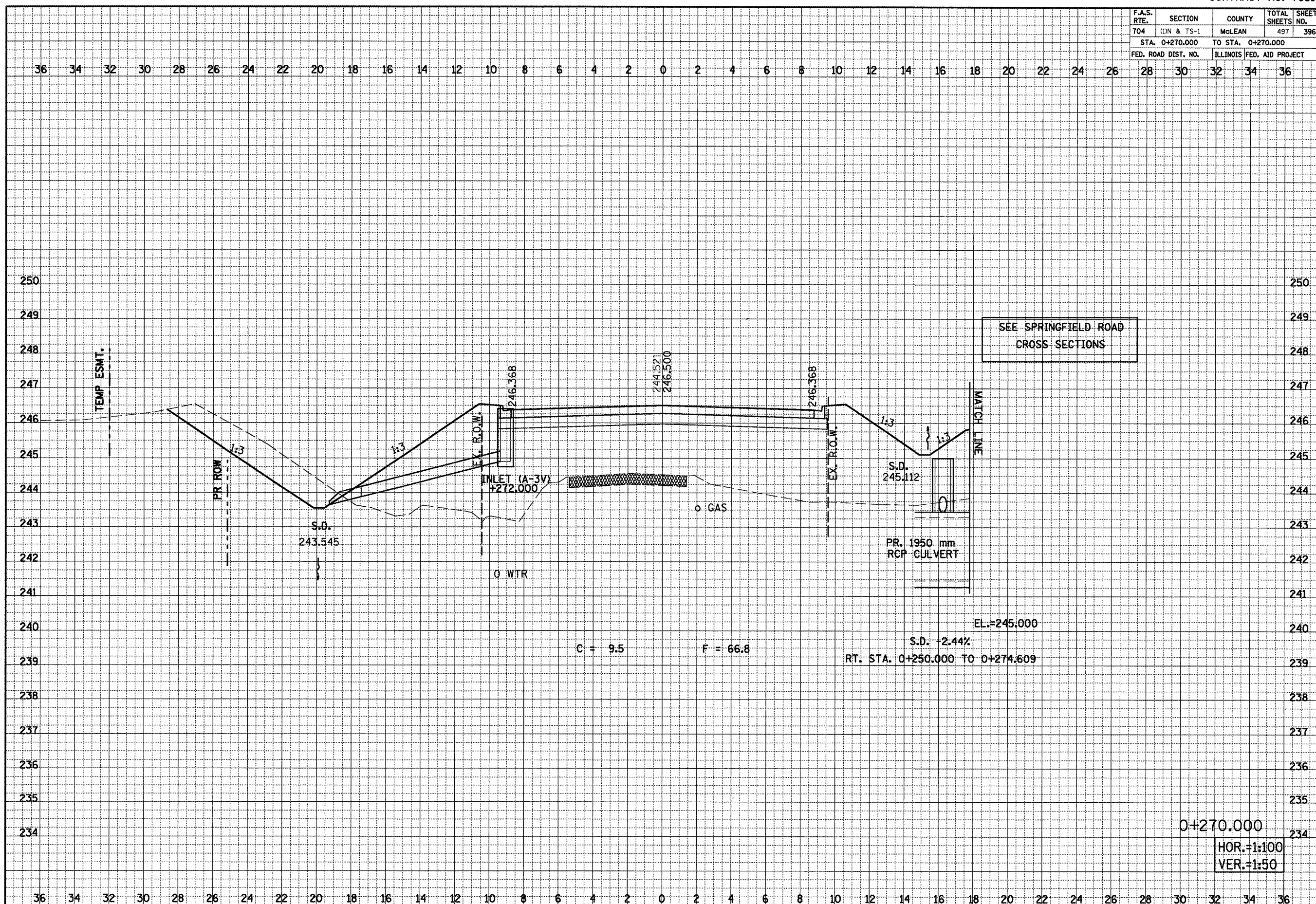

DATE	
BY	
REVIEWED	
SURVEY	
NOTE BOOK	
TEMPLATE	
AREAS	
CHECKED	

DATE	
BY	
REVIEWED	
SURVEY	
NOTE BOOK	
TEMPLATE	
AREAS	
CHECKED	

SIX POINTS ROAD CROSS SECTIONS, STA. 0+270.000