

F.A.P. RTE.	SECTION	COUNTY	TOTAL SHEETS	SHEET NO.
704	(1)N&TS-1	McLEAN	497	423
STA. 0+960.000		TO STA. 0+970.000		
FED. ROAD DIST. NO.	ILLINOIS FED. AID PROJECT			
28	30	32	34	36
CONTRACT NO. 70514				

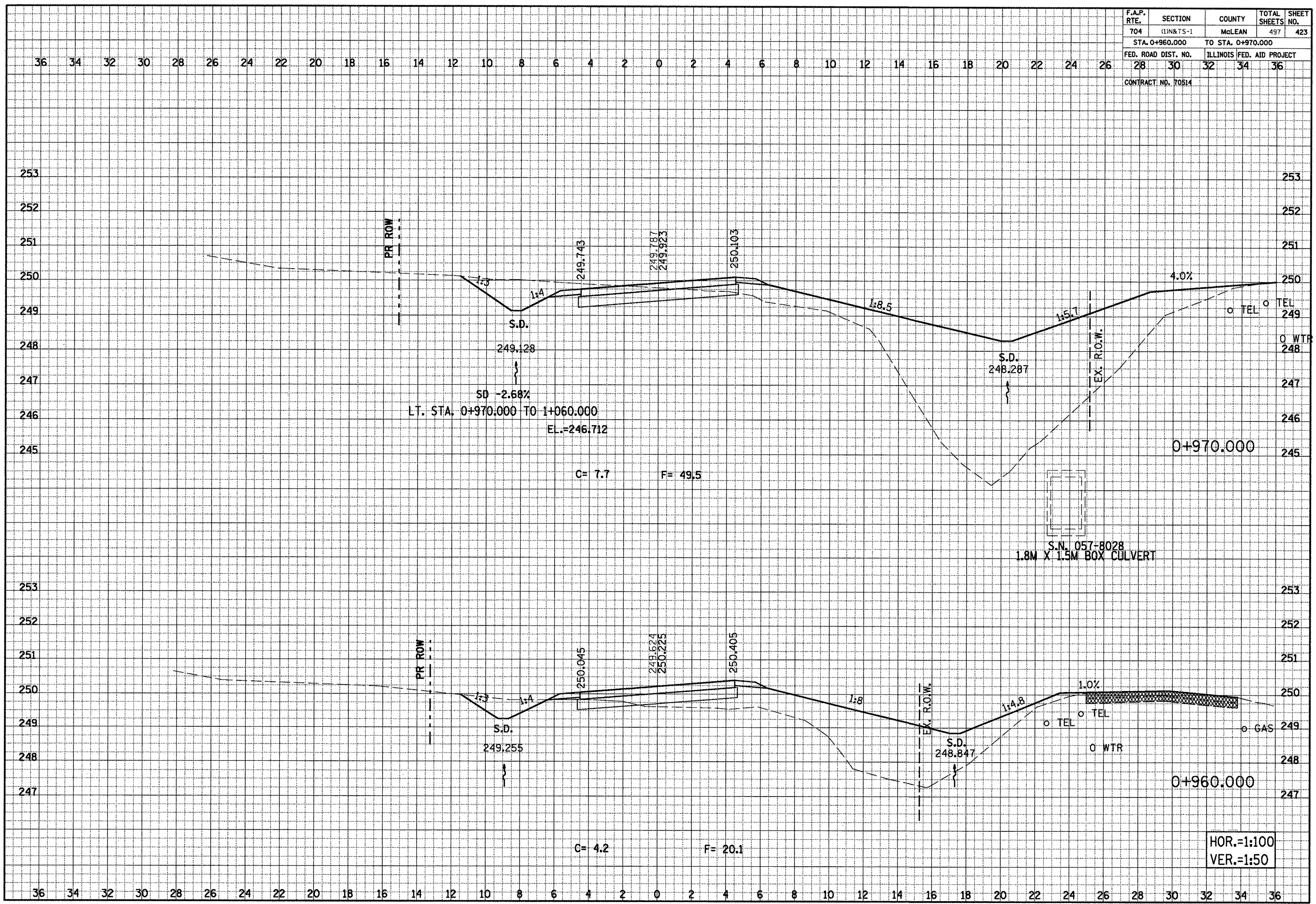

FINAL SURVEY BY: _____ DATE: _____

REVISIONS: _____

NOTE BOOK NO. _____

AREAS CHECKED: _____

ORIGINAL SURVEY BY: _____ DATE: _____

REVISIONS: _____

NOTE BOOK NO. _____

AREAS CHECKED: _____

SPRINGFIELD ROAD, CROSS SECTIONS, STA. 0+960.000 TO STA. 0+970.000

HOR.=1:100
VER.=1:50