

EXISTING TYPICAL SECTION

STATION 606+83.00 TO STATION 628+12.00

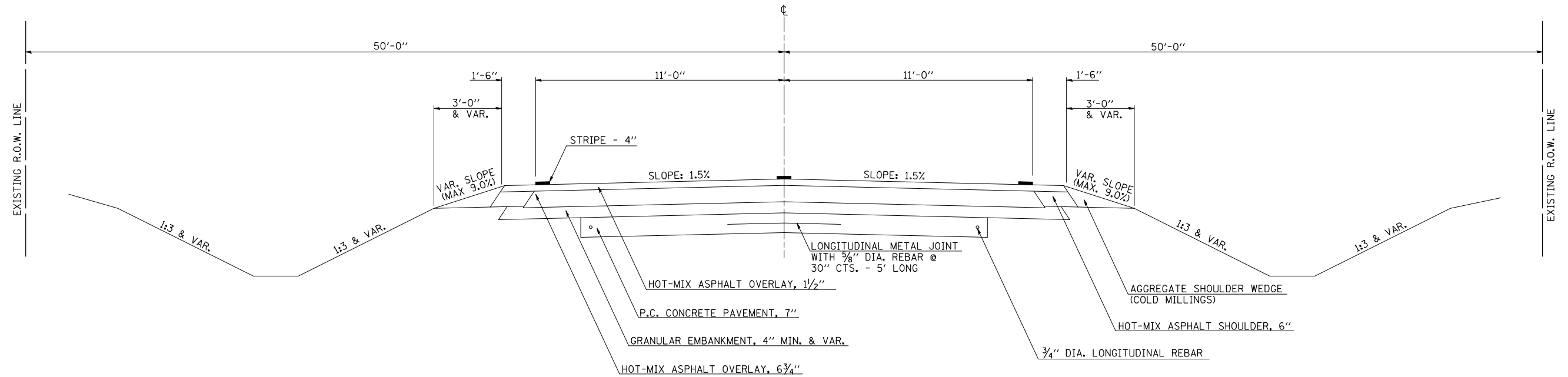

PROPOSED TYPICAL SECTION

STATION 626+41.33 TO STATION 626+58.67

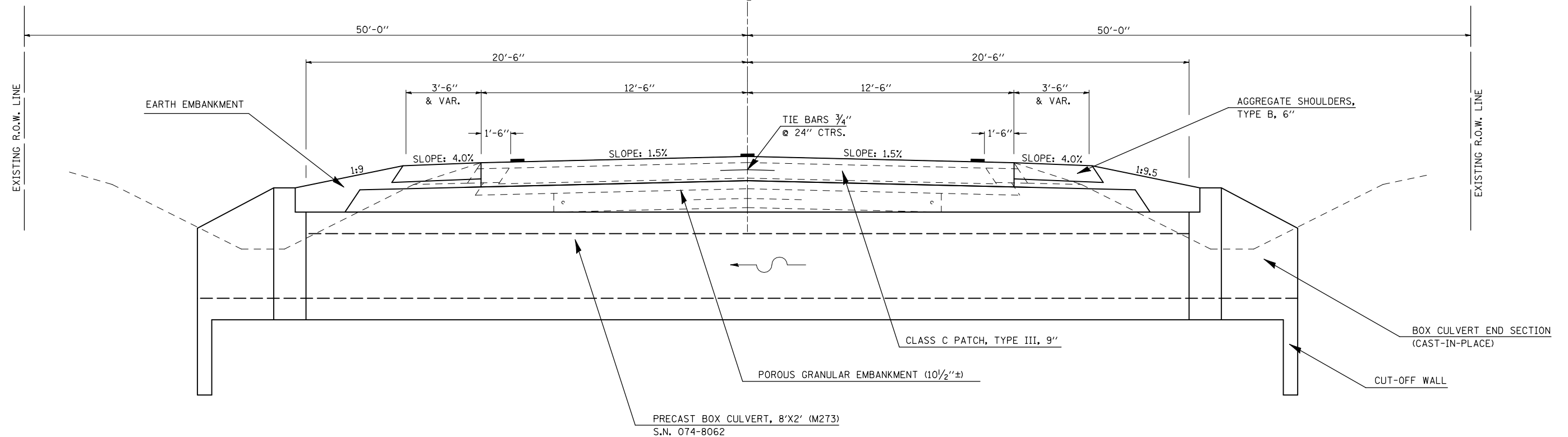

FILE NAME =	USER NAME = hennessdm	DESIGNED -	REVISED -	STATE OF ILLINOIS DEPARTMENT OF TRANSPORTATION	EXISTING & PROPOSED TYPICAL SECTION S.N. 074-8062 (CULVERT #2)	F.A.P. RTE.	SECTION	COUNTY	TOTAL SHEETS	SHEET NO.
ct:\pw\work\p\dot\hennessdm\0184799\0570800-sh1-Typical.dgn		DRAWN -	REVISED -			741	(8,9,10)CR	Platt	65	8
PLOT SCALE = 40.0000' / IN.		CHECKED -	REVISED -							
PLOT DATE = 10/19/2010		DATE -	REVISED -							
					SCALE:	SHEET NO. 2 OF 4 SHEETS		STA.	TO STA.	
ILLINOIS FED. AID PROJECT										