

# STATE OF ILLINOIS

DEPARTMENT OF TRANSPORTATION

DIVISION OF HIGHWAYS

## PROPOSED HIGHWAY PLANS

FAP ROUTE 745 (IL 104)  
SECTION 107 B-1  
ADAMS COUNTY  
PROJECT : BRF-0745(101)  
C-96-064-08

F.A.P. RTE.	SECTION	COUNTY	TOTAL SHEETS	SHEET NO.
745	107 B-1	ADAMS	86	1
FED. ROAD DIST. NO.	ILLINOIS	CONTRACT NO. 72B98		

D-96-064-08

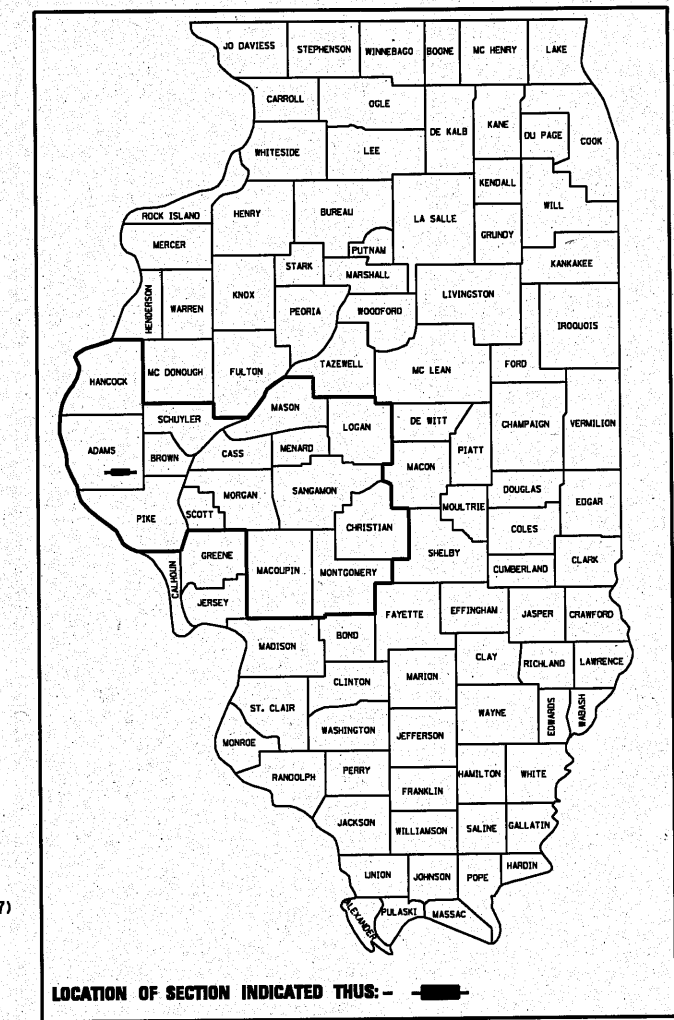

### INDEX OF SHEETS

- 1 COVER SHEET
- 2 GENERAL NOTES
- 3 - 6 SUMMARY OF QUANTITIES
- 7 TYPICAL SECTIONS
- 8 - 13 SCHEDULES OF QUANTITIES
- 14 ALIGNMENT, TIES, BENCHMARKS, AND R.O.W.
- 15 - 17 PLAN AND PROFILE SHEETS
- 18 RESTRICTED WIDTH SINGING DETAIL
- 19 - 24 STAGES OF CONSTRUCTION AND TRAFFIC CONTROL
- 25 - 27 REMOVAL SHEETS
- 28 - 34 EROSION AND SEDIMENT CONTROL
- 35 - 55 STRUCTURE PLANS
- 56 - 61 MISCELLANEOUS DETAILS
- 62 - 74 ROADWAY CROSS SECTIONS
- 75 - 86 CHANNEL EXCAVATION CROSS SECTIONS

### HIGHWAY STANDARDS

000001-06	602601-02	666001-01	781001-03
280001-05	604106-01	701201-04	780001-02
420401-08	606101-04	701306-03	
482011-03	630301-05	701321-11	
515001-03	631031-09	701326-04	
542301-03	635006-03	701901-01	
602306-03	635011-02	704001-06	

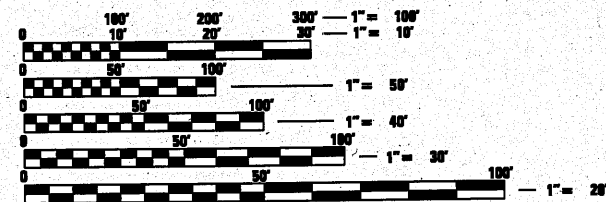

FULL SIZE PLANS HAVE BEEN PREPARED USING STANDARD ENGINEERING SCALES. REDUCED SIZED PLANS WILL NOT CONFORM TO STANDARD SCALES. IN MAKING MEASUREMENTS ON REDUCED PLANS, THE ABOVE SCALES MAY BE USED.

J.U.L.I.E.  
JOINT UTILITY LOCATION INFORMATION FOR EXCAVATION  
1-800-892-0123  
OR 811

PROJECT ENGINEER: SAL MADONIA (217) 782-4761  
SQUAD LEADER: BRIAN LANINGHAM (217) 524-0472

CONTRACT NO. 72B98

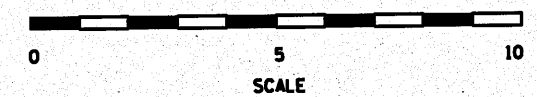
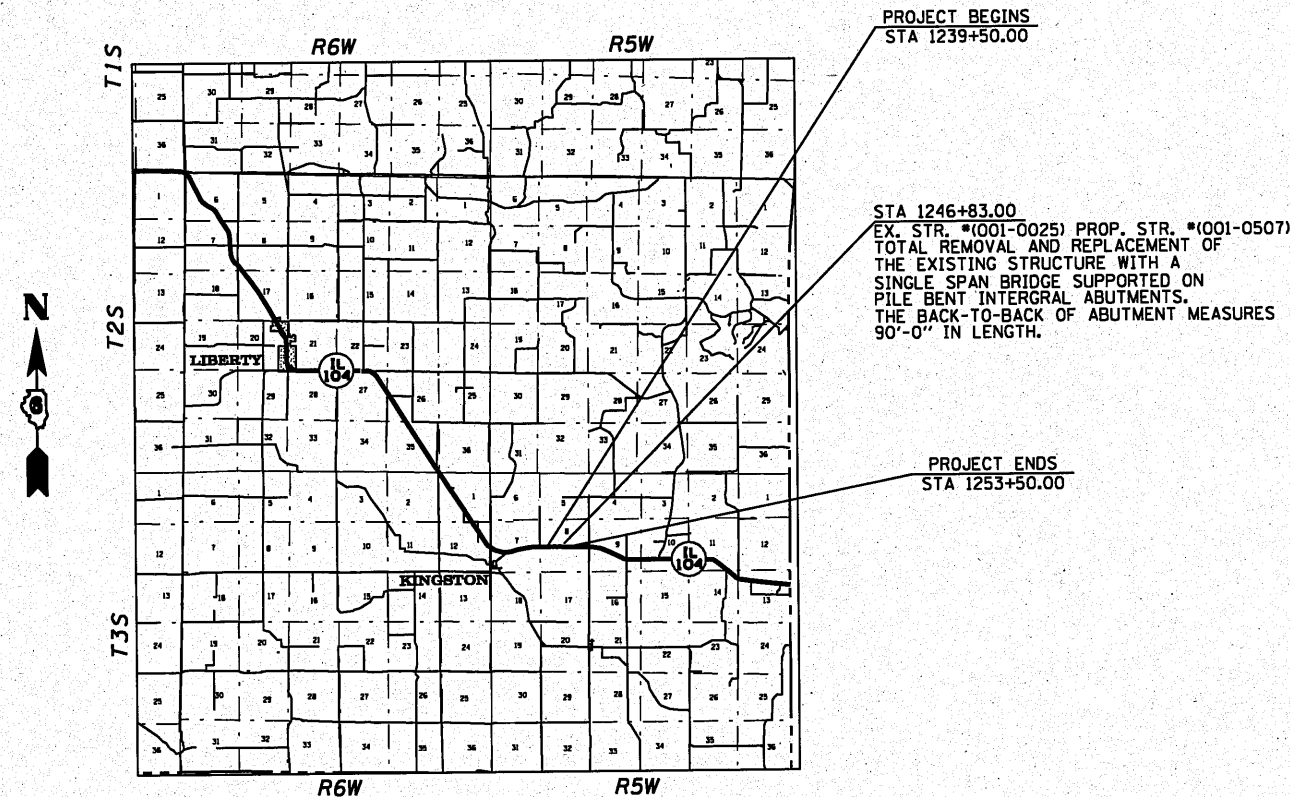

GROSS LENGTH = 1,400.00 FT. = 0.265 MILE  
NET LENGTH = 1,400.00 FT. = 0.265 MILE

PV = 88%  
SU = 6%  
ADT - 800 (2006) MU = 6%

STATE OF ILLINOIS  
DEPARTMENT OF TRANSPORTATION  
DIVISION OF HIGHWAYS

SUBMITTED October 13, 2010  
Rosa Z. Dunbar  
DEPUTY DIRECTOR OF HIGHWAYS, REGION ENGINEER

Dec 10, 2010  
Scott E. Stitt, P.E.  
ENGINEER OF DESIGN AND ENVIRONMENT

Dec 10, 2010  
Christine M. Reed  
DIRECTOR OF HIGHWAYS, CHIEF ENGINEER

PRINTED BY THE AUTHORITY  
OF THE STATE OF ILLINOIS