

RECENT BL 55/VILLAGE CENTER  
DRIVE INTERSECTION IMPROVEMENT -  
RECENT TOPOGRAPHY NOT SHOWN

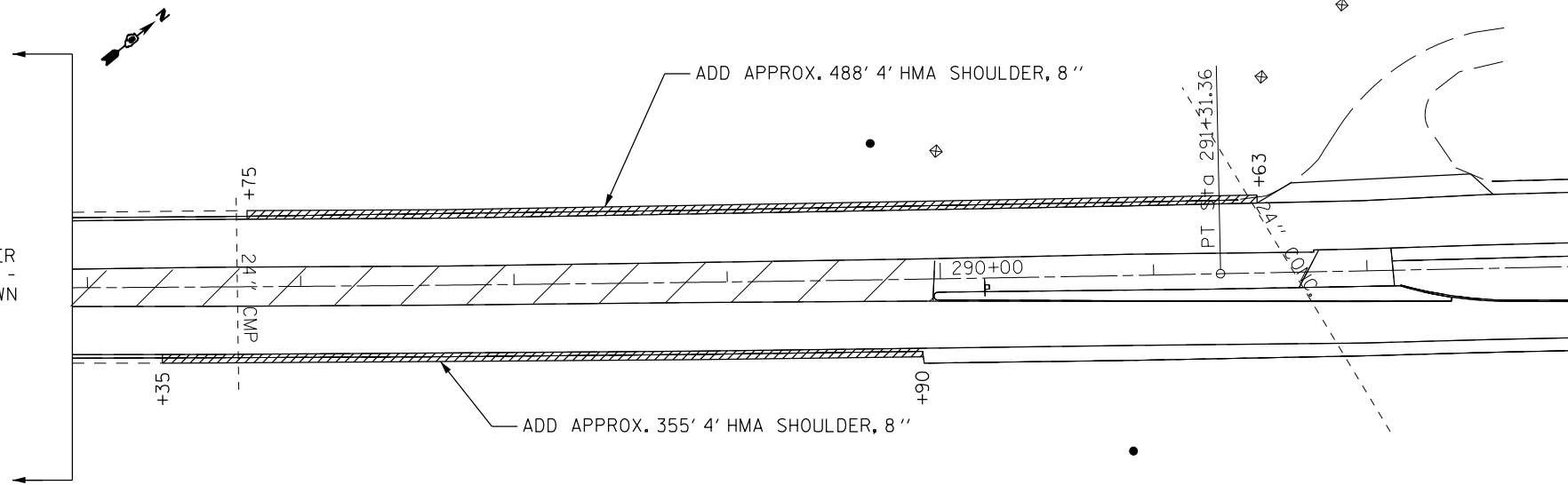

ADD APPROX. 488' 4" HMA SHOULDER, 8"

ADD APPROX. 355' 4" HMA SHOULDER, 8"

57+  
24' CMP

+35

+90

290+00

PT 291+31.36

+63

FILE NAME =	USER NAME = laughlinr1	DESIGNED -	REVISED -
et:\pwork\pwork\laughlinr1\0217723\plansheets.dgn		DRAWN -	REVISED -
	PLOT SCALE = 80.0000' / in.	CHECKED -	REVISED -
	PLOT DATE = Oct-26-2010 07:10:18AM	DATE -	REVISED -

STATE OF ILLINOIS  
DEPARTMENT OF TRANSPORTATION

PLAN VIEW - SPOT SHOULDER  
IMPROVEMENTS

SCALE: SHEET NO. OF SHEETS STA. TO STA.

F.A.S. RTE.	SECTION	COUNTY	TOTAL SHEETS	SHEET NO.
618	(B)RS-4, (O-15)RS-2	SANGAMON	32	27
CONTRACT NO. 72D56			ILLINOIS FED. AID PROJECT	