

STATE OF ILLINOIS
DEPARTMENT OF TRANSPORTATION
DIVISION OF HIGHWAYS

**PROPOSED
HIGHWAY PLANS**

FAS ROUTE 618 (IL 124/ANDREW RD)
SECTION (B)RS-4, (O-15D)RS-2

TYPE of IMPROVEMENT
SANGAMON COUNTY

C-96-187-10

F.A.S. RTE.	SECTION	COUNTY	TOTAL SHEETS	SHEET NO.
618	(B)RS-4, (O-15D)RS-2	SANGAMON	32	1
		ILLINOIS	CONTRACT NO. 72D56	

FOR INDEX OF SHEETS, SEE SHEET NO. 2

LIST OF STANDARDS

000001-06	701001-02	701311-03
001006	701006-03	701326-04
482011-03	701011-02	701422-03
630001-09		701901-01
635006-03	701301-04	780001-02
635001-01	701306-03	781001-03
		701501-06

IL 124 ANDREW RD

ADT (2009) = 1,150 3,800
%MU + %SU = 8.0% 11.5%

IMPROVEMENT ALSO INCLUDES
AREAS OF SHOULDER
IMPROVEMENTS ON BL-I 55
(SHERMAN RD)

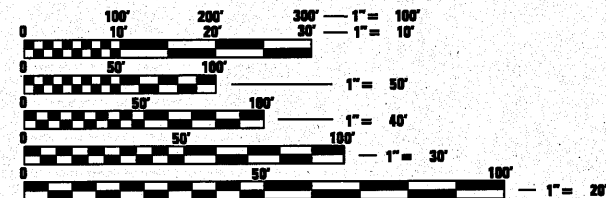

FULL SIZE PLANS HAVE BEEN PREPARED USING STANDARD
ENGINEERING SCALES. REDUCED SIZED PLANS WILL NOT
CONFORM TO STANDARD SCALES. IN MAKING MEASUREMENTS
ON REDUCED PLANS, THE ABOVE SCALES MAY BE USED.

J.U.L.I.E.
JOINT UTILITY LOCATION INFORMATION FOR EXCAVATION
1-800-892-0123
OR 811

PROJECT ENGINEER JOHN NEGANGARD 217-782-6990
PROJECT MANAGER VINCE MADONIA 217-785-9046

CONTRACT NO. 72D56

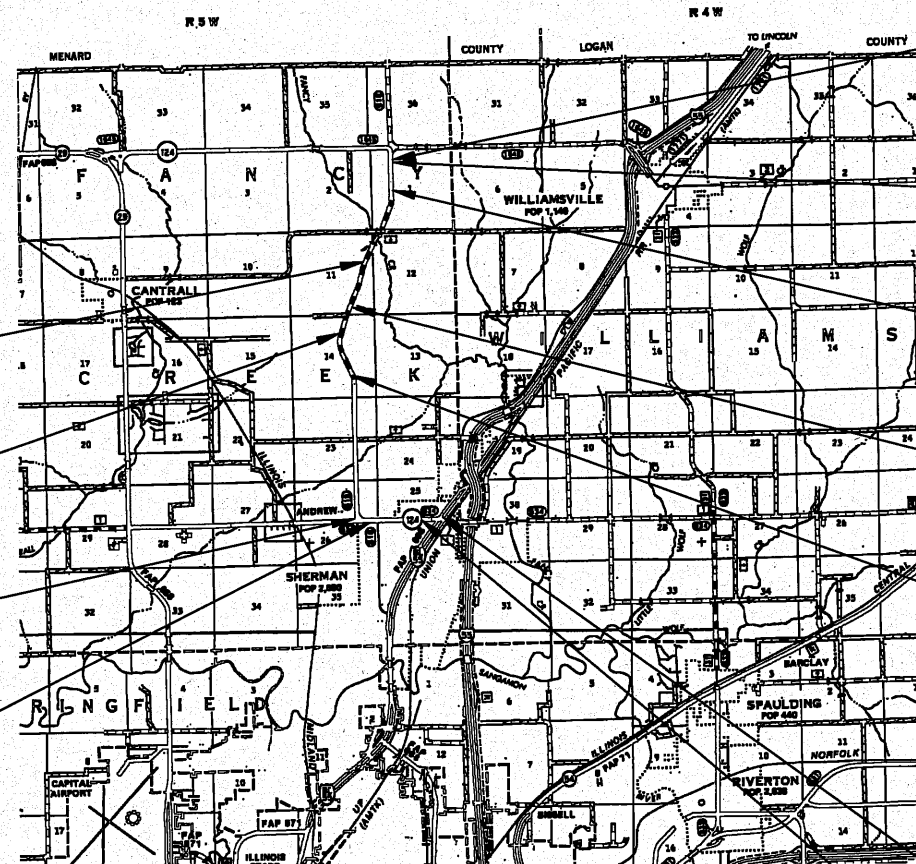

STA EQN
464 + 33.95 (BK) =
465 + 00.00 (AH)

STA EQN
395 + 85.96 (BK) =
396 + 39.54 (AH)

STA EQN
4 + 53.48 (BK) =
276 + 34 (AH)

STA EQN
1121 + 40.34 (BK) =
1 + 00 (AH)

PROJECT ENDS
STA 522 + 50

STA EQN
519 + 92.37 (BK) =
520 + 18.77 (AH)

STA EQN
490 + 03.25 (BK) =
490 + 12.92 (AH)

STA EQN
420 + 32.31 (BK) =
420 + 49.79 (AH)

STA EQN
368 + 98.90 (BK) =
368 + 99.12 (AH)

PROJECT BEGIN
STA 1074 + 47

STA EQN
1076 + 19.10 (BK) =
1075 + 08.40 (AH)

GROSS AND NET LENGTH = 29,600' = 5.61 MI

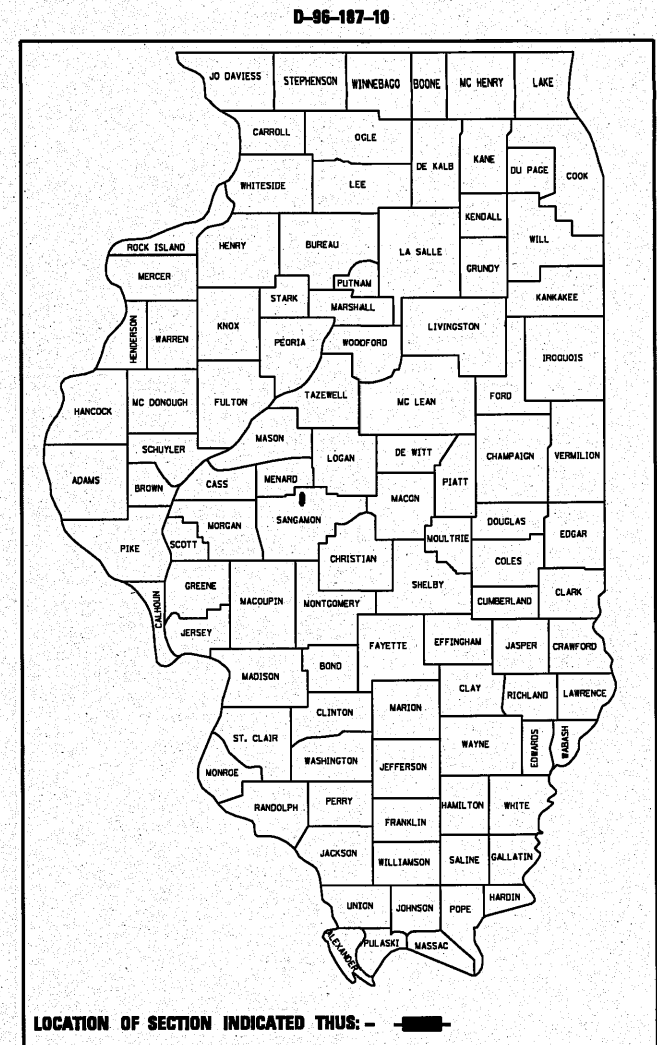

LOCATION OF SECTION INDICATED THUS: - - -

STATE OF ILLINOIS
DEPARTMENT OF TRANSPORTATION
DIVISION OF HIGHWAYS
SUBMITTED October 22, 2010
Ray J. Dineen
DEPUTY DIRECTOR OF HIGHWAYS, REGION ENGINEER
December 10, 2010
Scott E. Stett, P.E.
Acting ENGINEER OF DESIGN AND ENVIRONMENT
December 10, 2010
Christine M. Reed
DIRECTOR OF HIGHWAYS, CHIEF ENGINEER

PRINTED BY THE AUTHORITY
OF THE STATE OF ILLINOIS

GENERAL NOTES

1. ANY REFERENCE TO A STANDARD IN THESE PLANS SHALL BE INTERPRETED TO MEAN THE EDITION AS INDICATED BY THE SUB NUMBER LISTED IN THE INDEX OF SHEETS OR THE COPY OF THE STANDARD INCLUDED IN THESE PLANS.
2. IN ADDITION TO FIELD SURVEYS, PLAN DIMENSIONS AND DETAILS RELATIVE TO THE EXISTING FACILITIES HAVE BEEN TAKEN FROM EXISTING PLANS AND ARE SUBJECT TO CONSTRUCTION VARIATIONS. IT SHALL BE THE CONTRACTOR'S RESPONSIBILITY TO VERIFY SUCH DIMENSIONS AND DETAILS IN THE FIELD. SUCH VARIATIONS SHALL NOT BE A CAUSE FOR ADDITIONAL COMPENSATION DUE TO A CHANGE IN THE SCOPE OF WORK; HOWEVER, THE CONTRACTOR WILL BE PAID FOR THE QUANTITY ACTUALLY FURNISHED AT THE UNIT PRICE BID FOR THE WORK.
3. ACCESS TO ALL ENTRANCES AND SIDE ROADS SHALL BE MAINTAINED AT ALL TIMES.
4. THE CONTRACTOR SHALL BE RESPONSIBLE FOR PROTECTING UTILITY PROPERTY FROM CONSTRUCTION OPERATIONS, AS OUTLINED IN ARTICLE 107.31 OF THE STANDARD SPECIFICATIONS. THE J.U.L.I.E. NUMBER IS 1-800-892-0123. A MINIMUM OF 48 HOURS ADVANCE NOTICE IS REQUIRED.
5. THE THICKNESS OF BITUMINOUS MIXTURES SHOWN ON THE PLANS IS THE NOMINAL THICKNESS. DEVIATIONS FROM THE NOMINAL THICKNESS WILL BE PERMITTED WHEN SUCH DEVIATIONS OCCUR DUE TO IRREGULARITIES IN THE EXISTING SURFACE OR BASE ON WHICH THE BITUMINOUS MIXTURE IS PLACED.
6. ALL SAW CUTS, NECESSARY TO COMPLETE THE WORK DETAILED IN THESE PLANS, SHALL BE INCLUDED IN THE COST FOR THE VARIOUS PAY ITEMS INVOLVED. THE MINIMUM SAW CUT DEPTH IN THE PAVEMENT SHALL BE 1 1/2 " UNLESS OTHERWISE SPECIFIED IN A DETAIL SHOWN IN THE PLANS.
7. UNLESS DIRECTED BY THE ENGINEER, PAVEMENT MARKING LINES SHALL NOT BE LAID DIRECTLY OVER A LONGITUDINAL CRACK OR JOINT NOR OVER A TAR OR ASPHALT PAINTED LINE. THE EDGE OF A CENTERLINE OR LANE LINE SHALL BE OFFSET A MINIMUM DISTANCE OF 2" FROM A LONGITUDINAL CRACK OR JOINT. EDGE LINES SHALL BE APPROXIMATELY 2" FROM THE EDGE LINE OF PAVEMENT. SEE SECTION 760 OF THE STANDARD SPECIFICATIONS FOR TRAFFIC CONTROL ITEMS.
8. NO PASSING ZONES TO BE FIELD VERIFIED BY THE BUREAU OF OPERATIONS. THE RESIDENT ENGINEER SHALL NOTIFY THE BUREAU OF OPERATIONS AT LEAST 14 DAYS PRIOR TO PLACEMENT OF FINAL PERMANENT PAVEMENT MARKING. (PH: 217-785-5312)
9. THE FOLLOWING RATES OF APPLICATION HAVE BEEN USED TO CALCULATE THE PLAN QUANTITIES:
 BITUMINOUS MATERIALS (PRIME COAT) 0.00038 TON/SQ. YD. (ON PAVEMENT)
 BITUMINOUS MATERIALS (PRIME COAT) 0.001425 TON/SQ. YD. (ON AGG.)
 AGGREGATE PRIME COAT 0.002 TON/SQ. YD.
 BITUMINOUS CONCRETE SURFACE / BINDER 0.056 TON/SQ. YD. PER 1"
 AGGREGATE MATERIAL 2.05 TON/CU. YD.

INDEX OF SHEETS

1	COVER SHEET
2	GENERAL NOTES
3-4	SUMMARY OF QUANTITIES
5-7	SCHEDULE OF QUANTITIES
8-13	TYPICAL CROSS SECTIONS
14-27	PLAN VIEW
28-29	DETAILS
30-32	ENTRANCE DETAILS/SCHEDULE

THE FOLLOWING MIXTURE REQUIREMENTS ARE APPLICABLE FOR THIS PROJECT:

MIXTURE USE(S):	•••LEVEL BINDER (MACH METHOD)	•••HMA SURFACE COURSE	INCIDENTAL HMA SURFACE	HMA SHOULDERS
PG:	PG 64-22	PG 64-22	PG 64-22	PG 58-22
DESIGN AIR VOIDS:	4.0% @ N 50	4.0% @ N50	4.0% @ N 50	2.0% @ N 30
MIXTURE COMPOSITION: (GRADATION MIXTURE)	IL 9.5	IL 9.5 OR IL 12.5	IL 9.5 OR IL 12.5	BAM (OTHER)
FRICTION AGGREGATE:	N/A	MIX "C"	MIX "C"	N/A
20 YEAR ESAL	N/A	N/A	N/A	N/A

DISTRICT SIX	
EXAMINED <u>October 19</u> 20 <u>10</u>	
<i>Dirk Walker</i>	
OPERATIONS ENGINEER	
EXAMINED <u>October 21</u> 20 <u>10</u>	
<i>Tony Fountain</i>	
PROJECT IMPLEMENTATION ENGINEER	
EXAMINED <u>October 21</u> 20 <u>10</u>	
<i>ARML</i>	
PROGRAM DEVELOPMENT ENGINEER	

			TOTAL	URBAN ANDREW ROAD 100% State	RURAL IL 124 100% State	RURAL Shoulder 100% State
				0005	0005	0021
20200600	EXCAVATING AND GRADING EXISTING SHOULDER	UNIT	566	78	488	
35800100	PREPARATION OF BASE	SQ YD	2,471	731	1,740	
40200800	AGGREGATE SURFACE COURSE, TYPE B	TON	303	26	277	
40600200	BITUMINOUS MATERIALS (PRIME COAT)	TON	29.4	6.7	22.7	
40600300	AGGREGATE (PRIME COAT)	TON	147.8	28.3	119.5	
40600625	LEVELING BINDER (MACHINE METHOD), N50	TON	3143.8	624	2519.8	
40600895	CONSTRUCTING TEST STRIP	EACH	1	0.5	0.5	
40600982	HOT-MIX ASPHALT SURFACE REMOVAL - BUTT JOINT	SQ YD	554	380	174	
40600990	TEMPORARY RAMP	SQ YD	40	26.7	13.3	
40603310	HOT-MIX ASPHALT SURFACE COURSE, MIX "C", N50	TON	8338.1	1475.4	6862.7	
40800050	INCIDENTAL HOT-MIX ASPHALT SURFACING	TON	795	300	495	
44000200	DRIVEWAY PAVEMENT REMOVAL	SQ YD	110	110		
44004250	PAVED SHOULDER REMOVAL	SQ YD	200		200	
48203023	HOT-MIX ASPHALT SHOULDERS, 6 1/2"	SQ YD	24410.6			24410.6
48203029	HOT-MIX ASPHALT SHOULDERS, 8"	SQ YD	535			535
*63000001	STEEL PLATE BEAM GUARD RAIL, TYPE A, 6 FOOT POSTS	FOOT	75		75	
*63100167	TRAFFIC BARRIER TERMINAL, TYPE 1 (SPECIAL) TANGENT	EACH	16		16	
63200310	GUARDRAIL REMOVAL	FOOT	1275		1275	
64200105	SHOULDER RUMBLE STRIPS	FOOT	48958		48958	

FILE NAME =	USER NAME = laughlinr1	DESIGNED -	REVISED -
et\pwwork\pwwork\laughlinr1\0217723\06	2056-sh1-500.dgn	DRAWN -	REVISED -
	PLOT SCALE = 100.0000 / in.	CHECKED -	REVISED -
	PLOT DATE = Oct-26-2018 07:05:09AM	DATE -	REVISED -

STATE OF ILLINOIS
DEPARTMENT OF TRANSPORTATION

SUMMARY OF QUANTITIES

SCALE: SHEET NO. OF SHEETS STA. TO STA.

F.A.S. RTE.	SECTION	COUNTY	TOTAL SHEETS	SHEET NO.
618	(BRS-4, 10-15)RS-2	SANGAMON	32	3
CONTRACT NO. 72056				
ILLINOIS FED. AID PROJECT				

*Specialty Items

Rev.

0105 2 S 700

			TOTAL	URBAN ANDREW ROAD 100% State	RURAL IL 124 100% State	RURAL Shoulder 100% State
				0005	0005	0021
67100100	MOBILIZATION	L SUM	1	0.2	0.8	
70100320	TRAFFIC CONTROL AND PROTECTION, STANDARD 701422	L SUM	1	0.5	0.5	
70100460	TRAFFIC CONTROL AND PROTECTION, STANDARD 701306	L SUM	1	0.5	0.5	
70100500	TRAFFIC CONTROL AND PROTECTION, STANDARD 701326	L SUM	1	0.5	0.5	
70102620	TRAFFIC CONTROL AND PROTECTION, STANDARD 701501	L SUM	1	1		
70103815	TRAFFIC CONTROL SURVEILLANCE	CAL DA	25	12	13	
70300100	SHORT TERM PAVEMENT MARKING	FOOT	7138	1263	5875	
70301000	WORK ZONE PAVEMENT MARKING REMOVAL	SQ FT	3569	632	2937	
*78001120	PAINT PAVEMENT MARKING - LINE 5"	FOOT	94665	12125	82540	
*78004280	PREFORMED PLASTIC PAVEMENT MARKING, TYPE B - INLAID - LINE 24"	FOOT	32	16	16	
*78100100	RAISED REFLECTIVE PAVEMENT MARKER	EACH	372	66	306	
*78200420	GUARDRAIL MARKERS, TYPE B	EACH	25		25	
*78201000	TERMINAL MARKER - DIRECT APPLIED	EACH	16		16	
78300200	RAISED REFLECTIVE PAVEMENT MARKER REMOVAL	EACH	372	66	306	
X4401198	HOT-MIX ASPHALT SURFACE REMOVAL, VARIABLE DEPTH	SQ YD	74852.1	14857.1	59995	
Z0058670	GRADING AND SHAPING FORESLOPES	UNIT	570	81	489	
X4811300	AGGREGATE SHOULDERS, TYPE B (SPECIAL)	TON	130		130	

*Specialty Items

Rev.

FILE NAME =	USER NAME = laughlinr1	DESIGNED -	REVISED -	STATE OF ILLINOIS DEPARTMENT OF TRANSPORTATION	SUMMARY OF QUANTITIES				F.A.S. RTE.	SECTION	COUNTY	TOTAL SHEETS	SHEET NO.
ct:\pwwork\pwwork\laughlinr1\0217723\062056-shr-S00.dgn		DRAWN -	REVISED -		SCALE:	SHEET NO. OF SHEETS	STA.	TO STA.	618	(BRS-4, IO-15)RS-2	SANGAMON	32	4
		CHECKED -	REVISED -						CONTRACT NO. 72056				
		DATE	REVISED -						ILLINOIS FED. AID PROJECT				

Pavement marking quantity

Location	Length of Roadway (feet)	Quantity (FOOT)		
		No Pass	Skip Dash	Edgeline
Andrew Road				
STA. 1074+47 to STA. 1076+19.1	172.10	160	23.025	344.2
STA. 1075+08.4 to STA. 1121+40.34	4631.94		1157.985	9263.88
STA. 1+00 to STA. 5+60.23	460.23	160	95.0575	920.46
<i>Andrew Rd Subtotal</i>		<i>320</i>	<i>1276</i>	<i>10529</i>
IL 124				
STA. 276+34 to STA. 368+98.90	9264.90	957.8	2196.5	18529.8
STA. 368+98.99.12 to 395+85.96	2686.97	5373.94		5373.94
STA. 396+39.54 to 420+32.31	2392.77	4785.54		4785.54
STA. 420+49.79 to 464+33.95	4384.16	8768.32		8768.32
STA. 465+00 to 522+50	5750.00	11500		11500
<i>IL 24 Subtotal</i>		<i>31386</i>	<i>2197</i>	<i>48958</i>
Total	29743.07	31706	3473	59486

Raised reflective pavement marker quantity

Location	Start Station	End Station	Length (FOOT)	Quantity (EACH)
Andrew Road				
	1074+47.	1076+19.1	172.10	2
	1075+08.4	1121+40.34	4631.94	58
	1+00.	5+60.23	460.23	6
<i>Andrew Rd Subtotal</i>			<i>5264.27</i>	<i>66</i>
IL 124				
	276+34.	368+98.9	9264.90	116
	368+98.99	395+85.96	2686.97	34
	396+39.54	420+32.31	2392.77	30
	420+49.79	464+33.95	4384.16	55
	465+00.	522+50.	5750.00	72
<i>IL 24 Subtotal</i>			<i>24478.80</i>	<i>306</i>
Total			29743	372

Two-way amber markers needed

Shoulder Rumble Strip Quantity

Location	Length of Roadway (FOOT)	Quantity (FOOT)
IL 124		
STA. 276+34 to STA. 368+98.90	9264.90	18529.8
STA. 368+98.99.12 to 395+85.96	2686.97	5373.94
STA. 396+39.54 to 420+32.31	2392.77	4785.54
STA. 420+49.79 to 464+33.95	4384.16	8768.32
STA. 465+00 to 522+50	5750.00	11500
Total	24479	48958

Paving Quantity

Location	Sta to Sta		Length	Pavt Wid	Ex Shld	Pr Shld	HMA SURF	HMA SURF	BIT (PRIME	AGG (PRIME	LVL BINDER	HMA SURF	HMA	HMA	HMA SHOULD
							REM, BUTT JOINT	REM, VD	COAT)	COAT)	MM N50	CSE, MIX C, N50 1-1/2"	SHOULDER 6-1/2"	SHOULDER 8"	REM
							SQ YD	SQ YD	TON	TON	TON	TON	SQ YD	SQ YD	SQ YD
BL 55														535	75
Andrew	1074+47.	1076+19.1	172.1	var	4.0	0.0	63.0	590.3	0.2	1.2	24.8	49.6	0.0	0.0	0.0
	1075+86.6	1075+86.6					56.5								
	1075+08.4	1085+40.	1,031.6	12.0	3.0	0.0	0.0	3,438.7	1.3	5.5	144.4	288.8	0.0	0.0	0.0
	1079+26.2	1079+26.2					44.9								
	1085+40.	1121+40.3	3,600.3	12.0	0.0	3.0	0.0	9,600.9	4.6	19.2	403.2	1,008.1	2,400.2	0.0	0.0
	1087+15.	1087+15.					26.7								
	1090+50.	1090+50.					26.7								
	1095+37.	1095+37.					54.9								
	1102+40.	1102+40.					26.7								
	1111+75.6	1111+75.6					40.8								
	1+00.	5+60.2	460.2	12.0	0.0	3.0	40.0	1,227.2	0.6	2.5	51.5	128.9	306.8	0.0	0.0
Andrew Rd Subtotal			5,264.2				380.2	14,857.1	6.7	28.3	624.0	1,475.4	2,707.0	535.0	75.0
IL 124	276+34.	277+50.	116.0	var	0.0	3.0	0.0	590.0	0.1	0.6	22.3	51.2	80.0	0.0	0.0
	277+50.	365+00.	8,750.0	11.0	0.0	4.0	0.0	21,388.9	8.1	42.8	898.3	2,450.0	7,777.8	0.0	0.0
	329+29.	329+29.					53.3								
	365+00.	368+98.9	398.9	11.0	0.0	4.0	0.0	975.1	0.4	2.0	41.0	111.7	354.6	0.0	0.0
	368+99.1	395+86.	2,686.8	11.0	0.0	4.0	0.0	6,567.8	2.5	13.1	275.8	752.3	2,388.3	0.0	0.0
	396+39.5	420+32.3	2,392.8	11.0	0.0	4.0	0.0	5,849.0	2.2	11.7	245.7	670.0	2,126.9	0.0	0.0
	420+49.8	464+34.	4,384.2	11.0	0.0	4.0	0.0	10,716.8	4.1	21.4	450.1	1,227.6	3,897.0	0.0	0.0
	469+00.	469+00.					53.3								
	465+00.	490+03.3	2,503.3	11.0	0.0	4.0	0.0	6,119.1	2.3	12.2	257.0	700.9	2,225.1	0.0	0.0
	490+12.9	519+92.4	2,979.5	11.0	0.0	4.0	0.0	7,283.1	2.8	14.6	305.9	834.2	2,648.4	0.0	0.0
	520+18.8	522+50.	231.2	11.0	0.0	4.0	67.0	565.2	0.2	1.1	23.7	64.7	205.5	0.0	0.0
IL 24 Subtotal			24,442.6				173.7	59,995.0	22.7	119.5	2,519.8	6,862.7	21,703.6	0.0	0.0
Total			29,706.8				553.8	74,852.1	29.4	147.9	3,143.8	8,338.1	24,410.7	535.0	75.0

Short-Term Pavement Marker Quantity

Location	Start Station	End Station	Length (FOOT)	Quantity (FOOT)	
				Center Skip Dash	Shoulder 4'
Andrew Road	1074+47.	1076+19.1	172.10	34	6.88
	1075+08.4	1121+40.34	4631.94	926	185.28
	1+00.	5+60.23	460.23	92	18.41
Andrew Rd Subtotal			5264.27	1053	211
IL 124	276+34.	368+98.9	9264.90	1853	370.60
	368+98.99	395+85.96	2686.97	537	107.48
	396+39.54	420+32.31	2392.77	479	95.71
	420+49.79	464+33.95	4384.16	877	175.37
	465+00.	522+50.	5750.00	1150	230.00
IL 24 Subtotal			24478.80	4896	979
Total			29743	5949	1190

FILE NAME =
c:\pwork\pwidet\novakovid\0217723\072056-shr-schedule.dgn

USER NAME = novakovid	DESIGNED -	REVISED -
PLOT SCALE = 1/8"=1'-0" / IN.	DRAWN -	REVISED -
PLOT DATE = Dec-03-2010 09:34:53AM	CHECKED -	REVISED -
	DATE -	REVISED -

STATE OF ILLINOIS
DEPARTMENT OF TRANSPORTATION

SCHEDULE

SCALE:	SHEET NO.	OF	SHEETS	STA.	TO STA.
--------	-----------	----	--------	------	---------

F.A.S. RTE.	SECTION	COUNTY	TOTAL SHEETS	SHEET NO.
618	(BRS-4, (G-15D)RS-2	SANGAMON	32	6
CONTRACT NO. 72056				
ILLINOIS FED. AID PROJECT				

Work Zone Pavement Marking Removal

Location	Start Station	End Station	Length (FOOT)	Quantity (FOOT)	
				Center Skip Dash	Shoulder 4'
Andrew Road	1074+47.	1076+19.1	172.10	17	3.442
	1075+08.4	1121+40.34	4631.94	463	92.6388
	1+00.	5+60.23	460.23	46	9.2046
<i>Andrew Rd Subtotal</i>			5264.27	526	105
IL 124	276+34.	368+98.9	9264.90	926	185.298
	368+98.99	395+85.96	2686.97	269	53.7394
	396+39.54	420+32.31	2392.77	239	47.8554
	420+49.79	464+33.95	4384.16	438	87.6832
	465+00.	522+50.	5750.00	575	115
<i>IL 24 Subtotal</i>			24478.80	2448	490
Total			29743	2974	595

Grading, Shaping, and Seeding Foreslope

Location	Station to Station		Length (FOOT)	Quantity (Unit)
Andrew Road	1085+40.	1121+40.34	3600.34	72.01
	1+00.	5+60.23	460.23	9.20
<i>Andrew Rd Subtotal</i>			4060.57	81.21
IL 124	276+34.	368+98.9	9264.90	185.30
	368+98.99	395+85.96	2686.97	53.74
	396+39.54	420+32.31	2392.77	47.86
	420+49.79	464+33.95	4384.16	87.68
	465+00.	522+50.	5750.00	115.00
<i>IL 24 Subtotal</i>			24478.80	489.58
Total			28539	571

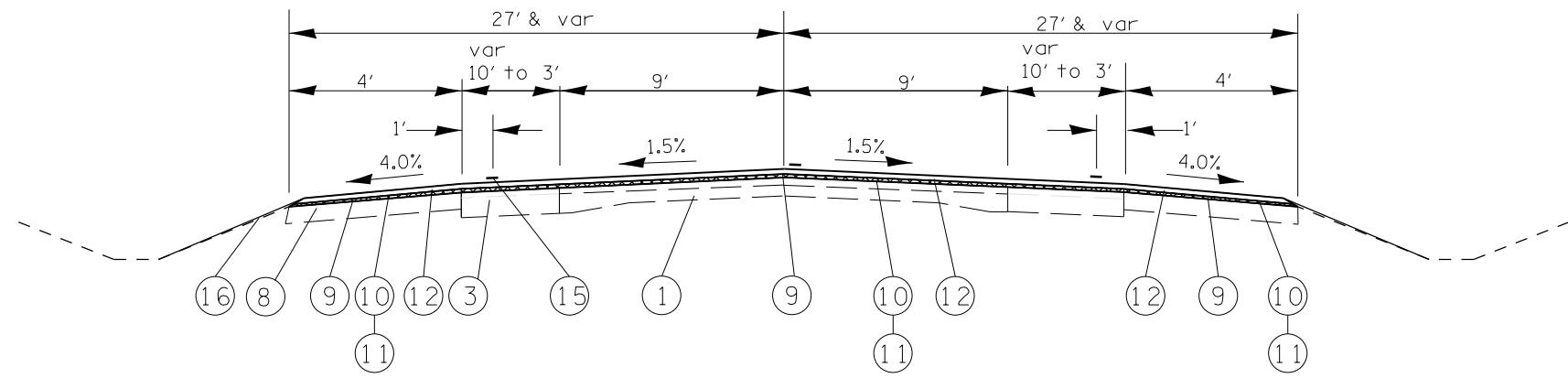

STA 1074+47 TO STA 1076+19.1 (BK) = STA 1075+08.4 (AH)
 STA 1075+08.4 TO STA 1085+40

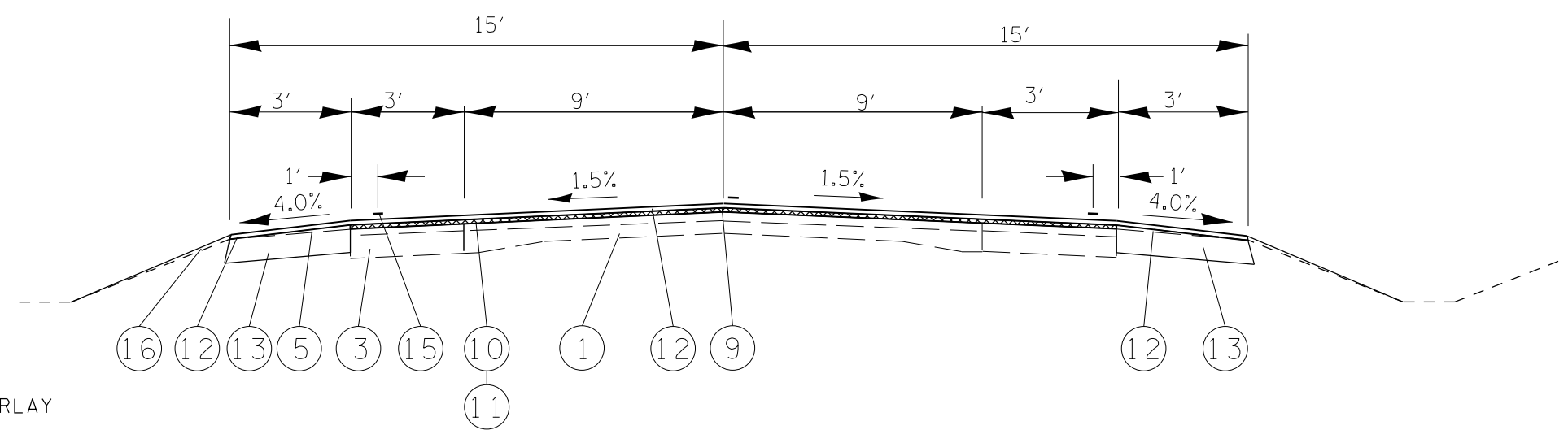

STA 1085+40 TO STA 1121+40.34 (BK) = 1+00 (AH)
 STA 1+00 TO STA 4+53.48 (BK) = 276+34 (AH)

LEGEND

- 1 EXISTING PCC PAVEMENT (9-6-9) & 6" BIT OVERLAY
- 2 EXISTING PCC PAVEMENT (9-6-9) & 5 1/2" BIT OVERLAY
- 3 EXISTING HMA BASE COURSE 9" & 3" HMA OVERLAY
- 4 EXISTING HMA BASE COURSE 8" & 3" HMA OVERLAY
- 5 EXISTING AGGREGATE SHOULDERS
- 6 EXISTING ROCKFILL AND CAPSTONE 15"
- 7 EXISTING HMA PAVEMENT, 11 1/4" B BINDER, 1 1/2" C SURFACE
- 8 EXISTING HMA SHOULDERS 8"
- 9 EXISTING HMA OVERLAY - 2 1/4"
- 10 HMA SURFACE REMOVAL - VAR. DEPTH
- 11 LEVELING BINDER COURSE - 3/4"
- 12 HMA SURFACE COURSE - 1 1/2"
- 13 HMA SHOULDERS - 6 1/2"
- 14 HMA SHOULDERS - 8"
- 15 PROPOSED PAVEMENT MARKING LINE, 5"
- 16 PROPOSED GRADING AND SHAPING FORESLOPES
- 17 PROPOSED AGGREGATE SHOULDER, TY-B

NOTE: STRIPE ALL PAVEMENT FOR 11' LANES WITH 4' SHOULDERS

FILE NAME =	USER NAME = laughlinc1	DESIGNED -	REVISED -	STATE OF ILLINOIS DEPARTMENT OF TRANSPORTATION	TYPICAL CROSS SECTION			F.A.S. RTE.	SECTION	COUNTY	TOTAL SHEETS	SHEET NO.
et:\pwork\pwork\laughlinc1\0217723\062056-shr-typical.dgn		DRAWN -	REVISED -		SCALE:	SHEET NO. OF SHEETS	STA. TO STA.	618	(B)RS-4, (O-15)DRS-2	SANGAMON	32	8
		CHECKED -	REVISED -					CONTRACT NO. 72D56				
		DATE -	REVISED -		ILLINOIS FED. AID PROJECT							

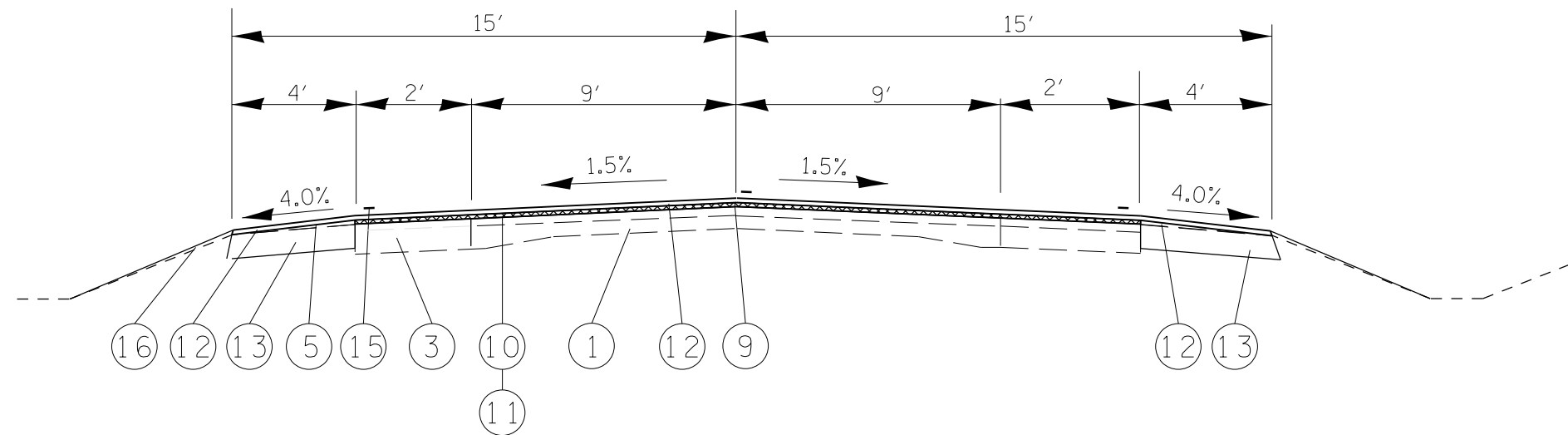

STA 276+34 TO STA 365+00

LEGEND

- 1 EXISTING PCC PAVEMENT (9-6-9) & 6" BIT OVERLAY
- 2 EXISTING PCC PAVEMENT (9-6-9) & 5 1/2" BIT OVERLAY
- 3 EXISTING HMA BASE COURSE 9" & 3" HMA OVERLAY
- 4 EXISTING HMA BASE COURSE 8" & 3" HMA OVERLAY
- 5 EXISTING AGGREGATE SHOULDERS
- 6 EXISTING ROCKFILL AND CAPSTONE 15"
- 7 EXISTING HMA PAVEMENT, 11 1/4" B BINDER, 1 1/2" C SURFACE
- 8 EXISTING HMA SHUOLDERS 8"
- 9 EXISTING HMA OVERLAY - 2 1/4"
- 10 HMA SURFACE REMOVAL - VAR. DEPTH
- 11 LEVELING BINDER COURSE - 3/4"
- 12 HMA SURFACE COURSE - 1 1/2"
- 13 HMA SHOULDERS - 6 1/2"
- 14 HMA SHOULDERS - 8"
- 15 PROPOSED PAVEMENT MARKING LINE, 5"
- 16 PROPOSED GRADING AND SHAPING FORESLOPES
- 17 PROPOSED AGGREGATE SHOULDER, TY-B

NOTE: STRIPE ALL PAVEMENT FOR 11' LANES WITH 4' SHOULDERS

FILE NAME =	USER NAME = laughlinr1	DESIGNED -	REVISED -	STATE OF ILLINOIS DEPARTMENT OF TRANSPORTATION	TYPICAL CROSS SECTION			F.A.S. RTE.	SECTION	COUNTY	TOTAL SHEETS	SHEET NO.
et:\pw\work\p\pidot\laughlinr1\0217723\062056-shr-typical.dgn		DRAWN -	REVISED -		SCALE:	SHEET NO. OF SHEETS	STA. TO STA.	618	(B)RS-4, (O-15)RS-2	SANGAMON	32	9
		CHECKED -	REVISED -					CONTRACT NO. 72D56				
		DATE -	REVISED -		ILLINOIS FED. AID PROJECT							

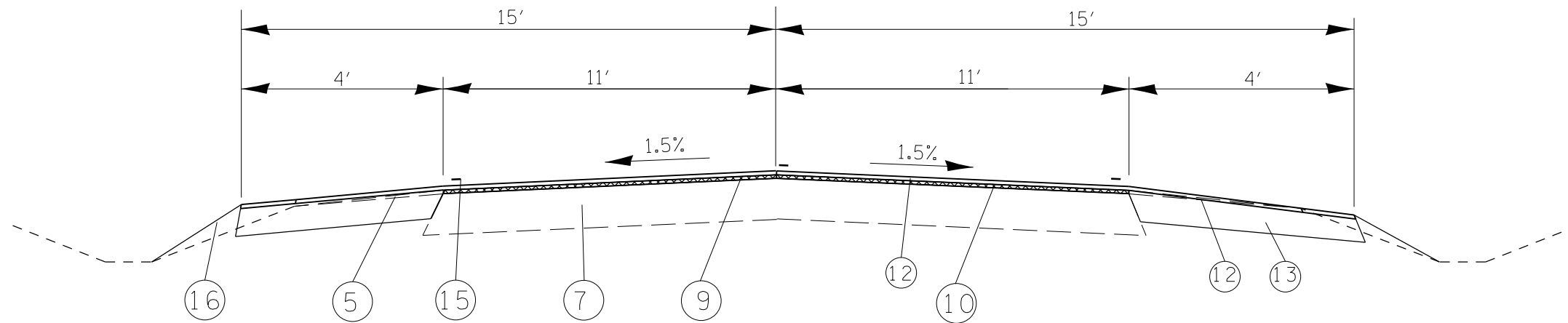

STA 365+00 TO STA 368+98.0 (BK) = STA 368+99.12 (AH)
 STA 368+99.12 TO STA 371+50
 STA 375+43 TO STA 377+80
 STA 406+17.42 TO STA 408+60

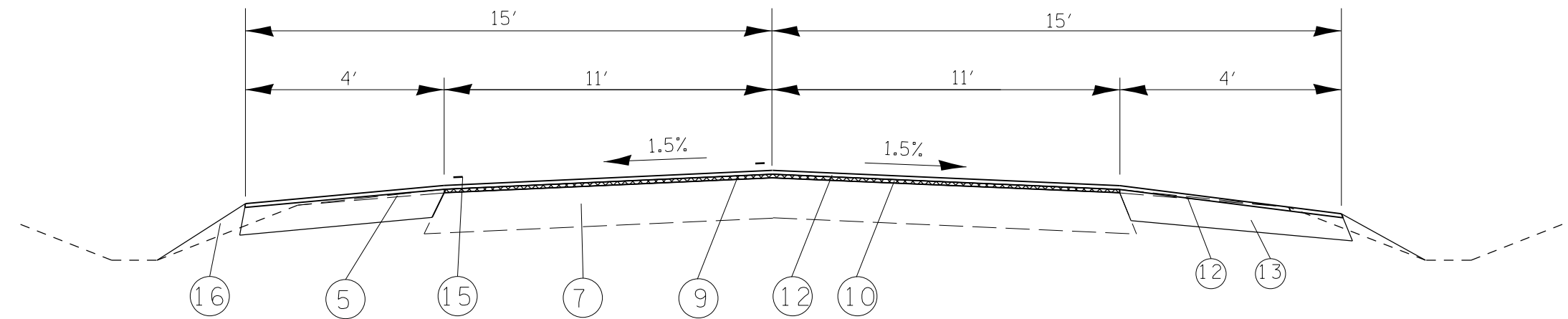

STA 416+94 TO STA 420+32.31 (BK) = STA 420+49.79 (AH)
 STA 482+92.57 TO STA 485+29
 STA 487+67 TO STA 490+03.25 (BK) = STA 490+12.91 (AH)

NOTE: STRIPE ALL PAVEMENT FOR 11' LANES WITH 4' SHOULDERS

LEGEND

- 1 EXISTING PCC PAVEMENT (9-6-9) & 6" BIT OVERLAY
- 2 EXISTING PCC PAVEMENT (9-6-9) & 5 1/2" BIT OVERLAY
- 3 EXISTING HMA BASE COURSE 9" & 3" HMA OVERLAY
- 4 EXISTING HMA BASE COURSE 8" & 3" HMA OVERLAY
- 5 EXISTING AGGREGATE SHOULDERS
- 6 EXISTING ROCKFILL AND CAPSTONE 15"
- 7 EXISTING HMA PAVEMENT, 11 1/4" B BINDER, 1 1/2" C SURFACE
- 8 EXISTING HMA SHOULDERS 8"
- 9 EXISTING HMA OVERLAY - 2 1/4"
- 10 HMA SURFACE REMOVAL - VAR. DEPTH
- 11 LEVELING BINDER COURSE - 3/4"
- 12 HMA SURFACE COURSE - 1 1/2"
- 13 HMA SHOULDERS - 6 1/2"
- 14 HMA SHOULDERS - 8"
- 15 PROPOSED PAVEMENT MARKING LINE, 5"
- 16 PROPOSED GRADING AND SHAPING FORESLOPES
- 17 PROPOSED AGGREGATE SHOULDER, TY-B

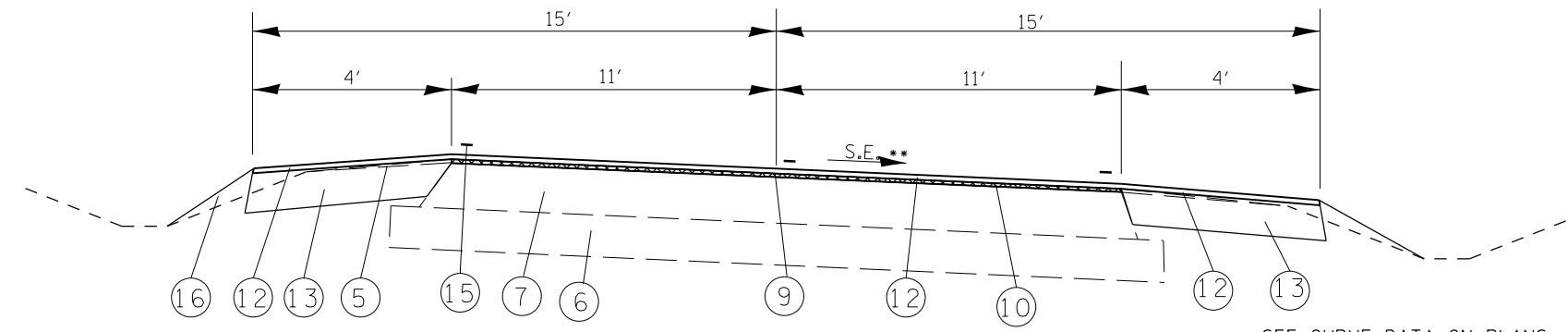

STA 371+50 TO STA 375+43
 STA 377+80 TO STA 377+98.99
 STA 382+66.89 TO STA 395+85.96 (BK) = STA 396+39.54 (AH)
 STA 413+70.32 TO STA 416+94
 STA 470+94.59 TO STA 476+30
 STA 485+29 TO STA 486+00

** SEE CURVE DATA ON PLANS

FILE NAME =	USER NAME = laughlinc1	DESIGNED -	REVISED -	STATE OF ILLINOIS DEPARTMENT OF TRANSPORTATION	TYPICAL CROSS SECTION			F.A.S. R.T.E.	SECTION	COUNTY	TOTAL SHEETS	SHEET NO.
et:\pwork\pwork\laughlinc1\0217723\062056-sh-typical.dgn		DRAWN -	REVISED -		SCALE:	SHEET NO. OF SHEETS	STA. TO STA.	618	(B)RS-4, (O-15)RS-2	SANGAMON	32	10
		CHECKED -	REVISED -					CONTRACT NO. 72D56				
		DATE -	REVISED -		ILLINOIS FED. AID PROJECT							

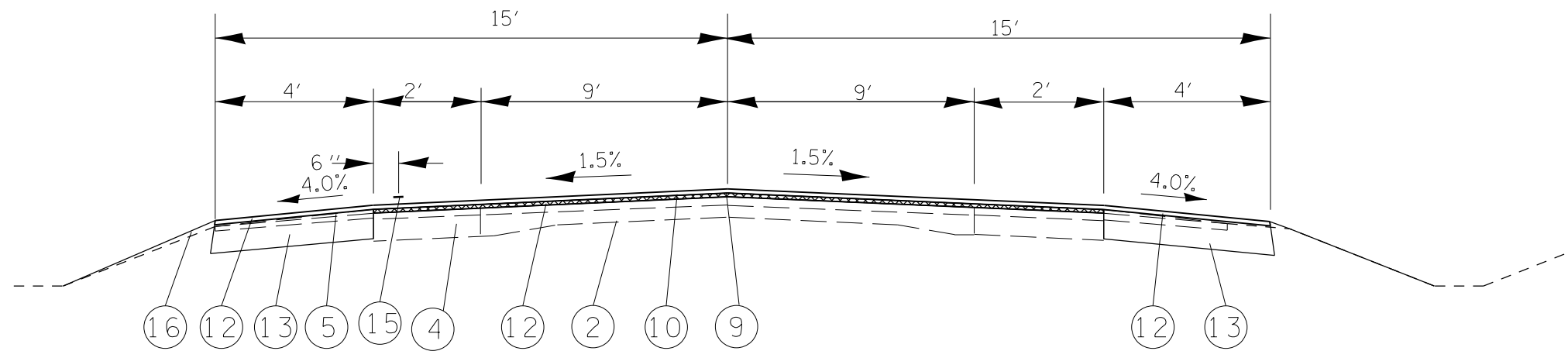

STA 397+32.66 TO STA 406+17.42
 STA 421+79.01 TO STA 428+50.52
 STA 441+33.12 TO STA 462+00
 STA 477+14.81 TO STA 481+45.93
 STA 491+49.99 TO STA 519+92.37 (BK) = STA 520+18.77 (AH)

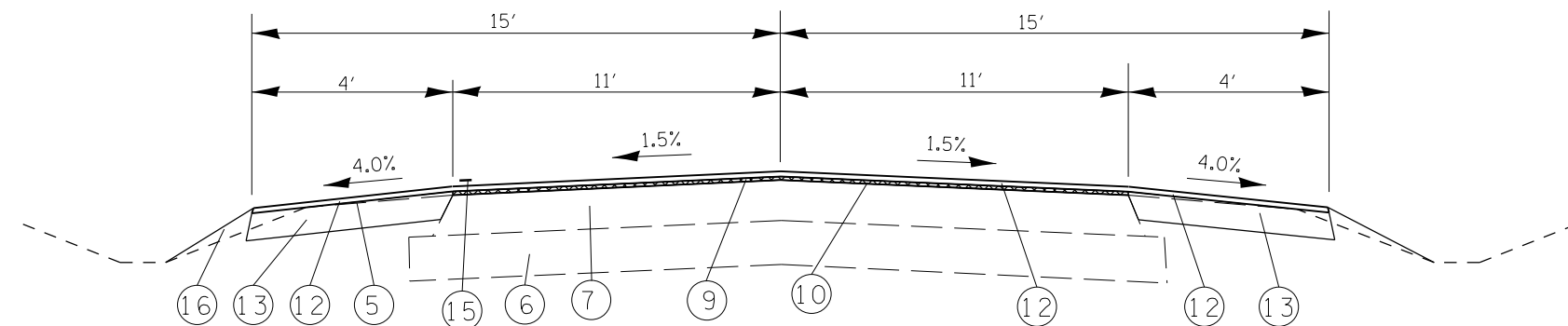

LEGEND

- 1 EXISTING PCC PAVEMENT (9-6-9) & 6" BIT OVERLAY
- 2 EXISTING PCC PAVEMENT (9-6-9) & 5 1/2" BIT OVERLAY
- 3 EXISTING HMA BASE COURSE 9" & 3" HMA OVERLAY
- 4 EXISTING HMA BASE COURSE 8" & 3" HMA OVERLAY
- 5 EXISTING AGGREGATE SHOULDERS
- 6 EXISTING ROCKFILL AND CAPSTONE 15"
- 7 EXISTING HMA PAVEMENT, 11 1/4" B BINDER, 1 1/2" C SURFACE
- 8 EXISTING HMA SHOULDERS 8"
- 9 EXISTING HMA OVERLAY - 2 1/4"
- 10 HMA SURFACE REMOVAL - VAR. DEPTH
- 11 LEVELING BINDER COURSE - 3/4"
- 12 HMA SURFACE COURSE - 1 1/2"
- 13 HMA SHOULDERS - 6 1/2"
- 14 HMA SHOULDERS - 8"
- 15 PROPOSED PAVEMENT MARKING LINE, 5"
- 16 PROPOSED GRADING AND SHAPING FORESLOPES
- 17 PROPOSED AGGREGATE SHOULDER, TY-B

STA 377+88.99 TO STA 382+66.89
 STA 408+60 TO STA 413+70.32
 STA 462+00 TO 464+33.95 (BK) = STA 465+00 (AH)
 STA 465+00 TO STA 465+52.96
 STA 465+52.96 TO STA 466+38.96 BRIDGE OMISSION
 STA 466+02 TO STA 470+94.59

NOTE: STRIPE ALL PAVEMENT FOR 11' LANES WITH 4' SHOULDERS

FILE NAME =	USER NAME = laughlrr1	DESIGNED -	REVISED -	STATE OF ILLINOIS DEPARTMENT OF TRANSPORTATION	TYPICAL CROSS SECTION			F.A.S. RTE.	SECTION	COUNTY	TOTAL SHEETS	SHEET NO.	
et:\pwork\pwork\laughlrr1\0217723\062056-shr-typical.dgn		DRAWN -	REVISED -		SCALE:	SHEET NO. OF	SHEETS	STA. TO STA.	618	(B)RS-4, (O-15)DRS-2	SANGAMON	32	11
		CHECKED -	REVISED -					CONTRACT NO. 72D56			ILLINOIS FED. AID PROJECT		
		DATE -	REVISED -										

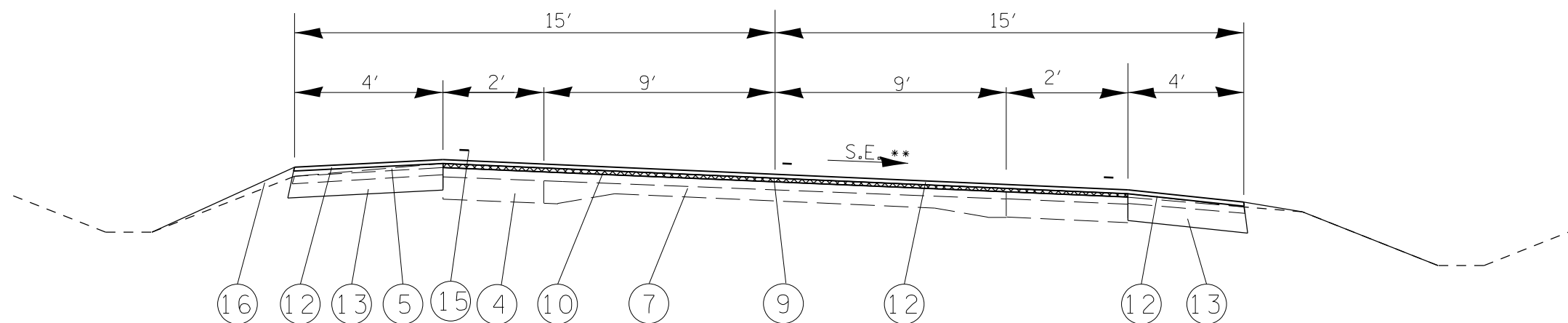

STA 396+39.54 TO STA 397+32.66
 STA 420+49.79 TO STA 421+79.01
 STA 428+50.52 TO STA 441+33.12
 STA 476+30 TO STA 477+14.81
 STA 481+45.93 TO STA 482+92.67
 STA 490+12.91 TO STA 491+49.99

** SEE CURVE DATA ON PLANS

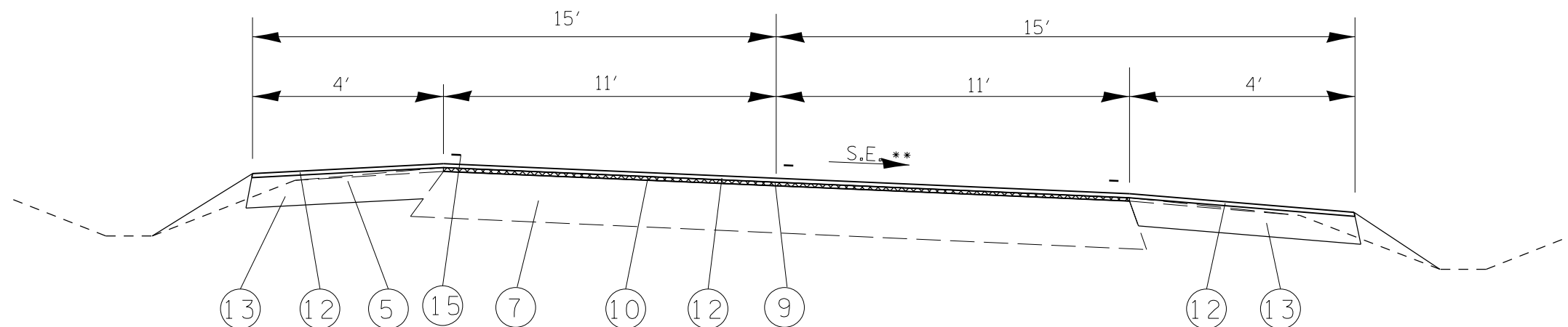

STA 486+00 TO STA 487+67

LEGEND

- 1 EXISTING PCC PAVEMENT (9-6-9) & 6" BIT OVERLAY
- 2 EXISTING PCC PAVEMENT (9-6-9) & 5 1/2" BIT OVERLAY
- 3 EXISTING HMA BASE COURSE 9" & 3" HMA OVERLAY
- 4 EXISTING HMA BASE COURSE 8" & 3" HMA OVERLAY
- 5 EXISTING AGGREGATE SHOULDERS
- 6 EXISTING ROCKFILL AND CAPSTONE 15"
- 7 EXISTING HMA PAVEMENT, 11 1/4" B BINDER, 1 1/2" C SURFACE
- 8 EXISTING HMA SHOULDERS 8"
- 9 EXISTING HMA OVERLAY - 2 1/4"
- 10 HMA SURFACE REMOVAL - VAR. DEPTH
- 11 LEVELING BINDER COURSE - 3/4"
- 12 HMA SURFACE COURSE - 1 1/2"
- 13 HMA SHOULDERS - 6 1/2"
- 14 HMA SHOULDERS - 8"
- 15 PROPOSED PAVEMENT MARKING LINE, 5"
- 16 PROPOSED GRADING AND SHAPING FORESLOPES
- 17 PROPOSED AGGREGATE SHOULDER, TY-B

NOTE: STRIPE ALL PAVEMENT FOR 11' LANES WITH 4' SHOULDERS

FILE NAME =	USER NAME = laughlir1	DESIGNED -	REVISED -	STATE OF ILLINOIS DEPARTMENT OF TRANSPORTATION	TYPICAL CROSS SECTION			F.A.S. RTE.	SECTION	COUNTY	TOTAL SHEETS	SHEET NO.
et:\pwork\pwork\laughlir1\0217723\062056-shr-typical.dgn		DRAWN -	REVISED -		SCALE:	SHEET NO. OF SHEETS	STA. TO STA.	618	(B)RS-4, (O-15)RS-2	SANGAMON	32	12
		CHECKED -	REVISED -					CONTRACT NO. 72D56				
		DATE -	REVISED -		ILLINOIS FED. AID PROJECT							

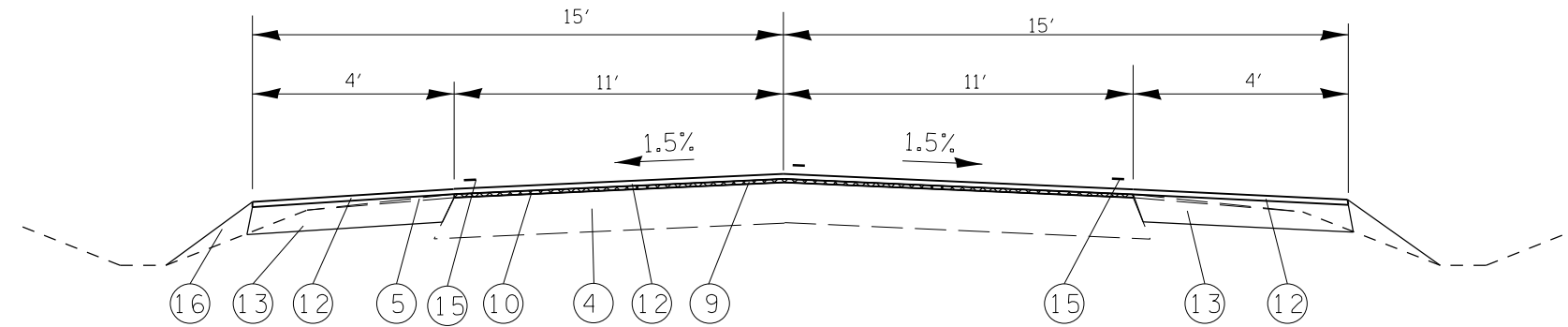

STA 520+18.77 TO STA 522+95

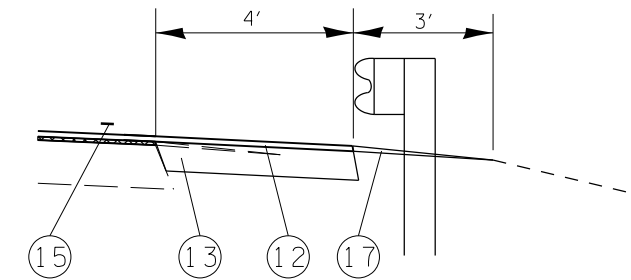

GUARDRAIL SECTION

NOTE: STRIPE ALL PAVEMENT FOR 11' LANES WITH 4' SHOULDERS

LEGEND

- 1 EXISTING PCC PAVEMENT (9-6-9) & 6" BIT OVERLAY
- 2 EXISTING PCC PAVEMENT (9-6-9) & 5 1/2" BIT OVERLAY
- 3 EXISTING HMA BASE COURSE 9" & 3" HMA OVERLAY
- 4 EXISTING HMA BASE COURSE 8" & 3" HMA OVERLAY
- 5 EXISTING AGGREGATE SHOULDERS
- 6 EXISTING ROCKFILL AND CAPSTONE 15"
- 7 EXISTING HMA PAVEMENT, 11 1/4" B BINDER, 1 1/2" C SURFACE
- 8 EXISTING HMA SHOULDERS 8"
- 9 EXISTING HMA OVERLAY - 2 1/4"
- 10 HMA SURFACE REMOVAL - VAR. DEPTH
- 11 LEVELING BINDER COURSE - 3/4"
- 12 HMA SURFACE COURSE - 1 1/2"
- 13 HMA SHOULDERS - 6 1/2"
- 14 HMA SHOULDERS - 8"
- 15 PROPOSED PAVEMENT MARKING LINE, 5"
- 16 PROPOSED GRADING AND SHAPING FORESLOPES
- 17 PROPOSED AGGREGATE SHOULDER, TY-B

FILE NAME =	USER NAME = laughlinc1	DESIGNED -	REVISED -	STATE OF ILLINOIS DEPARTMENT OF TRANSPORTATION	TYPICAL CROSS SECTION			F.A.S. RTE.	SECTION	COUNTY	TOTAL SHEETS	SHEET NO.		
et:\pwork\pwork\laughlinc1\0217723\062056-shr-typical.dgn		DRAWN -	REVISED -		SCALE:	SHEET NO. OF	SHEETS	STA.	TO STA.	618	(B)RS-4, (O-15)RS-2	SANGAMON	32	13
		CHECKED -	REVISED -											
		DATE -	REVISED -											
	PLOT SCALE = 100.0000' / in.													
	PLOT DATE = Oct-26-2010 07:41:08AM													
CONTRACT NO. 72D56											ILLINOIS FED. AID PROJECT			

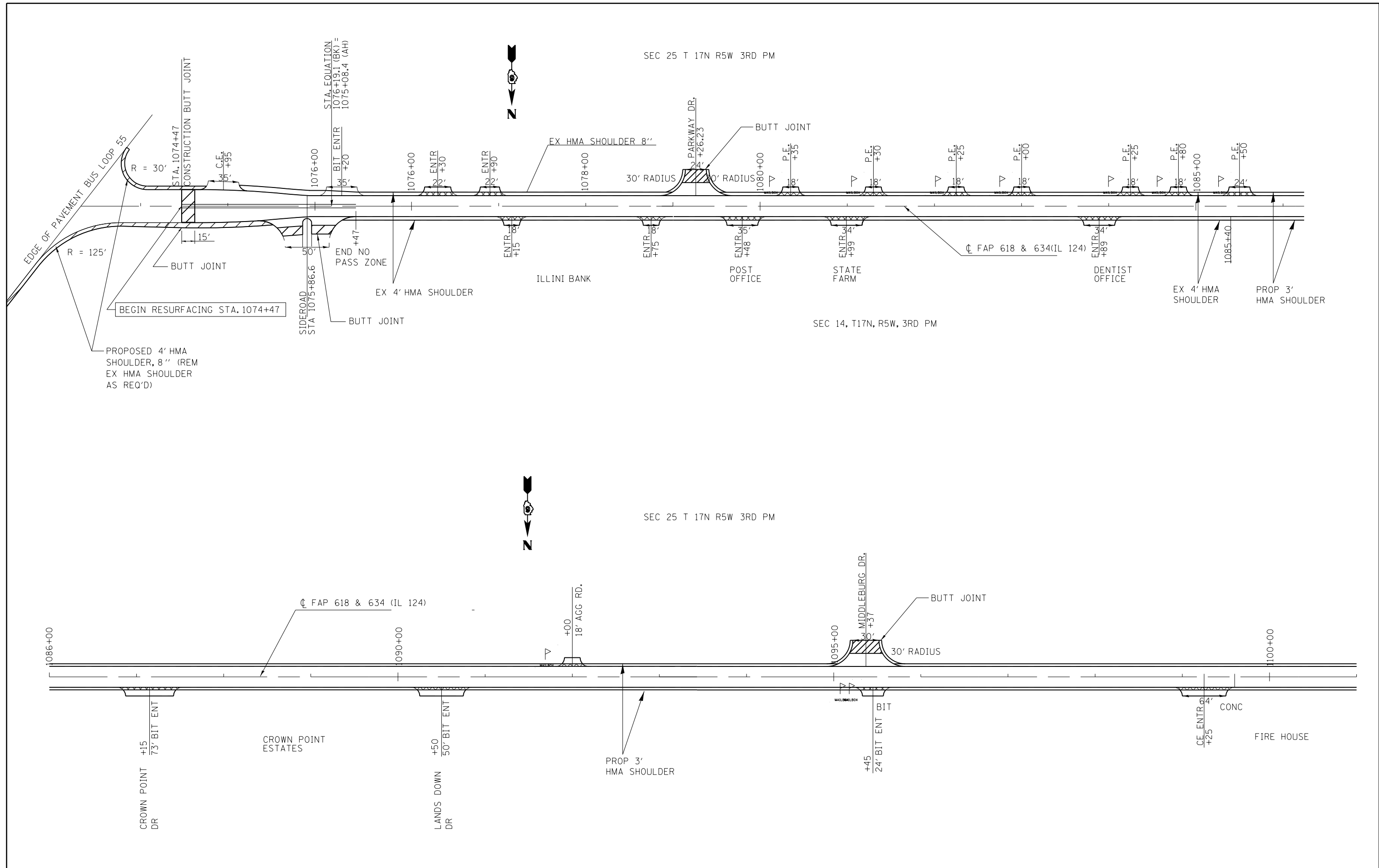

FILE NAME =	USER NAME = laughlinc1	DESIGNED -	REVISED -
et:\pw\work\p\dtdot\laughlinc1\0217723\062056-shr-plan.dgn		DRAWN -	REVISED -
		CHECKED -	REVISED -
		DATE -	REVISED -
	PLOT SCALE = 100.0000' / in.		
	PLOT DATE = Oct-26-2010 07:10:07AM		

**STATE OF ILLINOIS
DEPARTMENT OF TRANSPORTATION**

PLAN VIEW			
SCALE:	SHEET NO. OF	SHEETS	STA. TO STA.

F.A.S. RTE.	SECTION	COUNTY	TOTAL SHEETS	SHEET NO.
618	(B)RS-4, (O-15)DRS-2	SANGAMON	32	14
CONTRACT NO. 72D56				
ILLINOIS FED. AID PROJECT				

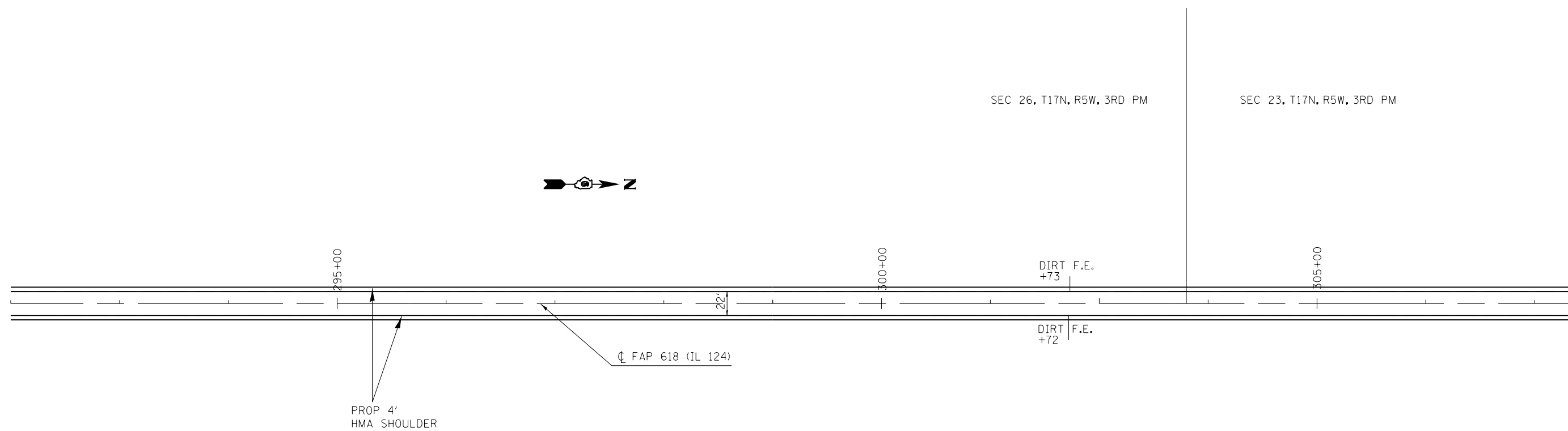
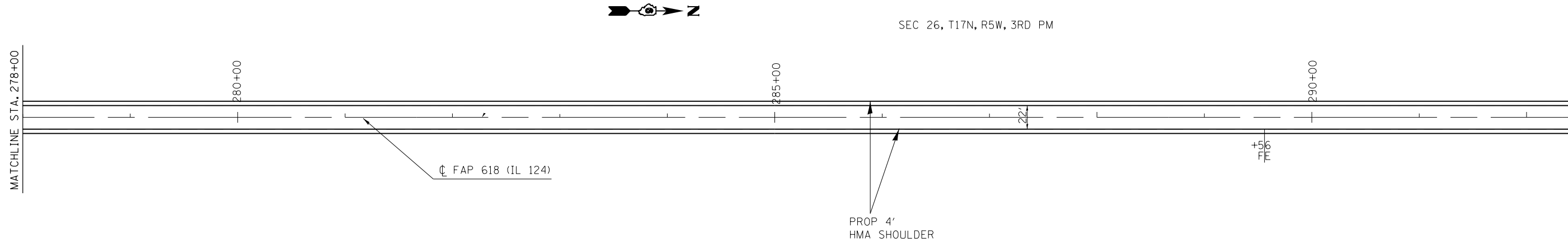

FILE NAME =	USER NAME = laughlinc1	DESIGNED -	REVISED -
c:\pwork\pwork\laughlinc1\0217723\0672056-shr-plan.dgn		DRAWN -	REVISED -
	PLOT SCALE = 100.0000' / in.	CHECKED -	REVISED -
	PLOT DATE = Oct-26-2010 07:10:08AM	DATE -	REVISED -

**STATE OF ILLINOIS
DEPARTMENT OF TRANSPORTATION**

PLAN VIEW

SCALE: SHEET NO. OF SHEETS STA. TO STA.

F.A.S. RTE.	SECTION	COUNTY	TOTAL SHEETS	SHEET NO.
618	(B)RS-4, (O-15)DRS-2	SANGAMON	32	16
CONTRACT NO. 72D56			ILLINOIS FED. AID PROJECT	

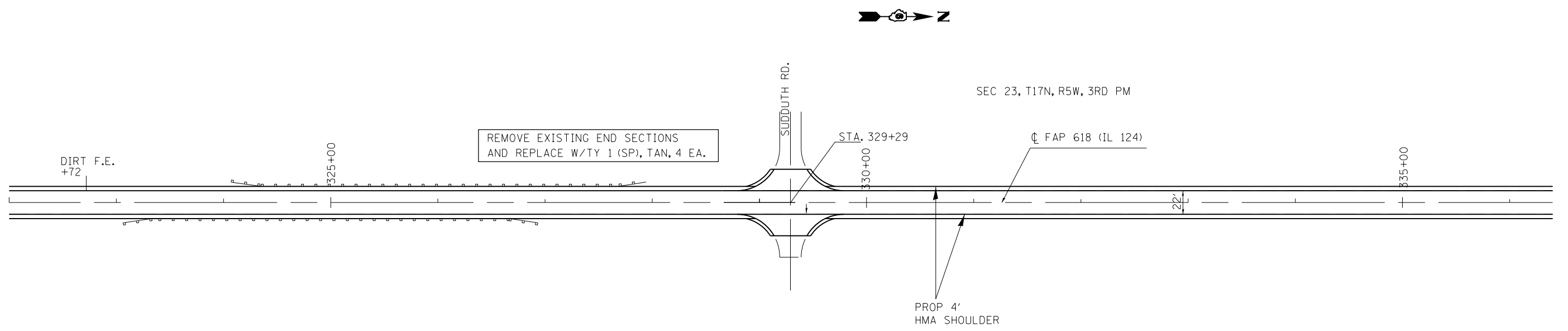
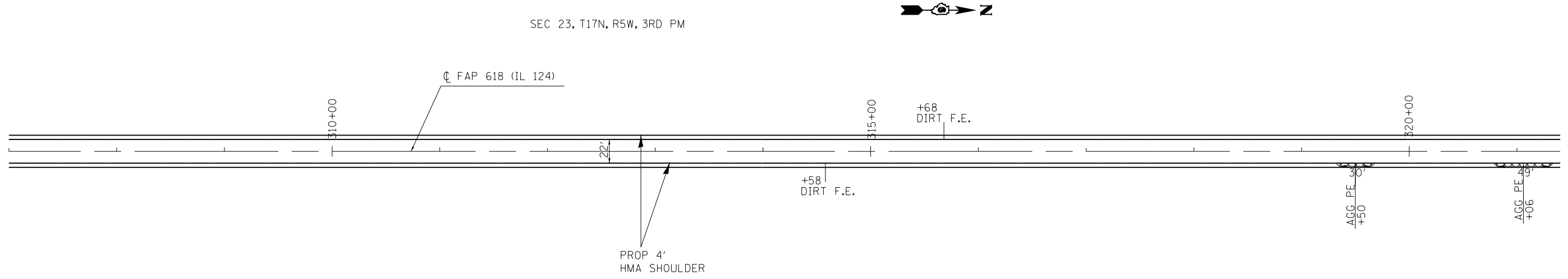

FILE NAME =	USER NAME = laughlinc1	DESIGNED -	REVISED -
et:\pwork\pwork\laughlinc1\0217723\0672056-shr-plan.dgn		DRAWN -	REVISED -
	PLOT SCALE = 100.0000' / in.	CHECKED -	REVISED -
	PLOT DATE = Oct-26-2010 07:10:08AM	DATE -	REVISED -

**STATE OF ILLINOIS
DEPARTMENT OF TRANSPORTATION**

PLAN VIEW			
SCALE:	SHEET NO. OF	SHEETS	STA. TO STA.

F.A.S. RTE.	SECTION	COUNTY	TOTAL SHEETS	SHEET NO.
618	(B)RS-4, (O-15)DRS-2	SANGAMON	32	17
CONTRACT NO. 72D56				
ILLINOIS FED. AID PROJECT				

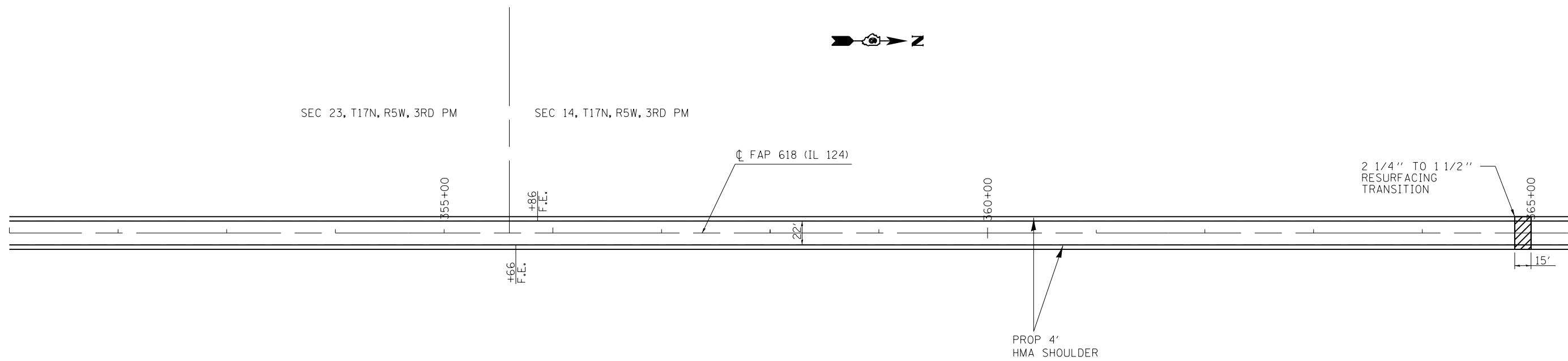
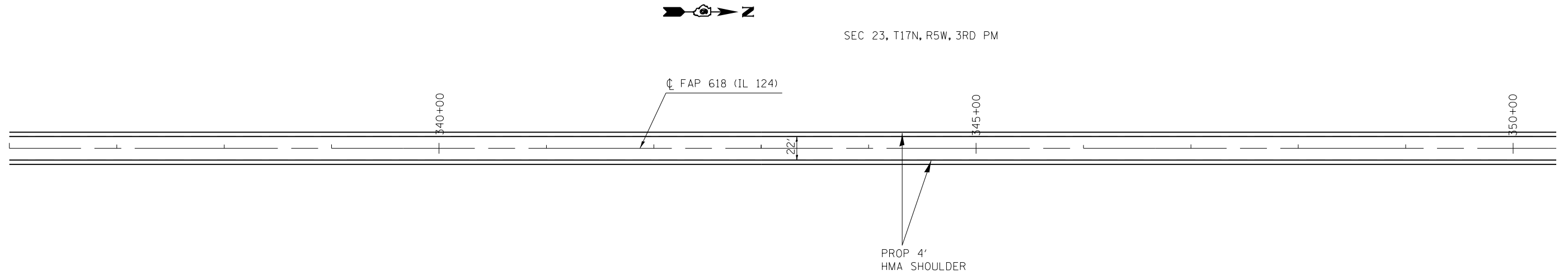

FILE NAME =	USER NAME = laughlinc1	DESIGNED -	REVISED -
et:\pwork\pwork\laughlinc1\0217723\0672056-shr-plan.dgn		DRAWN -	REVISED -
	PLOT SCALE = 100.0000' / in.	CHECKED -	REVISED -
	PLOT DATE = Oct-26-2010 07:10:08AM	DATE -	REVISED -

**STATE OF ILLINOIS
DEPARTMENT OF TRANSPORTATION**

PLAN VIEW

SCALE: SHEET NO. OF SHEETS STA. TO STA.

F.A.S. RTE.	SECTION	COUNTY	TOTAL SHEETS	SHEET NO.
618	(B)RS-4, (O-15)DRS-2	SANGAMON	32	18
CONTRACT NO. 72D56			ILLINOIS FED. AID PROJECT	

CURVE *10
 P.I. STA= 372+84.52
 Δ = 30°-07'-08"
 D= 4°-00'-00"
 R= 1432.40'
 T= 385.40'
 L= 752.97'
 E= 50.94'
 e= 6.0
 T.R.= 160.0
 S.E. RUN= 200.0
 P.C. STA= 368+98.90 BK. = 368+99.12 AHD.
 P.T. STA= 376+52.09
 S.E.A. 367+52.42 - 368+72.42
 S.E.A. 375+78.79 - 377+98.79

SEC 14, T17N, R5W, 3RD PM

STATION EQUATION
 STA. 368+98.90 BK.=
 P.C. STA. 368+99.12 AHD.

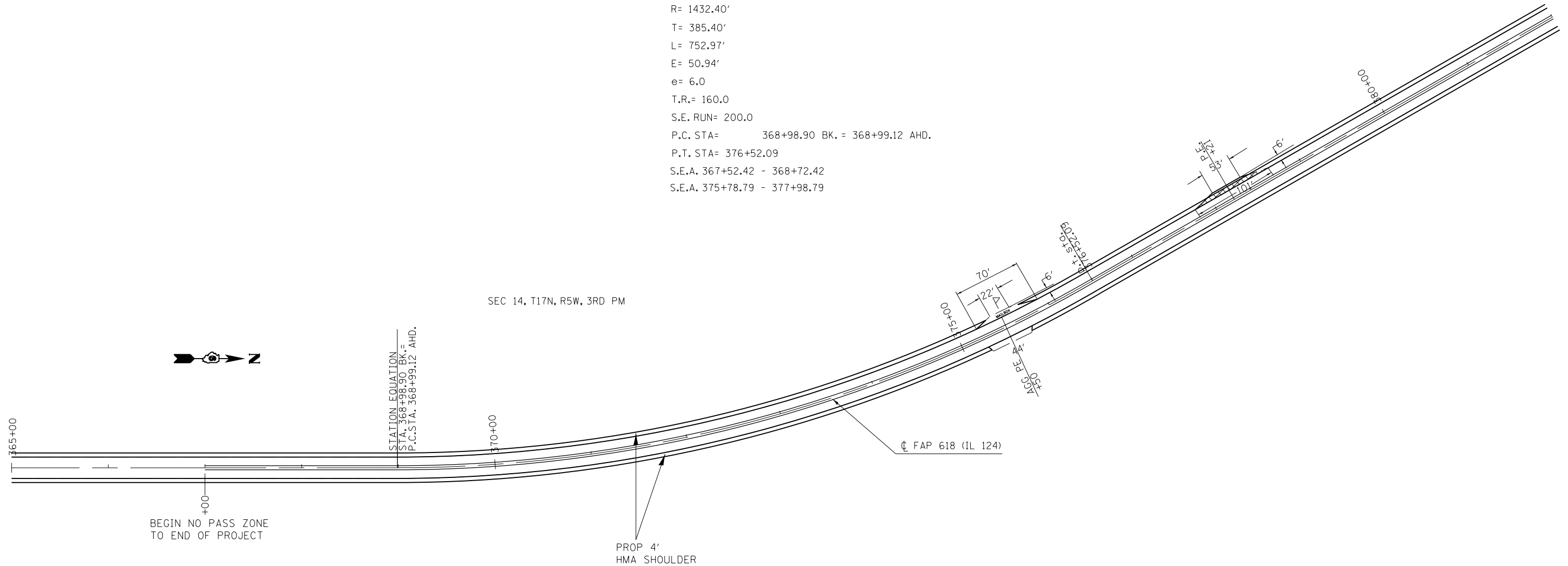
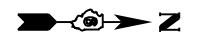

FILE NAME =	USER NAME = laughlinc1	DESIGNED -	REVISED -
et:\pwork\pwork\laughlinc1\0217723\0672056-shr-plan.dgn		DRAWN -	REVISED -
	PLOT SCALE = 100.0000' / in.	CHECKED -	REVISED -
	PLOT DATE = Oct-26-2010 07:10:09AM	DATE -	REVISED -

STATE OF ILLINOIS
 DEPARTMENT OF TRANSPORTATION

PLAN VIEW			
SCALE:	SHEET NO. OF	SHEETS	STA. TO STA.

F.A.S. RTE.	SECTION	COUNTY	TOTAL SHEETS	SHEET NO.
618	(B)RS-4, (O-15)DRS-2	SANGAMON	32	19
CONTRACT NO. 72D56				
ILLINOIS FED. AID PROJECT				

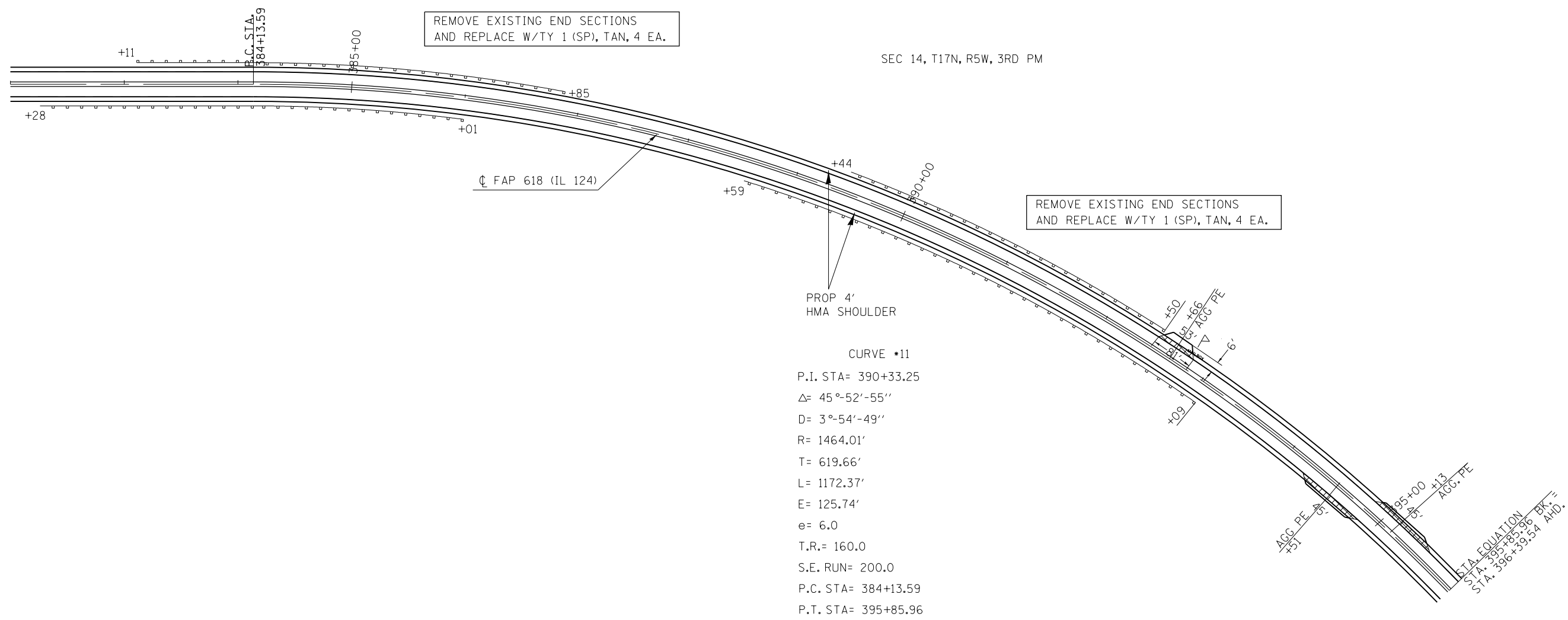

CURVE *11
 P.I. STA= 390+33.25
 $\Delta = 45^\circ-52'-55''$
 $D = 3^\circ-54'-49''$
 $R = 1464.01'$
 $T = 619.66'$
 $L = 1172.37'$
 $E = 125.74'$
 $e = 6.0$
 $T.R. = 160.0$
 $S.E. RUN = 200.0$
 P.C. STA= 384+13.59
 P.T. STA= 395+85.96

FILE NAME =	USER NAME = laughlinr1	DESIGNED -	REVISED -
et:\pwork\pwork\laughlinr1\0217723\0672056-shr-plan.dgn		DRAWN -	REVISED -
	PLOT SCALE = 100.0000' / in.	CHECKED -	REVISED -
	PLOT DATE = Oct-26-2010 07:10:09AM	DATE -	REVISED -

**STATE OF ILLINOIS
 DEPARTMENT OF TRANSPORTATION**

PLAN VIEW			
SCALE:	SHEET NO. OF	SHEETS	STA. TO STA.

F.A.S. RTE.	SECTION	COUNTY	TOTAL SHEETS	SHEET NO.
618	(B)RS-4, (O-15)DRS-2	SANGAMON	32	20
CONTRACT NO. 72D56			ILLINOIS FED. AID PROJECT	

STA. EQUATION
 STA. 395+85.96 BK.
 STA. 396+39.54 AH.

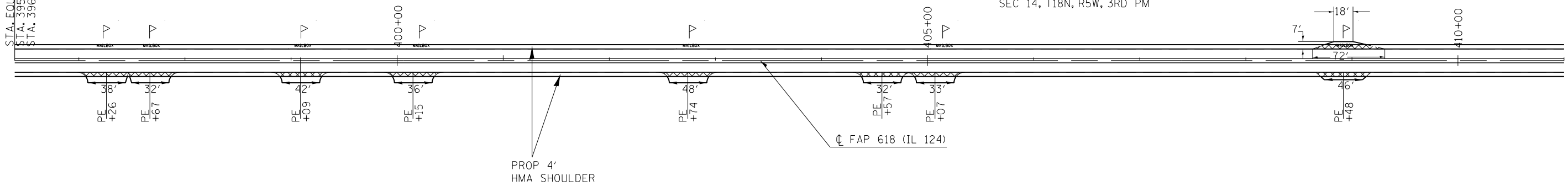

CURVE
 P.I. STA= 417+75.36
 Δ = 10°-18'-21"
 D= 2°-00'-00"
 R= 2864.79'
 T= 258.34'
 L= 515.29'
 E= 11.67'
 e= 4.4
 T.R.= 118.5
 S.E. RUN= 158.9
 P.C. STA= 415+17.02
 P.T. STA= 420+32.31(BK) = 420+49.79(AH)
 S.E.A. 413+70.32 - 415+90.32
 S.E.A. 413+70.32 - 415+90.32

FILE NAME =	USER NAME = laughlinr1	DESIGNED -	REVISED -
e:\pwork\pwork\laughlinr1\0217723\0672056-shr-plan.dgn		DRAWN -	REVISED -
	PLOT SCALE = 100.0000' / in.	CHECKED -	REVISED -
	PLOT DATE = Oct-26-2010 07:10:10AM	DATE -	REVISED -

**STATE OF ILLINOIS
 DEPARTMENT OF TRANSPORTATION**

PLAN VIEW			
SCALE:	SHEET NO. OF	SHEETS	STA. TO STA.

F.A.S. RTE.	SECTION	COUNTY	TOTAL SHEETS	SHEET NO.
618	(B)RS-4, (O-15)RS-2	SANGAMON	32	21
CONTRACT NO. 72D56				
ILLINOIS FED. AID PROJECT				

CURVE
 P.I. STA= 432+76.77
 Δ = 14°-18'-04"
 D= 2°-30'-04"
 R= 2282.70'
 T= 286.37'
 L= 569.76'
 E= 17.89
 e= 5.1
 T.R.= 135
 S.E. RUN= 174.7
 P.C. STA= 429+90.40
 P.T. STA= 435+60.16
 S.E.A. = 428+50.52 - 430+70.52
 S.E.A. = 435+13.07 - 436+21.07

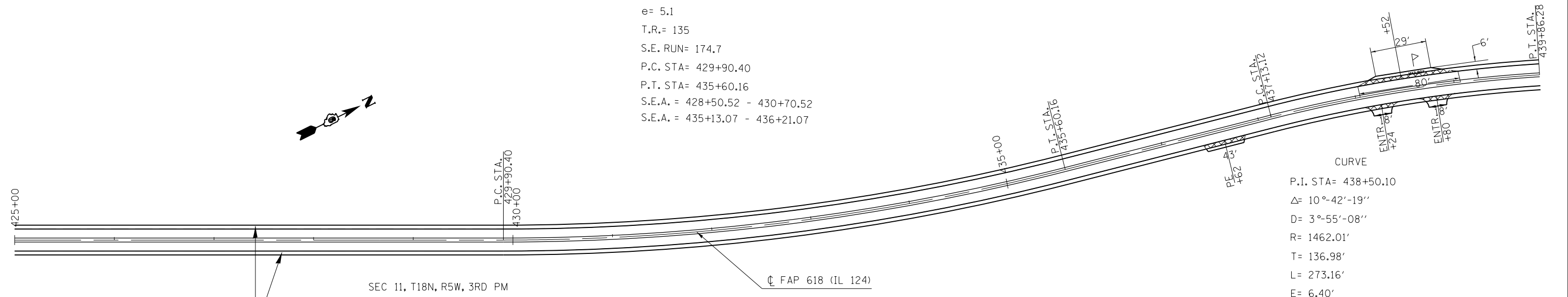

CURVE
 P.I. STA= 438+50.10
 Δ = 10°-42'-19"
 D= 3°-55'-08"
 R= 1462.01'
 T= 136.98'
 L= 273.16'
 E= 6.40'
 e= 5.9
 T.R.= 158
 S.E. RUN= 198.2
 P.C. STA= 437+13.12
 P.T. STA= 439+86.28
 S.E.A. 436+37.25 - 437+89.25
 S.E.A. 436+37.25 - 437+89.25

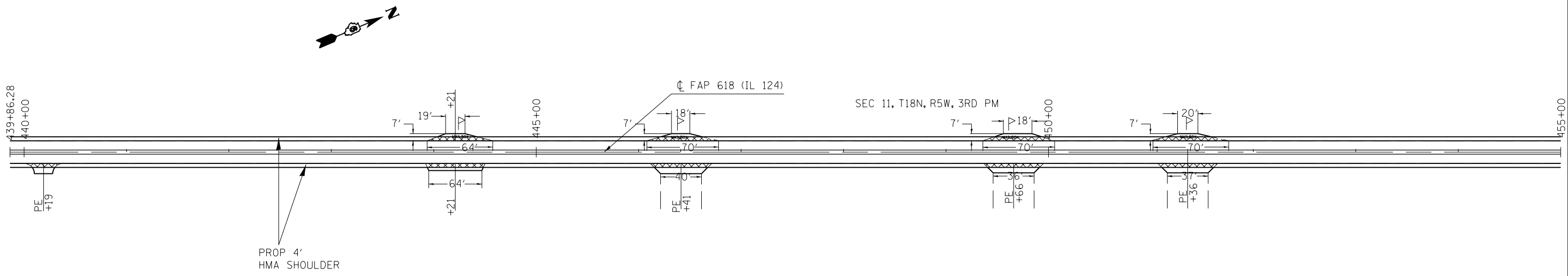

FILE NAME =	USER NAME = laughlinc1	DESIGNED -	REVISED -
et:\pw\work\p1dot\laughlinc1\0217723\0672056-shit-plan.dgn		DRAWN -	REVISED -
	PLOT SCALE = 100.0000' / in.	CHECKED -	REVISED -
	PLOT DATE = Oct-26-2010 07:10:10AM	DATE -	REVISED -

**STATE OF ILLINOIS
 DEPARTMENT OF TRANSPORTATION**

PLAN VIEW

SCALE: SHEET NO. OF SHEETS STA. TO STA.

F.A.S. RTE.	SECTION	COUNTY	TOTAL SHEETS	SHEET NO.
618	(B)RS-4, (O-15)DRS-2	SANGAMON	32	22
CONTRACT NO. 72D56				
ILLINOIS FED. AID PROJECT				

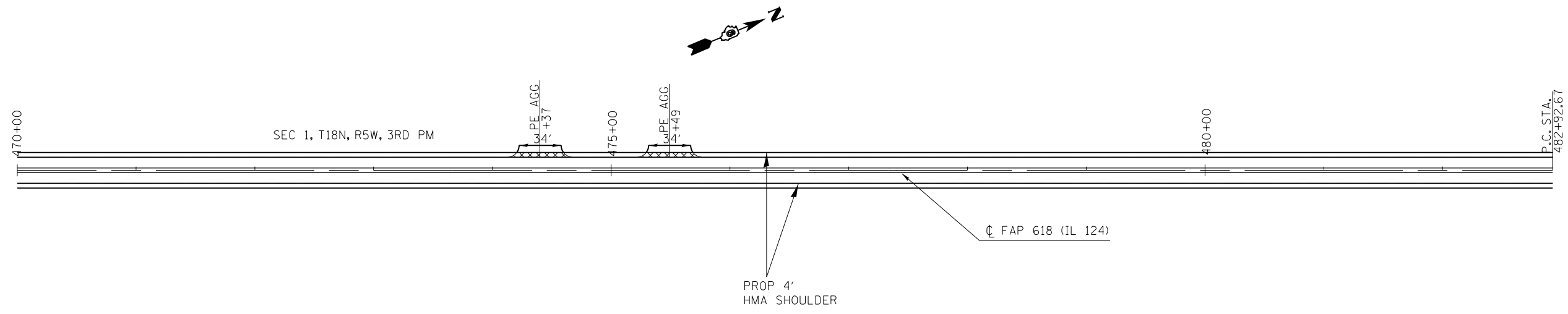
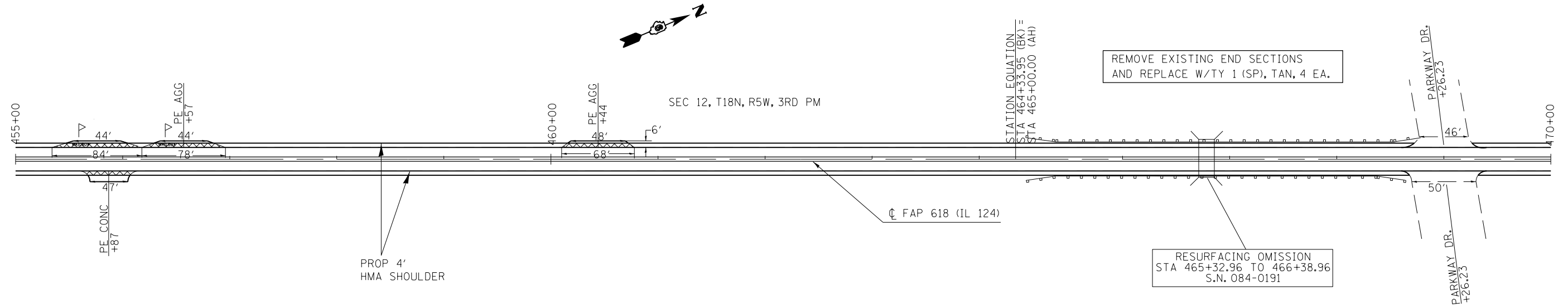

FILE NAME =	USER NAME = laughlinr1	DESIGNED -	REVISED -
et:\pw\work\p1dot\laughlinr1\0217723\0672056-sh1-plan.dgn		DRAWN -	REVISED -
PLOT SCALE = 100.0000' / in.		CHECKED -	REVISED -
PLOT DATE = Oct-26-2010 07:10:10AM		DATE -	REVISED -

**STATE OF ILLINOIS
DEPARTMENT OF TRANSPORTATION**

PLAN VIEW			
SCALE:	SHEET NO. OF	SHEETS	STA. TO STA.

F.A.S. RTE.	SECTION	COUNTY	TOTAL SHEETS	SHEET NO.
618	(B)RS-4, (O-15)DRS-2	SANGAMON	32	23
CONTRACT NO. 72D56				
ILLINOIS FED. AID PROJECT				



CURVE

P.I. STA= 486+56.42
 Δ = 30°-12'-00"
 D= 4°-15'-00"
 R= 1348.14'
 T= 363.76'
 L= 710.59'
 E= 48.21'
 e= 6.0
 T.R.= 160
 S.E. RUN= 200.0
 P.C. STA= 482+92.67
 P.T. STA= 490+03.25 (BK) = 490+12.92 (AHD)
 S.E.A. 470+94.59 - 473+14.59
 S.E.A. 474+94.81 - 477+14.81

SEC 1, T18N, R5W, 3RD PM

P.I. STA = 486+56.42
 P.T. STA = 490+03.25 (BK)
 P.T. STA = 490+12.92 (AHD)

☐ FAP 618 (IL 124)

P.C. STA
482+92.67

485+00

00+50

497+93

PROP 4'
HMA SHOULDER

FILE NAME =	USER NAME = laughlinr1	DESIGNED -	REVISED -
et:\pwork\pwork\laughlinr1\0217723\0672056-shht-plan.dgn		DRAWN -	REVISED -
	PLOT SCALE = 100.0000' / in.	CHECKED -	REVISED -
	PLOT DATE = Oct-26-2010 07:10:11AM	DATE -	REVISED -

STATE OF ILLINOIS
DEPARTMENT OF TRANSPORTATION

PLAN VIEW

SCALE: SHEET NO. OF SHEETS STA. TO STA.

F.A.S. RTE.	SECTION	COUNTY	TOTAL SHEETS	SHEET NO.
618	(B)RS-4, (O-15)DRS-2	SANGAMON	32	24
CONTRACT NO. 72D56				
ILLINOIS FED. AID PROJECT				

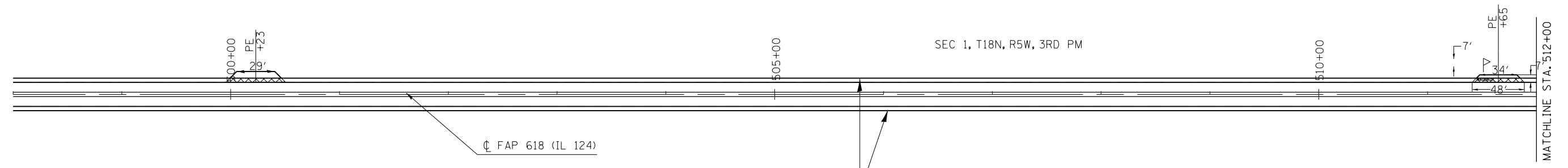
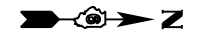

SEC 1, T18N, R5W, 3RD PM

CL FAP 618 (IL 124)

PROP 4'
HMA SHOULDER

CURVE

P.I. STA= 521+97.56
 Δ = 7°-08'-32.62
 D= 2°-00'-00"
 R= 2864.79'
 T= 178.79'
 L= 357.12
 E= 5.57'
 e= 4.4
 T.R.= 118.5
 S.E. RUN= 158.9
 P.C. STA= 520+18.77
 P.T. STA= 523+75.89



MATCHLINE STA. 512+00

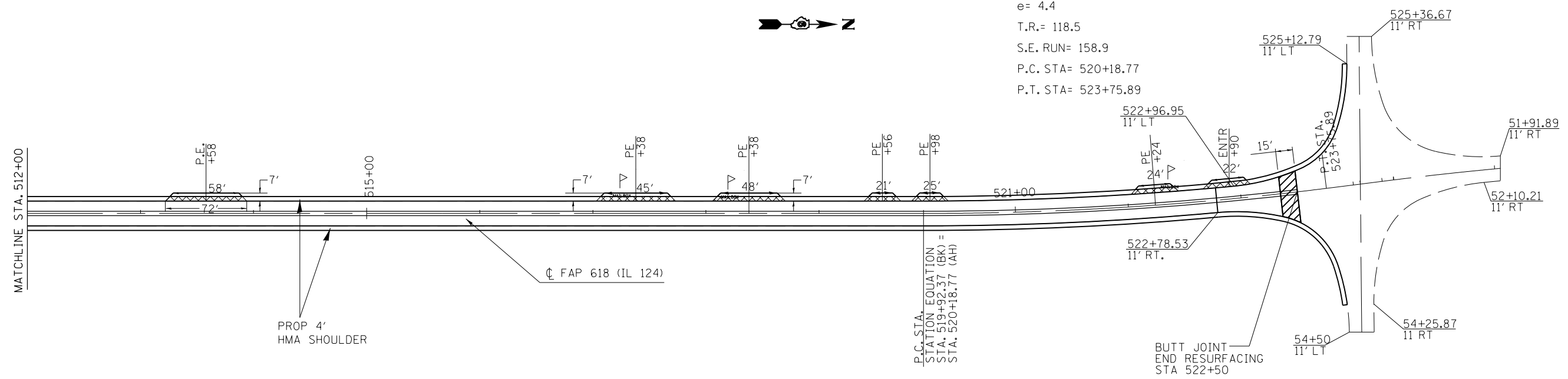

CL FAP 618 (IL 124)

PROP 4'
HMA SHOULDER

P.C. STA.
STATION EQUATION
STA. 519+92.37 (BK) =
STA. 520+18.77 (AH)

BUTT JOINT
END RESURFACING
STA 522+50

FILE NAME =	USER NAME = laughlinc1	DESIGNED -	REVISED -
et:\pw\work\p\idot\laughlinc1\0217723\0672056-shr-plan.dgn		DRAWN -	REVISED -
	PLOT SCALE = 100.0000' / in.	CHECKED -	REVISED -
	PLOT DATE = Oct-26-2010 07:10:11AM	DATE -	REVISED -

STATE OF ILLINOIS
DEPARTMENT OF TRANSPORTATION

PLAN VIEW

SCALE: SHEET NO. OF SHEETS STA. TO STA.

F.A.S. RTE.	SECTION	COUNTY	TOTAL SHEETS	SHEET NO.
618	(B)RS-4, (O-15)DRS-2	SANGAMON	32	25
CONTRACT NO. 72D56				
ILLINOIS FED. AID PROJECT				

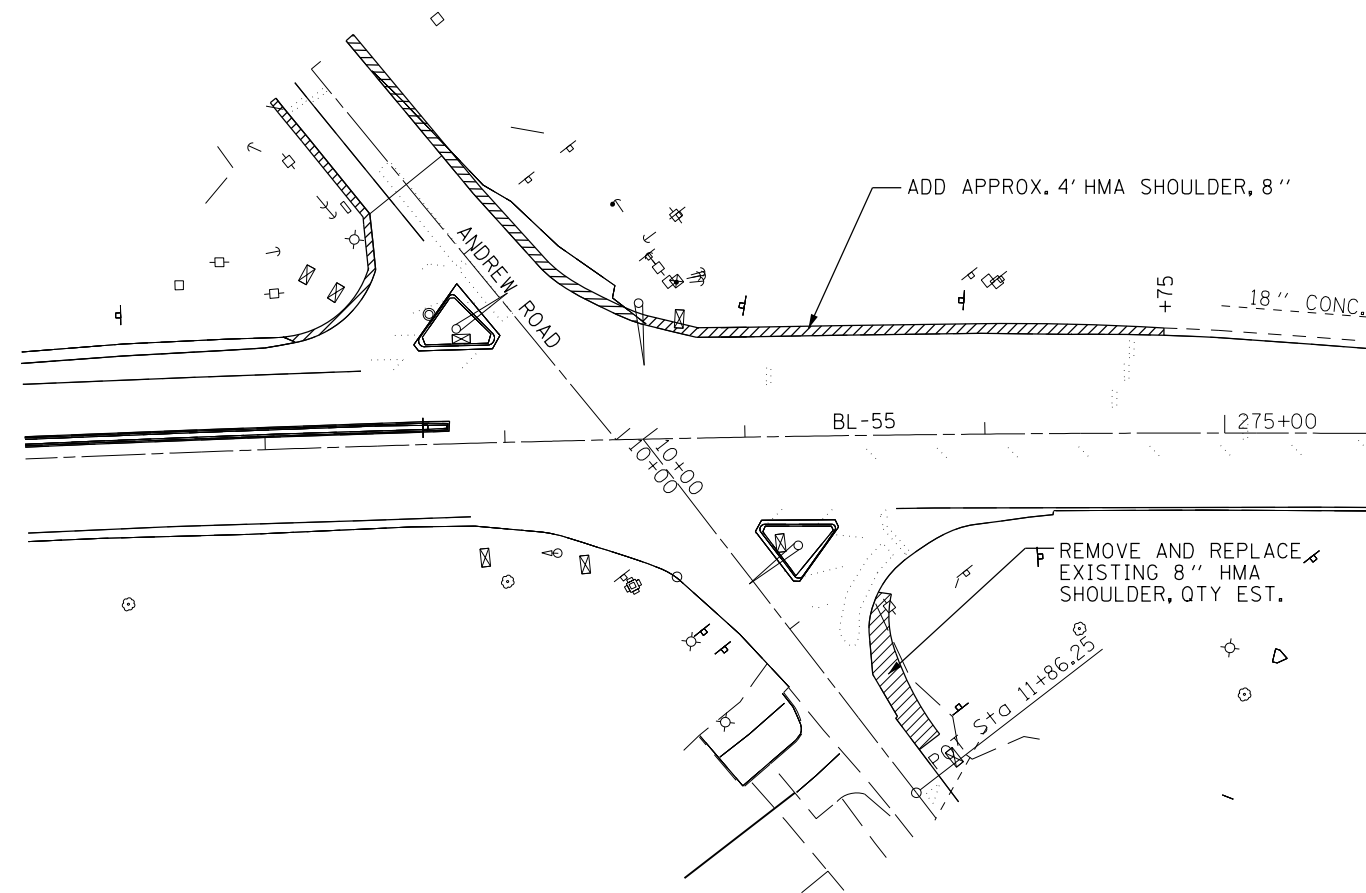

RECENT BL 55/VILLAGE CENTER
DRIVE INTERSECTION IMPROVEMENT -
RECENT TOPOGRAPHY NOT SHOWN

FILE NAME =	USER NAME = laughlir1	DESIGNED -	REVISED -
et:\pw\work\p1dot\laughlir1\0217723\plansheets.dgn		DRAWN -	REVISED -
	PLOT SCALE = 80.0000' / in.	CHECKED -	REVISED -
	PLOT DATE = Oct-26-2010 07:10:17AM	DATE -	REVISED -

**STATE OF ILLINOIS
DEPARTMENT OF TRANSPORTATION**

**PLAN VIEW - SPOT SHOULDER
IMPROVEMENTS**

SCALE: SHEET NO. OF SHEETS STA. TO STA.

F.A.S. RTE.	SECTION	COUNTY	TOTAL SHEETS	SHEET NO.
618	(B)RS-4, (O-15)DRS-2	SANGAMON	32	26
CONTRACT NO. 72D56				
ILLINOIS FED. AID PROJECT				

RECENT BL 55/VILLAGE CENTER
DRIVE INTERSECTION IMPROVEMENT -
RECENT TOPOGRAPHY NOT SHOWN

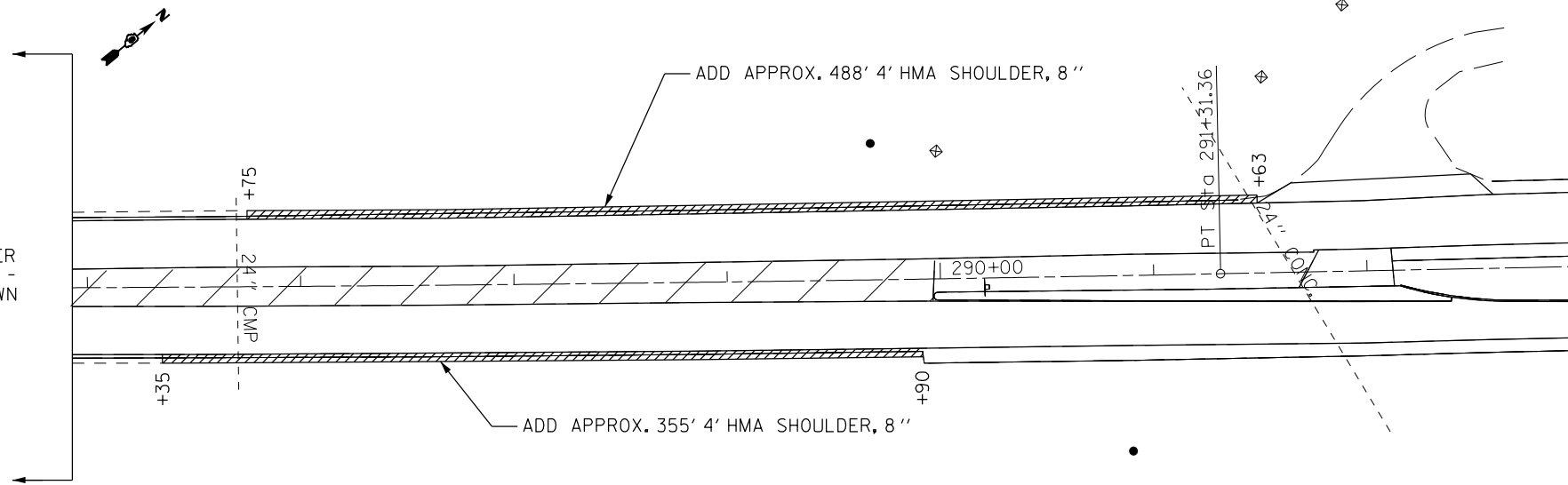

FILE NAME =	USER NAME = laughlinr1	DESIGNED -	REVISED -
et:\pwork\pwork\laughlinr1\0217723\plansheets.dgn		DRAWN -	REVISED -
	PLOT SCALE = 80.0000' / in.	CHECKED -	REVISED -
	PLOT DATE = Oct-26-2010 07:10:18AM	DATE -	REVISED -

**STATE OF ILLINOIS
DEPARTMENT OF TRANSPORTATION**

**PLAN VIEW - SPOT SHOULDER
IMPROVEMENTS**

SCALE: SHEET NO. OF SHEETS STA. TO STA.

F.A.S. RTE.	SECTION	COUNTY	TOTAL SHEETS	SHEET NO.
618	(B)RS-4, (O-15)RS-2	SANGAMON	32	27
CONTRACT NO. 72D56			ILLINOIS FED. AID PROJECT	

1 1/2" SAW CUT (COST TO BE INCLUDED IN HMA SURFACE REMOVAL, BUTT JOINT)

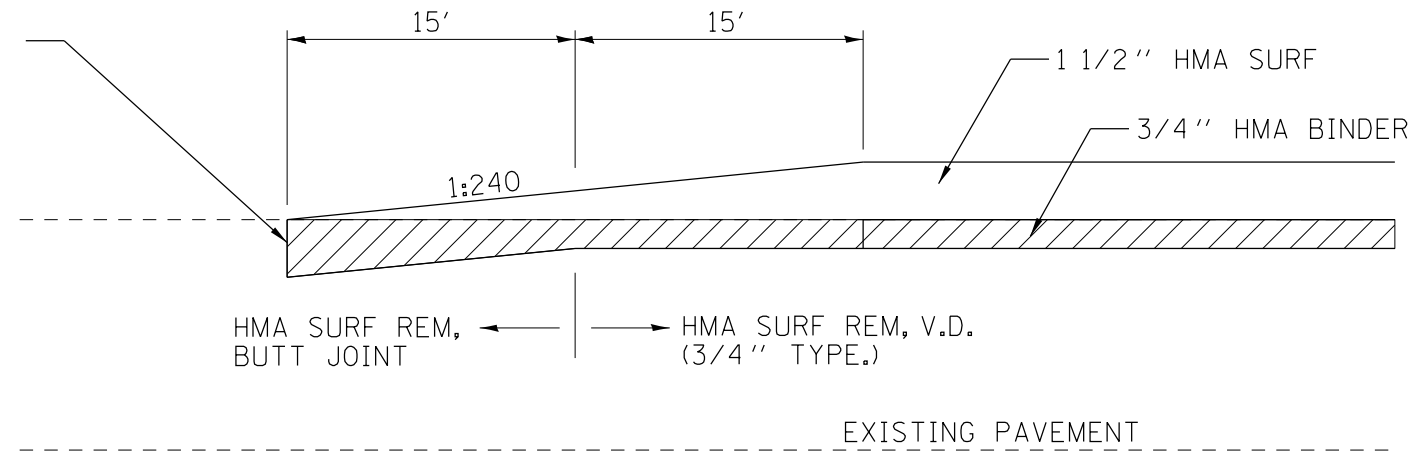

HMA BUTT JOINT

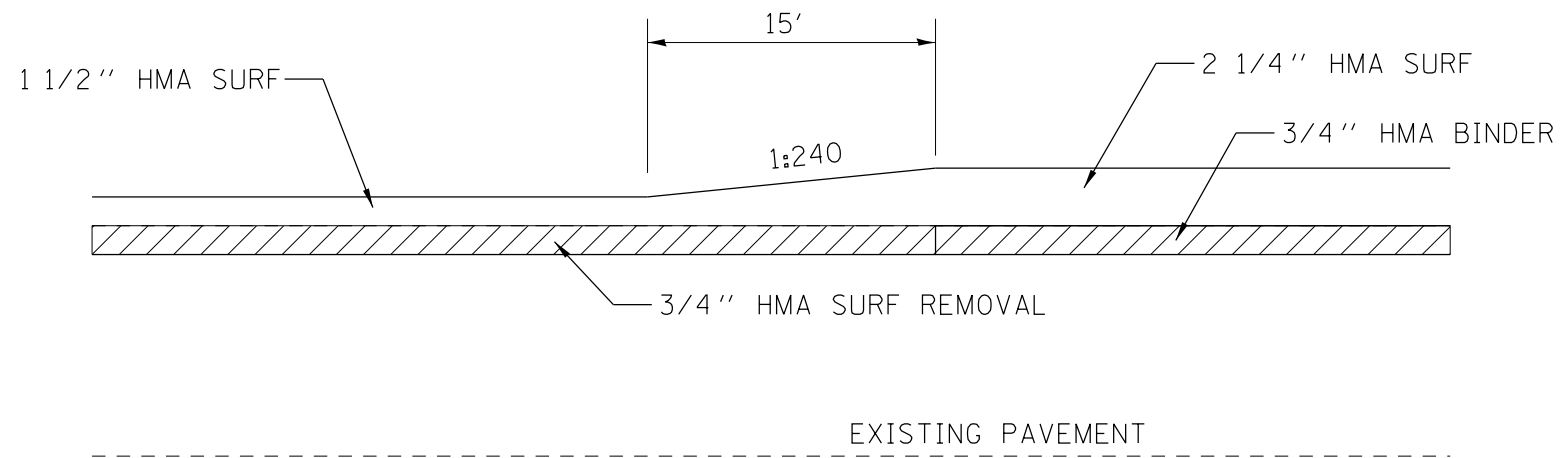

1 1/2" RESURFACING TO 2 1/4" RESURFACING TRANSITION

FILE NAME =	USER NAME = laughlinr1	DESIGNED -	REVISED -
et:\pw\work\pwidot\laughlinr1\0217723\0672056-shr-details.dgn		DRAWN -	REVISED -
	PLOT SCALE = 100.0000' / in.	CHECKED -	REVISED -
	PLOT DATE = Oct-26-2010 07:10:46AM	DATE -	REVISED -

STATE OF ILLINOIS
DEPARTMENT OF TRANSPORTATION

TRANSITION DETAILS

SCALE: SHEET NO. OF SHEETS STA. TO STA.

F.A.S. RTE.	SECTION	COUNTY	TOTAL SHEETS	SHEET NO.
618	(B)RS-4, (O-15)RS-2	SANGAMON	32	28
CONTRACT NO. 72D56			ILLINOIS FED. AID PROJECT	

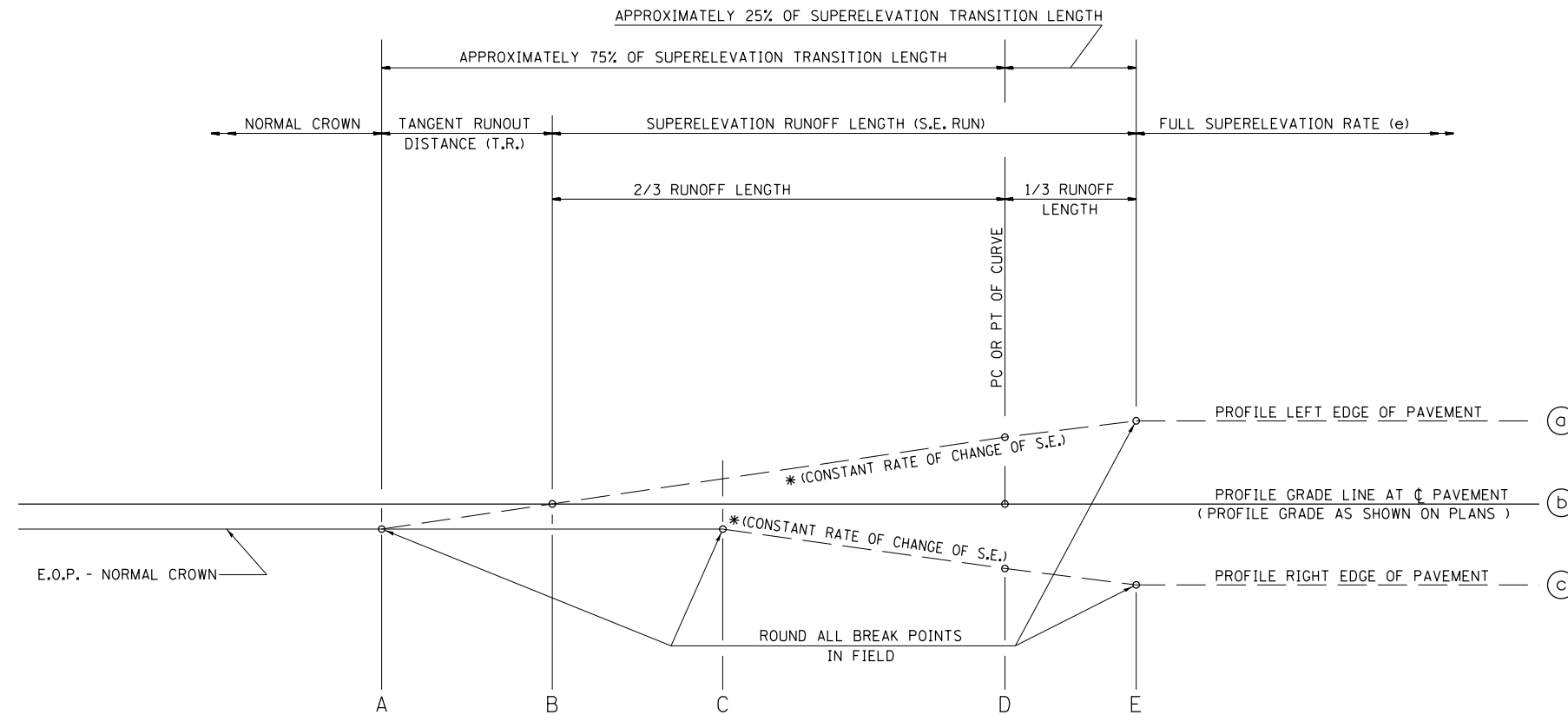

TYPICAL PROFILE - S.E. TRANSITION

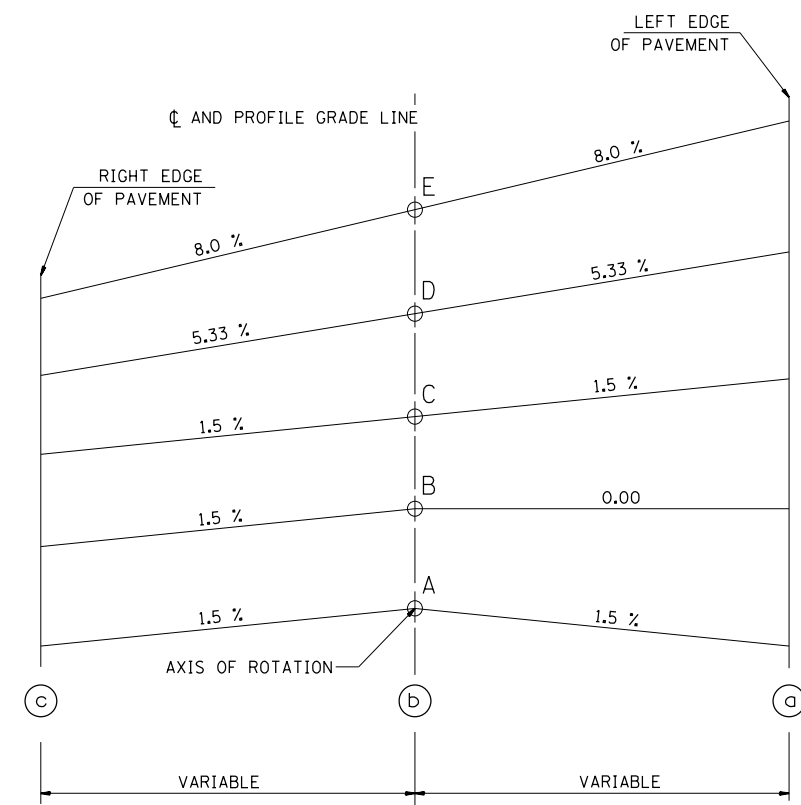

TABLE OF SUPERELEVATION BREAK POINT LOCATIONS							
CURVE NO.	e	A	B	C	D	E	TRANSITION
10	6.00%	Sta. 367+15.787	Sta. 367+65.787	Sta. 368+15.787	Sta. 368+99.12	Sta. 369+65.787	Trans. In
10	6.00%	Sta. 378+35.423	Sta. 377+85.423	Sta. 377+35.423	Sta. 376+52.09	Sta. 375+85.423	Trans. Out
11	6.00%	Sta. 382+30.257	Sta. 382+80.257	Sta. 383+30.257	Sta. 384+13.59	Sta. 384+80.257	Trans. In
11	6.00%	Sta. 397+69.293	Sta. 397+19.293	Sta. 396+69.293	Sta. 395+85.96	Sta. 395+19.293	Trans. Out
12	4.40%	Sta. 413+56.916	Sta. 414+11.087	Sta. 414+65.257	Sta. 415+17.02	Sta. 415+69.987	Trans. In
12	4.40%	Sta. 421+92.414	Sta. 421+38.243	Sta. 420+84.073	Sta. 420+32.31	Sta. 419+79.343	Trans. Out
13	5.10%	Sta. 428+22.551	Sta. 428+73.933	Sta. 429+25.316	Sta. 429+90.4	Sta. 430+48.633	Trans. In
13	5.10%	Sta. 437+28.009	Sta. 436+76.627	Sta. 436+25.244	Sta. 435+60.16	Sta. 435+01.927	Trans. Out
14	5.90%	Sta. 435+30.597	Sta. 435+80.987	Sta. 436+31.376	Sta. 437+13.12	Sta. 437+79.187	Trans. In
14	5.90%	Sta. 441+68.803	Sta. 441+18.413	Sta. 440+68.024	Sta. 439+86.28	Sta. 439+20.213	Trans. Out
15	6.00%	Sta. 481+09.337	Sta. 481+59.337	Sta. 482+09.337	Sta. 482+92.67	Sta. 483+59.337	Trans. In
15	6.00%	Sta. 491+86.583	Sta. 491+36.583	Sta. 490+86.583	Sta. 490+03.25	Sta. 489+36.583	Trans. Out

FILE NAME =	USER NAME = laughlinc1	DESIGNED -	REVISED -
et:\pwork\pwork\laughlinc1\0217723\06	2056-shr-details.dgn	DRAWN -	REVISED -
	PLOT SCALE = 100.0000' / in.	CHECKED -	REVISED -
	PLOT DATE = Oct-26-2010 07:10:46AM	DATE -	REVISED -

STATE OF ILLINOIS
DEPARTMENT OF TRANSPORTATION

SUPERELEVATION DETAILS

SCALE: SHEET NO. OF SHEETS STA. TO STA.

F.A.S. RTE.	SECTION	COUNTY	TOTAL SHEETS	SHEET NO.
618	(B)RS-4, (O-15)DRS-2	SANGAMON	32	29
CONTRACT NO. 72056				
ILLINOIS FED. AID PROJECT				

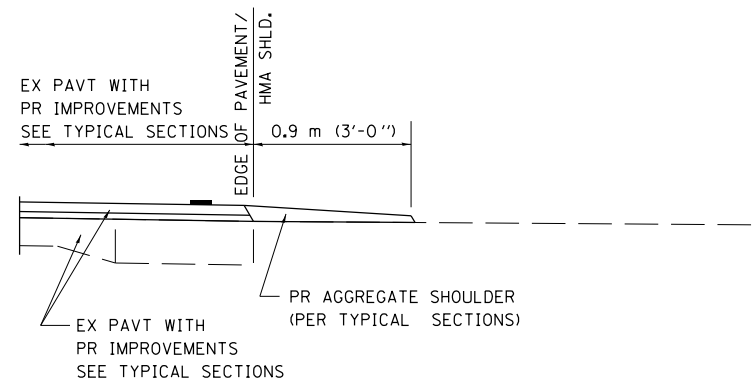

SECTION A-A FOR EX EARTH/ AGGREGATE FE

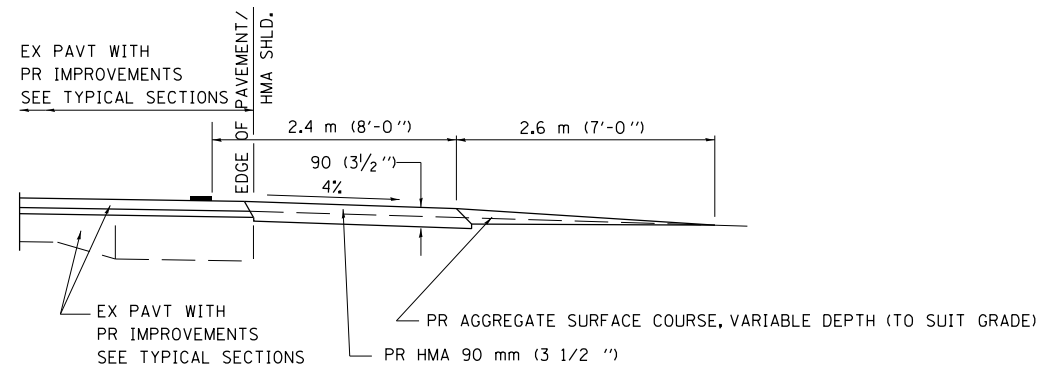

SECTION A-A FOR EX EARTH/AGGREGATE PE

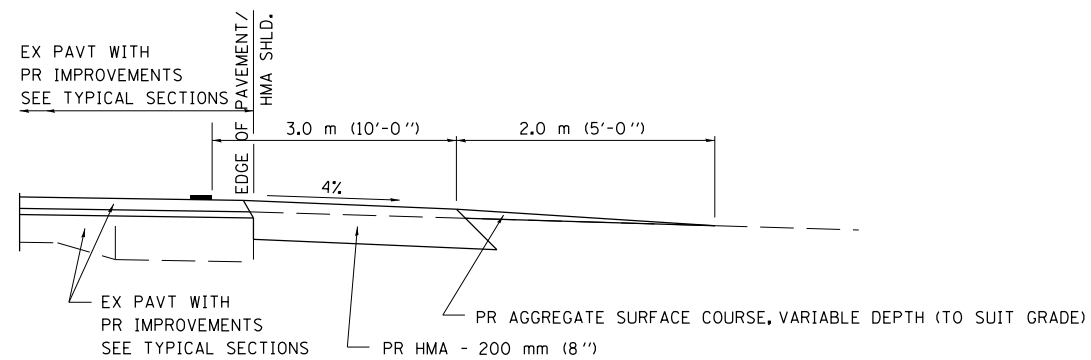

SECTION A-A FOR EX EARTH/AGGREGATE CE & SIDE ROAD

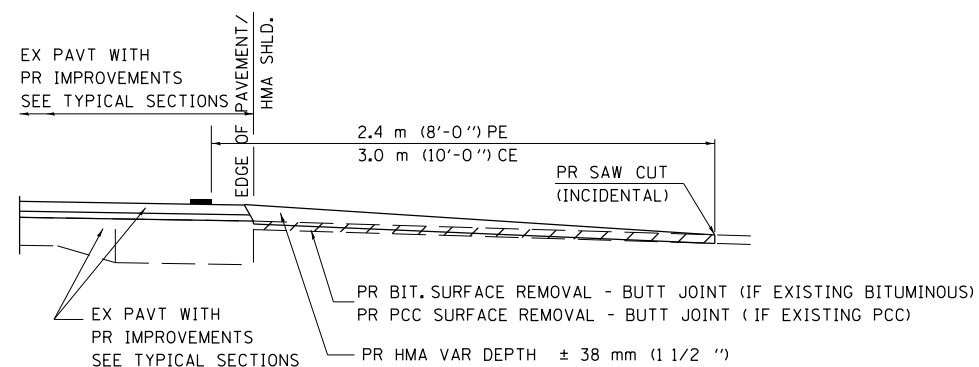

SECTION A-A FOR EX BITUMINOUS/ PC CONCRETE PE, CE & SIDE ROAD

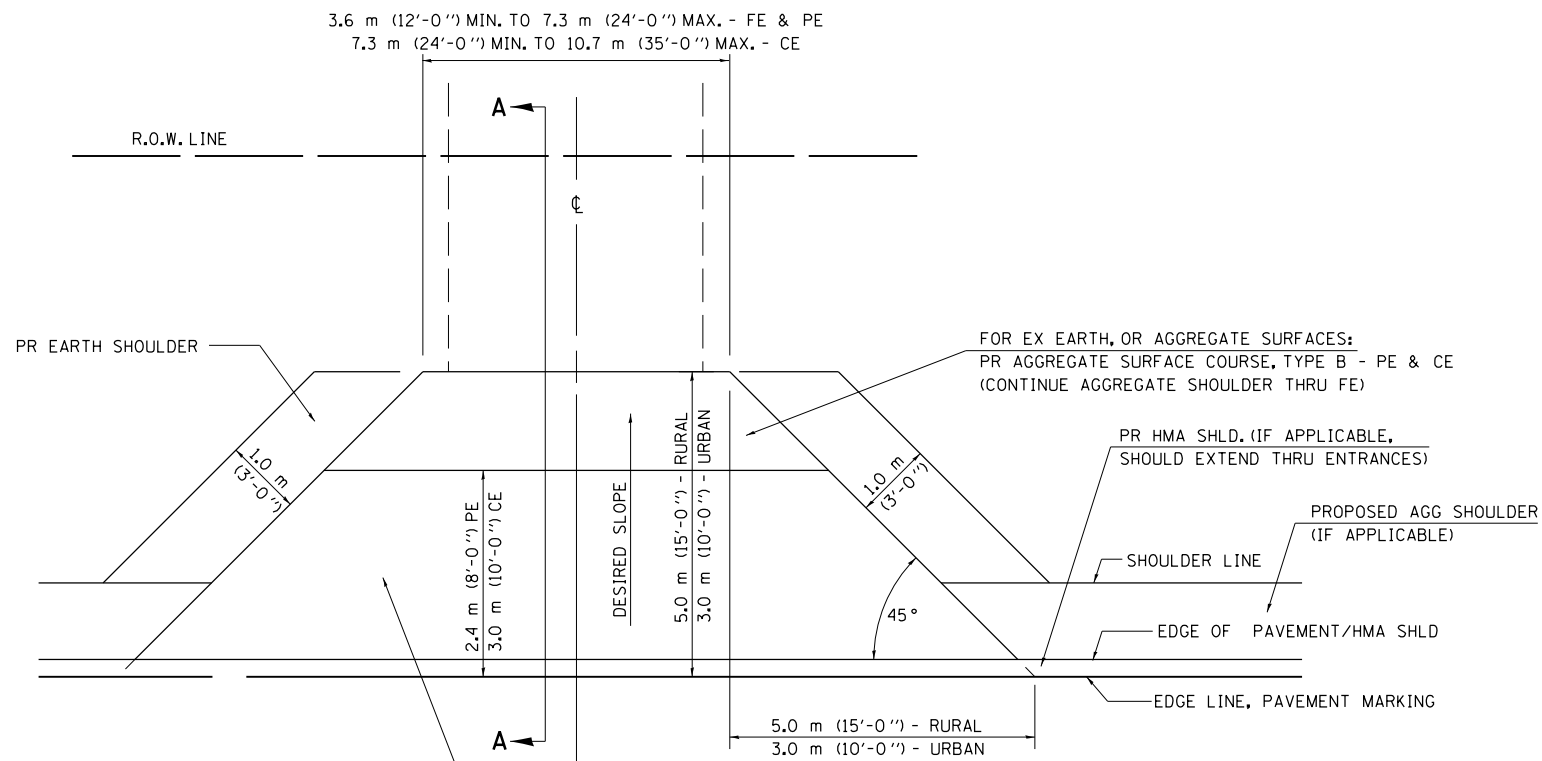

FOR EX EARTH OR AGGREGATE SURFACES:
 PR BIT SURFACE REMOVAL (IF APPLICABLE)
 PR AGGREGATE SHOULDER THRU - FE
 PR BITUMINOUS CONCRETE 90 mm (3 1/2") - PE
 PR BITUMINOUS CONCRETE 200mm (8") - CE

FOR EX BITUMINOUS CONCRETE SURFACES:
 PR BITUMINOUS SURFACE REMOVAL-BUTT JOINT

FOR EX PCC SURFACES:
 PR PCC SURFACE REMOVAL-BUTT JOINT

GENERAL NOTES:

THE RESIDENT ENGINEER WILL DETERMINE THE EXACT TYPE OF IMPROVEMENT TO BE COMPLETED FOR ALL ENTRANCES, SIDEROADS AND MAILBOX TURNOUTS ON THIS PROJECT.

THE PLAN DETAILS AND SCHEDULES SHOULD BE USED AS A GUIDE FOR THE ENGINEER TO IMPLEMENT THE FINAL DESIGN. THE ENGINEER MAY DECIDE TO SALVAGE PORTIONS OF THE EXISTING ENTRANCE PAVEMENT STRUCTURE; THEREFORE, REDUCING PAY ITEM QUANTITIES. NO ADDITIONAL PAYMENT WILL BE ALLOWED FOR THIS REDUCTION IN QUANTITIES.

ANY WORK THE ENGINEER REQUIRES WHICH IS NOT COVERED BY A PAY ITEM CONTAINED IN THE PLANS WILL BE PAID FOR IN ACCORDANCE WITH ARTICLE 109.04 OF THE STANDARD SPECIFICATIONS.

BITUMINOUS CONCRETE REQUIRED TO CONSTRUCT THE ENTRANCES SHALL BE IN ACCORDANCE WITH THE APPLICABLE PORTIONS OF SECTION 406 AND 408 OF THE STANDARD SPECIFICATIONS AND AS DIRECTED BY THE ENGINEER.

WHEN THE BITUMINOUS CONCRETE PROPOSED FOR THE IMPROVEMENT IS THICKER THAN 75 mm (3 INCHES) AND REQUIRE PLACEMENT IN MORE THAN ONE LIFT. THE BOTTOM LIFT(S) SHALL MEET THE REQUIREMENTS OF BITUMINOUS BASE COURSE IN SECTION 406 OF THE STANDARD SPECIFICATIONS AND THE TOP LIFT OF 50 mm (2 INCHES) SHALL MEET THE REQUIREMENTS OF BITUMINOUS CONCRETE SURFACE COURSE, SUPERPAVE.

THIS WORK WILL BE PAID FOR IN ACCORDANCE WITH SECTIONS 351, 358, 408, 423 AND 440 OF THE STANDARD SPECIFICATIONS.

ALL DIMENSIONS ARE IN MILLIMETERS (INCHES) UNLESS OTHERWISE SHOWN.

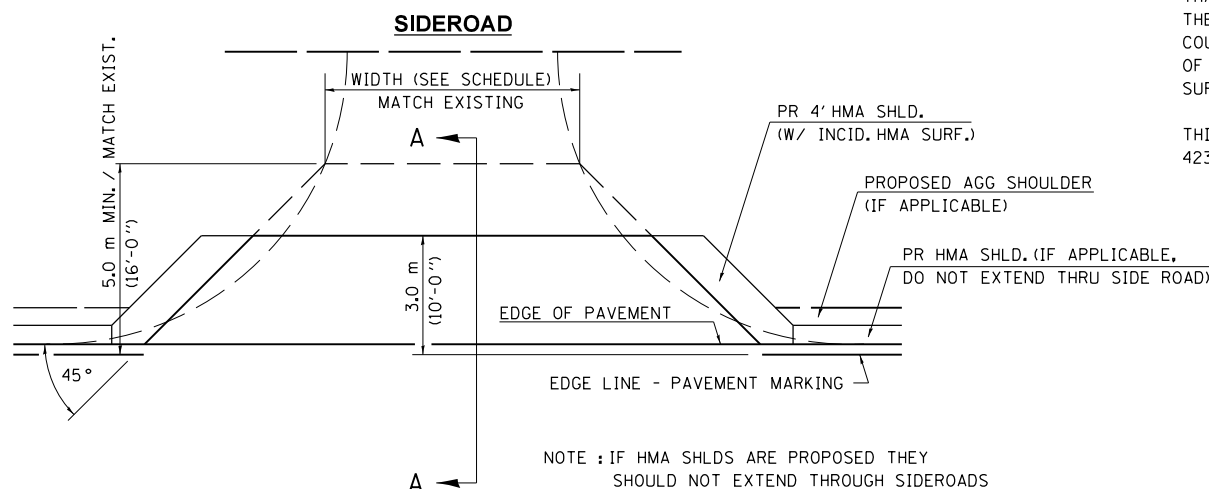

FILE NAME =	USER NAME = laughl1nr1	DESIGNED -	REVISED - 2/19/03 JCN
et:\pwwork\pwwork\laughl1nr1\d0217723\ent_ppp.dgn		DRAWN - CADD	REVISED - 4/01/04 JCN
	PLOT SCALE = 48.000' / in.	CHECKED - JCN	REVISED -
	PLOT DATE = Oct-26-2010 07:10:53AM	DATE - FEBRUARY 23, 1999	REVISED -

**STATE OF ILLINOIS
 DEPARTMENT OF TRANSPORTATION**

**DIST. 6 DETAILS FOR RURAL/URBAN ENT., MAILBOX
 TURNOUT & SIDEROADS W/O CONC. GUTTER (3P-PROJ.)**

SCALE: SHEET NO. 1 OF 3 SHEETS STA. TO STA.

F.A.S. RTE.	SECTION	COUNTY	TOTAL SHEETS	SHEET NO.
618	(B)RS-4, (O-15)DRS-2	SANGAMON	32	30
CONTRACT NO. 72D56				
FED. ROAD DIST. NO. ILLINOIS FED. AID PROJECT				

DETAILS OF MAILBOX TURNOUTS

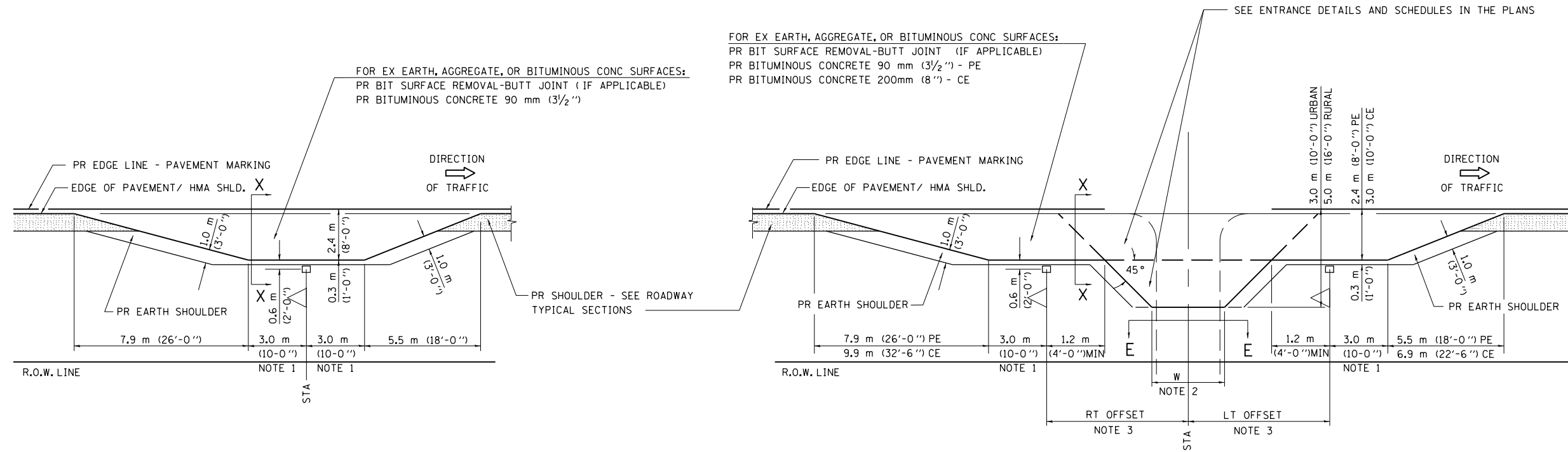

PLAN - MAILBOX TURNOUTS

PLAN - COMBINED MAILBOX TURNOUT WITH TRAILING OR LEADING ENTRANCE

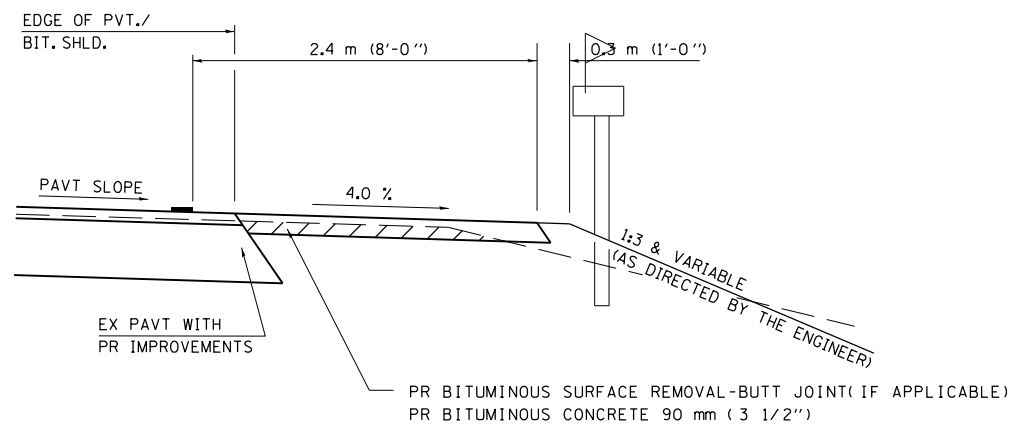

**SECTION X-X THRU MAILBOX TURNOUT
ALSO APPLIES TO MAILBOX TURNOUTS COMBINED WITH
EX EARTH, AGGREGATE, OR BITUMINOUS PE & FE**

(DETAIL APPLIES WHEN M.B. TURNOUT DOES NOT EXIST.
IF EXISTING, TREAT SAME AS ENTRANCE.)

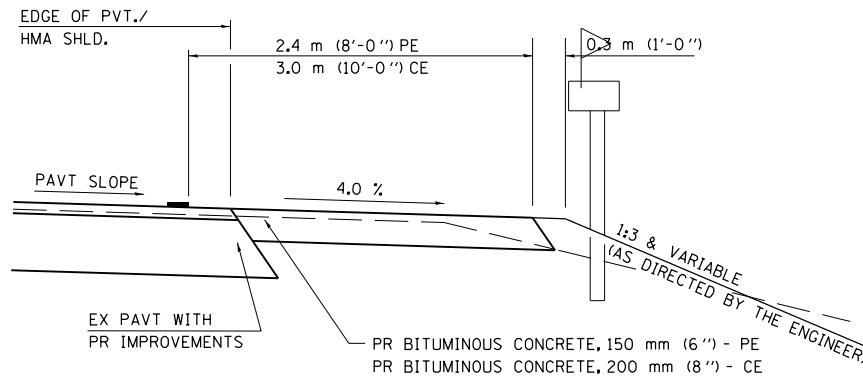

**SECTION X-X THRU MAILBOX TURNOUT
COMBINED WITH EX BITUMINOUS CONC & PC CONC PE & CE**

(DETAIL APPLIES WHEN M.B. TURNOUT DOES NOT EXIST.
IF EXISTING, TREAT SAME AS ENTRANCE.)

- NOTE 1 IF MORE THAN ONE MAILBOX IS PRESENT, DIMENSION FROM CENTER OF END MAILBOX.
- NOTE 2 FOR ENTRANCE LAYOUT DIMENSIONS AND SECTIONS A-A & E-E REFER TO THE SCHEDULES IN THE PLANS.
- NOTE 3 BOTH LT OR RT OFFSETS FOR MAILBOX SHOWN USE OFFSET DIMENSION PER SCHEDULE AND REFER TO LAYOUT SHOWN ON THE PLAN.

ALL DIMENSIONS ARE IN MILLIMETERS (INCHES)
UNLESS OTHERWISE SHOWN.

FILE NAME =	USER NAME = laughlinr1	DESIGNED -	REVISED - 2/19/03 JCN
et:\pwork\pwork\laughlinr1\0217723\ent_ppp.dgn		DRAWN - CADD	REVISED - 4/01/04 JCN
ENT PPP.DGN	PLOT SCALE = 48.000' / in.	CHECKED - JCN	REVISED -
	PLOT DATE = Oct-26-2010 07:10:53AM	DATE - FEBRUARY 23, 1999	REVISED -

**STATE OF ILLINOIS
DEPARTMENT OF TRANSPORTATION**

**DIST. 6 DETAILS FOR RURAL/URBAN ENT., MAILBOX
TURNOUT & SIDEROADS W/O CONC. GUTTER (3P-PROJ.)**

SCALE: SHEET NO. 1 OF 3 SHEETS STA. TO STA.

F.A.S. RTE.	SECTION	COUNTY	TOTAL SHEETS	SHEET NO.
618	(B)RS-4, (O-15)DRS-2	SANGAMON	32	31
CONTRACT NO. 72D56				
FED. ROAD DIST. NO. ILLINOIS FED. AID PROJECT				

LOCATION (LT/RT) (STA)	TYPE OF ENTRANCE	EX MAT TYPE	EX WIDTH FOOT	WIDTH FOOT	AREA SQ YD	HMA 3-1/2" TON	VOLUME (AGG) CU YD	AGG 2" TON	HMA VD TON	PREP BASE SQ YD
LT 1074+95	CE	BIT	35	35	50.0	0.0	N/A	0.0	5.6	0
RT 1075+86.6	SIDEROAD	HMA	50	50	66.7	0.0	N/A	0.0	7.5	0
LT 1076+20	CE	BIT	35	35	50.0	0.0	N/A	0.0	5.6	0
LT 1076+30	PE	Earth/ Agg.	22	22	39.1	7.7	1.3	2.6	0.0	39.1
LT 1076+90	PE	Earth/ Agg.	22	22	39.1	7.7	1.3	2.6	0.0	39.1
LT 1077+ ~20	CE	CONC	24	24	37.8	0.0	N/A	0.0	4.2	0
RT 1077+15	CE	CONC	18	24	37.8	0.0	N/A	0.0	4.2	0
RT 1078+75	CE	CONC	18	24	37.8	0.0	N/A	0.0	4.2	0
LT 1079+26.23	SIDEROAD	HMA	40	40	55.6	0.0	N/A	0.0	6.2	0
RT 1079+48	CE	HMA	35	35	50.0	0.0	N/A	0.0	5.6	0
LT 1080+35	PE W/MB	Earth/ Agg.	18	18	80.9	15.9	1.1	2.2	0.0	80.9
RT 1080+99	CE	CONC	34	34	48.9	0.0	N/A	0.0	5.5	0
LT 1081+30	PE W/MB	Earth/ Agg.	18	18	80.9	15.9	1.1	2.2	0.0	80.9
LT 1082+25	PE W/MB	Earth/ Agg.	18	18	80.9	15.9	1.1	2.2	0.0	80.9
LT 1083+00	PE W/MB	Earth/ Agg.	18	18	80.9	15.9	1.1	2.2	0.0	80.9
RT 1083+89	CE	HMA	34	34	48.9	0.0	N/A	0.0	5.5	0
LT 1084+25	PE W/MB	Earth/ Agg.	18	18	80.9	15.9	1.1	2.2	0.0	80.9
LT 1084+80	PE W/MB	Earth/ Agg.	18	18	80.9	15.9	1.1	2.2	0.0	80.9
LT 1085+50	PE W/MB	Earth/ Agg.	24	24	86.2	16.9	1.3	2.7	0.0	80.9
RT 1087+15	SIDEROAD	HMA	73	73	92.2	0.0	N/A	0.0	10.3	0
RT 1090+50	SIDEROAD	HMA	50	50	66.7	0.0	N/A	0.0	7.5	0
LT 1092+00	PE W/MB	AGG	18	18	80.9	15.9	1.1	2.2	0.0	0
LT 1095+37	SIDEROAD	HMA	45	45	61.1	0.0	N/A	0.0	6.8	0
RT 1095+45	PE W/MB	BIT	24	24	37.8	8.9	N/A	0.0	4.2	0
LT 1097+??	PE	CONC	24	24	37.8	0.0	N/A	0.0	4.2	0
RT 1099+25	CE ENTR	CONC	64	35	50.0	0.0	N/A	0.0	5.6	0
RT 1100+37	ENTR	CONC	77	35	50.0	0.0	N/A	0.0	5.6	0
LT 1102+40	SIDEROAD	HMA	40	40	55.6	0.0	N/A	0.0	6.2	0
LT 1105+27	CE	CONC	50	35	50.0	0.0	N/A	0.0	5.6	0
LT 1107+16	CE	CONC	18	24	37.8	0.0	N/A	0.0	4.2	0
RT 1111+~60	PE W/MB	Earth/ Agg.	75	24	86.2	16.9	1.3	2.7	0.0	86.2
LT 1111+75.6	SIDEROAD	HMA	130	130	155.6	0.0	N/A	0.0	17.4	0
Total					1994.7	169.0		26.1	131.9	730.7

LOCATION (LT/RT) (STA)	TYPE OF ENTRANCE	EX MAT TYPE	EX WIDTH FOOT	WIDTH FOOT	AREA SQ YD	HMA 3-1/2" TON	VOLUME (AGG) CU YD	AGG 2" TON	HMA VD TON	PREP OF BASE SQ YD
RT 319+50	PE	AGG	30	24	40.9	8.0	1.3	2.7	0.0	40.9
RT 321+06	PE	AGG	49	24	40.9	8.0	1.3	2.7	0.0	40.9
LT SUDDUTH RD.	SIDEROAD	HMA	22	22	35.6	0.0	N/A	0.0	4.0	
RT SUDDUTH RD.	SIDEROAD	HMA	22	22	35.6	0.0	N/A	0.0	4.0	
LT 375+50	MB			20	37.3	7.3	N/A	0.0	0.0	
RT 375+50	PE	AGG	44	24	40.9	8.0	1.3	2.7	0.0	40.9
LT 378+21	PE		53	24	40.9	8.0	1.3	2.7	0.0	40.9
LT 392+66	PE w/MB	AGG	53	24	86.2	16.9	1.3	2.7	0.0	86.2
RT 394+51	PE	AGG	45	24	40.9	8.0	1.3	2.7	0.0	40.9
LT 395+13	PE	AGG	45	24	40.9	8.0	1.3	2.7	0.0	40.9
LT 397+26	MB			20	37.3	7.3	N/A	0.0	0.0	
RT 397+26	PE		38	24	40.9	8.0	1.3	2.7	0.0	40.9
LT 397+67	MB			20	37.3	7.3	N/A	0.0	0.0	
RT 397+67	PE		32	24	40.9	8.0	1.3	2.7	0.0	40.9
LT 399+09	MB			20	37.3	7.3	N/A	0.0	0.0	
RT 399+09	PE		42	24	40.9	8.0	1.3	2.7	0.0	40.9
LT 400+15	MB			20	37.3	7.3	N/A	0.0	0.0	
RT 400+15	PE		36	24	40.9	8.0	1.3	2.7	0.0	40.9
LT 402+74	MB			20	37.3	7.3	N/A	0.0	0.0	
RT 402+74	PE		48	24	40.9	8.0	1.3	2.7	0.0	40.9
RT 404+57	PE		32	24	40.9	8.0	1.3	2.7	0.0	40.9
LT 405+07	MB			20	37.3	7.3	N/A	0.0	0.0	
RT 405+07	PE		33	24	40.9	8.0	1.3	2.7	0.0	40.9
LT 408+??	MB			20	37.3	7.3	N/A	0.0	0.0	
RT 408+48	PE		46	24	40.9	8.0	1.3	2.7	0.0	40.9
LT 413+72	PE		50	24	40.9	8.0	1.3	2.7	0.0	40.9
RT 436+62	PE		43	24	40.9	8.0	1.3	2.7	0.0	40.9
RT 438+24	ENTR		18	18	35.6	7.0	1.1	2.2	0.0	0.0
LT 438+52	MB			20	37.3	7.3	N/A	0.0	0.0	
RT 438+80	ENTR		18	18	35.6	7.0	1.1	2.2	0.0	0.0
RT 440+19	PE		18	18	35.6	7.0	1.1	2.2	0.0	35.6
LT 444+21	MB			20	37.3	7.3	N/A	0.0	0.0	
RT 444+21	PE		64	24	40.9	8.0	1.3	2.7	0.0	40.9
LT 446+41	MB			20	37.3	7.3	N/A	0.0	0.0	
RT 446+41	PE		40	24	40.9	8.0	1.3	2.7	0.0	40.9
LT 449+66	MB			20	37.3	7.3	N/A	0.0	0.0	
RT 449+66	PE		36	24	40.9	8.0	1.3	2.7	0.0	40.9
LT 451+36	MB			20	37.3	7.3	N/A	0.0	0.0	
RT 451+36	PE		37	24	40.9	8.0	1.3	2.7	0.0	40.9
LT 455+87	MB			20	37.3	7.3	N/A	0.0	0.0	
RT 455+87	PE	CONC	47	24	40.9	0.0	0.0	0.0	4.6	
LT 456+57	PE w/MB	AGG	44	24	86.2	16.9	1.3	2.7	0.0	86.2
LT 460+44	PE	AGG	48	24	40.9	8.0	1.3	2.7	0.0	40.9
LT Barber Rd.	SIDEROAD	HMA	46	46	62.2	0.0	N/A	0.0	7.0	
RT Holten Rd.	SIDEROAD	HMA	50	50	66.7	0.0	N/A	0.0	7.5	
LT 474+37	PE	AGG	34	24	40.9	8.0	1.3	2.7	0.0	40.9
LT 475+49	PE	AGG	34	24	40.9	8.0	1.3	2.7	0.0	40.9
LT 497+93	PE w/MB		64	24	86.2	16.9	1.3	2.7	0.0	86.2
LT 500+32	PE		29	24	40.9	8.0	1.3	2.7	0.0	40.9
LT 511+65	PE w/MB		34	24	86.2	16.9	1.3	2.7	0.0	86.2
LT 513+58	PE		58	24	40.9	8.0	1.3	2.7	0.0	40.9
LT 517+38	PE w/MB		45	24	86.2	16.9	1.3	2.7	0.0	86.2
LT 518+38	PE w/MB		48	24	86.2	16.9	1.3	2.7	0.0	86.2
LT 519+56	PE		21	21	38.2	7.5	1.2	2.5	0.0	38.2
LT 520+98	PE		25	24	40.9	8.0	1.3	2.7	0.0	40.9
LT 522+24	PE w/MB		24	24	86.2	16.9	1.3	2.7	0.0	86.2
LT 522+90	ENTR		22	22	39.1	7.7	1.3	2.6	0.0	
Total					2614.2	465.2		102.3	27.0	1740.4

FILE NAME =	USER NAME = novakovid	DESIGNED -	REVISED - 2/19/03 JCN
os:\pw\work\pwsdot\novakovid\0217723\ent.ppp.dgn		DRAWN - CADD	REVISED - 4/01/04 JCN
ENT PPP.DGN	PLOT SCALE = 100.000' / IN.	CHECKED - JCN	REVISED -
	PLOT DATE = Dec-02-2010 02:21:51PM	DATE - FEBRUARY 23, 1999	REVISED -

**STATE OF ILLINOIS
DEPARTMENT OF TRANSPORTATION**

**DIST. 6 DETAILS FOR RURAL/URBAN ENT., MAILBOX
TURNOUT & SIDEROADS W/O CONC. GUTTER (3P-PROJ.)**

SCALE: SHEET NO. 1 OF 3 SHEETS STA. TO STA.

F.A.S. RTE.	SECTION	COUNTY	TOTAL SHEETS	SHEET NO.
618	(B)RS-4, (O-15)RS-2	SANGAMON	32	32
FED. ROAD DIST. NO. ILLINOIS FED. AID PROJECT			CONTRACT NO. 72D56	