

STATE OF ILLINOIS
DEPARTMENT OF TRANSPORTATION
DIVISION OF HIGHWAYS

PROPOSED
HIGHWAY PLANS

F.A.P. ROUTE 823 (IL15)
SECTION D7-BEAM REPAIR 2011-2

BEAM REPAIR
WAYNE COUNTY

C-97-012-11

F.A.P. RTE.	SECTION	COUNTY	TOTAL SHEETS	SHEET NO.
823	D7-BEAM REPAIR 2011-2	WAYNE	4	1
		ILLINOIS	CONTRACT NO. 74502	

FOR INDEX OF SHEETS, SEE SHEET NO. 2

ADT = 2400 (2007)

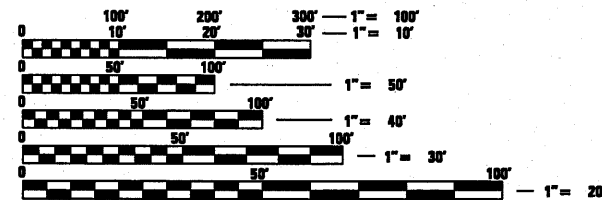

FULL SIZE PLANS HAVE BEEN PREPARED USING STANDARD ENGINEERING SCALES. REDUCED SIZED PLANS WILL NOT CONFORM TO STANDARD SCALES. IN MAKING MEASUREMENTS ON REDUCED PLANS, THE ABOVE SCALES MAY BE USED.

J.U.L.I.E.
 JOINT UTILITY LOCATION INFORMATION FOR EXCAVATION
 1-800-892-0123
 OR 811

PROJECT ENGINEER: TOM RONAN
PROJECT MANAGER: TOM RONAN

CONTRACT NO. 74502

SECTION D7 BEAM REPAIR 2011-2
WAYNE COUNTY
S.N. 096-0063

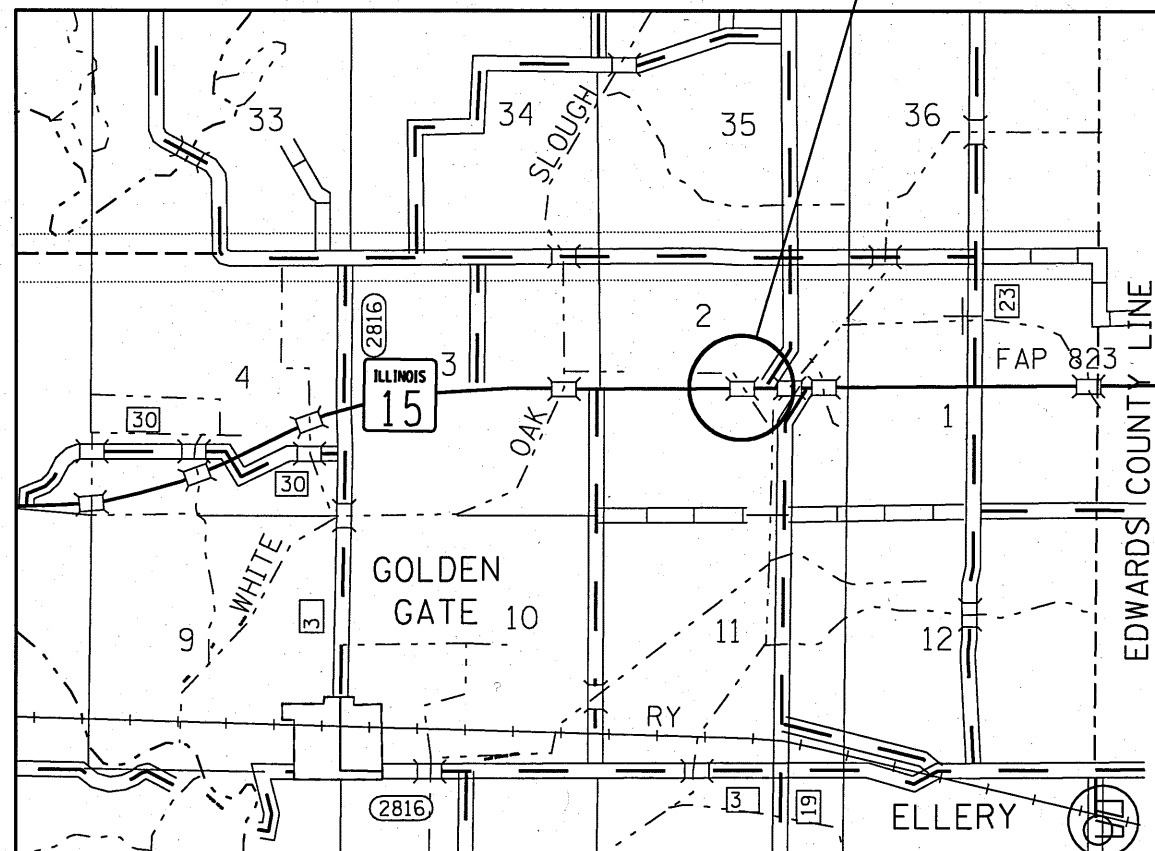

T 1 S

T 2 S



R 9 E

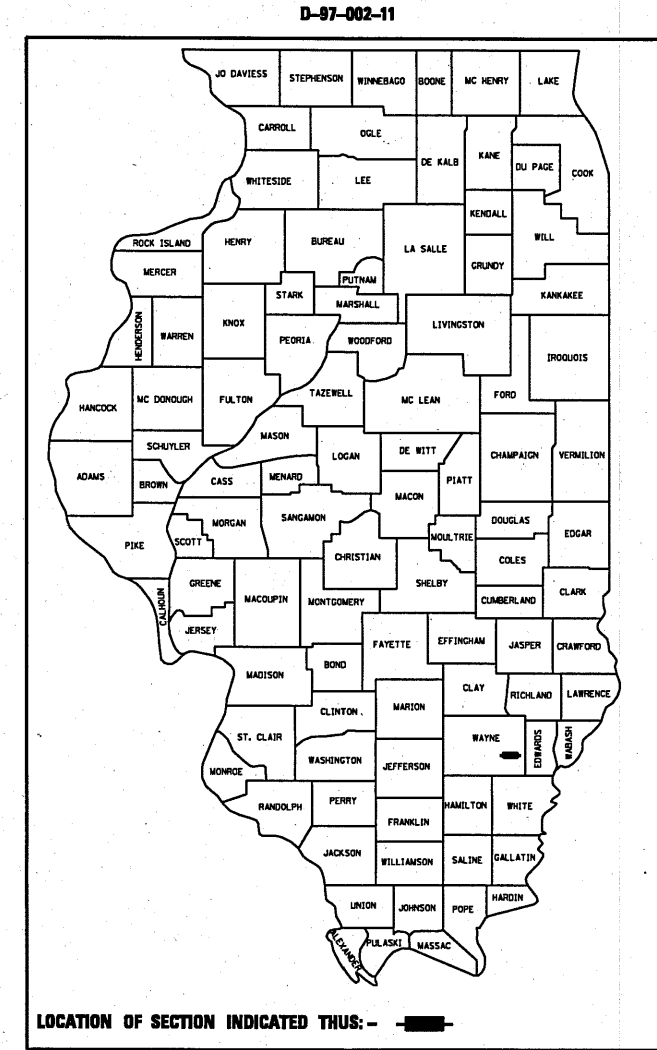

STATE OF ILLINOIS
 DEPARTMENT OF TRANSPORTATION
 DIVISION OF HIGHWAYS

SUBMITTED Oct 18 20 10
Roger L. Driskell
 DEPUTY DIRECTOR OF HIGHWAYS, REGION ENGINEER

Dec 10 20 10
Scott E. Stitt, P.E.
 acting ENGINEER OF DESIGN AND ENVIRONMENT

Dec 10 20 10
Christine M. Reed
 DIRECTOR OF HIGHWAYS, CHIEF ENGINEER

PRINTED BY THE AUTHORITY
OF THE STATE OF ILLINOIS