

STATE OF ILLINOIS  
DEPARTMENT OF TRANSPORTATION  
DIVISION OF HIGHWAYS

**PROPOSED  
HIGHWAY PLANS**

FAI ROUTE 70 PROJECT: HSIP-070-2(234)044  
SECTION 3-(3,4,5)-1  
MISCELLANEOUS STRIPING  
BOND COUNTY

C-98-006-11

F.A.I. RTE.	SECTION	COUNTY	TOTAL SHEETS	SHEET NO.
70	3-(3,4,5)-1	BOND	16	1
		ILLINOIS	CONTRACT NO. 76E53	

D-88-009-11



FOR INDEX OF SHEETS, SEE SHEET NO. 2

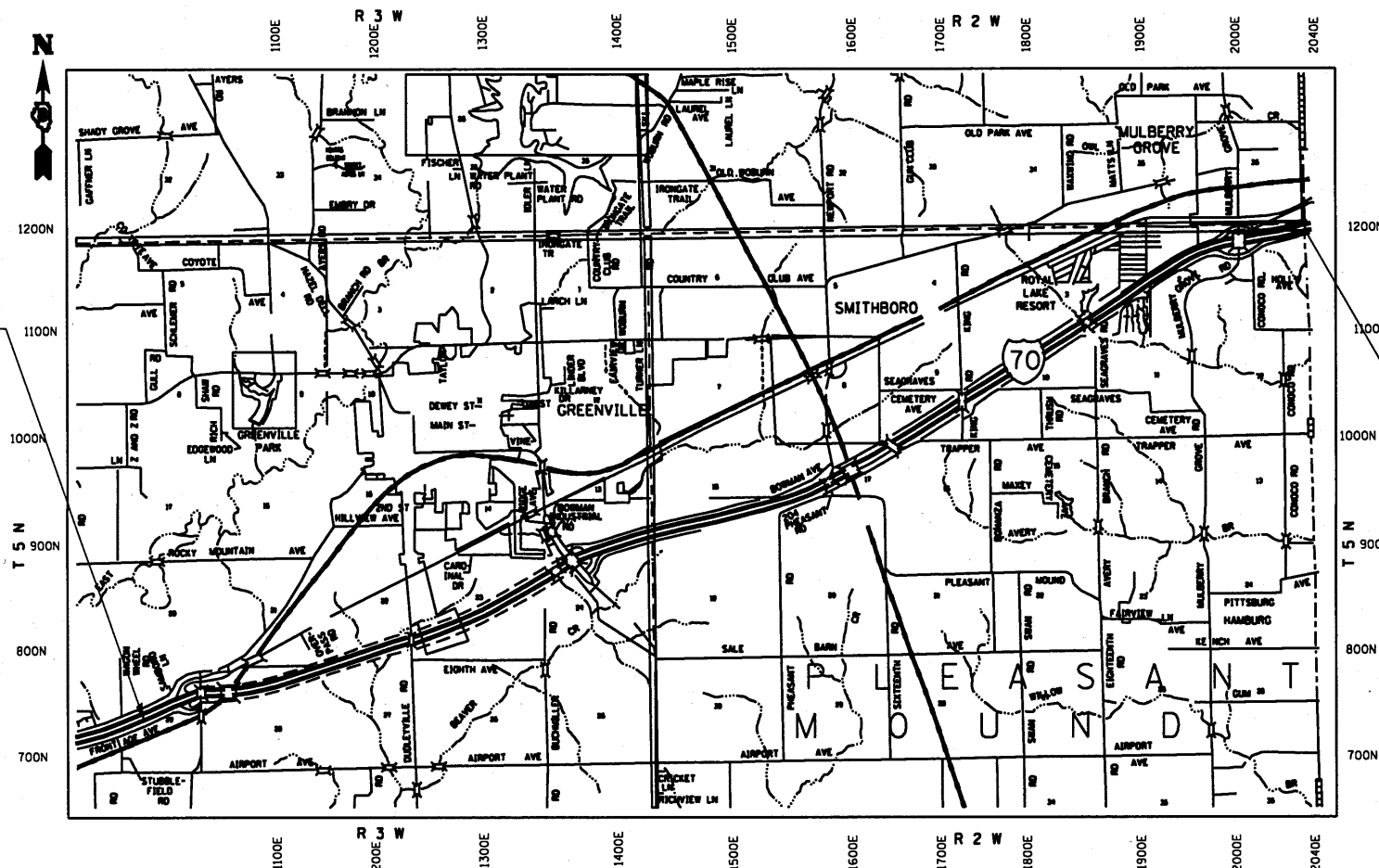

BEGIN PROJECT  
STA. 2330+00  
LAT. 38°50'60"N  
LONG. 89°27'47"W

END PROJECT  
STA. 3033+65  
LAT. 38°54'58"N  
LONG. 89°15'23"W

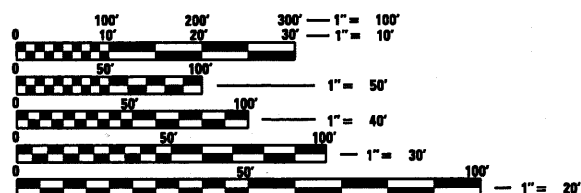

FULL SIZE PLANS HAVE BEEN PREPARED USING STANDARD ENGINEERING SCALES. REDUCED SIZED PLANS WILL NOT CONFORM TO STANDARD SCALES. IN MAKING MEASUREMENTS ON REDUCED PLANS, THE ABOVE SCALES MAY BE USED.

J.U.L.I.E.  
JOINT UTILITY LOCATION INFORMATION FOR EXCAVATION  
1-800-892-0123  
OR 811

PROJECT ENGINEER: TIM PADGETT (618) 346-3325  
PROJECT MANAGER: JEFF ABEL (618) 346-3283

CONTRACT NO. 76E53

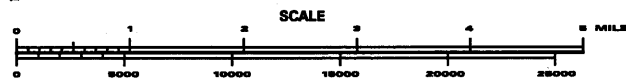

GROSS LENGTH = 70,365 FT. = 13.327 MILE  
NET LENGTH = 70,365 FT. = 13.327 MILE

STATE OF ILLINOIS  
DEPARTMENT OF TRANSPORTATION  
DIVISION OF HIGHWAYS

SUBMITTED 10/24 2010  
Mary Ramie  
DEPUTY DIRECTOR OF HIGHWAYS, REGION ENGINEER

Dec 10 2010  
Scott E. Stett, P.E.  
Acting ENGINEER OF DESIGN AND ENVIRONMENT

Dec 10 2010  
Christine M. Reed  
DIRECTOR OF HIGHWAYS, CHIEF ENGINEER

PRINTED BY THE AUTHORITY  
OF THE STATE OF ILLINOIS