



CONTRACT: 85513

POLE FEDER SIZES

Branch Circuit #	panel Circuit	CU Wire Size	Leaving Device	Load Device	Total Remaining Load (Amps)	Distance (Feet)	Wire Resistance Ohms/1000 ft	Voltage Drop	Cummulative Voltage Drop	% Drop at Applied Voltage
1	1,3	10	Panel	Pole C7	4.20	434.00	0.0012899	4.70	4.70	1.96%
2	1,3	10	Pole C7	Pole C8	1.40	95.00	0.0012899	0.34	5.05	2.10%
3	1,3	10	Pole C7	Pole S5	1.40	227.00	0.0012899	0.82	5.87	2.44%
4	2,4	10	Panel	Pole C10	4.20	473.00	0.0012899	5.13	5.13	2.14%
5	2,4	10	Pole C10	Pole C9	2.80	110.00	0.0012899	0.79	5.92	2.47%
6	2,4	10	Pole C9	Pole S6	1.40	211.00	0.0012899	0.76	6.68	2.78%
7	5,7	10	Panel	Pole S3	2.80	439.00	0.0012899	3.17	3.17	1.32%
8	5,7	10	Pole S3	Pole S1	1.40	261.00	0.0012899	0.94	4.11	1.71%
9	6,8	10	Panel	Pole S4	5.60	92.00	0.0012899	1.33	1.33	0.55%
10	6,8	10	Pole S4	Pole C4	4.20	145.00	0.0012899	1.57	2.90	1.21%
11	6,8	10	Pole C4	Pole C5	2.80	96.00	0.0012899	0.69	3.59	1.50%
12	6,8	10	Pole C5	Pole C6	1.40	261.00	0.0012899	0.94	4.54	1.89%
13	9,11	10	Panel	Pole C2	4.20	108.00	0.0012899	1.17	1.17	0.49%
14	9,11	10	Pole C2	Pole C1	2.80	139.00	0.0012899	1.00	2.17	0.91%
15	9,11	10	Pole C1	Pole S2	1.40	234.00	0.0012899	0.85	3.02	1.26%
16	10,12	10	Panel	Pole C3	1.40	175.00	0.0012899	0.63	0.63	0.26%

ALL WIRING TO BE #10 AWG.
PROVIDE A #10 CU GROUNDING
CONDUCTORS WITH ALL CIRCUITS.

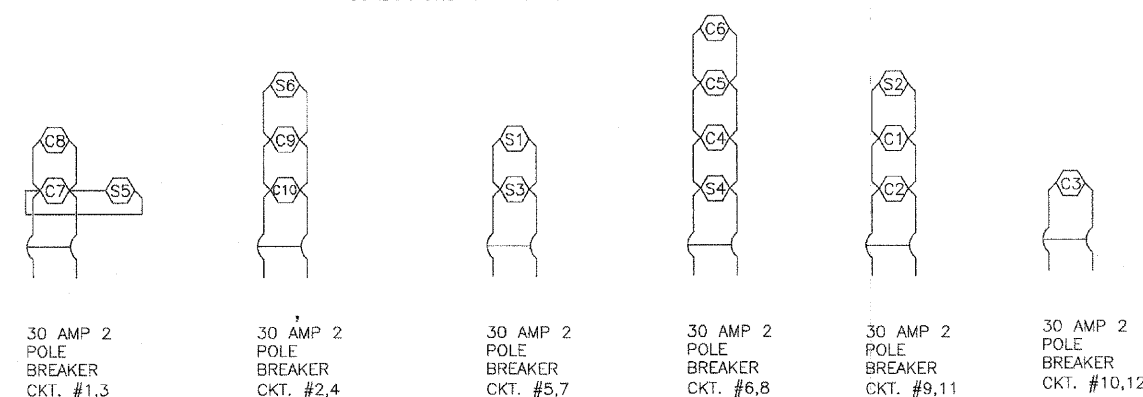

WIRING SCHEMATIC

NO SCALE/PURELY DIAGRAMMATIC

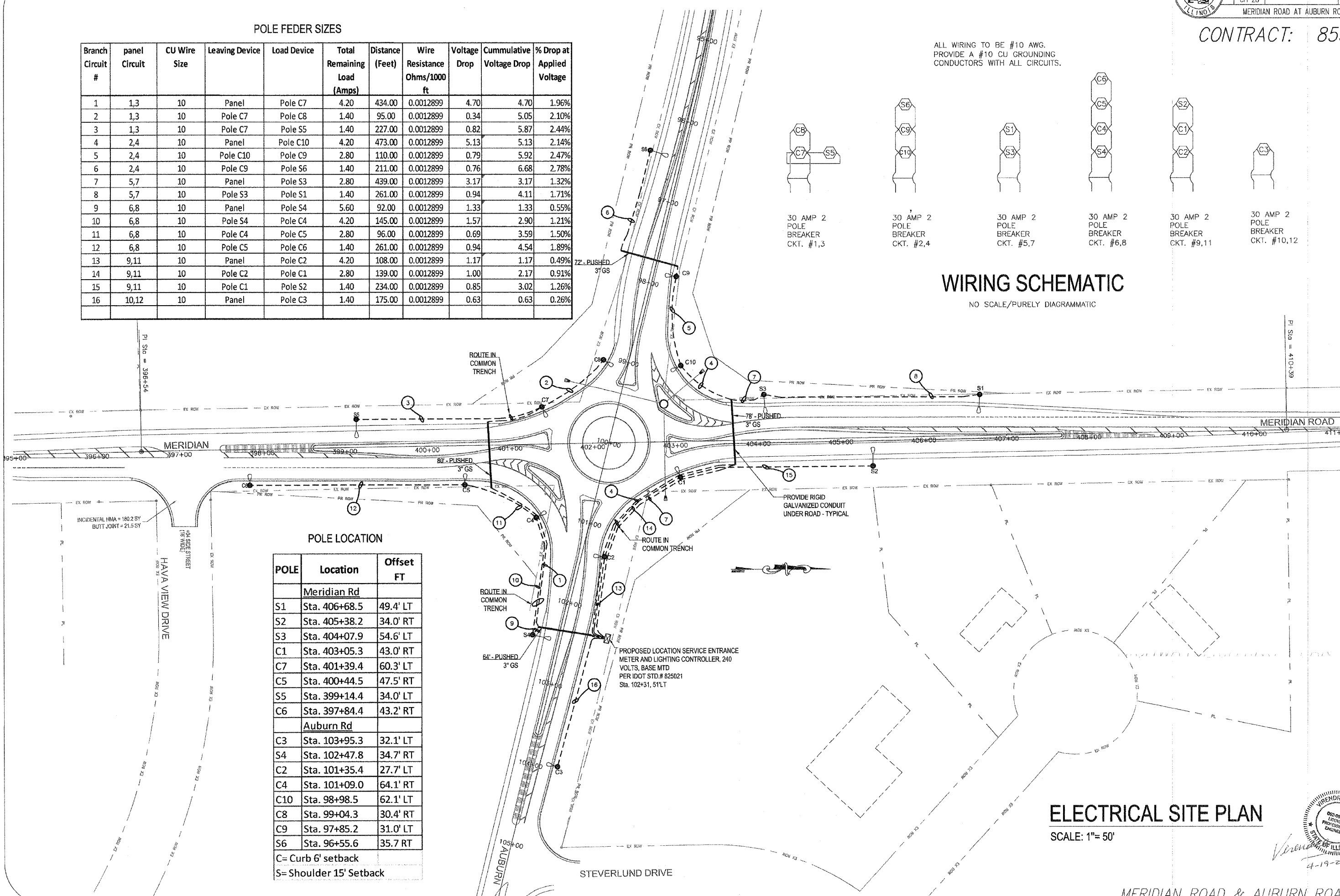

POLE LOCATION

POLE	Location	Offset FT
Meridian Rd		
S1	Sta. 406+68.5	49.4' LT
S2	Sta. 405+38.2	34.0' RT
S3	Sta. 404+07.9	54.6' LT
C1	Sta. 403+05.3	43.0' RT
C7	Sta. 401+39.4	60.3' LT
C5	Sta. 400+44.5	47.5' RT
S5	Sta. 399+14.4	34.0' LT
C6	Sta. 397+84.4	43.2' RT
Auburn Rd		
C3	Sta. 103+95.3	32.1' LT
S4	Sta. 102+47.8	34.7' RT
C2	Sta. 101+35.4	27.7' LT
C4	Sta. 101+09.0	64.1' RT
C10	Sta. 98+98.5	62.1' LT
C8	Sta. 99+04.3	30.4' RT
C9	Sta. 97+85.2	31.0' LT
S6	Sta. 96+55.6	35.7 RT
C= Curb 6' setback		
S= Shoulder 15' Setback		

ELECTRICAL SITE PLAN

SCALE: 1"= 50'

