

SECTION 35, TOWNSHIP 34, RANGE 3
 SECTION 36, TOWNSHIP 34, RANGE 3
 SECTION 25, TOWNSHIP 34, RANGE 3
 SECTION 26, TOWNSHIP 34, RANGE 3

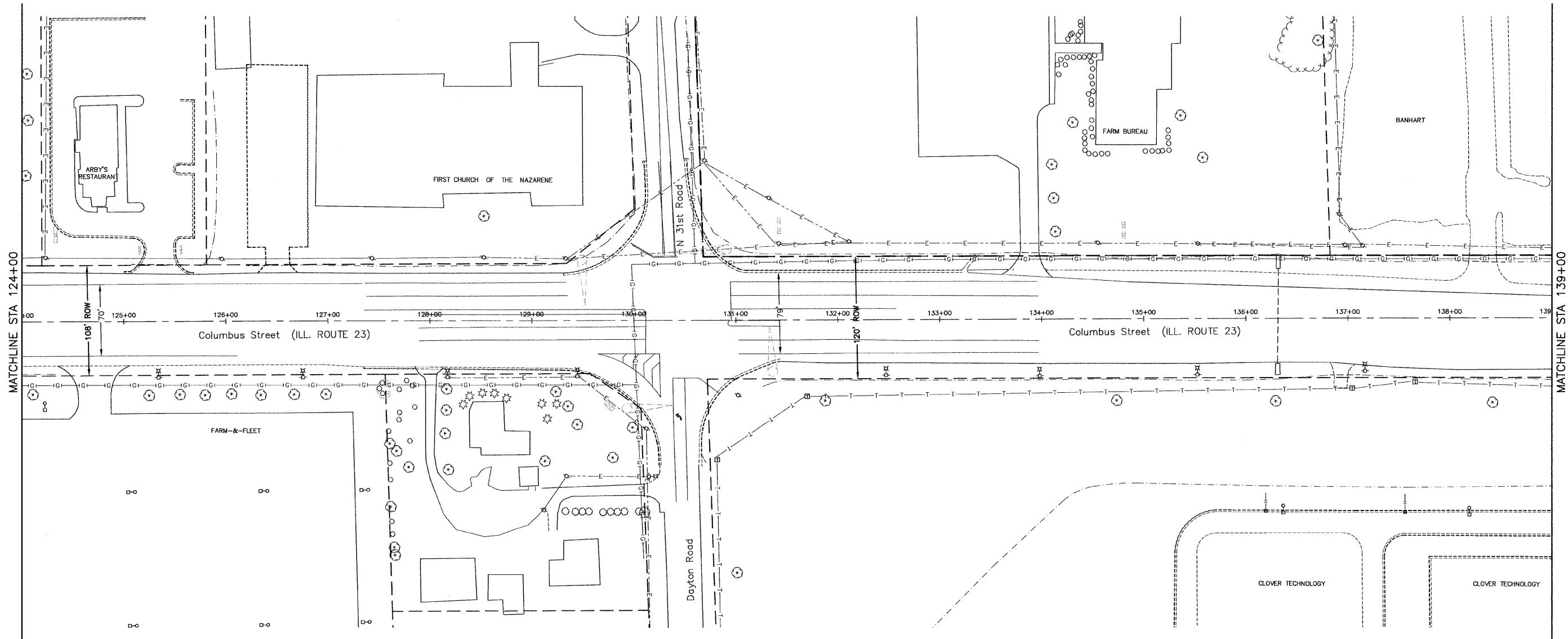
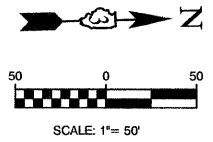

LINE & SYMBOL LEGEND			
	EXISTING FIRE HYDRANT		EXISTING CONTROL CABINET
	EXISTING VALVE		EXISTING BURIED TELEPHONE
	EXISTING INLET		EXISTING STEEL LIGHT POLE
	EXISTING CATCH BASIN		EXISTING TREE LINE
	EXISTING MANHOLE		EXISTING DITCH SWALE
	EXISTING LIGHT POLE		EXISTING STORM SEWER
	EXISTING POWER POLE		EXISTING SANITARY SEWER
	EXISTING TREE		EXISTING FORCE MAIN
	EXISTING BUSH / HEDGE		EXISTING WATER MAIN
	EXISTING EVERGREEN		EXISTING OVERHEAD ELECTRIC
	EXISTING TRAFFIC SIGNAL POST		EXISTING BURIED ELECTRIC
	EXISTING TRAFFIC SIGNAL MAST ARM		EXISTING GAS MAIN
			EXISTING BURIED TELEPHONE
			EXISTING CHAIN LINK FENCE
			PROPOSED CONIFEROUS EVERGREEN TREE
			PROPOSED DECIDUOUS SHADE TREE
			PROPOSED ORNAMENTAL TREE
			TREE REMOVAL & REPLACEMENT
			PLANT QUANTITY
			PLANT CODE NUMBER
			APPARENT RIGHT-OF-WAY (PER CITY OF OTTAWA)

NOTES

ALL PLANTINGS SHALL FOLLOW IDOT BUREAU OF DESIGN & ENVIRONMENT MANUAL - CHAPTER 59 - LANDSCAPE DESIGN AND EROSION CONTROL 59-7.09 PLANTING IN URBANIZED AREA FOR SIGHT DISTANCES.

ALL AREAS TO BE LANDSCAPED SHALL BE EXCAVATED TO THE DEPTH APPROPRIATE FOR THE PROPOSED PLANTINGS. NO SOD SHALL REMAIN IN NEW PLANTING AREAS.

PLANT QUANTITIES SHOWN ON DRAWINGS ARE APPROXIMATE. CONTRACTOR SHALL PROVIDE PLANT MATERIALS SUFFICIENT TO COVER AREAS SHOWN ON PLANS AT THE REQUIRED SPACING.

FOR LANDSCAPE PLANTING DETAILS AND ADDITIONAL PLANTING NOTES, SEE SHEET 27.

NO PLANTING SHALL BE CLOSER THAN 18' FROM BACK OF CURB OR EDGE OF PAVEMENT. NO TREES SHALL BE CLOSER THAN 4' FROM BACK OF MEDIAN CURB.

FOR PLANT SCHEDULE SEE SHEET 2.

CONTRACTOR SHALL REPAIR TO ITS ORIGINAL CONDITION ANY AREA OR ITEM DAMAGED AS A RESULT OF THEIR WORK. ANY EXISTING LANDSCAPE THAT IS DAMAGED OR REMOVED DURING CONSTRUCTION SHALL BE REPAIRED AND/OR REPLACED IN KIND AND EQUIVALENT SIZE. CONTRACTOR SHALL REPAIR AND SEED IN KIND, AT HIS COST, ALL TURF AREAS DAMAGED AS A RESULT OF PROJECT CONSTRUCTION.

NO SOIL SHALL LEAVE THE JOB SITE. ALL EXISTING MATERIAL IS TO REMAIN AT LOCATION.

FILE NAME = 10159-PLAN-01 - N-RT23-04	USER NAME =	DESIGNED - JRA	REVISED -
		CHECKED - BDB	REVISED -
	PLOT SCALE =	DRAWN - JJB/JRA	REVISED -
	PLOT DATE = 10-29-2010	CHECKED - BDB	REVISED -

STATE OF ILLINOIS
 DEPARTMENT OF TRANSPORTATION

CITY OF OTTAWA ENTRY CORRIDOR TREE PLANTING PROJECT LANDSCAPING PLAN		F.A.P. RTE. 68,623	SECTION 10-00164-00-LS	COUNTY LASALLE	TOTAL SHEETS 27	SHEET NO. 23
SCALE: 1"=50'	SHEET NO. 23 OF 27 SHEETS	STA.	TO STA.	FED. ROAD DIST. NO. 3	ILLINOIS	FED. AID PROJECT TE-00D3(061)

LAST SAVED BY: SALVAREZ ON 11/29/10
 PLOTTED BY: JGARE ALVAREZ ON 11/29/10