



LAYOUT	MWH	08/31/10
DRAWN	MWH	11/04/10
REVIEWED	DPA	11/04/10

FILE NAME = \\s05jobs\06R1583\CADD\Road\Sheet\C-302-XS-EASTWEST.dgn
 USER NAME = MWH
 PLOT SCALE = AS SHOWN
 PLOT DATE = 11/05/2010

DESIGNED - DPA
 DRAWN - MWH
 CHECKED - DPA
 DATE - 11/04/10

REVISED -
 REVISED -
 REVISED -

**STATE OF ILLINOIS
 DEPARTMENT OF TRANSPORTATION**

**EAST-WEST ROADWAY SOUTH CROSS SECTIONS
 NORTHERN ILLINOIS UNIVERSITY
 FAR WEST CAMPUS EXPANSION**

SCALE: AS SHOWN SHEET NO. OF SHEETS STA. 201+92.34 TO STA. 204+00.00

F.A.P. RTE.	SECTION	COUNTY	TOTAL SHEETS	SHEET NO.
567	06-00002-00-PV	DEKALB	148	99
FED. ROAD DIST. NO.			ILLINOIS FED. AID PROJECT	
			CONTRACT NO. 87476	

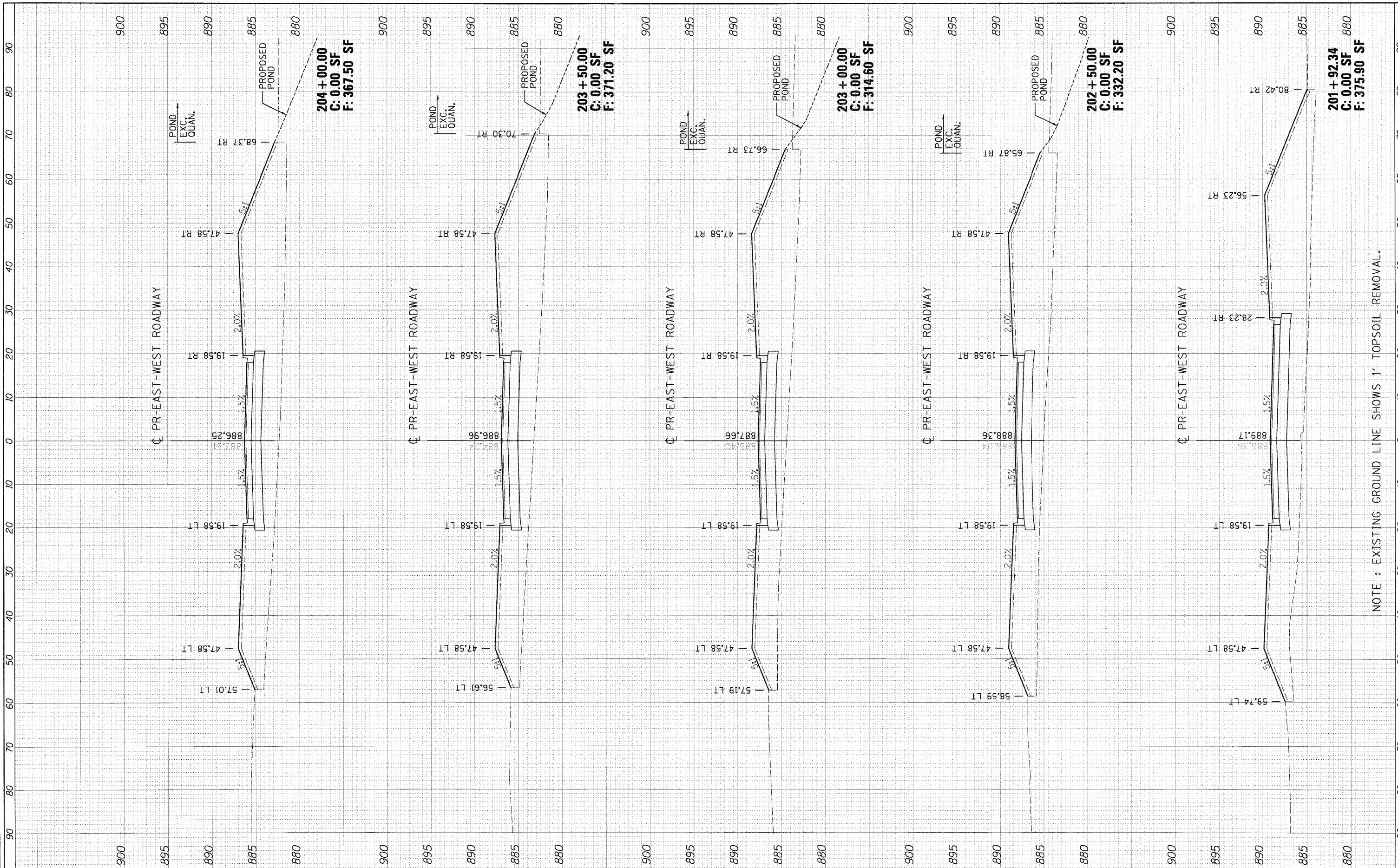

NOTE : EXISTING GROUND LINE SHOWS 1' TOPSOIL REMOVAL.