

ROUTE NO.	SECTION	COUNTY	TOTAL SHEETS	THIS SHEET
F.A.U. 6739	*	TAZEWELL	36	18

FED. ROAD DIST. NO. 7 | ILLINOIS | PROJECT M-5093-129  
 \*05-00103-00-FP  
 CONTRACT NO. 89493

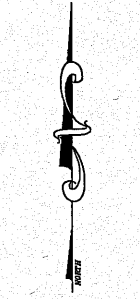

SCALE: 1" = 10'

**LEGEND**

- 790.89 PROPOSED PAVEMENT ELEVATION
- 790.37 EXISTING PAVEMENT ELEVATION

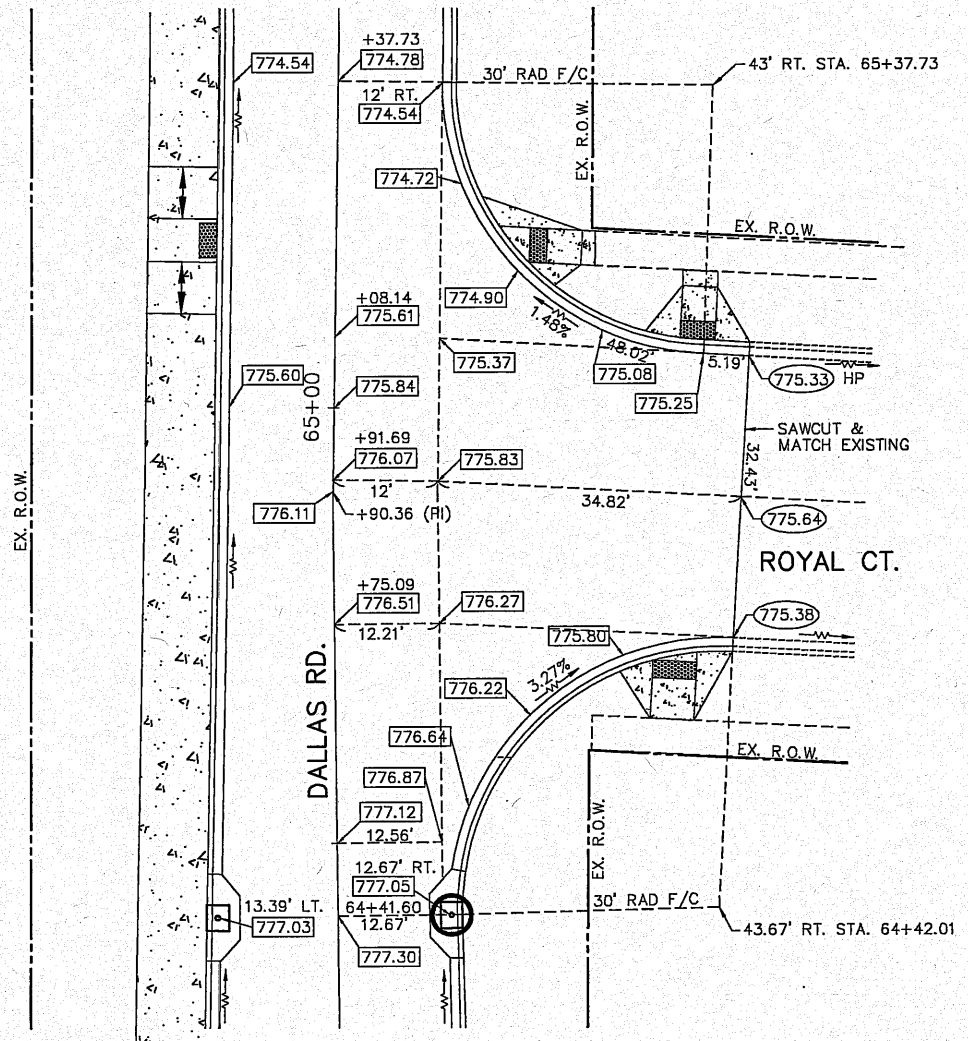

DALLAS ROAD / ROYAL COURT INTERSECTION

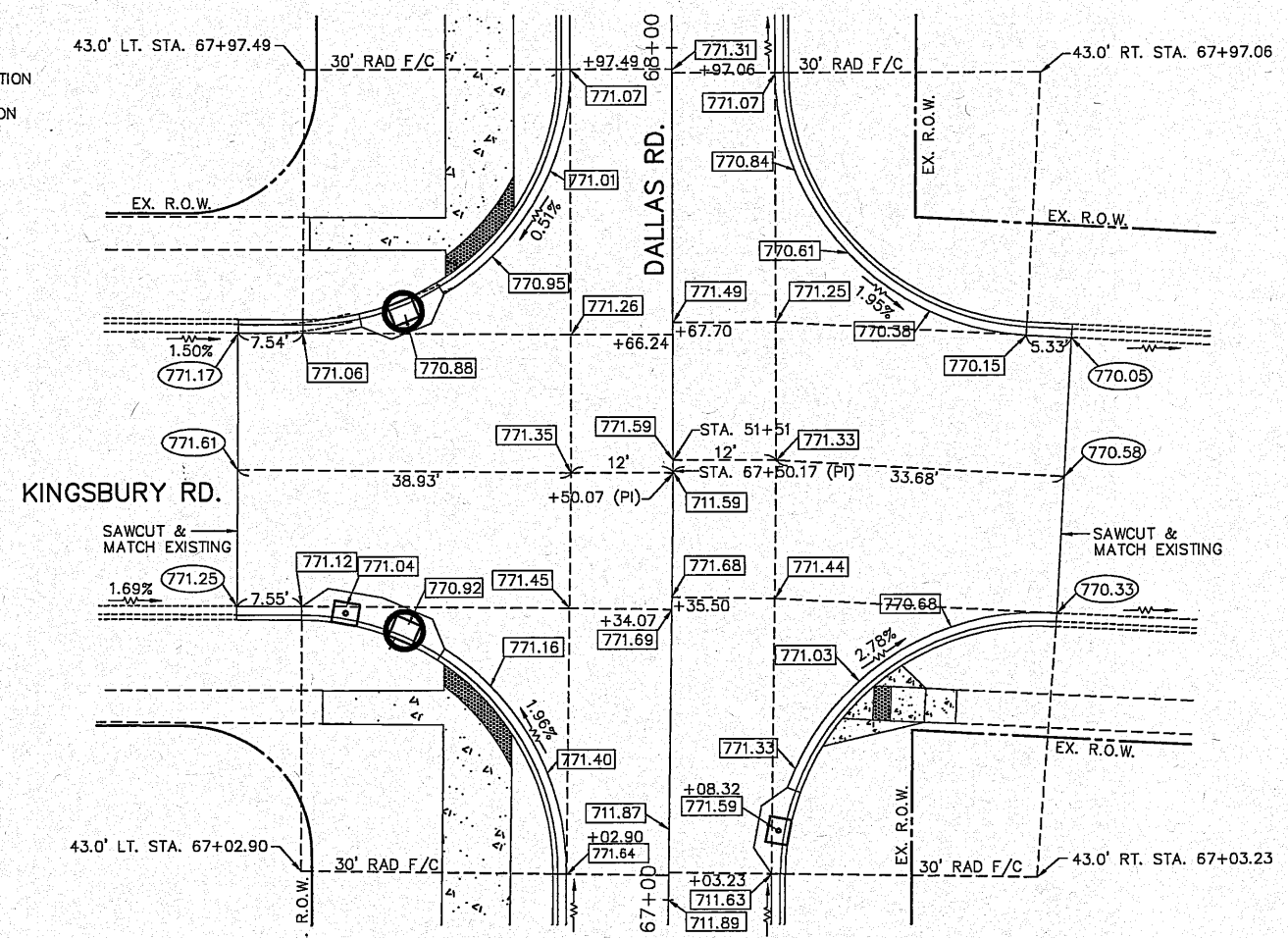

DALLAS ROAD / KINGSBURY ROAD INTERSECTION

INTERSECTION DETAILS DALLAS ROAD - PHASE ONE		AUSTIN ENGINEERING CO., INC.	
FOR: CITY OF WASHINGTON		CIVIL ENGINEERS LICENSE No. 184-001148	
DATE 09/13/10	SCALE 1" = 10'	PROJECT 20-07-005	SHEET NO. 18 OF 36