

| | | | | |
|--|---------|----------|--------------|------------|
| ROUTE NO. | SECTION | COUNTY | TOTAL SHEETS | THIS SHEET |
| F.A.U. 6739 | * | TAZEWELL | 36 | 23 |
| FED. ROAD DIST. NO. 7 | | ILLINOIS | PROJECT | M-6093-129 |
| * 05-00103-00-FP CONTRACT NO. 89493 | | | | |

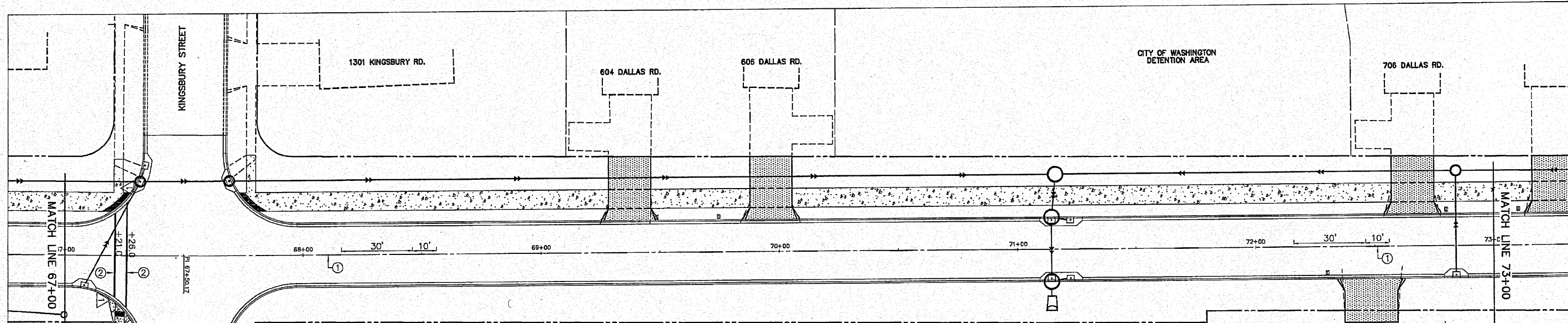
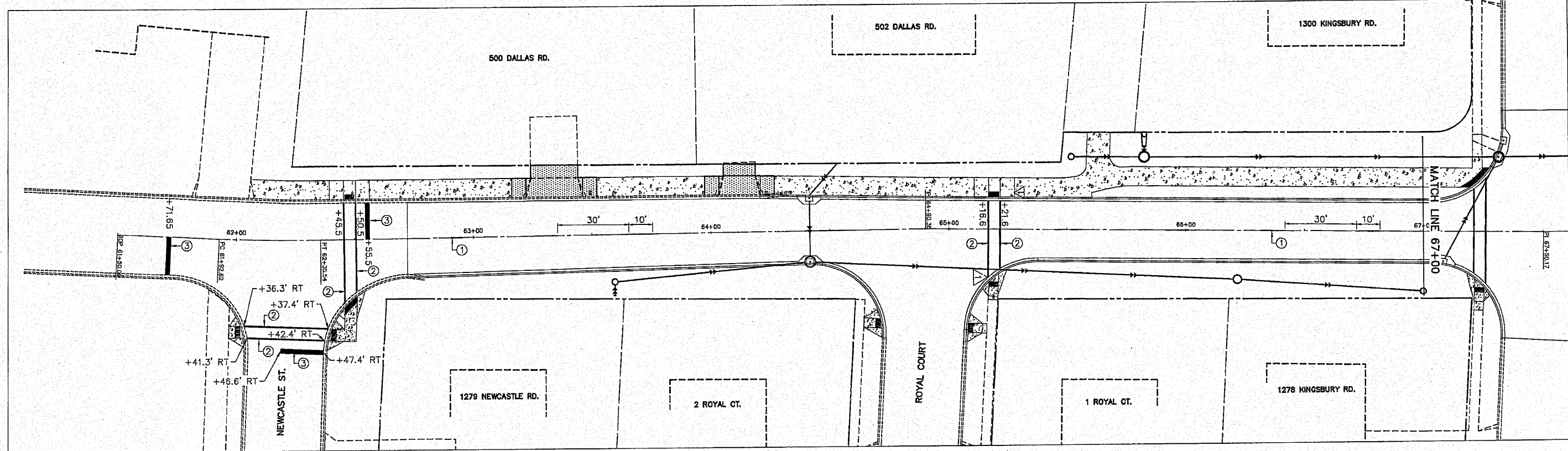

PAVEMENT MARKING LEGEND

- ① THERMOPLASTIC PAVEMENT MARKING - LINE 4" - SKIP DASH (YELLOW) ▲ NONVEHICULAR SIGN W11-2 (30x30)
 - ② THERMOPLASTIC PAVEMENT MARKING - LINE 6" - WHITE ▽ DIAGONAL DOWNWARD POINTING ARROW W16-7p (24x12)
 - ③ THERMOPLASTIC PAVEMENT MARKING - LINE 24" - WHITE □ METAL POST - TYPE A (14 FT)
- STRIPING SHALL BE CONSTRUCTED IN ACCORDANCE WITH IDOT STANDARD 780001-02

PAVEMENT MARKINGS
DALLAS ROAD - PHASE ONE
FOR: CITY OF WASHINGTON
DATE: 09/13/10 SCALE: 1" = 20'

AUSTIN ENGINEERING CO., INC.
CIVIL ENGINEERS
PEORIA ILLINOIS
LICENSE No. 184-001140
PROJECT: 20-07-005
SHEET NO. 23 OF 36