

**REMOVAL NOTES**

1. BRICK PAVERS THAT ARE REMOVED FOR THE REMOVAL OR INSTALLATION OF PARKING METER POSTS, LIGHT POLES, OR JUNCTION BOXES SHALL BE REINSTALLED AT THEIR ORIGINAL LOCATIONS UNLESS OTHERWISE DIRECTED BY THE ENGINEER.
2. AT LOCATIONS WHERE PROPOSED IMPROVEMENTS ABUT EXISTING BRICK PAVER SIDEWALKS TO REMAIN, THE CONTRACTOR SHALL TAKE CARE NOT TO DISTURB THE ADJACENT FEATURES. THE CONTRACTOR MAY ELECT TO REMOVE AND REINSTALL ADJACENT BRICK PAVERS AT NO ADDITIONAL COST TO THE CONTRACT SHOULD IT FACILITATE HIS CONSTRUCTION OPERATIONS.
3. THE CONTRACTOR SHALL MAKE FULL DEPTH SAWCUTS AT ALL PAVEMENT, SIDEWALK, CURB, AND CURB AND GUTTER REMOVAL LIMITS.
4. THE REMOVAL LIMITS MAY BE ADJUSTED AS DIRECTED BY THE ENGINEER.
5. THE SIDEWALK REMOVAL LIMITS FOR PARKING METER POST REMOVAL SHALL BE TWO FEET ALONG THE LENGTH OF THE PANEL AS SHOWN ON THE MISCELLANEOUS DETAILS OR AS OTHERWISE DIRECTED BY THE ENGINEER. THE BRICK PAVER REMOVAL LIMITS FOR PARKING METER POST REMOVAL OR INSTALLATION SHALL BE TWO FEET WIDE AND TWO FEET LONG OR AS OTHERWISE DIRECTED BY THE ENGINEER. THE SIDEWALK AND BRICK PAVER REMOVAL LIMITS FOR LIGHT POLE AND JUNCTION BOX REMOVAL SHALL BE FIVE FEET LONG FOR THE WIDTH OF THE SIDEWALK OR PAVERS OR AS OTHERWISE DIRECTED BY THE ENGINEER. THE SIDEWALK AND BRICK PAVER REMOVAL LIMITS FOR LIGHT POLE AND JUNCTION BOX INSTALLATION SHALL BE TEN FEET LONG FOR THE WIDTH OF THE SIDEWALK OR PAVERS OR AS OTHERWISE DIRECTED BY THE ENGINEER. THE REMOVAL LIMITS SHALL BE REDUCED AS DIRECTED BY THE ENGINEER TO MINIMIZE THE AMOUNT OF REMOVAL AND SUBSEQUENT REPLACEMENT REQUIRED FOR THIS WORK.
6. EXISTING ROADWAY LIGHTING POLES OWNED BY THE AMERIN I.P. UTILITY DENOTED WITH A  $\square$  BESIDE THE SYMBOL. ALL OTHERS ARE OWNED BY THE CITY OF CHAMPAIGN OR THE UNIVERSITY OF ILLINOIS. COORDINATE WITH CITY / AMERIN I.P. FOR REMOVAL OF UTILITY OWNED LIGHT POLES, FIXTURES AND WIRING.
7. WHERE ROADWAY LIGHTING POLES TO BE REMOVED ARE OWNED BY THE CITY, REMOVE WIRING BACK TO THE PREVIOUS LIGHT POLE IN THE CIRCUIT AND ABANDON CONDUIT IN PLACE. WHERE WIRING IS DIRECT BURIED DISCONNECT AND TERMINATE WIRING AT PREVIOUS LIGHT POLE IN THE CIRCUIT.

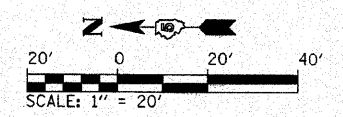

SEE PAVEMENT MARKING AND SIGNING PLAN FOR SIGNAGE REMOVAL AND RELOCATIONS.

THE LIMITS OF SIDEWALK REMOVAL AND BRICK PAVER REMOVAL ARE NOT SHOWN FOR THE REMOVAL AND/OR INSTALLATION OF LIGHT POLES, JUNCTION BOXES, OR PARKING METERS QUANTITIES FOR THIS WORK ARE INCLUDED ON THE PLANS.

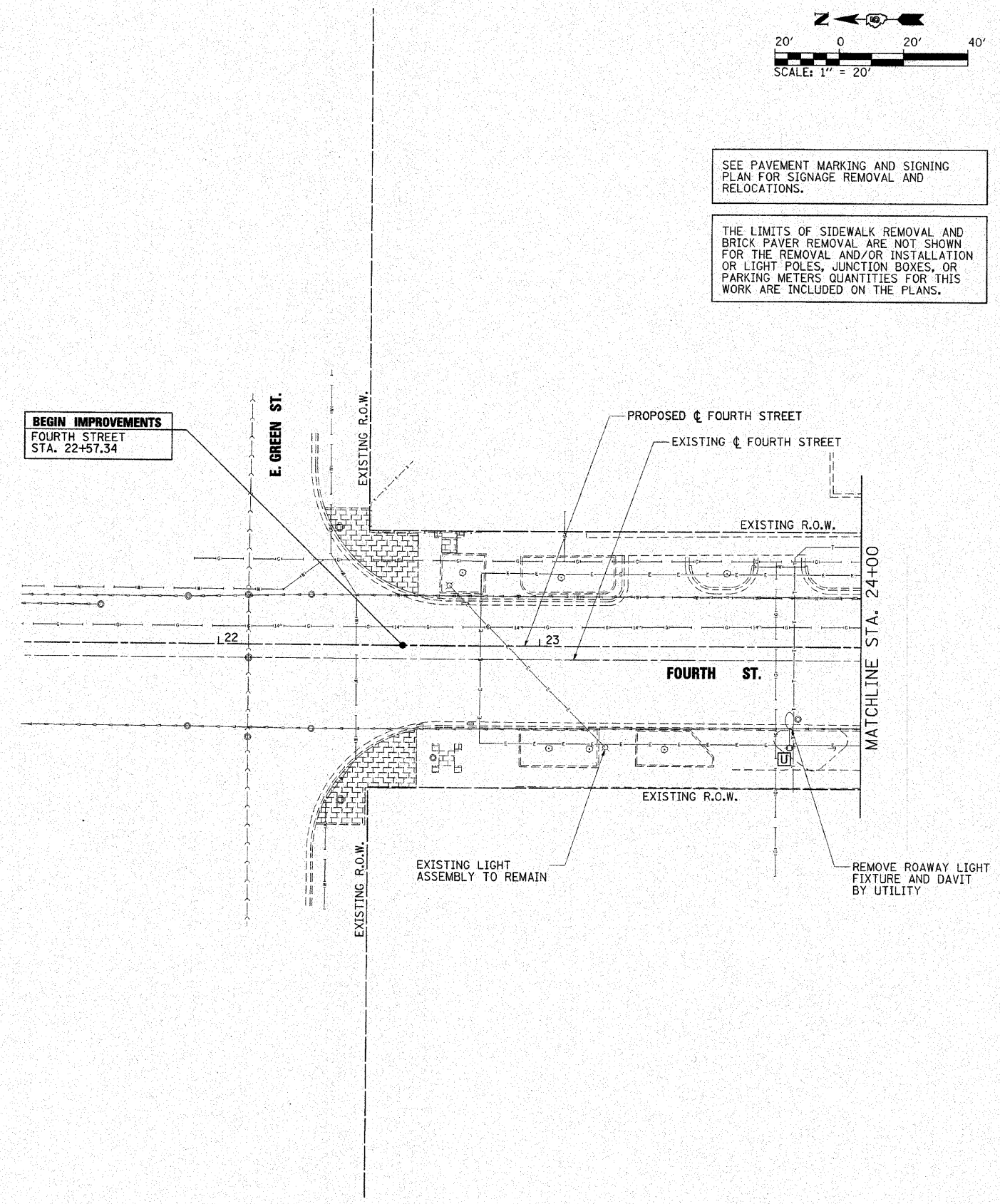

FILE NAME =	USER NAME = Jim Michael	DESIGNED - RMM	<p><b>CMT</b> CRAWFORD, MURPHY &amp; TILLY, INC. CONSULTING ENGINEERS License No. 184-000613</p>	<p align="center"><b>CITY OF CHAMPAIGN DEPARTMENT OF PUBLIC WORKS</b></p>			<p align="center"><b>REMOVAL / RELOCATION FOURTH STREET IMPROVEMENT CHAMPAIGN, ILLINOIS</b></p>		F.A.U. RTE. 7171	SECTION 10-00285-00-SP	COUNTY CHAMPAIGN	TOTAL SHEETS 55	SHEET NO. 8
\\champaign\188940100\draw\cadd\sheet5	Removal-01_Green.dgn	DRAWN - RAH					SCALE: 1" = 20'	SHEET NO.	OF SHEETS	STA. 22+00	TO STA. 24+00	CONTRACT NO. 91445	
	PLOT SCALE = 20,0000' / IN.	CHECKED - JMM		ILLINOIS FED. AID PROJECT									
	PLOT DATE = 10/18/2010	DATE - 10/15/2010											