

X PARKING METER POSTS TO BE REMOVED (Z0036700)

STATION	TO STATION	EACH
24+48	25+16 LT.	3
24+85	25+30 RT.	2
27+42	28+85 LT.	4
NOMINAL QUANTITY		1
SHEET TOTAL		10

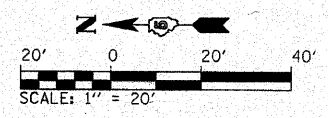

SEE PAVEMENT MARKING AND SIGNING PLAN FOR SIGNAGE REMOVAL AND RELOCATIONS.

THE LIMITS OF SIDEWALK REMOVAL AND BRICK PAVER REMOVAL ARE NOT SHOWN FOR THE REMOVAL AND/OR INSTALLATION OF LIGHT POLES, JUNCTION BOXES, OR PARKING METERS QUANTITIES FOR THIS WORK ARE INCLUDED ON THE PLANS.

SEE SITE IMPROVEMENTS PLAN FOR STORM SEWER REMOVALS AND STRUCTURE ADJUSTMENTS.

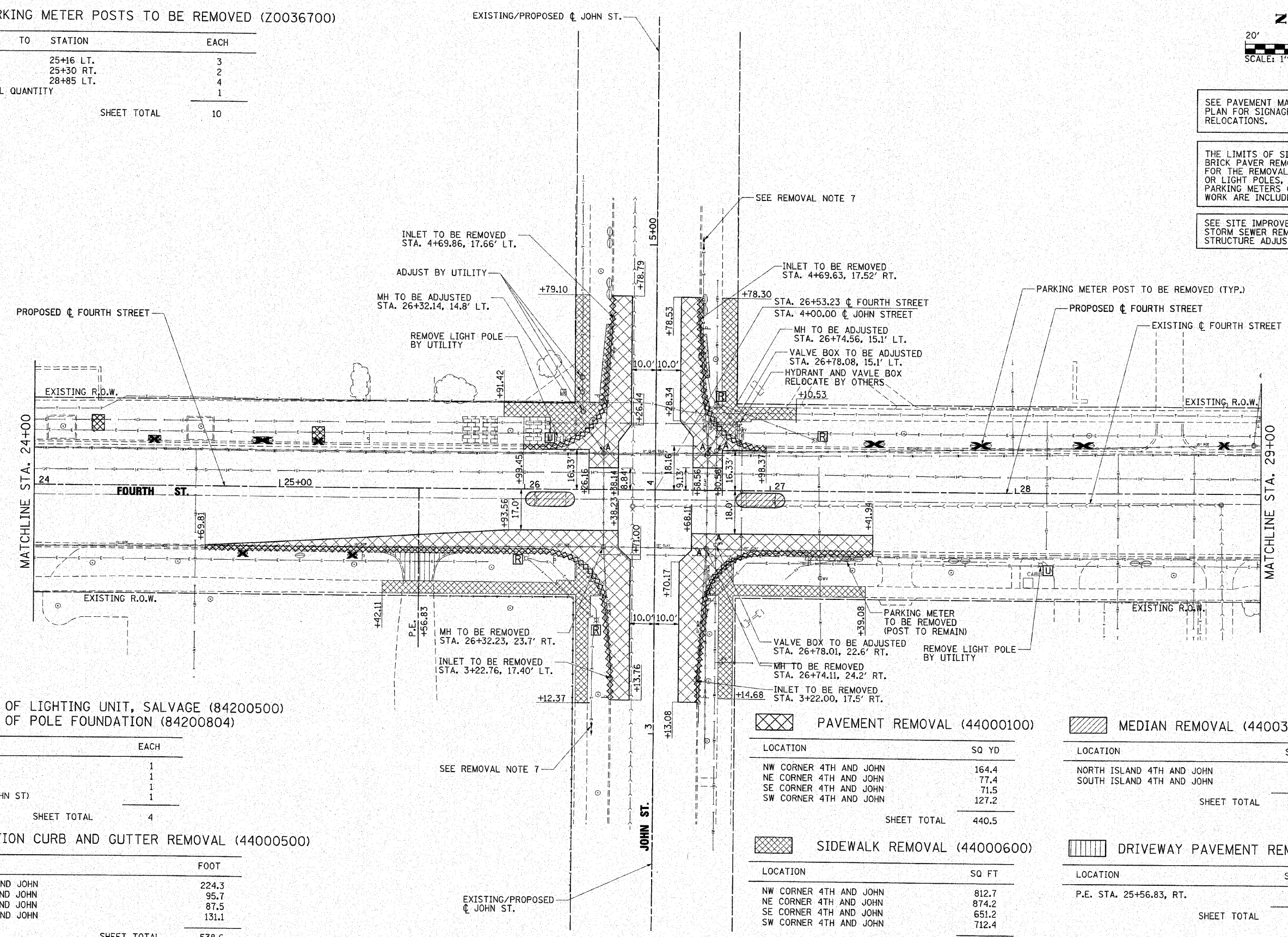

REMOVAL OF LIGHTING UNIT, SALVAGE (84200500)
☒ REMOVAL OF POLE FOUNDATION (84200804)

STATION	EACH
26+00 RT.	1
26+78 LT.	1
27+18 LT.	1
3+46 LT. (JOHN ST)	1
SHEET TOTAL	4

☒☒☒ COMBINATION CURB AND GUTTER REMOVAL (44000500)

LOCATION	FOOT
NW CORNER 4TH AND JOHN	224.3
NE CORNER 4TH AND JOHN	95.7
SE CORNER 4TH AND JOHN	87.5
SW CORNER 4TH AND JOHN	131.1
SHEET TOTAL	538.6

▨ PAVEMENT REMOVAL (44000100)

LOCATION	SQ YD
NW CORNER 4TH AND JOHN	164.4
NE CORNER 4TH AND JOHN	77.4
SE CORNER 4TH AND JOHN	71.5
SW CORNER 4TH AND JOHN	127.2
SHEET TOTAL	440.5

▨ MEDIAN REMOVAL (44003100)

LOCATION	SQ FT
NORTH ISLAND 4TH AND JOHN	121.1
SOUTH ISLAND 4TH AND JOHN	121.8
SHEET TOTAL	242.9

▨ SIDEWALK REMOVAL (44000600)

LOCATION	SQ FT
NW CORNER 4TH AND JOHN	812.7
NE CORNER 4TH AND JOHN	874.2
SE CORNER 4TH AND JOHN	651.2
SW CORNER 4TH AND JOHN	712.4
SHEET TOTAL	3050.5

▨ DRIVEWAY PAVEMENT REMOVAL (44000200)

LOCATION	SQ YD
P.E. STA. 25+56.83, RT.	21.0
SHEET TOTAL	21.0

FILE NAME =	USER NAME = Jim Michael	DESIGNED - RMM
I:\champaign\100940100\draw\cadd\sheet	Removal-02_John.dgn	DRAWN - RAH
	PLOT SCALE = 20.0000 / IN.	CHECKED - JMM
	PLOT DATE = 10/18/2010	DATE - 10/15/2010

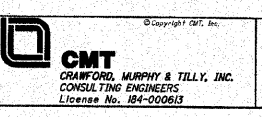

**CITY OF CHAMPAIGN
DEPARTMENT OF PUBLIC WORKS**

**REMOVAL / RELOCATION
FOURTH STREET IMPROVEMENT
CHAMPAIGN, ILLINOIS**
 SCALE: 1" = 20' SHEET NO. OF SHEETS STA. 24+00 TO STA. 29+00

F.A.U. RTE.	SECTION	COUNTY	TOTAL SHEETS	SHEET NO.
7171	10-00285-00-SP	CHAMPAIGN	55	9
CONTRACT NO. 91445				ILLINOIS FED. AID PROJECT