

SEE STREETScape DETAIL SHEETS FOR PROPOSED SIDEWALK IMPROVEMENTS.

SEE DRAINAGE SCHEDULES FOR DETAILED STORM SEWER PIPE AND STRUCTURE INFORMATION.

SEE INTERSECTION DETAIL SHEETS FOR PROPOSED CURB & GUTTER AND SIDEWALK DETAILS.

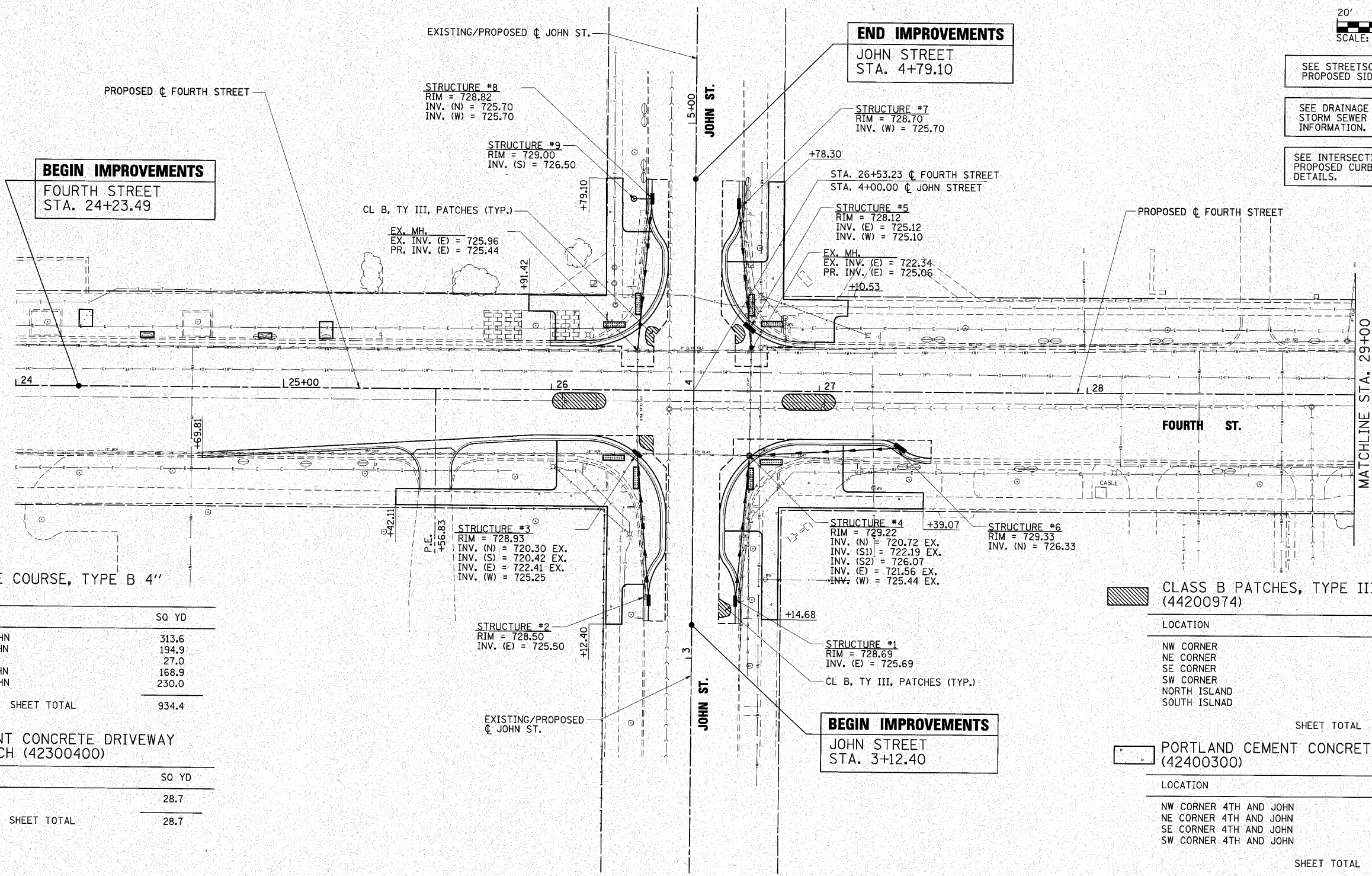

AGGREGATE BASE COURSE, TYPE B 4" (35101600)

LOCATION	SQ YD
NW CORNER 4TH AND JOHN	313.6
NE CORNER 4TH AND JOHN	194.9
ALONG CENTERLINE	27.0
SE CORNER 4TH AND JOHN	168.9
SW CORNER 4TH AND JOHN	230.0
SHEET TOTAL	934.4

PORTLAND CEMENT CONCRETE DRIVEWAY PAVEMENT, 8 INCH (42300400)

LOCATION	SQ YD
STA. 25+56.83, RT.	28.7
SHEET TOTAL	28.7

COMBINATION CONCRETE CURB AND GUTTER, TYPE B-6.18 (SPECIAL) (60604800)

LOCATION	FOOT
NW CORNER 4TH AND JOHN	242.5
NE CORNER 4TH AND JOHN	104.9
SE CORNER 4TH AND JOHN	95.6
SW CORNER 4TH AND JOHN	148.3
SHEET TOTAL	591.3

CLASS B PATCHES, TYPE III, 10 INCH (44200974)

LOCATION	SQ YD
NW CORNER	60.8
NE CORNER	83.5
SE CORNER	79.9
SW CORNER	75.6
NORTH ISLAND	13.5
SOUTH ISLAND	13.5
SHEET TOTAL	326.8

PORTLAND CEMENT CONCRETE SIDEWALK 6 INCH (42400300)

LOCATION	SQ FT
NW CORNER 4TH AND JOHN	1969.4
NE CORNER 4TH AND JOHN	1384.6
SE CORNER 4TH AND JOHN	1097.0
SW CORNER 4TH AND JOHN	1542.0
SHEET TOTAL	5993.0

DETECTABLE WARNINGS (42400800)

LOCATION	SQ FT
NW CORNER 4TH AND JOHN	32.0
NE CORNER 4TH AND JOHN	32.0
SE CORNER 4TH AND JOHN	32.0
SW CORNER 4TH AND JOHN	32.0
SHEET TOTAL	128.0

FILE NAME = I:\champaign\102940100\draw\cadd\sheet	USER NAME = Jim Michael	DESIGNED - TM
Site Improvements_Plan_02.dgn		DRAWN - RAH
PLOT SCALE = 20.0000' / 1"		CHECKED - JMM
PLOT DATE = 11/9/2010		DATE = 10/15/2010

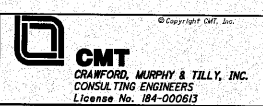

CITY OF CHAMPAIGN DEPARTMENT OF PUBLIC WORKS

SITE IMPROVEMENT PLAN FOURTH STREET IMPROVEMENT CHAMPAIGN, ILLINOIS

F.A.U. RTE. 7171	SECTION 10-00285-00-SP	COUNTY CHAMPAIGN	TOTAL SHEETS 55	SHEET NO. 14
SCALE: 1" = 20'			CONTRACT NO. 91445	