

SEE STREETScape DETAIL SHEETS FOR PROPOSED SIDEWALK IMPROVEMENTS.

SEE DRAINAGE SCHEDULES FOR DETAILED STORM SEWER PIPE AND STRUCTURE INFORMATION.

SEE INTERSECTION DETAIL SHEETS FOR PROPOSED CURB & GUTTER AND SIDEWALK DETAILS.

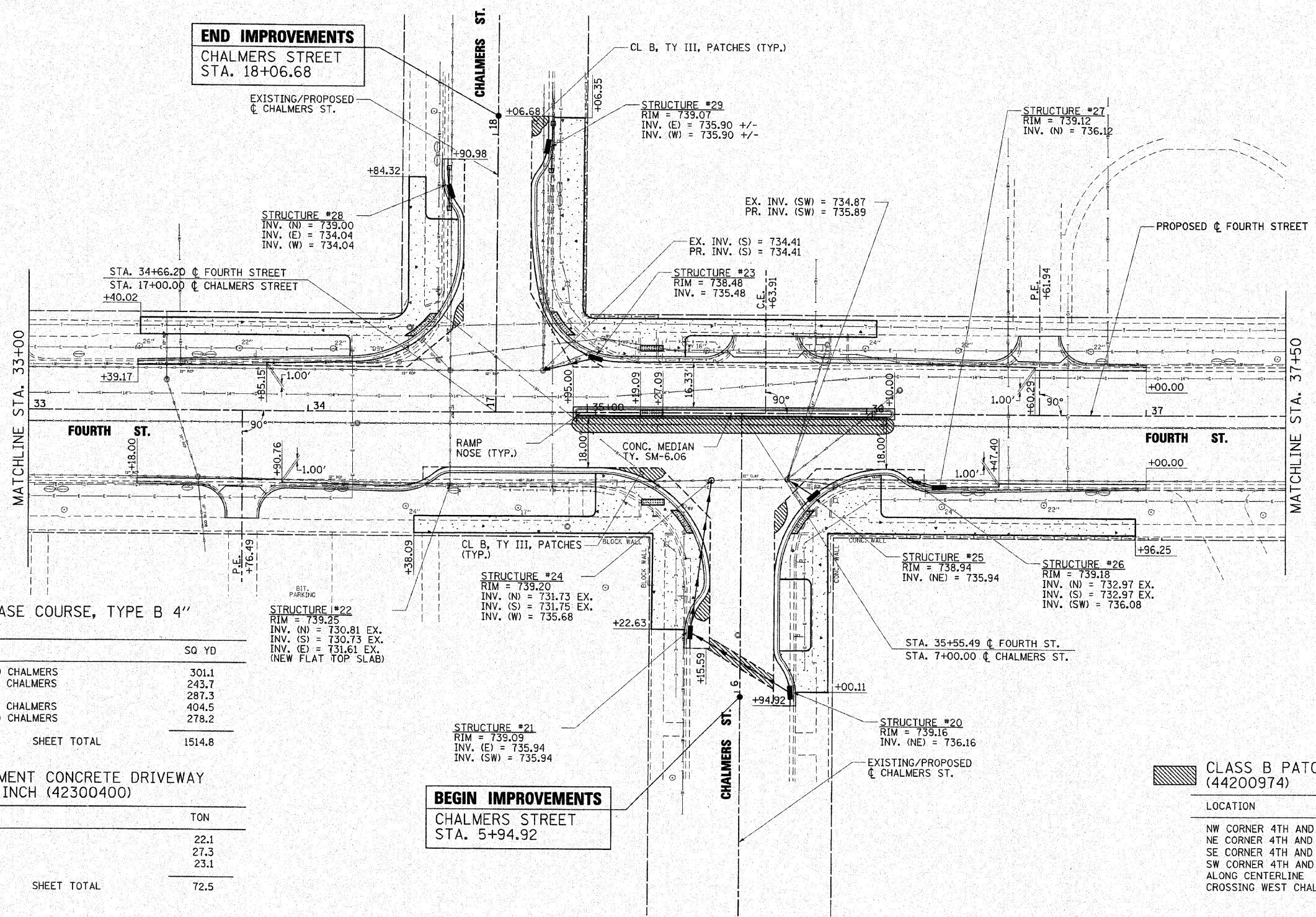

**AGGREGATE BASE COURSE, TYPE B 4" (35101600)**

LOCATION	SQ YD
NW CORNER 4TH AND CHALMERS	301.1
NE CORNER 4TH AND CHALMERS	243.7
ALONG CENTERLINE	287.3
SE CORNER 4TH AND CHALMERS	404.5
SW CORNER 4TH AND CHALMERS	278.2
<b>SHEET TOTAL</b>	<b>1514.8</b>

**PORTLAND CEMENT CONCRETE DRIVEWAY PAVEMENT, 8 INCH (42300400)**

LOCATION	TON
STA. 33+76.47, RT.	22.1
STA. 35+63.91, LT.	27.3
STA. 36+61.94, LT.	23.1
<b>SHEET TOTAL</b>	<b>72.5</b>

**COMBINATION CONCRETE CURB AND GUTTER, TYPE B-6.18 (SPECIAL) (60604800)**

LOCATION	FOOT
NW CORNER 4TH AND CHALMERS	266.6
NE CORNER 4TH AND CHALMERS	184.6
SE CORNER 4TH AND CHALMERS	305.8
SW CORNER 4TH AND CHALMERS	215.5
<b>SHEET TOTAL</b>	<b>971.5</b>

**BEGIN IMPROVEMENTS**  
CHALMERS STREET  
STA. 5+94.92

**DETECTABLE WARNINGS (42400800)**

LOCATION	SQ FT
NW CORNER 4TH AND CHALMERS	35.6
NE CORNER 4TH AND CHALMERS	23.4
SE CORNER 4TH AND CHALMERS	36.7
SW CORNER 4TH AND CHALMERS	19.6
CENTERLINE	16.0
<b>SHEET TOTAL</b>	<b>131.5</b>

**CLASS B PATCHES, TYPE III, 10 INCH (44200974)**

LOCATION	SQ FT
NW CORNER 4TH AND CHALMERS	67.3
NE CORNER 4TH AND CHALMERS	41.8
SE CORNER 4TH AND CHALMERS	61.2
SW CORNER 4TH AND CHALMERS	75.3
ALONG CENTERLINE	77.7
CROSSING WEST CHALMERS	7.7
<b>SHEET TOTAL</b>	<b>333.7</b>

**PORTLAND CEMENT CONCRETE SIDEWALK 6 INCH (42400300)**

LOCATION	SQ FT
NW CORNER 4TH AND CHALMERS	1660.7
NE CORNER 4TH AND CHALMERS	1520.6
SE CORNER 4TH AND CHALMERS	1967.0
SW CORNER 4TH AND CHALMERS	1813.9
<b>SHEET TOTAL</b>	<b>6962.2</b>