

DATE	
BY	
SURVEYED	
NOTED	
TEMPLATE	
AREAS	
CHECKED	
NO.	

DATE	
BY	
SURVEYED	
NOTED	
TEMPLATE	
AREAS	
CHECKED	
NO.	

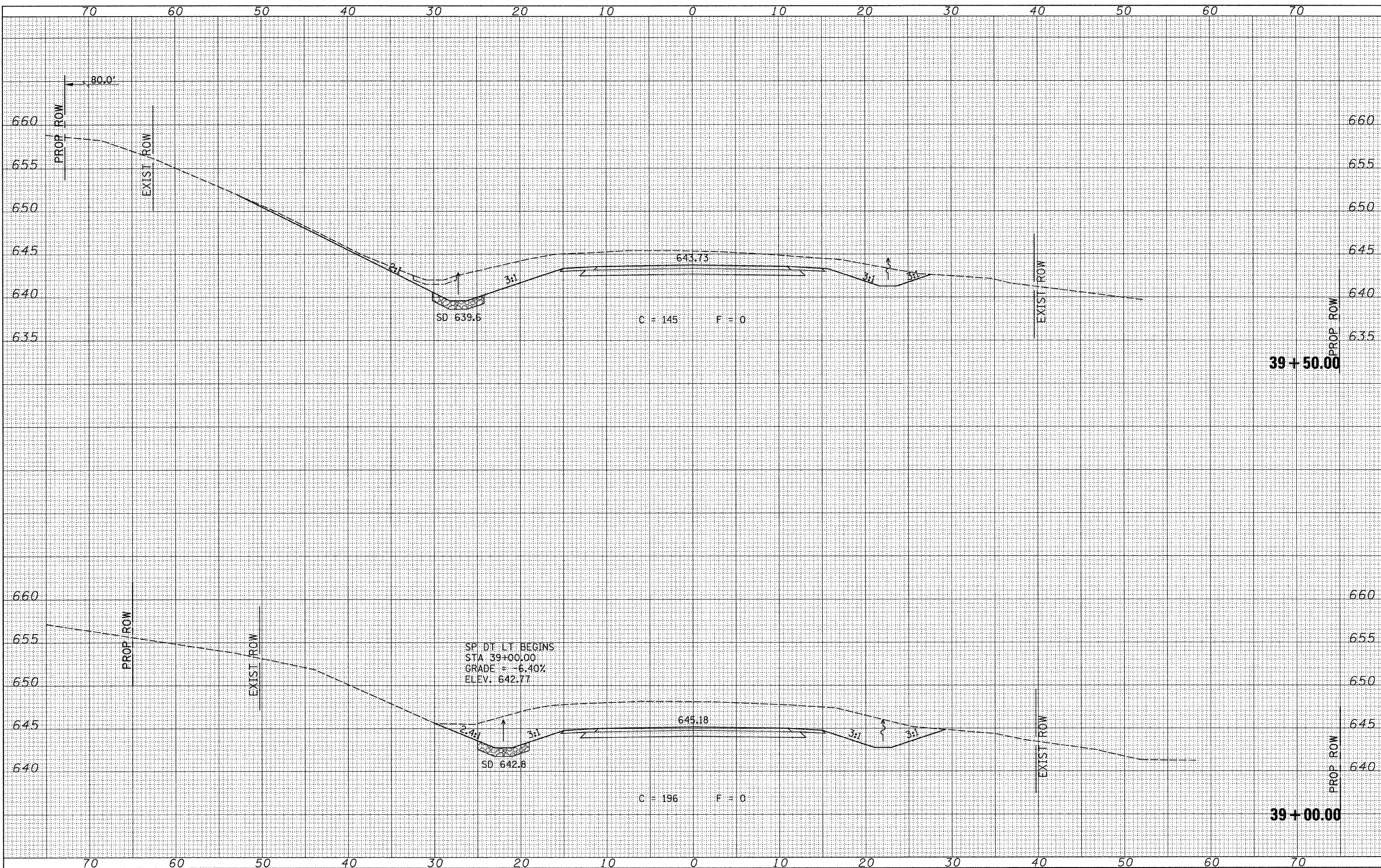

FILE NAME = V:\Bridge\2576-1 Macoupin\2576XSSHTS.dgn	USER NAME = athomas	DESIGNED - DRAWN -	REVISED - REVISED -	MACOUPIN COUNTY COUNTY HIGHWAY 12 OVER HICKS CREEK AND JOES CREEK	CROSS SECTIONS		F.A.S. RTE. 732	SECTION 07-00090-00-BR	COUNTY MACOUPIN	TOTAL SHEETS 77	SHEET NO. 68
PLOT SCALE = 5.0000' / 1"	CHECKED -	REVISED -	REVISED -		SCALE: 1"=5'	SHEET NO. 17 OF 26 SHEETS	STA. 39+00.000 TO STA. 39+50.000	CONTRACT NO. 09338			
PLOT DATE = 2/19/2010	DATE -	REVISED -	REVISED -		FED. ROAD DIST. NO. 7 (ILLINOIS)		FED. AID PROJECT BRS-0732(148)				