

FAU ROUTE	SECTION	COUNTY
9257	06-00011-02-RP	ST. CLAIR
CONTRACT NO. 97448		ILLINOIS

THOUVENOT, WADE & MOERCHEN, INC.
ENGINEERS ♦ SURVEYORS ♦ PLANNERS



CORPORATE OFFICE

4940 OLD COLLINSVILLE RD.
SWANSEA, ILLINOIS 62226
TEL (618) 624-4488
FAX (618) 624-6688
info@twm-inc.com

CARBONDALE OFFICE

206 WEST COLLEGE STREET
CARBONDALE, ILLINOIS 62901
TEL (618) 549-8844
FAX (618) 549-8450
info@twm-inc.com

EDWARDSVILLE OFFICE

10158 CENTURY DRIVE
EDWARDSVILLE, ILLINOIS 62025
TEL (618) 656-4040
FAX (618) 656-4343
info@twm-inc.com

ST. CHARLES OFFICE

400 NORTH 5TH ST., SUITE 101
ST. CHARLES, MISSOURI 63301
TEL (636) 724-8300
FAX (636) 724-8304
info@twm-inc.com

WATERLOO OFFICE

113 SOUTH MAIN STREET
WATERLOO, ILLINOIS 62298
TEL (618) 939-5050
FAX (618) 939-3938
info@twm-inc.com

PROFESSIONAL REGISTRATIONS	LICENSE NO.
ILLINOIS PROFESSIONAL DESIGN FIRM	184-001220
PROFESSIONAL ENGINEERING CORP.	62-035370
PROFESSIONAL STRUCTURAL ENGR. CORP.	81-006202
ILLINOIS PROF. LAND SURVEYING CORP.	048-000029
MISSOURI PROFESSIONAL ENGR. CORP.	NC 001528
MISSOURI LAND SURVEYING CORP.	NC 000346

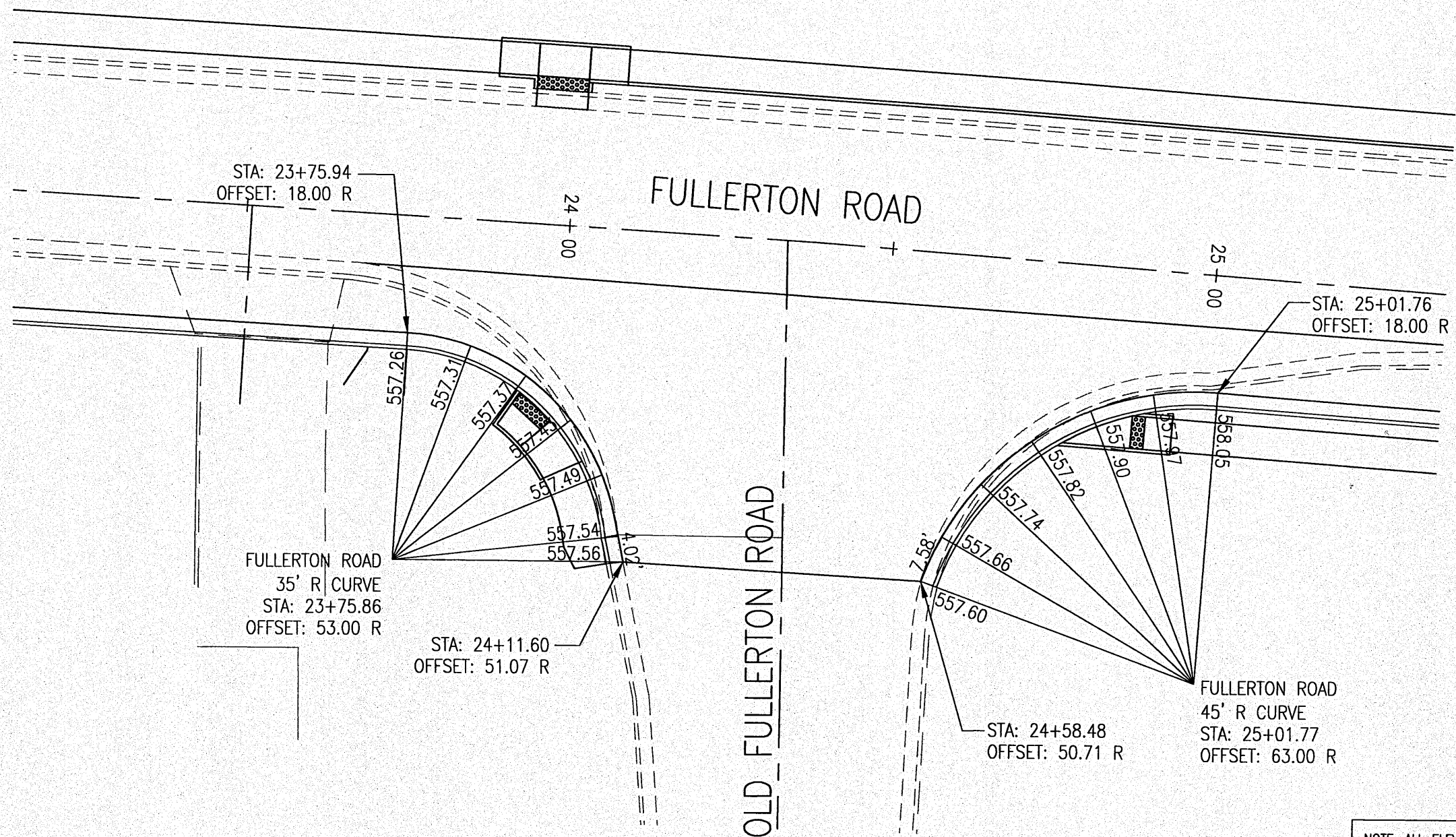

NOTE: ALL ELEVATIONS ARE GIVEN AT THE EDGE OF PAVEMENT.
EOP ELEVATIONS ARE AT 10' INTERVALS UNLESS OTHERWISE NOTED

INTERSECTION DETAILS	FULLERTON ROAD WIDENING VILLAGE OF SWANSEA ST. CLAIR COUNTY, ILLINOIS
TITLE	PROJECT

REV.	DATE	DESCRIPTION
▲		
▲		
▲		

PLAN STATUS	
FINAL	
<input type="checkbox"/> ISSUED FOR REVIEW	<input type="checkbox"/> ISSUED FOR BIDDING
<input type="checkbox"/> ISSUED FOR CONSTR.	<input type="checkbox"/> RECORD DRAWING
DRAWN BY: JUV	SHEET
DESIGNED BY: JUV	31
CHECKED BY: RSD	OF 69 SHEETS
APPROVED BY: JUV	PROJECT DESCRIPTION
PROJECT NUMBER: T07050149	