

PAY ITEM NUMBER	DESIGNATION	UNIT	TOTAL QUANTITY	CONSTRUCTION CODE	
				URBAN	0005
				80% FEDERAL 20% STATE	100% STATE
20200100	EARTH EXCAVATION	CU YD	39	39	
21101615	TOPSOIL FURNISH AND PLACE, 4"	SQ YD	160	160	
25200110	SODDING, SALT TOLERANT	SQ YD	160	160	
25200200	SUPPLEMENTAL WATERING	UNIT	1	1	
28000250	TEMPORARY EROSION CONTROL SEEDING	POUND	38	38	
28000510	INLET FILTERS	EACH	30	30	
35101400	AGGREGATE BASE COURSE, TYPE B	TON	26	26	
40600290	BITUMINOUS MATERIALS (TACK COAT)	POUND	30,827	30,827	
40600370	LONGITUDINAL JOINT SEALANT	FOOT	49,354 <del>16,630</del>	49,354 <del>16,630</del>	⚠
40600400	MIXTURE FOR CRACKS, JOINTS, AND FLANGEWAYS	TON	103	103	
40600982	HOT-MIX ASPHALT SURFACE REMOVAL - BUTT JOINT	SQ YD	371	371	
40601005	HOT-MIX ASPHALT REPLACEMENT OVER PATCHES	TON	8	8	
40604060	HOT-MIX ASPHALT SURFACE COURSE, IL-9.5, MIX "D", N50	TON	8	8	
40604172	POLYMERIZED HOT-MIX ASPHALT SURFACE COURSE, IL-9.5, MIX "E", N70	TON	6,714	6,714	
42000060	WELDED WIRE REINFORCEMENT	SQ YD	520	520	
42001300	PROTECTIVE COAT	SQ YD	1,638	1,638	
42400200	PORTLAND CEMENT CONCRETE SIDEWALK 5 INCH	SQ FT	4,179	4,179	
42400800	DETECTABLE WARNINGS	SQ FT	550	550	
44000156	HOT-MIX ASPHALT SURFACE REMOVAL, 1 3/4"	SQ YD	68,505	68,505	
44000600	SIDEWALK REMOVAL	SQ FT	4,179	4,179	
44002227	HOT-MIX ASPHALT REMOVAL OVER PATCHES, 6 3/4"	SQ YD	4,179	4,179	
44200994	CLASS B PATCHES, TYPE II, 12 INCH	SQ YD	560	560	
44200998	CLASS B PATCHES, TYPE III, 12 INCH	SQ YD	400	400	

\* = SPECIALTY ITEM

PAY ITEM NUMBER	DESIGNATION	UNIT	TOTAL QUANTITY	CONSTRUCTION CODE	
				URBAN	0005
				80% FEDERAL 20% STATE	100% STATE
44201000	CLASS B PATCHES, TYPE IV, 12 INCH	SQ YD	120	120	
44201299	DOWEL BARS 1 1/2"	EACH	1,860	1,860	
44201741	CLASS D PATCHES, TYPE II, 8 INCH	SQ YD	780	780	
44201745	CLASS D PATCHES, TYPE III, 8 INCH	SQ YD	415	415	
44201747	CLASS D PATCHES, TYPE IV, 8 INCH	SQ YD	750	750	
44213200	SAW CUTS	FOOT	4,968	4,968	
44213204	TIE BARS 3/4"	EACH	45	45	
48102100	AGGREGATE WEDGE SHOULDER, TYPE B	TON	200	200	
60255500	MANHOLES TO BE ADJUSTED	EACH	6	6	
60260100	INLETS TO BE ADJUSTED	EACH	8	8	
60266600	VALVE BOXES TO BE ADJUSTED	EACH	2	2	
60404950	FRAMES AND GRATES, TYPE 24	EACH	2	2	
60406000	FRAMES AND LIDS, TYPE 1, OPEN LID	EACH	2	2	
60406100	FRAMES AND LIDS, TYPE 1, CLOSED LID	EACH	8	8	
60618320	CONCRETE MEDIAN SURFACE, 6 INCH	SQ FT	417	417	
* 66900200	NON-SPECIAL WASTE DISPOSAL	CU YD	21	21	
* 66900530	SOIL DISPOSAL ANALYSIS	EACH	4	4	
* 66901001	REGULATED SUBSTANCES PRE-CONSTRUCTION PLAN	L SUM	1	1	
* 66901003	REGULATED SUBSTANCES FINAL CONSTRUCTION REPORT	L SUM	1	1	
* 66901006	REGULATED SUBSTANCES MONITORING	CAL DA	4	4	
67000400	ENGINEER'S FIELD OFFICE, TYPE A	CAL MO	12	12	
67100100	MOBILIZATION	L SUM	1	1	
70102620	TRAFFIC CONTROL AND PROTECTION, STANDARD 701501	L SUM	1	1	

MODEL: Default  
FILE NAME: P:\2020-2024\DOT Various Phase 1 (P78, 196 Item, 16Work Order: 150DCNCA000\_Sheets\0162N56-SHT-5000-01.dgn

<b>INFRASTRUCTURE ENGINEERING</b> <small>INCORPORATES</small> 1 South Wacker   Suite 2650   Chicago, IL 60606 P 312.425.9580   F 312.425.9584   www.infrastructure-eng.com	USER NAME = ALane	DESIGNED - IMU	REVISED - 1
	PLOT SCALE = 20.0000' / in.	DRAWN - IMU	REVISED -
	PLOT DATE = 10/21/2021	CHECKED - ACL	REVISED -
		DATE - 08/13/2021	

**STATE OF ILLINOIS  
DEPARTMENT OF TRANSPORTATION**

**SUMMARY OF QUANTITIES  
IL-31 (MCCULLOM LAKE RD TO JOHNSBURG RD)**

SCALE: NTS STA. TO STA.

F.A.P. RTE. 336	SECTION	COUNTY	TOTAL SHEETS	SHEET NO.
	2021-024-R5	MCHENRY	28	3
ILLINOIS FED. AID PROJECT			CONTRACT NO. 62N56	

⚠ REVISED SHEET 1/3/2022

PAY ITEM NUMBER	DESIGNATION	UNIT	TOTAL QUANTITY	CONSTRUCTION CODE	
				URBAN	
				80% FEDERAL 20% STATE	100% STATE
70102622	TRAFFIC CONTROL AND PROTECTION, STANDARD 701502	L SUM	1	1	
70102625	TRAFFIC CONTROL AND PROTECTION, STANDARD 701606	L SUM	1	1	
70102630	TRAFFIC CONTROL AND PROTECTION, STANDARD 701601	L SUM	1	1	
70102632	TRAFFIC CONTROL AND PROTECTION, STANDARD 701602	L SUM	1	1	
70102635	TRAFFIC CONTROL AND PROTECTION, STANDARD 701701	L SUM	1	1	
70102640	TRAFFIC CONTROL AND PROTECTION, STANDARD 701801	L SUM	1	1	
70103815	TRAFFIC CONTROL SURVEILLANCE	CAL DA	50	50	
70107025	CHANGEABLE MESSAGE SIGN	CAL DA	56	56	1
70300100	SHORT TERM PAVEMENT MARKING	FOOT	1,635	1,635	1
70300150	SHORT TERM PAVEMENT MARKING REMOVAL	SQ FT	545	545	
70300211	TEMPORARY PAVEMENT MARKING LETTERS AND SYMBOLS - PAINT	SQ FT	1,677	1,677	
70300221	TEMPORARY PAVEMENT MARKING - LINE 4"- PAINT	FOOT	35,769	35,769	
70300241	TEMPORARY PAVEMENT MARKING - LINE 6"- PAINT	FOOT	7,706	7,706	
70300251	TEMPORARY PAVEMENT MARKING - LINE 8"- PAINT	FOOT	3,268	3,268	
70300261	TEMPORARY PAVEMENT MARKING - LINE 12"- PAINT	FOOT	3,502	3,502	
70300281	TEMPORARY PAVEMENT MARKING - LINE 24"- PAINT	FOOT	602	602	
70306120	TEMPORARY PAVEMENT MARKING - LINE 4" - TYPE III TAPE	FOOT	1,635	1,635	
* 78000100	THERMOPLASTIC PAVEMENT MARKING - LETTERS AND SYMBOLS	SQ FT	1,313	1,313	
* 78000200	THERMOPLASTIC PAVEMENT MARKING - LINE 4"	FOOT	35,133	35,133	
* 78000400	THERMOPLASTIC PAVEMENT MARKING - LINE 6"	FOOT	6,365	6,365	
* 78000500	THERMOPLASTIC PAVEMENT MARKING - LINE 8"	FOOT	2,626	2,626	1
* 78000600	THERMOPLASTIC PAVEMENT MARKING - LINE 12"	FOOT	2,756	2,756	
* 78000650	THERMOPLASTIC PAVEMENT MARKING - LINE 24"	FOOT	407	407	
* 78004235	PERFORMED PLASTIC PAVEMENT MARKING, TYPE B - INLAID - LINE 7"	FOOT	626	626	

\* = SPECIALTY ITEM

PAY ITEM NUMBER	DESIGNATION	UNIT	TOTAL QUANTITY	CONSTRUCTION CODE	
				URBAN	
				80% FEDERAL 20% STATE	100% STATE
* 78009000	MODIFIED URETHANE PAVEMENT MARKING - LETTERS AND SYMBOLS	SQ FT	328	328	
* 78009004	MODIFIED URETHANE PAVEMENT MARKING - LINE 4"	FOOT	11	11	
* 78009006	MODIFIED URETHANE PAVEMENT MARKING - LINE 6"	FOOT	1,341	1,341	1
* 78009008	MODIFIED URETHANE PAVEMENT MARKING - LINE 8"	FOOT	643	643	
* 78009012	MODIFIED URETHANE PAVEMENT MARKING - LINE 12"	FOOT	746	746	
* 78009024	MODIFIED URETHANE PAVEMENT MARKING - LINE 24"	FOOT	195	195	
* 78011040	GROOVING FOR RECESSED PAVEMENT MARKING 8"	FOOT	626	626	
* 78100100	RAISED REFLECTIVE PAVEMENT MARKER	EACH	318	318	
78300200	RAISED REFLECTIVE PAVEMENT MARKER REMOVAL	EACH	318	318	
78300202	PAVEMENT MARKER REMOVAL - WATER BLAST	SQ FT	2,775	2,775	1
* 88600600	DETECTOR LOOP REPLACEMENT	FOOT	3,432	3,432	
* 89502376	REBUILD EXISTING HANDHOLE	EACH	3	3	
X0320050	CONSTRUCTION LAYOUT (SPECIAL)	L SUM	1	1	
X2020110	GRADING AND SHAPING SHOULDERS	UNIT	71	71	
X4400501	COMBINATION CURB AND GUTTER REMOVAL AND REPLACEMENT LESS THAN OR EQUAL TO 10 FEET	FOOT	690	690	
X5537800	STORM SEWERS TO BE CLEANED 12"	FOOT	300		300
X6022900	CATCH BASINS TO BE RECONSTRUCTED (SPECIAL)	EACH	2	2	
X6025300	CATCH BASINS TO BE ADJUSTED (SPECIAL)	EACH	4	4	
X6030205	FRAMES AND GRATES TO BE ADJUSTED (SPECIAL)	EACH	6	6	
X6700407	ENGINEER'S FIELD OFFICE, TYPE A (D1)	CAL MO	12	12	1
Z0030850	TEMPORARY INFORMATION SIGNING	SQ FT	95	95	
Z0004562	COMBINATION CONCRETE CURB AND GUTTER REMOVAL AND REPLACEMENT	FOOT	280.0	280.0	
Z0018100	DRAINAGE STRUCTURE ADJUSTMENT (SPECIAL)	EACH	23	23	
Z0018500	DRAINAGE STRUCTURES TO BE CLEANED	EACH	36		36
Z0076600	TRAINEES	HOURS	500	500	
Z0076604	TRAINEES - TRAINING PROGRAM GRADUATE	HOURS	500	500	

1 REVISED SHEET 1/3/2022 0042

MODEL: Default  
FILE: \\nas11\p\2020-09\4-00 IDOT Various Phase 2 (RTB 196 Item 16)\Work Order 151026\CAD Sheets\151026-SHT-500-02.dgn

<b>INFRASTRUCTURE ENGINEERING</b> 1 South Wacker   Suite 2650   Chicago, IL 60606 P 312.425.9580   F 312.425.9584   www.infrastructure-eng.com	USER NAME = ALane	DESIGNED - IMU	REVISED - 1
	PLOT SCALE = 20.0000' / in.	DRAWN - IMU	REVISED -
	PLOT DATE = 10/21/2021	CHECKED - ACL	REVISED -
	DATE = 08/13/2021		

**STATE OF ILLINOIS  
DEPARTMENT OF TRANSPORTATION**

**SUMMARY OF QUANTITIES  
IL-31 (MCCULLOM LAKE RD TO JOHNSBURG RD)**

SCALE: NTS STA. TO STA.

F.A.P. RTE. 336	SECTION 2021-024-R5	COUNTY MCHENRY	TOTAL SHEETS 28	SHEET NO. 4
CONTRACT NO. 62N56			ILLINOIS FED. AID PROJECT	

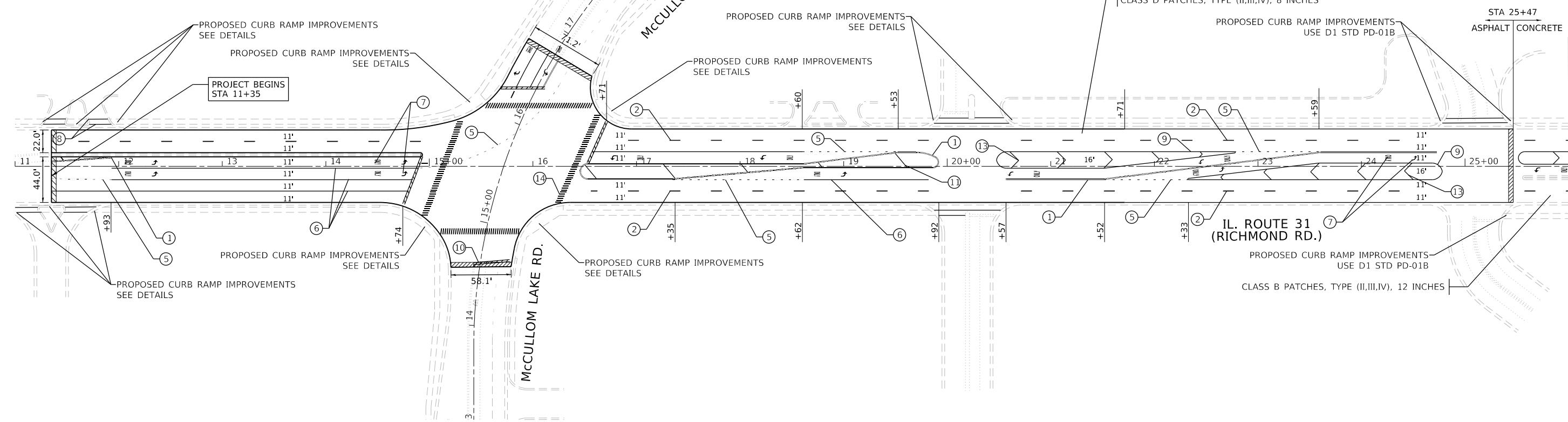
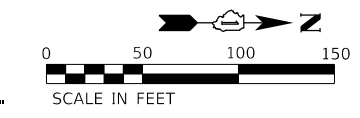

**LEGEND**

HMA SURFACE REMOVAL BUTT JOINT, 4.5'

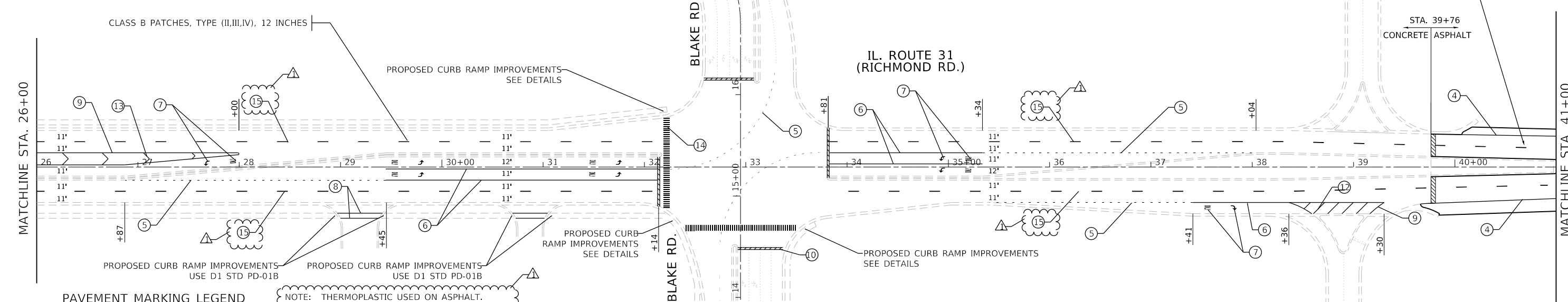

**PAVEMENT MARKING LEGEND**

NOTE: THERMOPLASTIC USED ON ASPHALT. MODIFIED URETHANE USED ON CONCRETE.

- ① LINE 2 @ 4" SOLID YELLOW, 11" C-C - CENTERLINE (TYP)
- ② LINE 4", SKIP-DASH, WHITE (10' LINE - 30' SPACE) - LANE LINES
- ③ LINE 4", SOLID, YELLOW - EDGE LINE (TYP)
- ④ LINE 4", SOLID WHITE - EDGE LINE (TYP)
- ⑤ LINE 6", SKIP-DASH, WHITE (2' LINE - 6' SPACE) - DOTTED LINES (TYP)
- ⑥ LINE 6", SOLID WHITE - TURN LANE MARKING (TYP)
- ⑦ LETTERS & SYMBOLS, 8", SOLID, WHITE - TURN LANE MARKINGS (TYP)
- ⑧ LINE 2 @ 6", SOLID, WHITE - CROSSWALK LINES (PEDESTRIAN) (TYP)
- ⑨ LINE 8", SOLID, WHITE - GORE MARKING AND CHANNELIZING LINES (TYP)
- ⑩ LINE 24", SOLID, WHITE - STOP LINES (TYP)
- ⑪ LINE 12", SOLID, YELLOW - PAINTED MEDIANS DIAGONALS (TYP) (SEE DISTRICT DETAIL TC-13 FOR SPACING)
- ⑫ LINE 12", SOLID, WHITE - SHOULDER DIAGONALS @ 45° (TYP) (SEE DISTRICT TC-13 FOR SPACING)
- ⑬ LINE 12", SOLID, WHITE - CHANNELIZATION LINES 45° (TYP) (SEE DISTRICT TC-13 FOR SPACING)
- ⑭ LINE 12", SOLID, WHITE - CONTINENTAL CROSSWALK (TYP)
- ⑮ PREFORMED PLASTIC PAVEMENT MARKING, TYPE B - INLAID - LINE 7" ON GROOVING FOR RECESSED PAVEMENT MARKING 8"

REVISED SHEET 1/3/2022

MODEL: Dwg.rvt FILE NAME: P:\2020\04094-00 IDOT Varioris Phase 2 (RFB) 106 from 161Work Order 1510GNCADD\_Sheets\1621N56-SHT-PLN\01.dgn

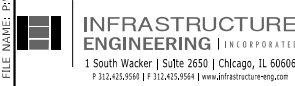

USER NAME = ALane	DESIGNED - IMU	REVISED -  ACL 12/17/2021
PLOT SCALE = 100.0000' / in.	DRAWN - IMU	REVISED -
PLOT DATE = 12/17/2021	CHECKED - ACL	REVISED -
	DATE - 08/13/2021	

**STATE OF ILLINOIS  
DEPARTMENT OF TRANSPORTATION**

**ROADWAY AND PAVEMENT MARKING PLANS  
IL-31 (MCCULLOM LAKE RD TO JOHNSBURG RD)**

SCALE: 1" = 50'      STA.      TO STA.

F.A.P. RTE. 336	SECTION 2021-024-R5	COUNTY MCHENRY	TOTAL SHEETS 28	SHEET NO. 9
			CONTRACT NO. 62N56	
		ILLINOIS FED. AID PROJECT		

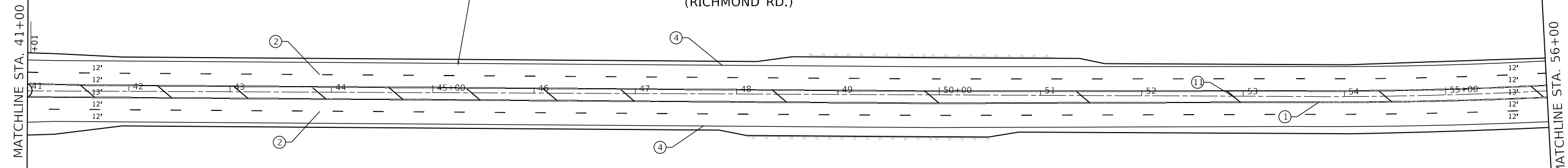
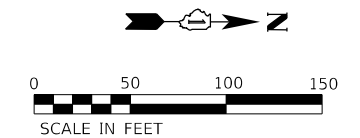

**PAVEMENT MARKING LEGEND**

NOTE: THERMOPLASTIC USED ON ASPHALT.  
MODIFIED URETHANE USED ON CONCRETE.

- ① LINE 2 @ 4" SOLID YELLOW, 11" C-C - CENTERLINE (TYP)
- ② LINE 4", SKIP-DASH, WHITE (10' LINE - 30' SPACE) - LANE LINES
- ③ LINE 4", SOLID, YELLOW - EDGE LINE (TYP)
- ④ LINE 4", SOLID WHITE - EDGE LINE (TYP)
- ⑤ LINE 6", SKIP-DASH, WHITE (2' LINE - 6' SPACE) - DOTTED LINES (TYP)
- ⑥ LINE 6", SOLID WHITE - TURN LANE MARKING (TYP)
- ⑦ LETTERS & SYMBOLS, 8", SOLID, WHITE - TURN LANE MARKINGS (TYP)
- ⑧ LINE 2 @ 6", SOLID, WHITE - CROSSWALK LINES (PEDESTRIAN) (TYP)
- ⑨ LINE 8", SOLID, WHITE - GORE MARKING AND CHANNELIZING LINES (TYP)
- ⑩ LINE 24", SOLID, WHITE - STOP LINES (TYP)
- ⑪ LINE 12", SOLID, YELLOW - PAINTED MEDIANS DIAGONALS (TYP) (SEE DISTRICT DETAIL TC-13 FOR SPACING)
- ⑫ LINE 12", SOLID, WHITE - SHOULDER DIAGONALS @ 45° (TYP) (SEE DISTRICT TC-13 FOR SPACING)
- ⑬ LINE 12", SOLID, WHITE - CHANNELIZATION LINES 45° (TYP) (SEE DISTRICT TC-13 FOR SPACING)
- ⑭ LINE 12", SOLID, WHITE - CONTINENTAL CROSSWALK (TYP)
- ⑮ PREFORMED PLASTIC PAVEMENT MARKING, TYPE B - INLAID - LINE 7" ON GROOVING FOR RECESSED PAVEMENT MARKING 8"

**LEGEND**

HMA SURFACE REMOVAL BUTT JOINT, 4.5'

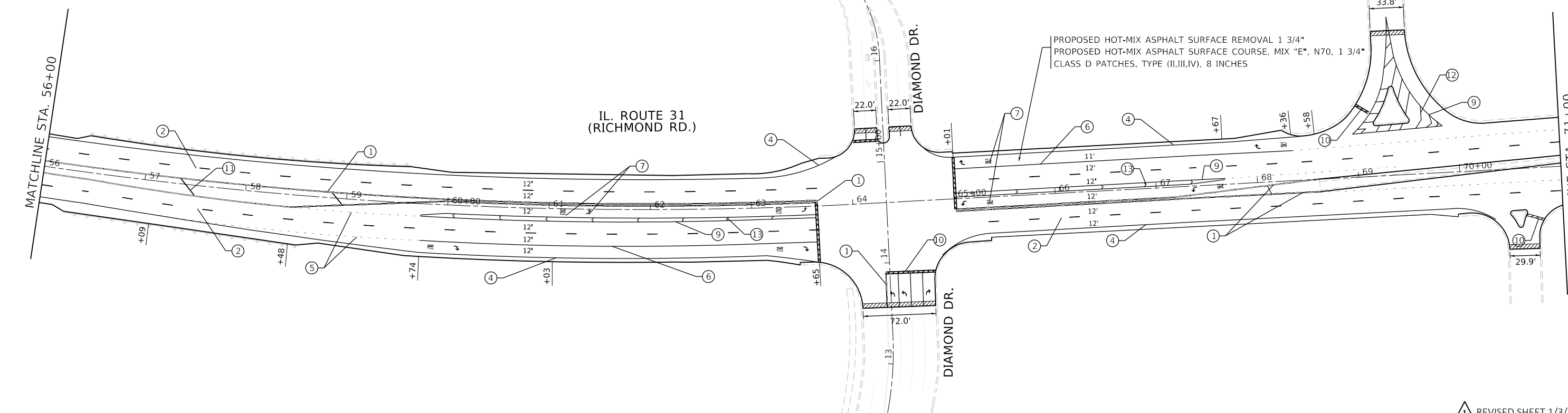

MODEL: D:\p\it\... INFRASTRUCTURE ENGINEERING INCORPORATED

REVISED SHEET 1/3/2022

<p><b>INFRASTRUCTURE ENGINEERING INCORPORATED</b> 1 South Wacker   Suite 2650   Chicago, IL 60606 P 312.425.9569   F 312.425.9568   www.infrastructure-eng.com</p>	USER NAME = ALane	DESIGNED - IMU	REVISED -  ACL 12/17/2021
	PLOT SCALE = 100.0000' / in.	DRAWN - IMU	REVISED -
	PLOT DATE = 12/17/2021	CHECKED - ACL	REVISED -
		DATE - 08/13/2021	

**STATE OF ILLINOIS  
DEPARTMENT OF TRANSPORTATION**

**ROADWAY AND PAVEMENT MARKING PLANS**  
**IL-31 (MCCULLOM LAKE RD TO JOHNSBURG RD)**

SCALE: 1" = 50'

F.A.P. RTE. 336	SECTION 2021-024-R5	COUNTY MCHENRY	TOTAL SHEETS 28	SHEET NO. 10
			CONTRACT NO. 62N56	
ILLINOIS FED. AID PROJECT				

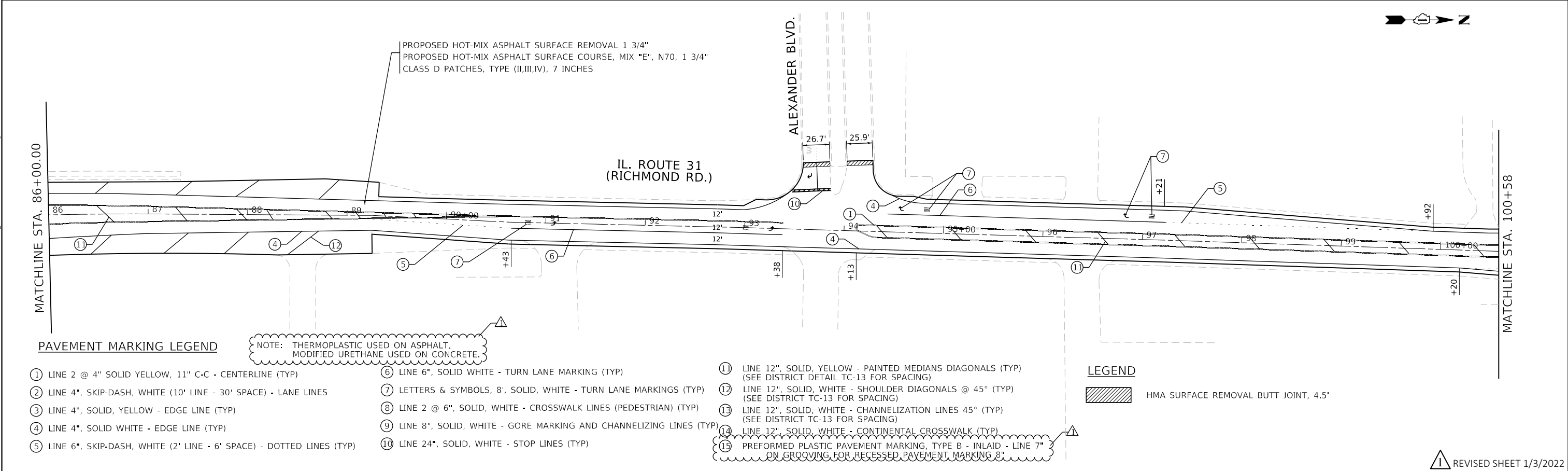
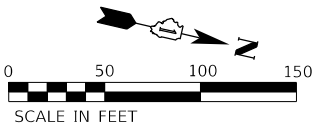
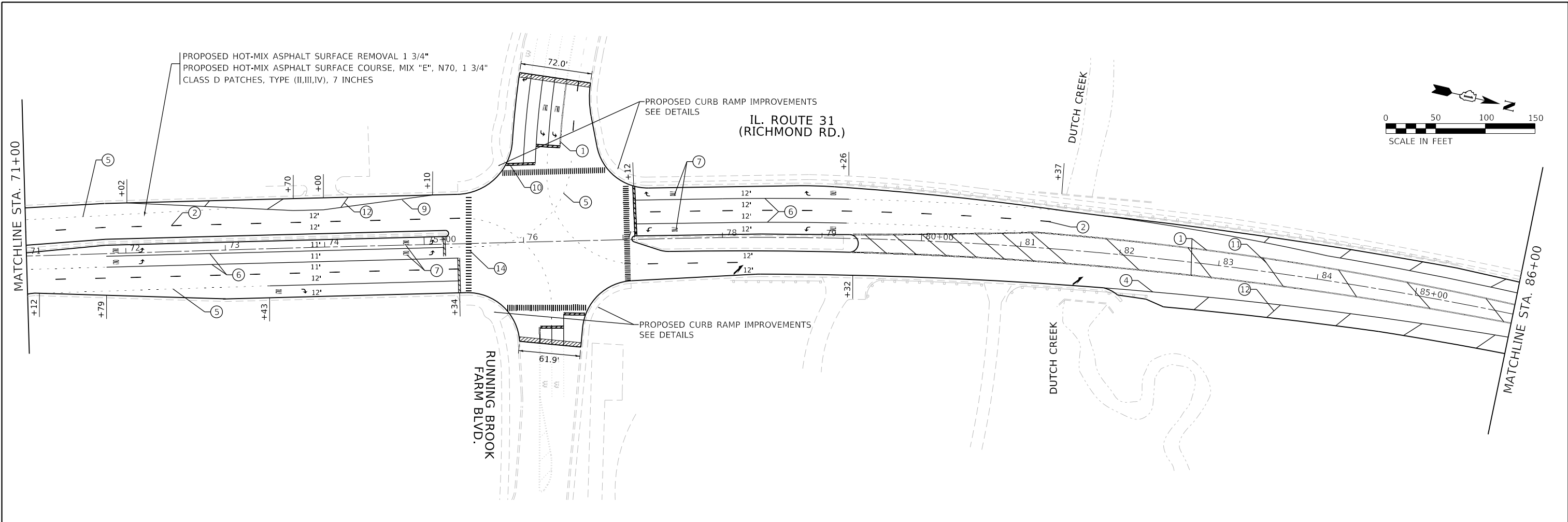

**PAVEMENT MARKING LEGEND**

- ① LINE 2 @ 4" SOLID YELLOW, 11" C-C - CENTERLINE (TYP)
- ② LINE 4", SKIP-DASH, WHITE (10' LINE - 30' SPACE) - LANE LINES
- ③ LINE 4", SOLID, YELLOW - EDGE LINE (TYP)
- ④ LINE 4", SOLID WHITE - EDGE LINE (TYP)
- ⑤ LINE 6", SKIP-DASH, WHITE (2' LINE - 6' SPACE) - DOTTED LINES (TYP)
- ⑥ LINE 6", SOLID WHITE - TURN LANE MARKING (TYP)
- ⑦ LETTERS & SYMBOLS, 8", SOLID, WHITE - TURN LANE MARKINGS (TYP)
- ⑧ LINE 2 @ 6", SOLID, WHITE - CROSSWALK LINES (PEDESTRIAN) (TYP)
- ⑨ LINE 8", SOLID, WHITE - GORE MARKING AND CHANNELIZING LINES (TYP)
- ⑩ LINE 24", SOLID, WHITE - STOP LINES (TYP)

NOTE: THERMOPLASTIC USED ON ASPHALT.  
MODIFIED URETHANE USED ON CONCRETE.

**LEGEND**

- ⑪ LINE 12", SOLID, YELLOW - PAINTED MEDIANS DIAGONALS (TYP) (SEE DISTRICT DETAIL TC-13 FOR SPACING)
- ⑫ LINE 12", SOLID, WHITE - SHOULDER DIAGONALS @ 45° (TYP) (SEE DISTRICT TC-13 FOR SPACING)
- ⑬ LINE 12", SOLID, WHITE - CHANNELIZATION LINES 45° (TYP) (SEE DISTRICT TC-13 FOR SPACING)
- ⑭ LINE 12", SOLID, WHITE - CONTINENTAL CROSSWALK (TYP)
- ⑮ PREFORMED PLASTIC PAVEMENT MARKING, TYPE B - INLAID - LINE 7" ON GROOVING FOR RECESSED PAVEMENT MARKING 8"

HMA SURFACE REMOVAL BUTT JOINT, 4.5'

MODEL: Default; FILE NAME: P:\2020\2020-09-04-00\_IDOT\_Various Phase 2 (FTEL 106 Item 16)Work Order 1510261CADD\_Sheets\162\156-SHT-PLAN\03.dwg

 <b>INFRASTRUCTURE ENGINEERING</b> INCORPORATED 1 South Wacker   Suite 2650   Chicago, IL 60606 P 312.425.9569   F 312.425.9568   www.infrastructure-eng.com	USER NAME = ALane	DESIGNED - IMU	REVISED -  ACL 12/17/2021
	PLOT SCALE = 100.0000' / in.	DRAWN - IMU	REVISED -
	PLOT DATE = 12/17/2021	CHECKED - ACL	REVISED -
		DATE - 08/13/2021	

**STATE OF ILLINOIS  
DEPARTMENT OF TRANSPORTATION**

**ROADWAY AND PAVEMENT MARKING PLANS  
IL-31 (MCCULLOM LAKE RD TO JOHNSBURG RD)**

SCALE: 1" = 50'      STA.      TO STA.

F.A.P. RTE. 336	SECTION	COUNTY	TOTAL SHEETS	SHEET NO.
	2021-024-R5	MCHENRY	28	11
CONTRACT NO. 62N56				
ILLINOIS FED. AID PROJECT				

REVISED SHEET 1/3/2022

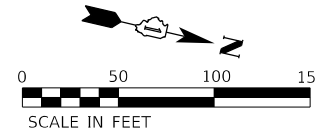
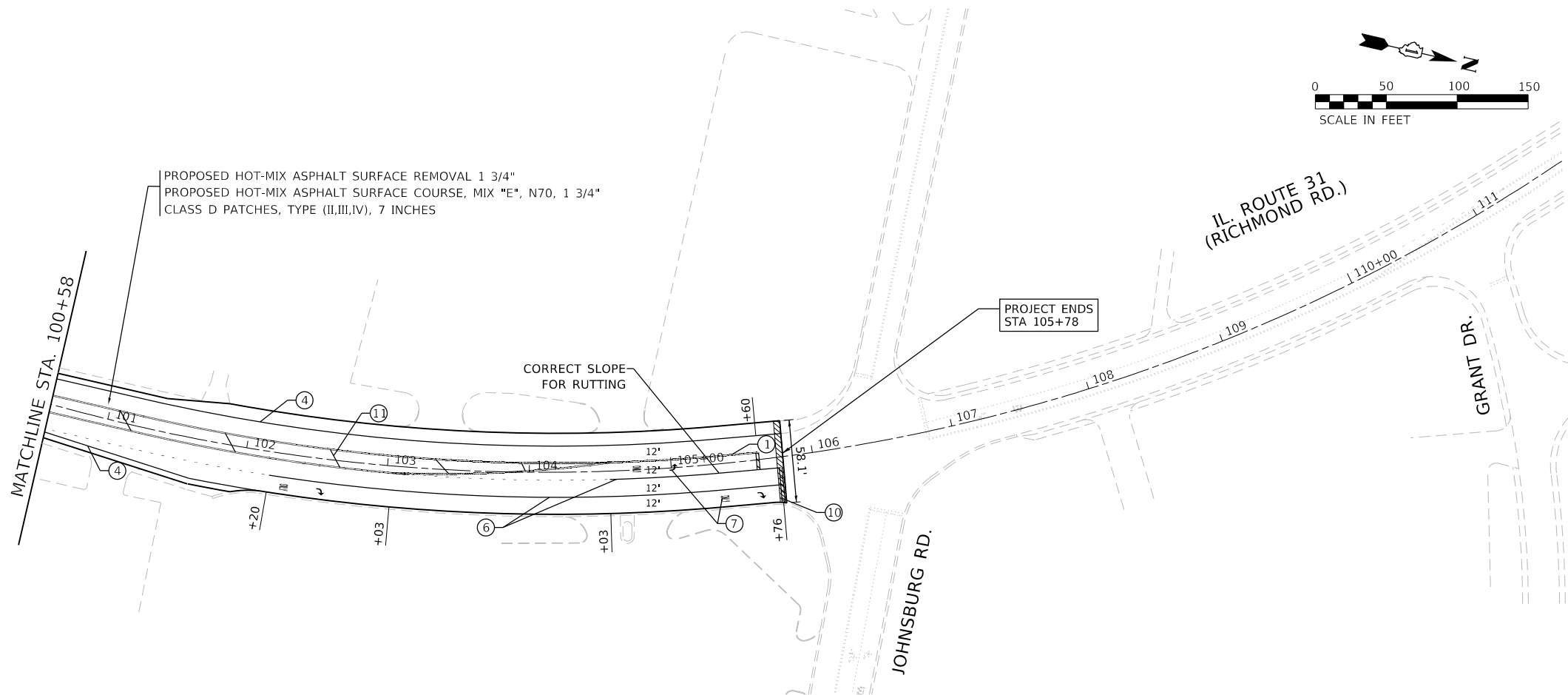

**PAVEMENT MARKING LEGEND**

- ① LINE 2 @ 4" SOLID YELLOW, 11" C-C - CENTERLINE (TYP)
- ② LINE 4", SKIP-DASH, WHITE (10' LINE - 30' SPACE) - LANE LINES
- ③ LINE 4", SOLID, YELLOW - EDGE LINE (TYP)
- ④ LINE 4", SOLID WHITE - EDGE LINE (TYP)
- ⑤ LINE 6", SKIP-DASH, WHITE (2' LINE - 6' SPACE) - DOTTED LINES (TYP)

NOTE: THERMOPLASTIC USED ON ASPHALT.  
MODIFIED URETHANE USED ON CONCRETE.

- ⑥ LINE 6", SOLID WHITE - TURN LANE MARKING (TYP)
- ⑦ LETTERS & SYMBOLS, 8", SOLID, WHITE - TURN LANE MARKINGS (TYP)
- ⑧ LINE 2 @ 6", SOLID, WHITE - CROSSWALK LINES (PEDESTRIAN) (TYP)
- ⑨ LINE 8", SOLID, WHITE - GORE MARKING AND CHANNELIZING LINES (TYP)
- ⑩ LINE 24", SOLID, WHITE - STOP LINES (TYP)

- ⑪ LINE 12", SOLID, YELLOW - PAINTED MEDIANS DIAGONALS (TYP) (SEE DISTRICT DETAIL TC-13 FOR SPACING)
- ⑫ LINE 12", SOLID, WHITE - SHOULDER DIAGONALS @ 45° (TYP) (SEE DISTRICT TC-13 FOR SPACING)
- ⑬ LINE 12", SOLID, WHITE - CHANNELIZATION LINES 45° (TYP) (SEE DISTRICT TC-13 FOR SPACING)
- ⑭ LINE 12", SOLID, WHITE - CONTINENTAL CROSSWALK (TYP)
- ⑮ PREFORMED PLASTIC PAVEMENT MARKING, TYPE B - INLAID - LINE 7" ON GROOVING FOR RECESSED PAVEMENT MARKING 8"

**LEGEND**



HMA SURFACE REMOVAL BUTT JOINT, 4.5'

MODEL: Dwg.rvt; FILE NAME: P:\2020\09\400 IDOT Various Phase 2 (RFB) 106 Item 16\Network Order 15\IDOT\CADD\_Sheets\62N56-SHT-PLAN.dwg



REVISED SHEET 1/3/2022

<p>INFRASTRUCTURE ENGINEERING INCORPORATED 1 South Wacker   Suite 2650   Chicago, IL 60606 P 312.425.9588   F 312.425.9588   www.infrastructure-eng.com</p>	USER NAME = ALane	DESIGNED - IMU	REVISED -  ACL 12/17/2021
	PLOT SCALE = 100.0000' / in.	DRAWN - IMU	REVISED -
	PLOT DATE = 12/17/2021	CHECKED - ACL	REVISED -
		DATE - 08/13/2021	

**STATE OF ILLINOIS  
DEPARTMENT OF TRANSPORTATION**

**ROADWAY AND PAVEMENT MARKING PLANS  
IL-31 (MCCULLOM LAKE RD TO JOHNSBURG RD)**

SCALE: 1" = 50'

STA. TO STA.

F.A.P. RTE.	SECTION	COUNTY	TOTAL SHEETS	SHEET NO.
336	2021-024-R5	MCHENRY	28	12
CONTRACT NO. 62N56				
ILLINOIS		FED. AID PROJECT		

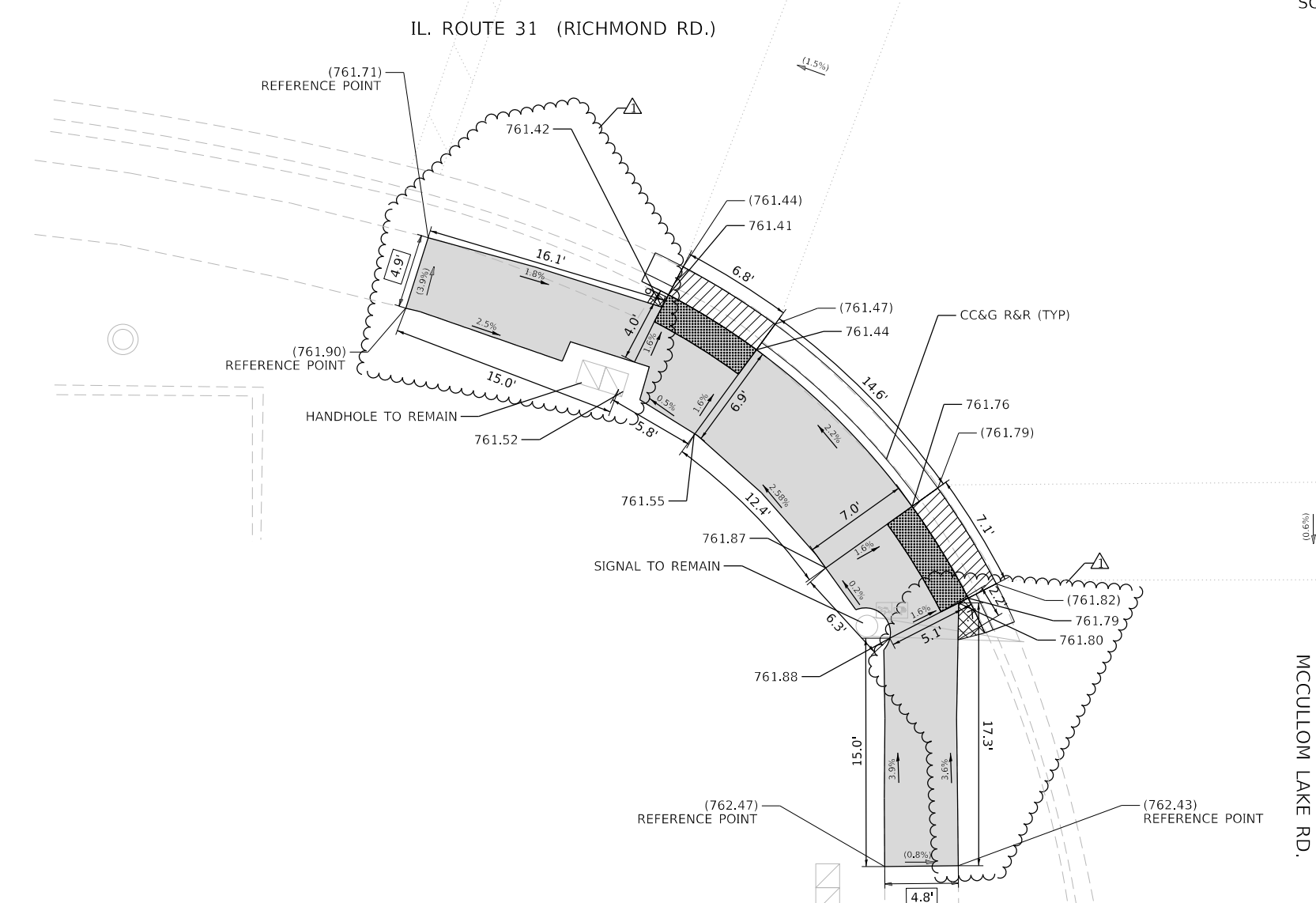
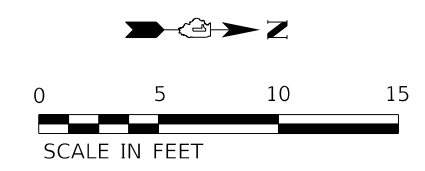

REFERENCE BENCHMARK: 5000-5689, ELEV. 762.43  
 BENCHMARK: FACE OF CANTILEVERED TRAFFIC SIGNAL FOUNDATION  
 LOCATION: SE CORNER OF RICHMOND AND MCCULLOM LAKE ROAD

**LEGEND**

xx.xx'	EXISTING LENGTH
( )	EXISTING ELEVATION / SLOPE
[Solid Grey]	PROPOSED SIDEWALK
[Cross-hatched]	DETECTABLE WARNINGS
[Diagonal Lines]	SIDEWALK REMOVAL REPLACE WITH TOPSOIL AND SOD
[Hatched]	DEPRESSED CURB AND GUTTER
[Double Line]	PROPOSED SIDE CURB

MODEL: D:\dgn\11...  
 FILE NAME: P:\2020\2020-09-14-00 IDOT Various Phase 2 (FBI\_106 Item 16)Work Order 151020\CADD\_Sheets\1621N56-SHT-ADA-005.dgn

1 REVISED SHEET 1/3/2022

<p><b>INFRASTRUCTURE ENGINEERING</b>          1 South Wacker   Suite 2650   Chicago, IL 60606          P 312.425.9568   F 312.425.9564   www.infrastructure-eng.com</p>	USER NAME = ALane	DESIGNED - IMU	REVISED -  ACL 12/17/2021
	PLOT SCALE = 10.0000 ' / in.	DRAWN - IMU	REVISED -
	PLOT DATE = 12/16/2021	CHECKED - ACL	REVISED -
		DATE - 10/29/2021	REVISED -

**STATE OF ILLINOIS**  
**DEPARTMENT OF TRANSPORTATION**

**ADA RAMP DETAILS**  
**IL-31 AT MCCULLOM LAKE RD.**

SCALE: 1" = 5'      STA.      TO STA.

F.A.P. RTE.	SECTION	COUNTY	TOTAL SHEETS	SHEET NO.
336	2021-024-R5	MCHENRY	28	12E
CONTRACT NO. 62N56			ILLINOIS FED. AID PROJECT	

IL. ROUTE 31 (RICHMOND RD.)

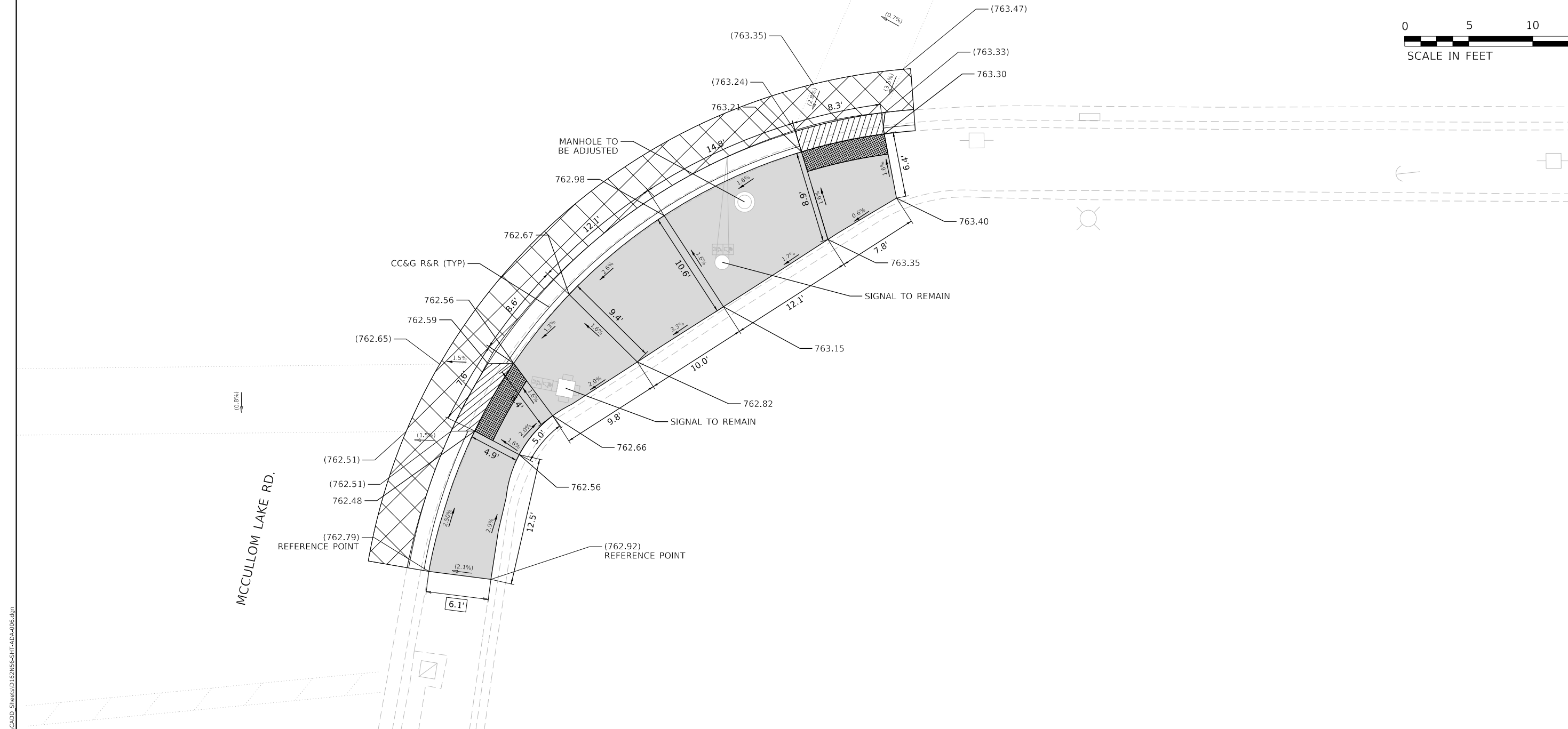
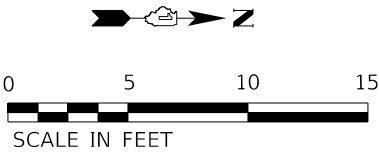

REFERENCE BENCHMARK: 5000-5689, ELEV. 762.43  
 BENCHMARK: FACE OF CANTILEVERED TRAFFIC SIGNAL FOUNDATION  
 LOCATION: SE CORNER OF RICHMOND AND MCCULLOM LAKE ROAD

**LEGEND**

- xx.xx' EXISTING LENGTH
- ( ) EXISTING ELEVATION / SLOPE
- PROPOSED SIDEWALK
- DETECTABLE WARNINGS
- SIDEWALK REMOVAL REPLACE WITH TOPSOIL AND SOD
- DEPRESSED CURB AND GUTTER
- PROPOSED SIDE CURB

MODEL: D:\draft\15112\CADD-Sheets\162\15156-SHT-ADA-006.dgn  
 FILE NAME: P:\2020\4094-00 IDOT Various Phase 2 (LEFT) 106 Item 16\Work Order 15112\CADD-Sheets\162\15156-SHT-ADA-006.dgn

**1** REVISED ENTIRE SHEET 1/3/2022

<p><b>INFRASTRUCTURE ENGINEERING</b> INCORPORATED 1 South Wacker   Suite 2650   Chicago, IL 60606 P 312.425.9588   F 312.425.9594   www.infrastructure-eng.com</p>	USER NAME = ALane	DESIGNED - IMU	REVISED -  ACL 12/17/2021
	PLOT SCALE = 10.0000" / in.	DRAWN - IMU	REVISED -
	PLOT DATE = 12/16/2021	CHECKED - ACL	REVISED -
		DATE - 10/29/2021	REVISED - SREV4_DA

**STATE OF ILLINOIS  
DEPARTMENT OF TRANSPORTATION**

<b>ADA RAMP DETAILS</b>			F.A.P. RTE.	SECTION	COUNTY	TOTAL SHEETS	SHEET NO.
IL-31 AT MCCULLOM LAKE RD.			336	2021-024-R5	MCHENRY	28	12F
SCALE: 1" = 5'			STA. TO STA.		CONTRACT NO. 62N56		
			ILLINOIS FED. AID PROJECT				



IL. ROUTE 31 (RICHMOND RD.)

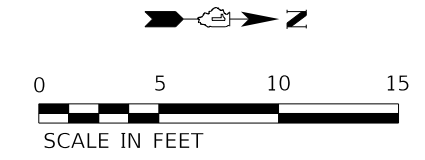
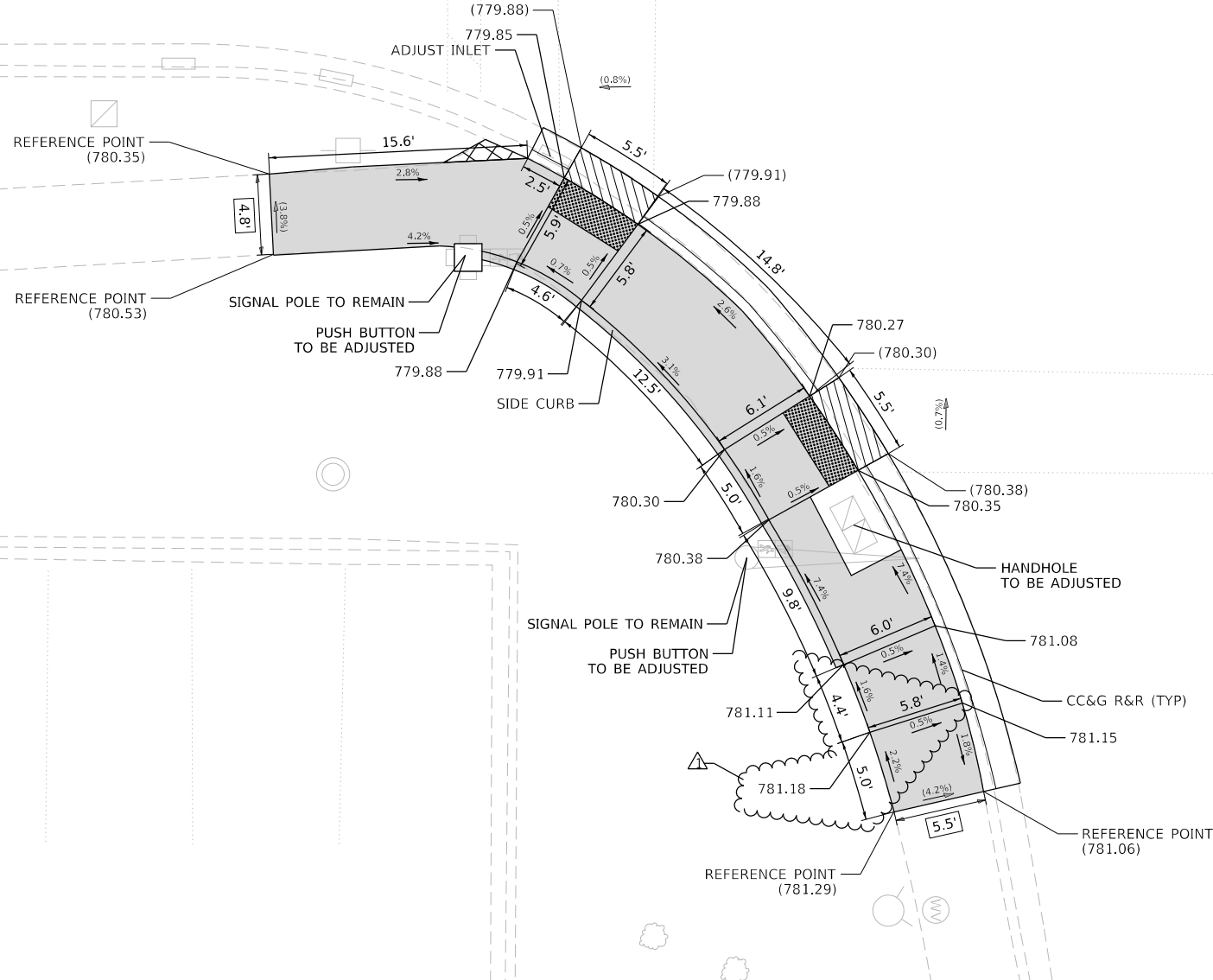

IL. ROUTE 31 (RICHMOND RD.)

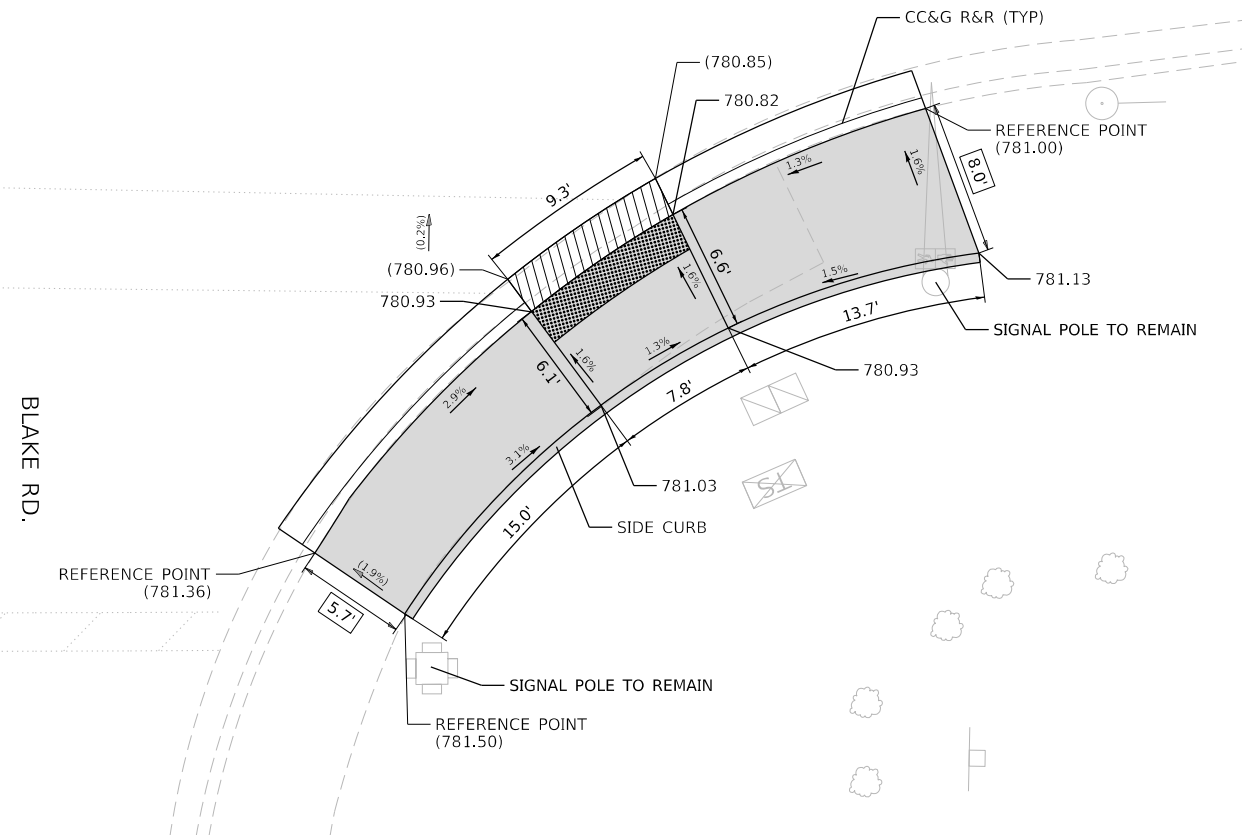

REFERENCE BENCHMARK: 1000 , ELEV. 782.292  
 BENCHMARK: CUT SQUARE ON TRAFFIC CONTROL BOX  
 LOCATION: NORTH EAST CONNER OF RICHMOND RD. AND BLAKE BLVD.

**LEGEND**

- xx.xx'      EXISTING LENGTH
- (        )      EXISTING ELEVATION / SLOPE
- PROPOSED SIDEWALK
- DETECTABLE WARNINGS
- SIDEWALK REMOVAL REPLACE WITH TOPSOIL AND SOD
- DEPRESSED CURB AND GUTTER
- — — — —      PROPOSED SIDE CURB

MODEL: D:\d\inf\161116\161116.dwg  
 FILE NAME: P:\2020\2020-09-14-00 IDOT Various Phase 2 (RFB\_106 Item 16)Work Order 1510201CADD\_Sheets\162156-SHT\_ADA-C09.dgn



USER NAME = ALane	DESIGNED - IMU	REVISED - ACL 12/17/2021
PLOT SCALE = 10.0000 ' / in.	DRAWN - IMU	REVISED -
PLOT DATE = 12/16/2021	CHECKED - ACL	REVISED -
	DATE - 10/31/2021	REVISED -

**STATE OF ILLINOIS  
 DEPARTMENT OF TRANSPORTATION**

**ADA RAMP DETAILS  
 IL-31 AT BLAKE RD.**

SCALE: 1" = 5'      STA.      TO STA.

F.A.P. RTE. 336		SECTION 2021-024-R5	COUNTY MCHENRY	TOTAL SHEETS 28	SHEET NO. 121
		CONTRACT NO. 62N56			
		ILLINOIS	FED. AID PROJECT		

REVISED SHEET 1/3/2022