

PAY ITEM NUMBER	DESIGNATION	UNIT	TOTAL QUANTITY	CONSTRUCTION CODE	
				URBAN	0005
				80% FEDERAL 20% STATE	100% STATE
20200100	EARTH EXCAVATION	CU YD	39	39	
21101615	TOPSOIL FURNISH AND PLACE, 4"	SQ YD	160	160	
25200110	SODDING, SALT TOLERANT	SQ YD	160	160	
25200200	SUPPLEMENTAL WATERING	UNIT	1	1	
28000250	TEMPORARY EROSION CONTROL SEEDING	POUND	38	38	
28000510	INLET FILTERS	EACH	30	30	
35101400	AGGREGATE BASE COURSE, TYPE B	TON	26	26	
40600290	BITUMINOUS MATERIALS (TACK COAT)	POUND	30,827	30,827	
40600370	LONGITUDINAL JOINT SEALANT	FOOT	49,354 <del>46,630</del>	49,354 <del>46,630</del>	1
40600400	MIXTURE FOR CRACKS, JOINTS, AND FLANGEWAYS	TON	103	103	
40600982	HOT-MIX ASPHALT SURFACE REMOVAL - BUTT JOINT	SQ YD	371	371	
<del>40601005</del>	<del>HOT-MIX ASPHALT REPLACEMENT OVER PATCHES</del>	<del>TON</del>	<del>8</del>	<del>8</del>	
40604060	HOT-MIX ASPHALT SURFACE COURSE, IL-9.5, MIX "D", N50	TON	8	8	
40604172	POLYMERIZED HOT-MIX ASPHALT SURFACE COURSE, IL-9.5, MIX "E", N70	TON	6,714	6,714	
42000060	WELDED WIRE REINFORCEMENT	SQ YD	520	520	
42001300	PROTECTIVE COAT	SQ YD	1,638	1,638	
42400200	PORTLAND CEMENT CONCRETE SIDEWALK 5 INCH	SQ FT	4,179	4,179	
42400800	DETECTABLE WARNINGS	SQ FT	550	550	
44000156	HOT-MIX ASPHALT SURFACE REMOVAL, 1 3/4"	SQ YD	68,505	68,505	
44000600	SIDEWALK REMOVAL	SQ FT	4,179	4,179	
<del>44002227</del>	<del>HOT-MIX ASPHALT REMOVAL OVER PATCHES, 6 3/4"</del>	<del>SQ YD</del>	<del>4,179</del>	<del>4,179</del>	
44200994	CLASS B PATCHES, TYPE II, 12 INCH	SQ YD	560	560	
44200998	CLASS B PATCHES, TYPE III, 12 INCH	SQ YD	400	400	

\* = SPECIALTY ITEM

PAY ITEM NUMBER	DESIGNATION	UNIT	TOTAL QUANTITY	CONSTRUCTION CODE	
				URBAN	0005
				80% FEDERAL 20% STATE	100% STATE
44201000	CLASS B PATCHES, TYPE IV, 12 INCH	SQ YD	120	120	
<del>44201299</del>	<del>DOWEL BARS 1 1/2"</del>	<del>EACH</del>	<del>1,860</del>	<del>1,860</del>	
44201803	CLASS D PATCHES, TYPE II, 13 INCH	SQ YD	780	780	
44201741	CLASS D PATCHES, TYPE II, 8 INCH	SQ YD	780	780	
44201807	CLASS D PATCHES, TYPE III, 13 INCH	SQ YD	415	415	
44201745	CLASS D PATCHES, TYPE III, 8 INCH	SQ YD	415	415	
44201809	CLASS D PATCHES, TYPE IV, 13 INCH	SQ YD	750	750	
44201747	CLASS D PATCHES, TYPE IV, 8 INCH	SQ YD	750	750	
44213200	SAW CUTS	FOOT	4,968	4,968	
44213204	TIE BARS 3/4"	EACH	45	45	
48102100	AGGREGATE WEDGE SHOULDER, TYPE B	TON	200	200	
60255500	MANHOLES TO BE ADJUSTED	EACH	6	6	
60260100	INLETS TO BE ADJUSTED	EACH	8	8	
60266600	VALVE BOXES TO BE ADJUSTED	EACH	2	2	
60404950	FRAMES AND GRATES, TYPE 24	EACH	2	2	
60406000	FRAMES AND LIDS, TYPE 1, OPEN LID	EACH	2	2	
60406100	FRAMES AND LIDS, TYPE 1, CLOSED LID	EACH	8	8	
60618320	CONCRETE MEDIAN SURFACE, 6 INCH	SQ FT	417	417	
* 66900200	NON-SPECIAL WASTE DISPOSAL	CU YD	21	21	
* 66900530	SOIL DISPOSAL ANALYSIS	EACH	4	4	
* 66901001	REGULATED SUBSTANCES PRE-CONSTRUCTION PLAN	L SUM	1	1	
* 66901003	REGULATED SUBSTANCES FINAL CONSTRUCTION REPORT	L SUM	1	1	
* 66901006	REGULATED SUBSTANCES MONITORING	CAL DA	4	4	
<del>67000400</del>	<del>ENGINEER'S FIELD OFFICE, TYPE A</del>	<del>CAL MO</del>	<del>12</del>	<del>12</del>	
67100100	MOBILIZATION	L SUM	1	1	
70102620	TRAFFIC CONTROL AND PROTECTION, STANDARD 701501	L SUM	1	1	

MODEL: Default  
 FILE NAME: P:\2020-2020-099-4-00 IDOT Various Phase 1 (P) 196 Item 16\Work Order 15\DOC\CADD Sheets\0162N56-SHT-5000-01.dgn

**INFRASTRUCTURE ENGINEERING**  
 INCORPORATED  
 1 South Wacker | Suite 2650 | Chicago, IL 60606  
 P 312.425.9580 | F 312.425.9584 | www.infrastructure-eng.com

USER NAME = ALane	DESIGNED - IMU	REVISED - 1
PLOT SCALE = 20.0000' / in.	DRAWN - IMU	REVISED -
PLOT DATE = 10/21/2021	CHECKED - ACL	REVISED -
	DATE - 08/13/2021	

**STATE OF ILLINOIS**  
**DEPARTMENT OF TRANSPORTATION**

**SUMMARY OF QUANTITIES**  
**IL-31 (MCCULLOM LAKE RD TO JOHNSBURG RD)**

SCALE: NTS

STA. TO STA.

F.A.P. RTE. 336	SECTION 2021-024-R5	COUNTY MCHENRY	TOTAL SHEETS 28	SHEET NO. 3
CONTRACT NO. 62N56			ILLINOIS FED. AID PROJECT	

3 REVISED SHEET 1/13/2022     1 REVISED SHEET 1/3/2022

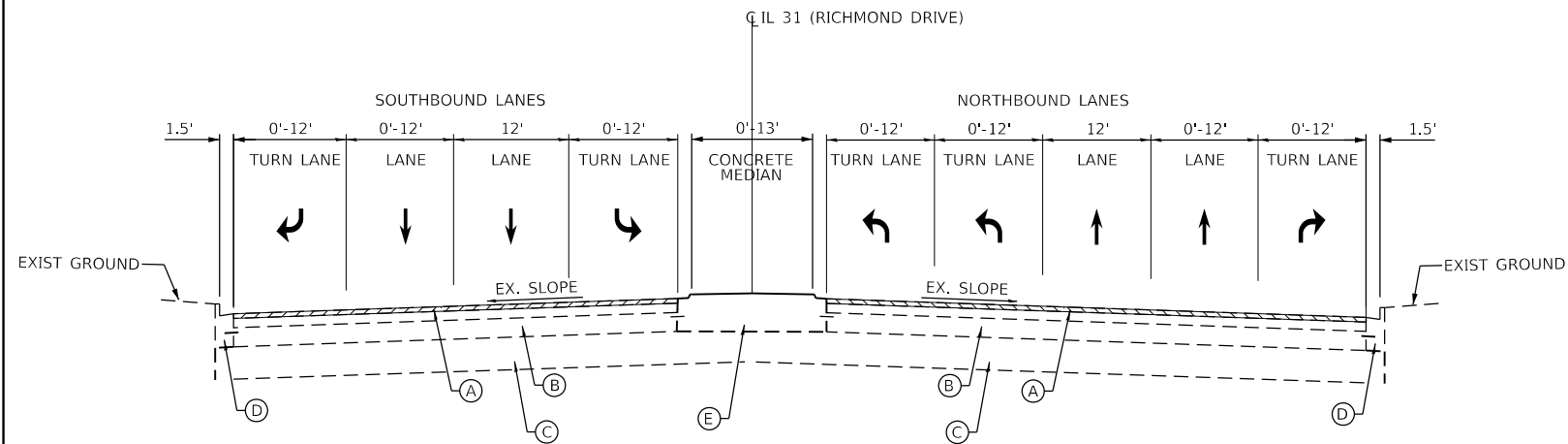

**LEGEND**

- (A) EXISTING HOT-MIX ASPHALT PAVEMENT 6 3/4"
- (B) EXISTING P.C.C. BASE COURSE 8"
- (C) EXISTING SUB-BASE GRANULAR MATERIAL, TYP B, 4"±
- (D) EXISTING COMBINATION CONCRETE CURB AND GUTTER, TYPE B-6.24
- (E) EXISTING COMBINATION CONCRETE CURB AND GUTTER, TYPE M-6.12
- (F) EXISTING CONCRETE 12"
- (G) PAVED SHOULDER
- ① POLYMERIZED HOT-MIX ASPHALT SURFACE COURSE MIX "E", IL-9.5, N70, 1-3/4"
- ② HOT-MIX ASPHALT SURFACE COURSE MIX "D", IL-9.5, N50, 2"
- ③ CLASS B PATCHES TYPE (II,III,IV), 12 INCH

**LEGEND:**

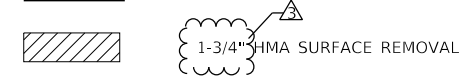

**NOTES:**

1. THE LONGITUDINAL JOINT SEALANT SHALL BE PLACED OVER THE MILLED SURFACE.
2. THE CONTRACTOR SHALL MILL FIRST THEN PATCH.

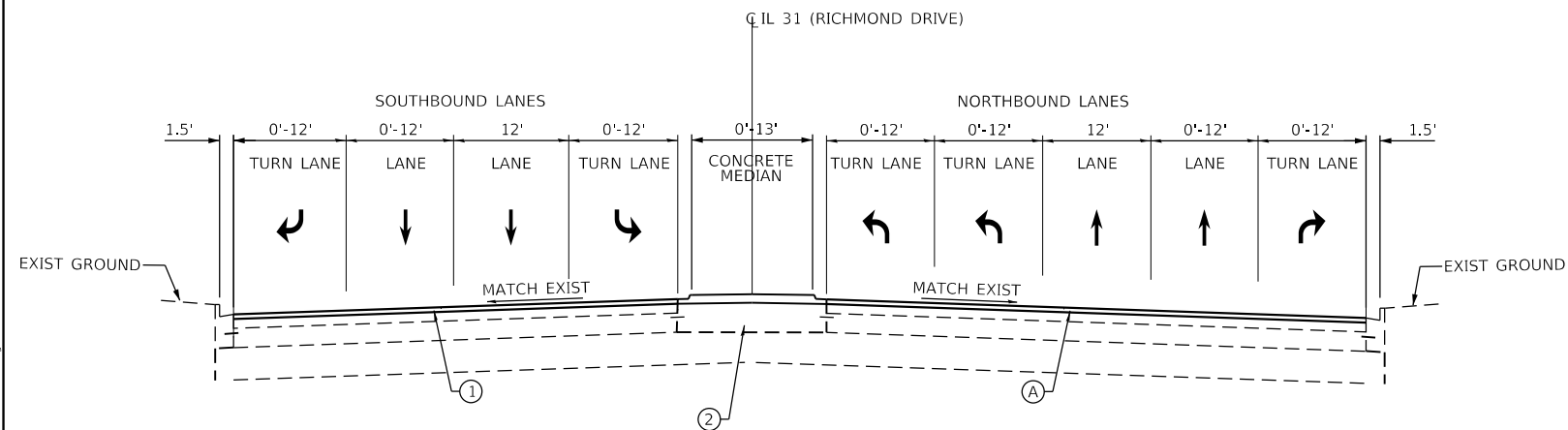

HOT-MIX ASPHALT MIXTURE REQUIREMENTS		QUALITY MANAGEMENT PROGRAM (QMP)
MIXTURE TYPE	AIR VOIDS @ Ndes	
PAVEMENT RESURFACING		
POLYMERIZED HOT-MIX ASPHALT SURFACE COURSE, MIX "E", IL-9.5, N70, 1-3/4"	4.0% @ 70 GYR	QCP
MEDIAN RESURFACING		
HOT-MIX ASPHALT SURFACE COURSE, MIX "D", IL-9.5, N50, 2"	4.0% @ 50 GYR	QC/QA
PATCHING		
CLASS D PATCHES, TYPE (II,III,IV), 13" HMA BINDER IL-19)	4.0% @ 70 GYR	QC/QA
QMP DESIGNATION: QUALITY CONTROL / QUALITY ASSURANCE (QC/QA): QUALITY CONTROL FOR PERFORMANCE (QCP): PAY FOR PERFORMANCE (PFP)		

MIXTURE REQUIREMENT NOTES:

1. THE UNIT WEIGHT USED TO CALCULATE ALL HMA SURFACE MIXTURE QUANTITIES IS 112 LBS/SQ YD/IN.
2. THE "AC TYPE" FOR POLYMERIZED HMA MIXES SHALL BE "SBS/SBR PG 76 -22" AND FOR NON-POLYMERIZED HMA THE "AC TYPE" SHALL BE "PG 64 -22" UNLESS MODIFIED BY RECLAIMED MATERIALS SPECIFICATIONS.

MODEL: D:\dgn\11\11-20-20\04-09-20\DOT\_Various Phase 2 (PFB) 106 Item 16\Work Order 15\DC\DCADD\_Sheets\162\N56-SHT-TYPICAL-01.dgn  
 FILE NAME: P:\2020\04-09-20\DOT\_Various Phase 2 (PFB) 106 Item 16\Work Order 15\DC\DCADD\_Sheets\162\N56-SHT-TYPICAL-01.dgn

INFRASTRUCTURE ENGINEERING INCORPORATED 1 South Wacker   Suite 2650   Chicago, IL 60606 P 312.425.9569   F 312.425.9568   www.infrastructure-eng.com	USER NAME = ALane	DESIGNED - IMU	REVISED - ACL 1/12/2022
	PLOT SCALE = 20.0000' / in.	DRAWN - IMU	REVISED -
		CHECKED - ACL	REVISED -
		DATE - 08/13/2021	

**STATE OF ILLINOIS  
DEPARTMENT OF TRANSPORTATION**

**TYPICAL SECTIONS  
IL-31 (MCCULLOM LAKE RD TO JOHNSBURG RD)**

F.A.P. RTE. 336	SECTION 2021-024-R5	COUNTY MCHENRY	TOTAL SHEETS 28	SHEET NO. 5
ILLINOIS FED. AID PROJECT			CONTRACT NO. 62N56	

REVISED SHEET 1/13/2022

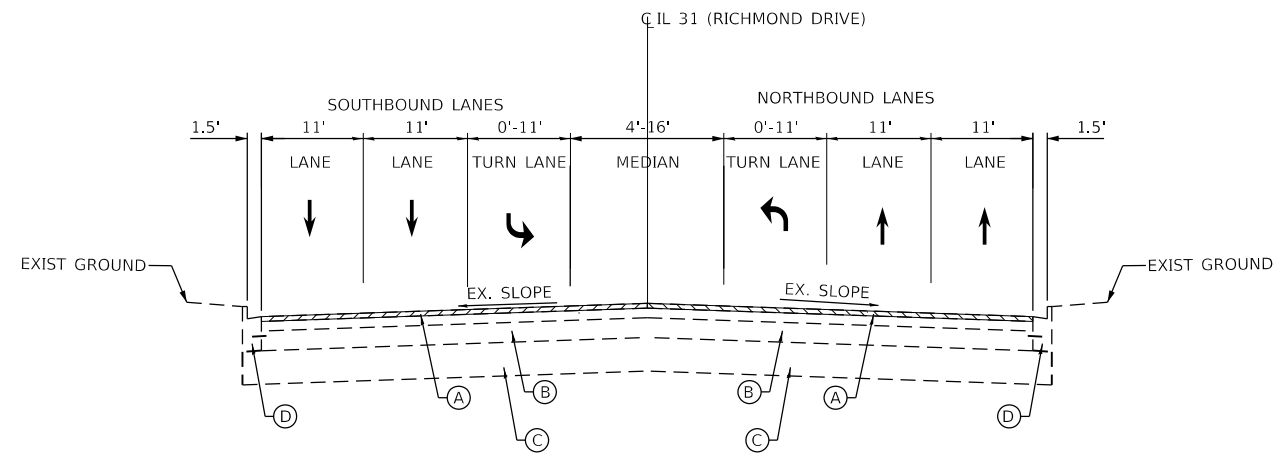

**EXISTING TYPICAL CROSS SECTION**

STA. 14+92 TO STA. 25+47  
STA. 39+76 TO STA. 68+61

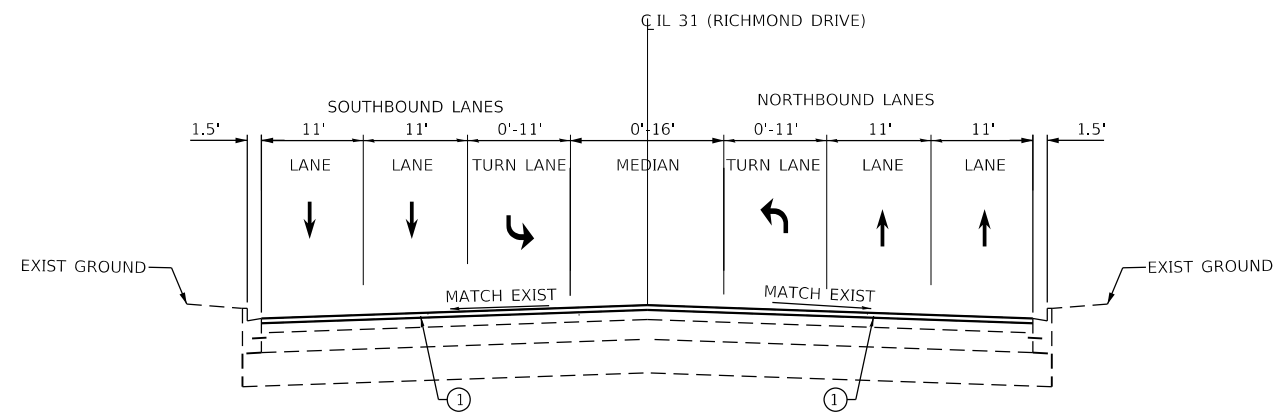

**PROPOSED TYPICAL CROSS SECTION**

STA. 14+92 TO STA. 25+47  
STA. 39+76 TO STA. 68+61

**LEGEND**

- (A) EXISTING HOT-MIX ASPHALT PAVEMENT 6 3/4"
- (B) EXISTING P.C.C. BASE COURSE 8"
- (C) EXISTING SUB-BASE GRANULAR MATERIAL, TYP B, 4"±
- (D) EXISTING COMBINATION CONCRETE CURB AND GUTTER, TYPE B-6.24
- (E) EXISTING COMBINATION CONCRETE CURB AND GUTTER, TYPE M-6.12
- (F) EXISTING CONCRETE 12"
- (G) PAVED SHOULDER
- (1) POLYMERIZED HOT-MIX ASPHALT SURFACE COURSE MIX "E", IL-9.5, N70, 1-3/4"
- (2) HOT-MIX ASPHALT SURFACE COURSE MIX "D", IL-9.5, N50, 2"
- (3) CLASS B PATCHES TYPE (II,III,IV), 12 INCH

**LEGEND:**

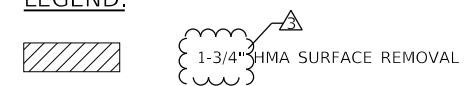

**NOTES:**

1. THE LONGITUDINAL JOINT SEALANT SHALL BE PLACED OVER THE MILLED SURFACE.
2. THE CONTRACTOR SHALL MILL FIRST THEN PATCH.

MODEL: D:\dgn\... FILE NAME: P:\2020\2020-09-14-00 IDOT Various Phase 2 (FBI\_106 Item 16)Work Order 15\DC\GADD\_Sheets\162\N56-SHT-TYPICAL-02.dgn

**INFRASTRUCTURE ENGINEERING** INCORPORATED  
1 South Wacker | Suite 2650 | Chicago, IL 60606  
P 312.425.9569 | F 312.425.9568 | www.infrastructure-eng.com

USER NAME = ALane	DESIGNED - IMU	REVISED - <sup>3</sup> ACL 1/12/2022
PLOT SCALE = 20.0000' / in.	DRAWN - IMU	REVISED -
	CHECKED - ACL	REVISED -
	DATE - 08/13/2021	

**STATE OF ILLINOIS  
DEPARTMENT OF TRANSPORTATION**

<b>TYPICAL SECTIONS</b>	
<b>IL-31 (MCCULLOM LAKE RD TO JOHNSBURG RD)</b>	
SCALE: NTS	STA. TO STA.

F.A.P. RTE. 336	SECTION 2021-024-R5	COUNTY MCHENRY	TOTAL SHEETS 28	SHEET NO. 6
ILLINOIS			FED. AID PROJECT	

**3** REVISED SHEET 1/13/2022

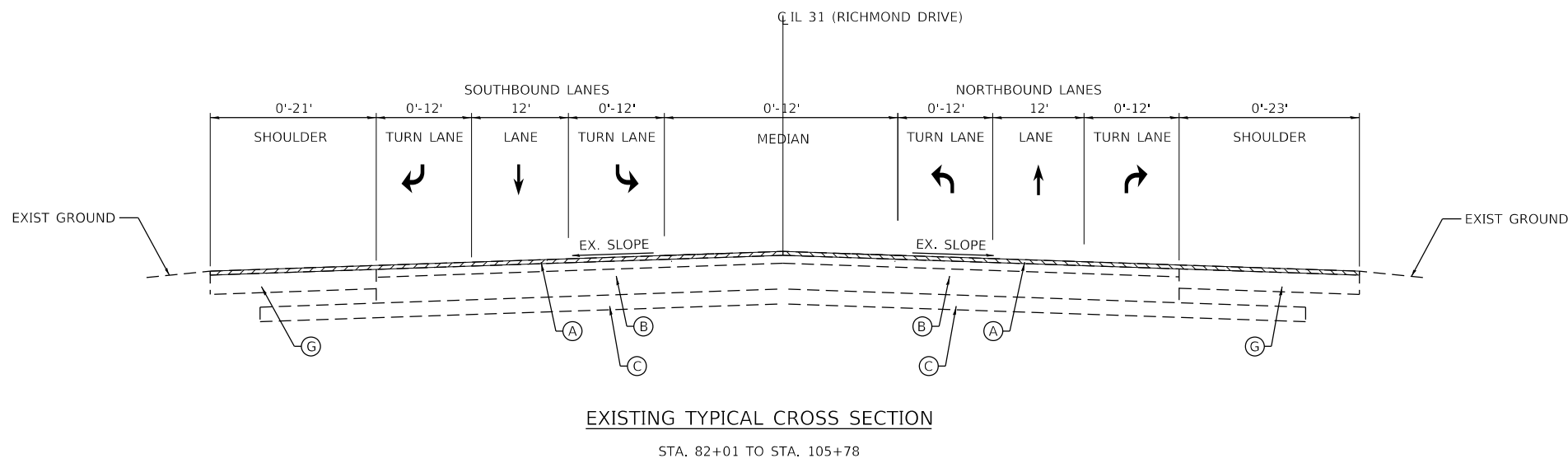

**LEGEND**

- (A) EXISTING HOT-MIX ASPHALT PAVEMENT 6 3/4"
- (B) EXISTING P.C.C. BASE COURSE 8"
- (C) EXISTING SUB-BASE GRANULAR MATERIAL, TYP B, 4"±
- (D) EXISTING COMBINATION CONCRETE CURB AND GUTTER, TYPE B-6.24
- (E) EXISTING COMBINATION CONCRETE CURB AND GUTTER, TYPE M-6.12
- (F) EXISTING CONCRETE 12"
- (G) PAVED SHOULDER
- (1) POLYMERIZED HOT-MIX ASPHALT SURFACE COURSE MIX "E", IL-9.5, N70, 1-3/4"
- (2) HOT-MIX ASPHALT SURFACE COURSE MIX "D", IL-9.5, N50, 2"
- (3) CLASS B PATCHES TYPE (II,III,IV), 12 INCH

**LEGEND:**

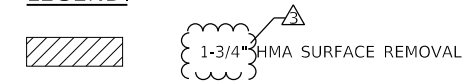

**NOTES:**

1. THE LONGITUDINAL JOINT SEALANT SHALL BE PLACED OVER THE MILLED SURFACE.
2. THE CONTRACTOR SHALL MILL FIRST THEN PATCH.

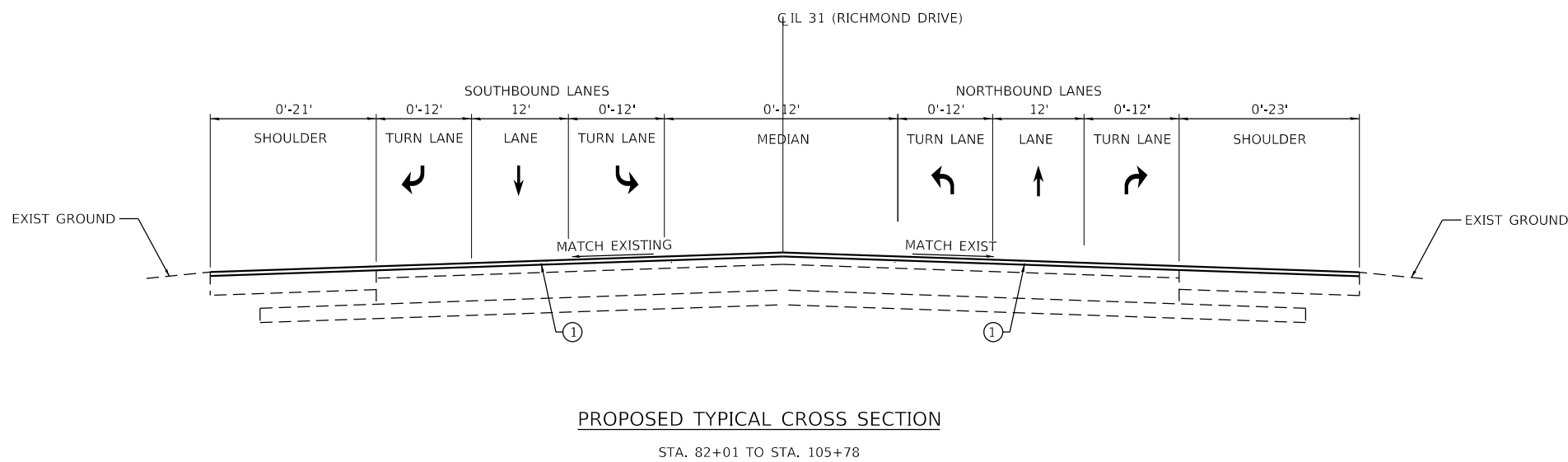

MODEL: Default  
 FILE NAME: P:\2020\2020-09-04-00 IDOT Various Phase 2 (FBI\_106 Item 16)Work Order 151DGN\CADD\_Sheets\162N56-SHT-TYPICAL-04.dgn

**INFRASTRUCTURE ENGINEERING INCORPORATED**  
 1 South Wacker | Suite 2650 | Chicago, IL 60606  
 P 312.425.9569 | F 312.425.9568 | www.infrastructure-eng.com

USER NAME = ALane	DESIGNED - IMU	REVISED - <sup>3</sup> ACL 1/12/2022
DRAWN - IMU	CHECKED - ACL	REVISED -
PLOT SCALE = 20.0000' / in.	DATE - 08/13/2021	

**STATE OF ILLINOIS  
DEPARTMENT OF TRANSPORTATION**

**TYPICAL SECTIONS  
IL-31 (MCCULLOM LAKE RD TO JOHNSBURG RD)**

SCALE: NTS      STA.      TO STA.

F.A.P. RTE.	SECTION	COUNTY	TOTAL SHEETS	SHEET NO.
336	2021-024-R5	MCHENRY	28	8
CONTRACT NO. 62N56				
ILLINOIS FED. AID PROJECT				

**3** REVISED SHEET 1/13/2022

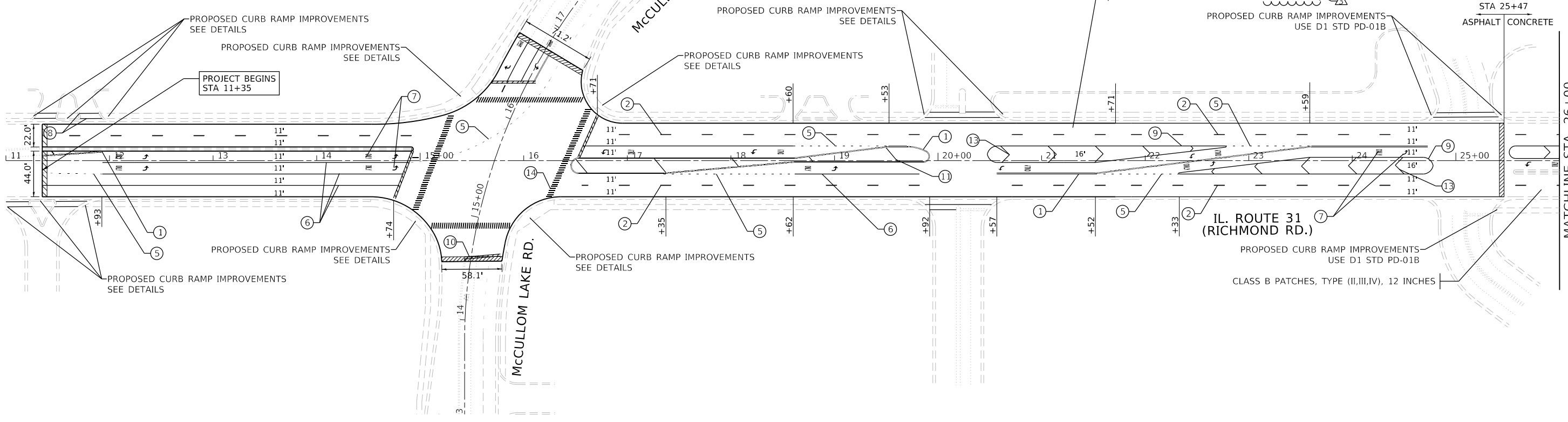
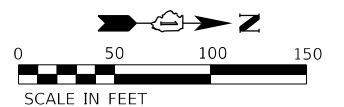

**LEGEND**

HMA SURFACE REMOVAL BUTT JOINT, 4.5'

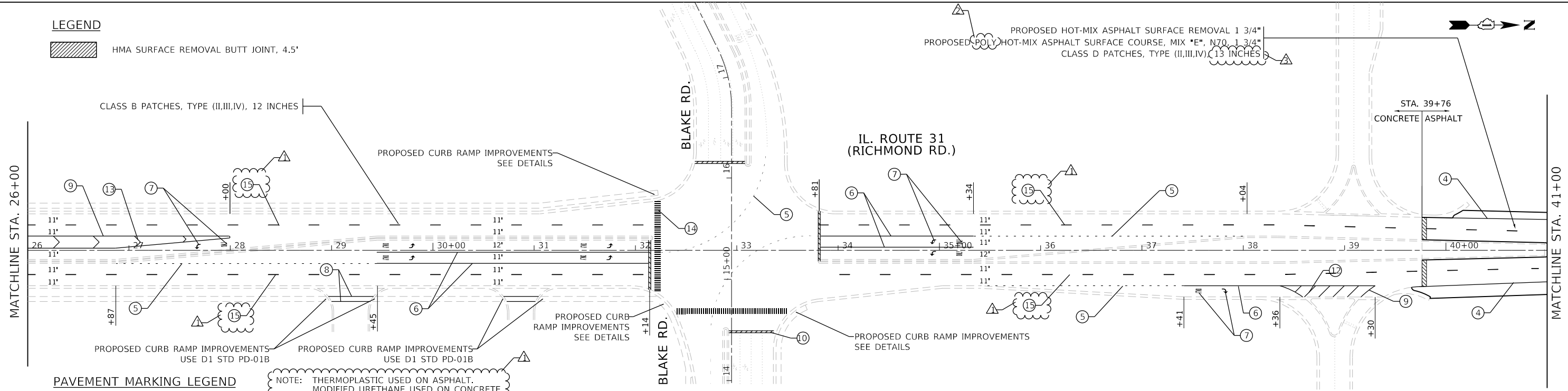

**PAVEMENT MARKING LEGEND**

NOTE: THERMOPLASTIC USED ON ASPHALT. MODIFIED URETHANE USED ON CONCRETE.

- ① LINE 2 @ 4" SOLID YELLOW, 11" C-C - CENTERLINE (TYP)
- ② LINE 4", SKIP-DASH, WHITE (10' LINE - 30' SPACE) - LANE LINES
- ③ LINE 4", SOLID, YELLOW - EDGE LINE (TYP)
- ④ LINE 4", SOLID WHITE - EDGE LINE (TYP)
- ⑤ LINE 6", SKIP-DASH, WHITE (2' LINE - 6' SPACE) - DOTTED LINES (TYP)
- ⑥ LINE 6", SOLID WHITE - TURN LANE MARKING (TYP)
- ⑦ LETTERS & SYMBOLS, 8", SOLID, WHITE - TURN LANE MARKINGS (TYP)
- ⑧ LINE 2 @ 6", SOLID, WHITE - CROSSWALK LINES (PEDESTRIAN) (TYP)
- ⑨ LINE 8", SOLID, WHITE - GORE MARKING AND CHANNELIZING LINES (TYP)
- ⑩ LINE 24", SOLID, WHITE - STOP LINES (TYP)
- ⑪ LINE 12", SOLID, YELLOW - PAINTED MEDIANS DIAGONALS (TYP) (SEE DISTRICT DETAIL TC-13 FOR SPACING)
- ⑫ LINE 12", SOLID, WHITE - SHOULDER DIAGONALS @ 45° (TYP) (SEE DISTRICT TC-13 FOR SPACING)
- ⑬ LINE 12", SOLID, WHITE - CHANNELIZATION LINES 45° (TYP) (SEE DISTRICT TC-13 FOR SPACING)
- ⑭ LINE 12", SOLID, WHITE - CONTINENTAL CROSSWALK (TYP)
- ⑮ PREFORMED PLASTIC PAVEMENT MARKING, TYPE B - LINE 7" (4" WHITE OVER 7" BLACK) ON GROOVING FOR RECESSED PAVEMENT MARKING 8"

- ③ REVISED SHEET 1/13/2022
- ② REVISED SHEET 1/7/2022
- ① REVISED SHEET 1/3/2022

MODEL: Dwg.rvt FILE NAME: P:\2020-2024\09-400 IDOT Varioris Phase 2 (FTR) 106 Item 16\Work Order 15102\ICADD\_Sheets\162\N56-SHT-PLN-01.dgn

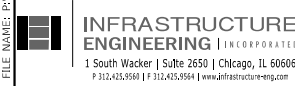

USER NAME = ALane	DESIGNED - IMU	REVISED -  ACL 12/17/2021
PLOT SCALE = 100.0000' / in.	DRAWN - IMU	REVISED -  ACL 1/6/2022
	CHECKED - ACL	REVISED -  ACL 1/12/2022
	DATE - 08/13/2021	

**STATE OF ILLINOIS  
DEPARTMENT OF TRANSPORTATION**

**ROADWAY AND PAVEMENT MARKING PLANS  
IL-31 (MCCULLOM LAKE RD TO JOHNSBURG RD)**

SCALE: 1" = 50' STA. TO STA.

F.A.P. RTE.	SECTION	COUNTY	TOTAL SHEETS	SHEET NO.
336	2021-024-R5	MCHENRY	28	9
CONTRACT NO. 62N56				
ILLINOIS FED. AID PROJECT				

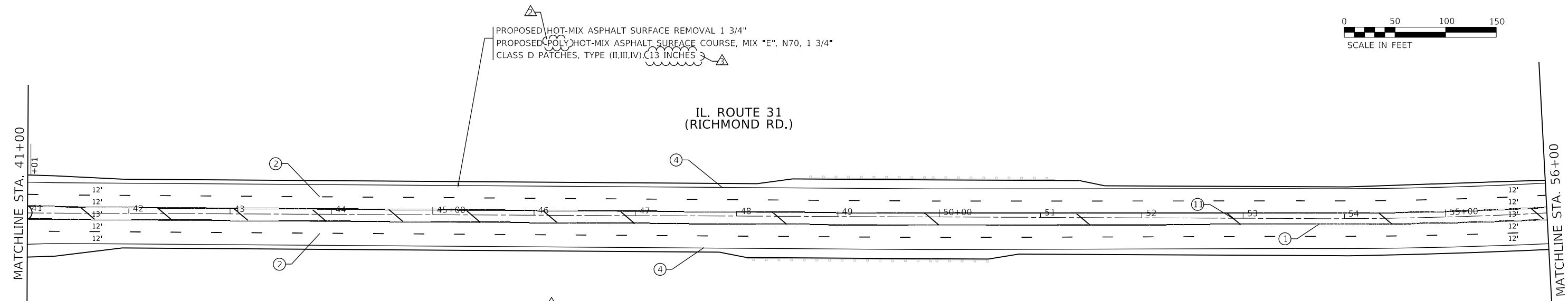
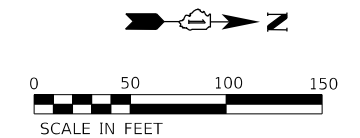

**PAVEMENT MARKING LEGEND**

NOTE: THERMOPLASTIC USED ON ASPHALT.  
MODIFIED URETHANE USED ON CONCRETE.

- ① LINE 2 @ 4" SOLID YELLOW, 11" C-C - CENTERLINE (TYP)
- ② LINE 4", SKIP-DASH, WHITE (10' LINE - 30' SPACE) - LANE LINES
- ③ LINE 4", SOLID, YELLOW - EDGE LINE (TYP)
- ④ LINE 4", SOLID WHITE - EDGE LINE (TYP)
- ⑤ LINE 6", SKIP-DASH, WHITE (2' LINE - 6' SPACE) - DOTTED LINES (TYP)
- ⑥ LINE 6", SOLID WHITE - TURN LANE MARKING (TYP)
- ⑦ LETTERS & SYMBOLS, 8", SOLID, WHITE - TURN LANE MARKINGS (TYP)
- ⑧ LINE 2 @ 6", SOLID, WHITE - CROSSWALK LINES (PEDESTRIAN) (TYP)
- ⑨ LINE 8", SOLID, WHITE - GORE MARKING AND CHANNELIZING LINES (TYP)
- ⑩ LINE 24", SOLID, WHITE - STOP LINES (TYP)
- ⑪ LINE 12", SOLID, YELLOW - PAINTED MEDIANS DIAGONALS (TYP) (SEE DISTRICT DETAIL TC-13 FOR SPACING)
- ⑫ LINE 12", SOLID, WHITE - SHOULDER DIAGONALS @ 45° (TYP) (SEE DISTRICT TC-13 FOR SPACING)
- ⑬ LINE 12", SOLID, WHITE - CHANNELIZATION LINES 45° (TYP) (SEE DISTRICT TC-13 FOR SPACING)
- ⑭ LINE 12", SOLID, WHITE - CONTINENTAL CROSSWALK (TYP)
- ⑮ PREFORMED PLASTIC PAVEMENT MARKING, TYPE B - LINE 7" (4" WHITE OVER 7" BLACK) ON GROOVING FOR RECESSED PAVEMENT MARKING 8"

**LEGEND**

HMA SURFACE REMOVAL BUTT JOINT, 4.5'

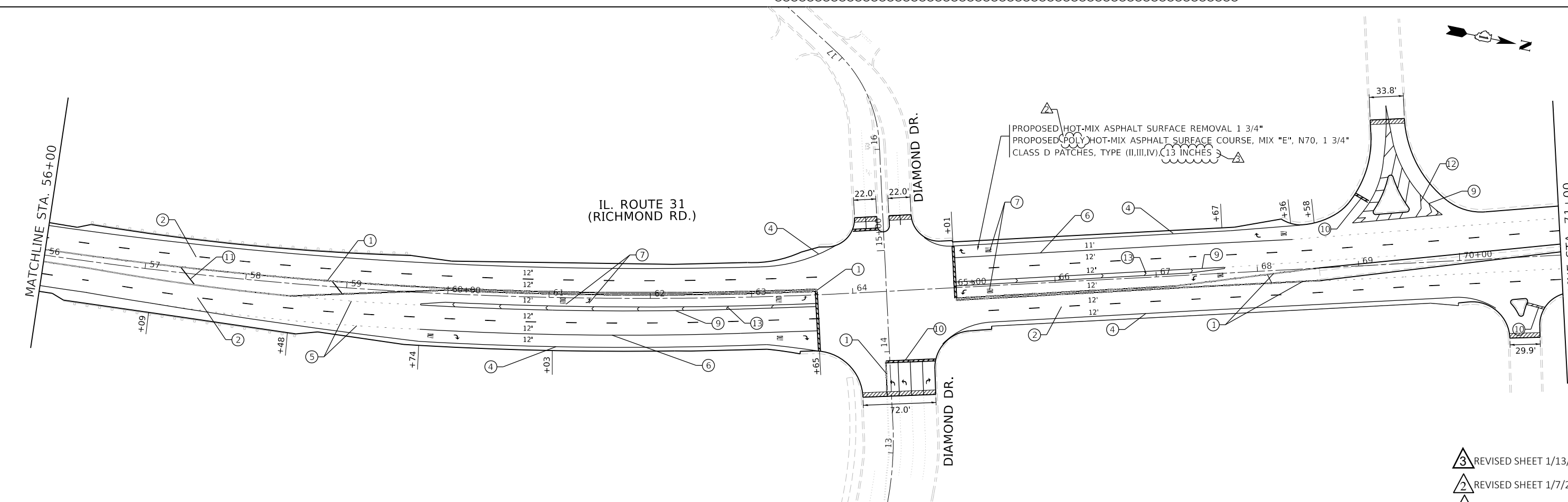

- ③ REVISED SHEET 1/13/2022
- ② REVISED SHEET 1/7/2022
- ① REVISED SHEET 1/3/2022

MODEL: Default  
 FILE NAME: P:\2020\2020-09-04-00 IDOT Various Phase 2 (PTB) 106 Item 16\Work Order 15\DC\GADD\_Sheets\162\NS5-SHT-PLN-02.dwg  
 P 312.425.9588 | F 312.425.9584 | www.infrastructure-eng.com

<b>INFRASTRUCTURE ENGINEERING INCORPORATED</b> 1 South Wacker   Suite 2650   Chicago, IL 60606 P 312.425.9588   F 312.425.9584   www.infrastructure-eng.com	USER NAME = ALane	DESIGNED - IMU	REVISED -  ACL 12/17/2021
	PLOT SCALE = 100.0000' / in.	DRAWN - IMU	REVISED -  ACL 1/6/2022
		CHECKED - ACL	REVISED -  ACL 1/12/2022
		DATE - 08/13/2021	

**STATE OF ILLINOIS  
 DEPARTMENT OF TRANSPORTATION**

**ROADWAY AND PAVEMENT MARKING PLANS  
 IL-31 (MCCULLOM LAKE RD TO JOHNSBURG RD)**

SCALE: 1" = 50'

STA. TO STA.

F.A.P. RTE.	SECTION	COUNTY	TOTAL SHEETS	SHEET NO.
336	2021-024-R5	MCHENRY	28	10
			CONTRACT NO. 62N56	
		ILLINOIS FED. AID PROJECT		

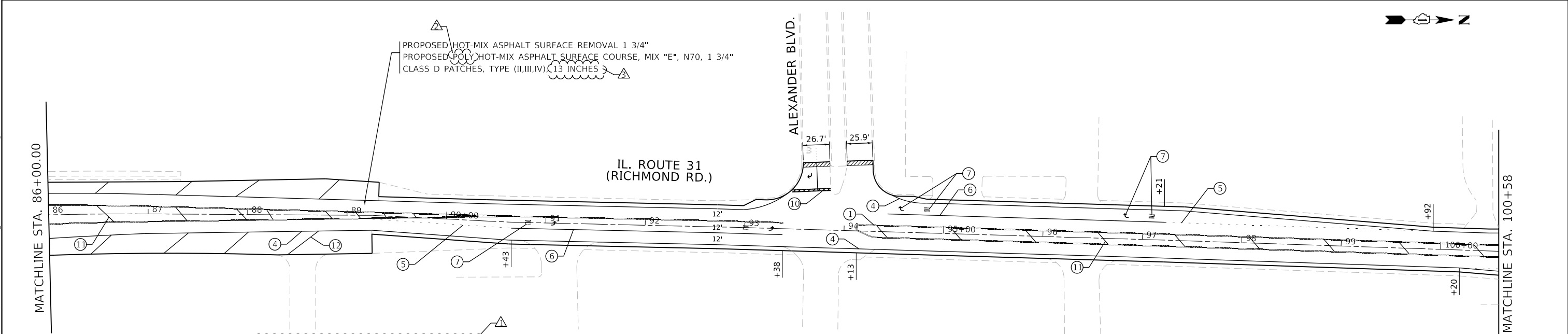
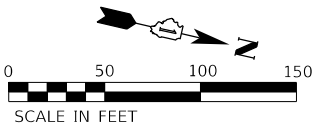
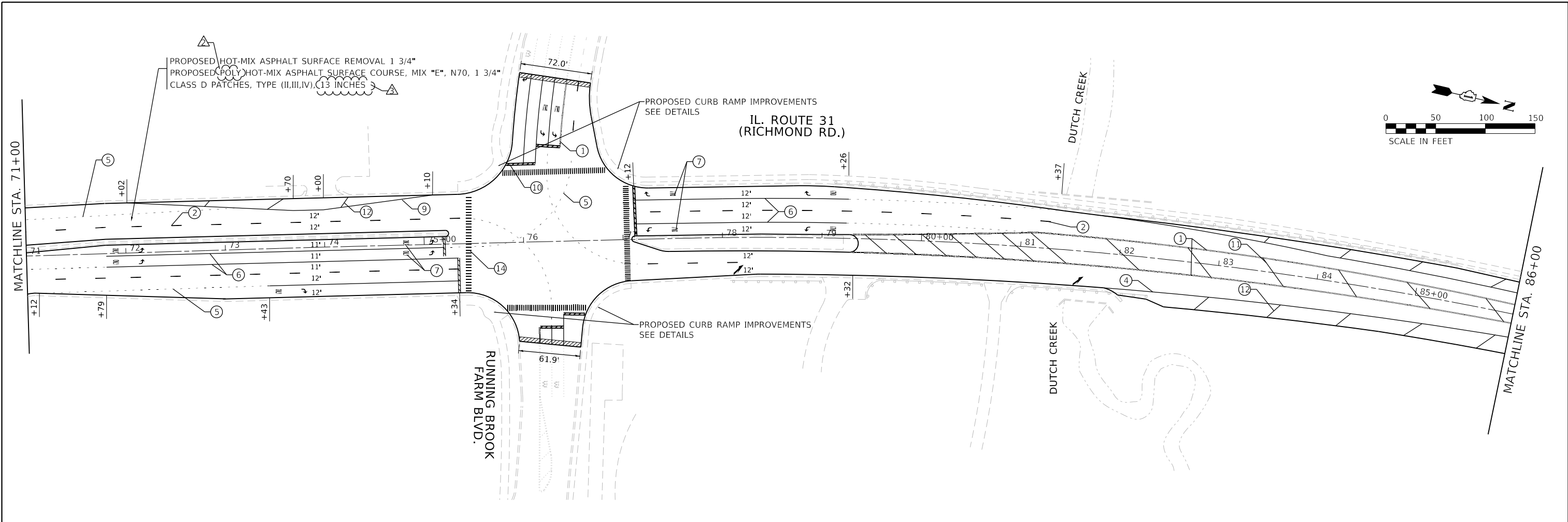

**PAVEMENT MARKING LEGEND**

- ① LINE 2 @ 4" SOLID YELLOW, 11" C-C - CENTERLINE (TYP)
- ② LINE 4", SKIP-DASH, WHITE (10' LINE - 30' SPACE) - LANE LINES
- ③ LINE 4", SOLID, YELLOW - EDGE LINE (TYP)
- ④ LINE 4", SOLID WHITE - EDGE LINE (TYP)
- ⑤ LINE 6", SKIP-DASH, WHITE (2' LINE - 6' SPACE) - DOTTED LINES (TYP)
- ⑥ LINE 6", SOLID WHITE - TURN LANE MARKING (TYP)
- ⑦ LETTERS & SYMBOLS, 8", SOLID, WHITE - TURN LANE MARKINGS (TYP)
- ⑧ LINE 2 @ 6", SOLID, WHITE - CROSSWALK LINES (PEDESTRIAN) (TYP)
- ⑨ LINE 8", SOLID, WHITE - GORE MARKING AND CHANNELIZING LINES (TYP)
- ⑩ LINE 24", SOLID, WHITE - STOP LINES (TYP)

NOTE: THERMOPLASTIC USED ON ASPHALT.  
MODIFIED URETHANE USED ON CONCRETE.

- ⑪ LINE 12", SOLID, YELLOW - PAINTED MEDIANS DIAGONALS (TYP) (SEE DISTRICT DETAIL TC-13 FOR SPACING)
- ⑫ LINE 12", SOLID, WHITE - SHOULDER DIAGONALS @ 45° (TYP) (SEE DISTRICT TC-13 FOR SPACING)
- ⑬ LINE 12", SOLID, WHITE - CHANNELIZATION LINES 45° (TYP) (SEE DISTRICT TC-13 FOR SPACING)
- ⑭ LINE 12", SOLID, WHITE - CONTINENTAL CROSSWALK (TYP)
- ⑮ PREFORMED PLASTIC PAVEMENT MARKING, TYPE B - LINE 7" (4" WHITE OVER 7" BLACK) ON GROOVING FOR RECESSED PAVEMENT MARKING 8"

**LEGEND**

HMA SURFACE REMOVAL BUTT JOINT, 4.5'

- ③ REVISED SHEET 1/13/2022
- ② REVISED SHEET 1/7/2022
- ① REVISED SHEET 1/3/2022

MODEL: D:\p\inf\... FILE NAME: P:\2020\2020-09-04-00\_IDOT\_Various Phase 2 (FTEL 106 Item 16)Work Order 1510261CADD\_Sheets\162156-SHT-PLAN-03.dgn



USER NAME = ALane	DESIGNED - IMU	REVISED -  ACL 12/17/2021
PLOT SCALE = 100.0000' / in.	DRAWN - IMU	REVISED -  ACL 1/6/2022
	CHECKED - ACL	REVISED -  ACL 1/12/2022
	DATE - 08/13/2021	

**STATE OF ILLINOIS  
DEPARTMENT OF TRANSPORTATION**

<b>ROADWAY AND PAVEMENT MARKING PLANS</b>	
<b>IL-31 (MCCULLOM LAKE RD TO JOHNSBURG RD)</b>	
SCALE: 1" = 50'	STA. TO STA.

F.A.P. RTE. 336	SECTION 2021-024-R5	COUNTY MCHENRY	TOTAL SHEETS 28	SHEET NO. 11
CONTRACT NO. 62N56				
ILLINOIS FED. AID PROJECT				

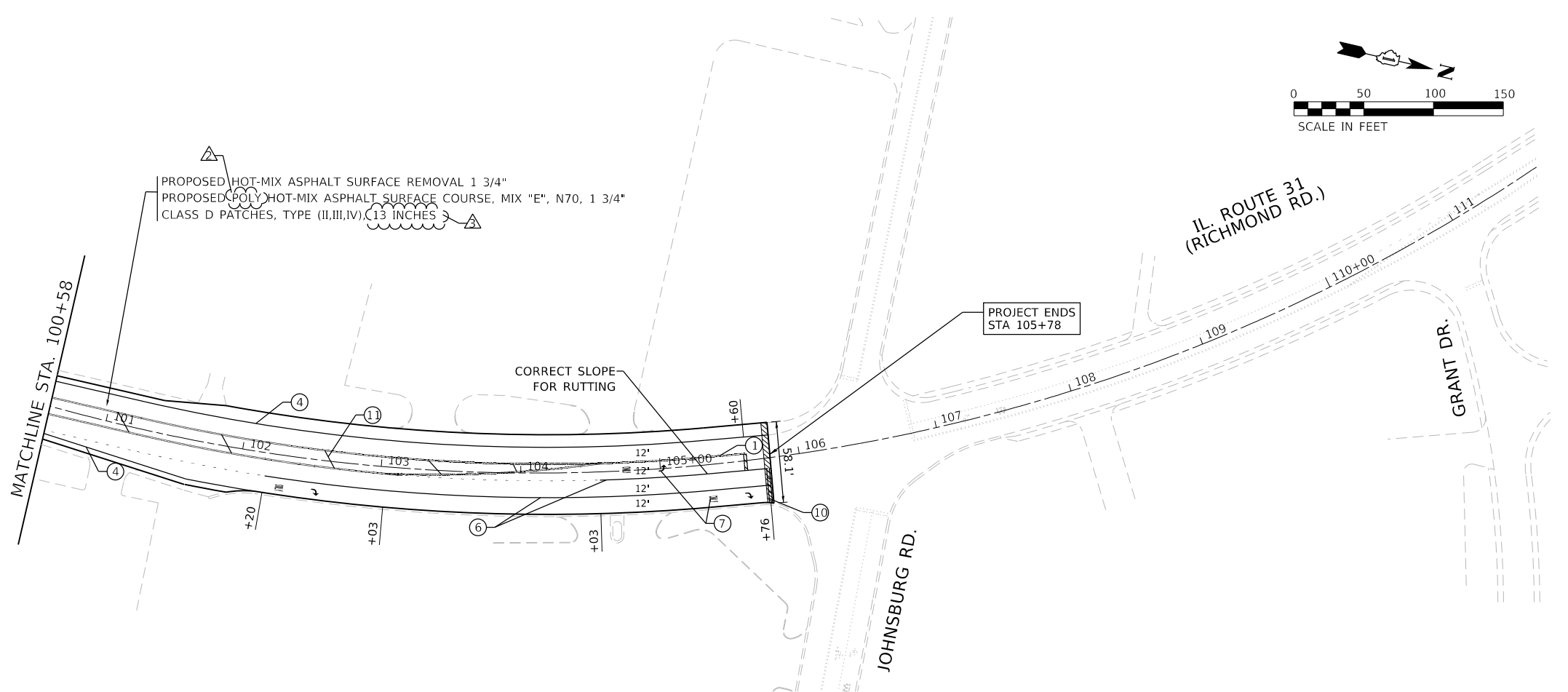

**PAVEMENT MARKING LEGEND**

- ① LINE 2 @ 4" SOLID YELLOW, 11" C-C - CENTERLINE (TYP)
- ② LINE 4", SKIP-DASH, WHITE (10' LINE - 30' SPACE) - LANE LINES
- ③ LINE 4", SOLID, YELLOW - EDGE LINE (TYP)
- ④ LINE 4", SOLID WHITE - EDGE LINE (TYP)
- ⑤ LINE 6", SKIP-DASH, WHITE (2' LINE - 6' SPACE) - DOTTED LINES (TYP)
- ⑥ LINE 6", SOLID WHITE - TURN LANE MARKING (TYP)
- ⑦ LETTERS & SYMBOLS, 8", SOLID, WHITE - TURN LANE MARKINGS (TYP)
- ⑧ LINE 2 @ 6", SOLID, WHITE - CROSSWALK LINES (PEDESTRIAN) (TYP)
- ⑨ LINE 8", SOLID, WHITE - GORE MARKING AND CHANNELIZING LINES (TYP)
- ⑩ LINE 24", SOLID, WHITE - STOP LINES (TYP)

NOTE: THERMOPLASTIC USED ON ASPHALT.  
MODIFIED URETHANE USED ON CONCRETE.

**LEGEND**

- ⑪ LINE 12", SOLID, YELLOW - PAINTED MEDIANS DIAGONALS (TYP) (SEE DISTRICT DETAIL TC-13 FOR SPACING)
- ⑫ LINE 12", SOLID, WHITE - SHOULDER DIAGONALS @ 45° (TYP) (SEE DISTRICT TC-13 FOR SPACING)
- ⑬ LINE 12", SOLID, WHITE - CHANNELIZATION LINES 45° (TYP) (SEE DISTRICT TC-13 FOR SPACING)
- ⑭ LINE 12", SOLID, WHITE - CONTINENTAL CROSSWALK (TYP)
- ⑮ PREFORMED PLASTIC PAVEMENT MARKING, TYPE B - LINE 7" (4" WHITE OVER 7" BLACK) ON GROOVING FOR RECESSED PAVEMENT MARKING 8"
- HMA SURFACE REMOVAL BUTT JOINT, 4.5'

- ③ REVISED SHEET 1/13/2022
- ② REVISED SHEET 1/7/2022
- ① REVISED SHEET 1/3/2022

MODEL: D:\dms\it... FILE NAME: P:\2020\4094-00 IDOT Variois Phase 2 (PFB) 106 Item 16\Work Order 15\IDG\CADD\_Sheets\162N56-SHT-PLU-04.dgn

<b>INFRASTRUCTURE ENGINEERING INCORPORATED</b> 1 South Wacker   Suite 2650   Chicago, IL 60606 P 312.425.9588   F 312.425.9584   www.infrastructure-eng.com	USER NAME = ALane	DESIGNED - IMU	REVISED -  ACL 12/17/2021
	PLOT SCALE = 100,0000' / in.	DRAWN - IMU	REVISED -  ACL 1/6/2022
		CHECKED - ACL	REVISED -  ACL 1/12/2022
		DATE - 08/13/2021	

**STATE OF ILLINOIS  
DEPARTMENT OF TRANSPORTATION**

<b>ROADWAY AND PAVEMENT MARKING PLANS</b>	
<b>IL-31 (MCCULLOM LAKE RD TO JOHNSBURG RD)</b>	
SCALE: 1" = 50'	STA. TO STA.

F.A.P. RTE.	SECTION	COUNTY	TOTAL SHEETS	SHEET NO.
336	2021-024-R5	MCHENRY	28	12
CONTRACT NO. 62N56				
ILLINOIS		FED. AID PROJECT		