

STATE OF ILLINOIS
DEPARTMENT OF TRANSPORTATION

F.A.U. RTE.	SECTION	COUNTY	TOTAL SHEETS	SHEET NO.
1372	2021-012-RS&SW	COOK	21	1
		ILLINOIS	CONTRACT NO. 62N71	

FOR INDEX OF SHEETS, SEE SHEET NO. 2

THIS PROJECT IS LOCATED IN THE CITY OF CHICAGO

TRAFFIC DATA

ADDISON STREET
ADT 2018 = 9050
SPEED LIMIT = 30 MPH

PROPOSED HIGHWAY PLANS
F.A.U. ROUTE 1372: ADDISON STREET
FROM HALSTED STREET TO US 41 (LAKE SHORE DRIVE)
SECTION: 2021-012-RS&SW
PROJECT: STP-ELPX(942)
DESIGNED OVERLAY & ADA IMPROVEMENTS
COOK COUNTY

C-91-144-21
R 14 E

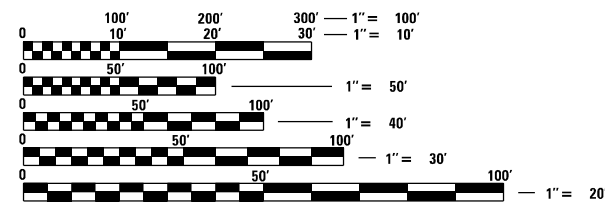

FULL SIZE PLANS HAVE BEEN PREPARED USING STANDARD ENGINEERING SCALES. REDUCED SIZED PLANS WILL NOT CONFORM TO STANDARD SCALES. IN MAKING MEASUREMENTS ON REDUCED PLANS, THE ABOVE SCALES MAY BE USED.

C.U.A.N.
CHICAGO UTILITY ALERT NETWORK
(312) 744-7000

PROJECT ENGINEER: RODRIGO LEDEZMA (847) 705-4580
PROJECT MANAGER: JEAN ALAIN MIDY (847) 221-3056

CONTRACT NO. 62N71

PROJECT BEGINS
STA 17 + 34

OVERLAY OMISSION
STARTS STA 22 + 44

OVERLAY OMISSION
ENDS STA 23 + 47

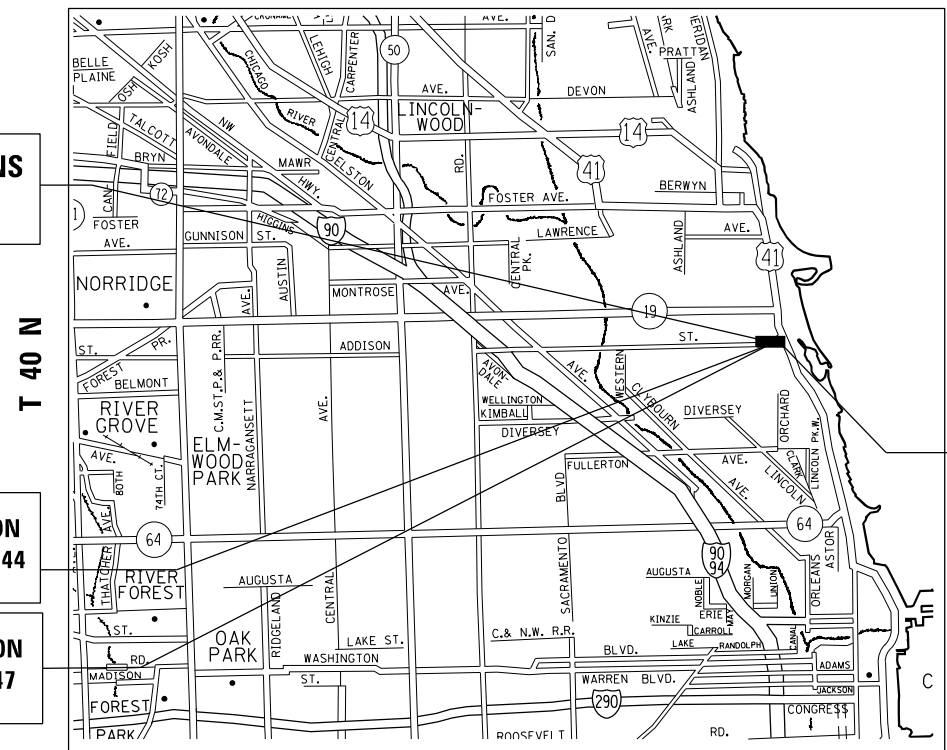

CITY OF CHICAGO

GROSS LENGTH = 1672 FT. = 0.32 MILE
NET LENGTH = 1569 FT. = 0.30 MILE

PROJECT ENDS
STA 34 + 06

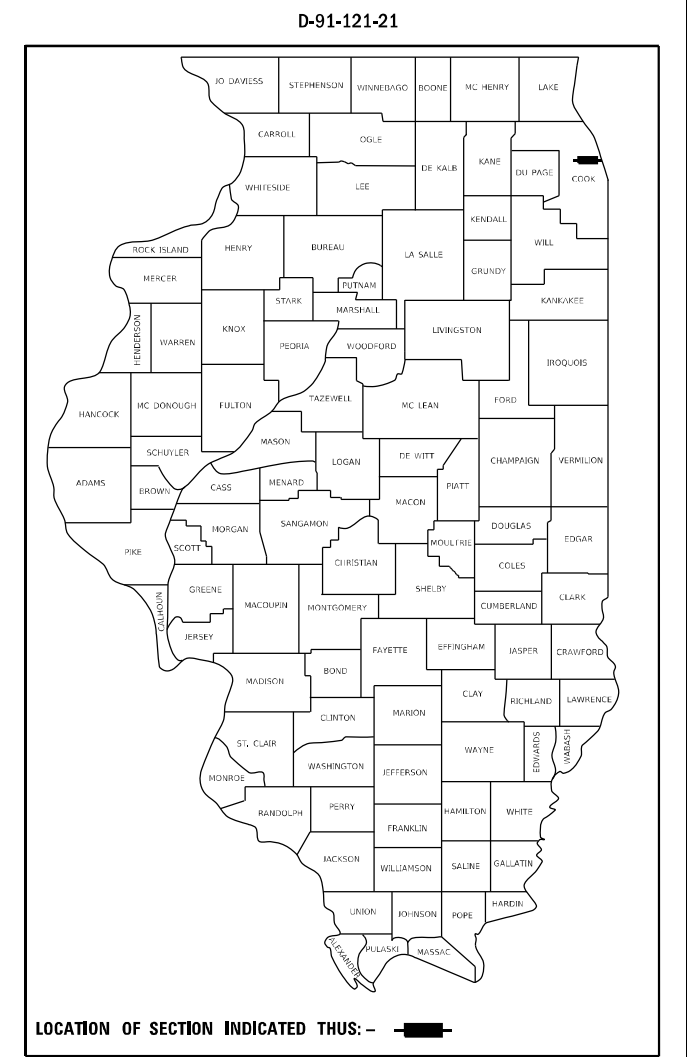

LOCATION OF SECTION INDICATED THIS: - [black rectangle] -

STATE OF ILLINOIS
DEPARTMENT OF TRANSPORTATION
SUBMITTED OCTOBER 20 21
Jose Pios / CBS
December 10, 2021
[Signature]
ENGINEER OF DESIGN AND ENVIRONMENT
December 10, 2021
[Signature]
DIRECTOR OF HIGHWAYS PROJECT IMPLEMENTATION

PRINTED BY THE AUTHORITY
OF THE STATE OF ILLINOIS

INDEX OF SHEETS

- 1 COVER SHEET
- 2 INDEX OF SHEETS, STATE STANDARDS & GENERAL NOTES
- 3 - 5 SUMMARY OF QUANTITIES
- 6-7 EXISTING AND PROPOSED TYPICAL SECTIONS
- 8 ROADWAY PLAN
- 9 DRIVEWAY DETAILS DISTANCE BETWEEN ROW AND FACE OF CURB < 15' (4.5 M) (BD-02)
- 10 PAVEMENT PATCHING FOR HMA SURFACED PAVEMENT (BD-22)
- 11 CURB OR CURB AND GUTTER REMOVAL AND REPLACEMENT (BD-24)
- 12 BUTT JOINT AND HMA TAPER DETAILS (BD-32)
- 13 CITY OF CHICAGO MANHOLE LIDS AND FRAMES (BD-47)
- 14 CITY OF CHICAGO DETECTABLE WARNINGS (BD-58)
- 15 TRAFFIC CONTROL AND PROTECTION FOR SIDE ROADS, INTERSECTIONS, AND DRIVEWAYS (TC-10)
- 16 TRAFFIC CONTROL AND PROTECTION AT TURN BAYS (TO REMAIN OPEN TO TRAFFIC) (TC-14)
- 17 ARTERIAL ROAD INFORMATION SIGN (TC-22)
- 18 - 20 CITY OF CHICAGO TYPICAL PAVEMENT MARKINGS (TC-24)
- 21 PROJECT DETAIL FOR SINGLE PERPENDICULAR CURB RAMPS (PD-01)

STATE STANDARDS

STANDARD NO.	DESCRIPTION
000001-08	STANDARD SYMBOLS, ABBREVIATIONS AND PATTERNS
424001-11	PREPENDICULAR CURB RAMPS FOR SIDEWALKS
424006-05	DIAGONAL CURB RAMPS FOR SIDEWALKS
424011-04	CORNER PARALLEL CURB RAMPS FOR SIDEWALKS
424016-05	MID-BLOCK CURB RAMPS FOR SIDEWALKS
424021-06	DEPRESSED CORNER FOR SIDEWALKS
424026-03	ENTRANCE / ALLEY PEDESTRIAN CROSSINGS
442201-03	CLASS C AND D PATCHES
604001-05	FRAME AND LIDS, TYPE 1
606001-08	CONCRETE CURB TYPE B AND COMBINATION CONCRETE CURB AND GUTTER
701006-05	OFF-ROAD OPERATIONS, 2L, 2W, 15' (4.5 M) TO 24'' (600 MM) FROM PAVEMENT EDGE
701011-04	OFF-ROAD MOVING OPERATIONS, 2L, 2W, DAY ONLY
701101-05	OFF-ROAD OPERATIONS, MULTILANE, 15' (4.5 M) TO 24'' (600 MM) FROM PAVEMENT EDGE
701301-04	LANE CLOSURE, 2L, 2W, SHORT TIME OPERATIONS
701311-03	LANE CLOSURE, 2L, 2W, MOVING OPERATIONS DAY ONLY
701427-05	LANE CLOSURE, MULTILANE, INTERMITTEN OR MOVING OPERATION, FOR SPEEDS <40 MPH
701501-06	URBAN LANE CLOSURE, 2L, 2W, UNDIVIDED
701502-09	URBAN LANE CLOSURE, 2L, 2W, WITH BIDIRECTIONAL LEFT TURN LANE
701606-10	URBAN SINGLE LANE CLOSURE, MULTILANE, 2W, WITH MOUNTABLE MEDIAN
701701-10	URBAN LANE CLOSURE, MULTILANE INTERSECTION
701801-06	SIDEWALK, CORNER OR CROSSWALK CLOSURE
701901-08	TRAFFIC CONTROL DEVICES

GENERAL NOTES

- 1 THE CONTRACTOR SHALL COORDINATE CONSTRUCTION ACTIVITIES WITH UTILITY COMPANIES, AND THE CITY OF CHICAGO.
- 2 BEFORE STARTING ANY EXCAVATION, THE CONTRACTOR SHALL CALL "C.U.A.N." (CHICAGO UTILITY ALERT NETWORK) AT (312)744-7000 FOR FIELD LOCATIONS OF BURIED ELECTRIC, TELEPHONE AND GAS UTILITIES. (48 HOUR NOTIFICATION IS REQUIRED).
- 3 THE CONTRACTOR WILL NOT BE ABLE TO SET UP A YARD OR FIELD OFFICE ON STATE PROPERTY WITHOUT THE WRITTEN PERMISSION OF THE DEPARTMENT.
- 4 BEFORE BEGINNING ANY WORK, THE CONTRACTOR SHALL RETAIN AND RECORD FOR FUTURE REFERENCE, ALL EXISTING PAVEMENT MARKING LINES (AND RAISED REFLECTIVE PAVEMENT MARKERS) IN ORDER THAT THESE LOCATIONS CAN BE RE-ESTABLISHED FOR STRIPING. EXACT LOCATIONS OF ALL PAVEMENT MARKINGS SHALL BE AS SHOWN ON THE PLANS OR AS DIRECTED BY THE ENGINEER.
- 5 IT SHALL BE THE CONTRACTOR'S RESPONSIBILITY TO VERIFY ALL DIMENSIONS AND CONDITIONS EXISTING IN THE FIELD PRIOR TO CONSTRUCTION AND ORDERING OF MATERIALS.
- 6 FRAMES AND GRATES ADJUSTMENT OF PRIVATE UTILITIES WITHIN THE LIMITS OF THE IMPROVEMENTS SHALL BE DONE BY THEIR RESPECTIVE OWNERS AND ARE NOT PART OF THIS CONTRACT.
- 7 THE CONTRACTOR SHALL CONTACT THE IDOT ARTERIAL DISTRICT ONE TRAFFIC CONTROL SUPERVISOR KALPANA KANNAN-HOSADURGA AT KALPANA.KANNAN-HOSADURGA@ILLINOIS.GOV A MINIMUM OF 72 HOURS IN ADVANCE OF BEGINNING WORK.
- 8 THE RESIDENT ENGINEER SHALL CONTACT MR. EMAD ALHUSSEINI, AREA TRAFFIC FIELD ENGINEER, AT EMAD.ALHUSSEINI@ILLINOIS.GOV A MINIMUM OF TWO (2) WEEKS PRIOR TO THE PLACEMENT OF PERMANENT PAVEMENT MARKINGS.
- 9 DO NOT SCALE PLANS FOR CONSTRUCTION DIMENSIONS.
- 10 WHEN THE MILLED PAVEMENT IS OPEN TO TRAFFIC THE MAXIMUM GRADE DIFFERENTIAL BETWEEN PASSES OF THE MILLING MACHINE SHALL NOT EXCEED 1/2 INCHES WHERE THE SPEED LIMIT IS 40 MPH OR LESS AND 1 INCH WHERE THE SPEED LIMIT IS GREATER THAN 40 MPH. WITH WRITTEN APPROVAL OF THE ENGINEER, A MAXIMUM GRADE DIFFERENTIAL OF 3 INCHES MAY BE ALLOWED IF THE EDGE OF THE MILLING IS SLOPED A MINIMUM 1:3 (V:H) OR A NOTCHED LONGITUDINAL WEDGE IS USED.
- 11 ALL PAVEMENT PATCHING LOCATIONS WILL BE DETERMINED IN THE FIELD BY THE ENGINEER.
- 12 BUTT JOINTS WILL BE INSTALLED AT THE ENDS OF ALL RESURFACING (WHERE RESURFACING MEETS EXISTING PAVEMENT) ACCORDING TO THE "BUTT JOINT AND HOT-MIX ASPHALT TAPER DETAILS" SHEET INCLUDED IN THE PLANS, UNLESS OTHERWISE SPECIFIED.
- 13 OVERNIGHT LANE CLOSURES SHALL NOT BE ALLOWED FOR REHABILITATION PROJECTS INVOLVING DAYTIME MILLING AND RESURFACING OPERATIONS AND CLASS D PATCHING UNLESS OTHER CONDITIONS WARRANT EXTENDED LANE CLOSURES AS DETERMINED AND APPROVED IN WRITING BY THE ENGINEER OR AS PROVIDED FOR IN THE CONTRACT SPECIFICATIONS.
- 14 THE CONTRACTOR SHALL BE REQUIRED TO PROVIDE ACCESS TO ABUTTING PROPERTY AT ALL TIMES DURING THE CONSTRUCTION OF THIS PROJECT.
- 15 EXISTING BROKEN FRAMES AND LIDS SHALL BE REMOVED AND DISPOSED OF BY THE CONTRACTOR AND SHALL BE REPLACED AS DIRECTED BY THE ENGINEER. REPLACEMENT FRAMES AND LIDS WILL BE PAID FOR ACCORDING TO ARTICLE 109.04 OF THE STANDARD SPECIFICATIONS UNLESS A SEPARATE PAY ITEM HAS BEEN PROVIDED.
- 16 ALL COMBINATION CONCRETE CURB AND GUTTER REMOVAL AND REPLACEMENT LOCATIONS WILL BE DETERMINED IN THE FIELD BY THE ENGINEER.
- 17 OPEN LID DRAINAGE STRUCTURES SHALL NOT BE CLOSED, COVERED OR OTHERWISE OBSTRUCTED DURING CONSTRUCTION OF THIS ROADWAY WITHOUT THE WRITTEN PERMISSION FROM THE CITY OF CHICAGO.
- 18 PAVEMENT MARKING TAPE, TYPE III SHALL BE USED FOR SHORT TERM PAVEMENT MARKINGS ON ALL FINAL SURFACES.
- 19 ALL EXCAVATED AREA REQUIRED FOR CLASS D PATCHING SHALL BE BACKFILLED FLUSH TO THE EXISTING PAVEMENT WITHIN 24 HOURS.
- 20 THE CONTRACTOR SHALL MAINTAIN PEDESTRIAN ACCESS AT ALL TIMES DURING CONSTRUCTION.
- 21 TEN (10) FOOT TRANSITIONS SHALL BE USED TO MATCH PROPOSED CURB AND GUTTER AND MEDIAN ITEM OF WORK TO EXISTING CURB AND GUTTER AND MEDIAN IN THE FEILD, UNLESS OTHERWISE SHOWN. THE TRANSITIONS SHALL BE PAID FOR AT THE CONTRACT UNIT PRICE FOR THE PROPOSED ITEMS OF WORK SPECIFIED.
- 22 THE CONTRACTOR WILL BE REQUIRED TO KEEP A RECORD OF THE LOCATIONS OF THE BURIED OR PLATED STRUCTURES ACCORDING TO THE STATION AND OFFSET LEFT OR RIGHT OF THE CENTERLINE OF PAVEMENT. UPON COMPLETION OF THE WORK, THE CONTRACTOR WILL DELIVER THE RECORD TO THE ENGINEER.
- 23 THE CONTRACTOR SHALL CONTACT CTA MINIMUM OF TWO (2) WEEKS PRIOR TO ANY BUS SERVICE IMPACTS. CTA POINT OF CONTACT IS TRAFFIC.PLANNING@TRANSITCHICAGO.COM.
- 24 THE CONTRACTOR SHALL ADHERE TO OWNER SAFETY REQUIREMENTS 01 35 23 CTA SPECIFICATION.

MODEL: Default
 FILE NAME: p:\projects\paw\bea\by.com\PI\IDOT\Documents\IDOT Office\District 1\Projects\112121\CADD\data\Design\112121-Sub\agencere.dgn

USER NAME = shahida	DESIGNED -	REVISED -	STATE OF ILLINOIS DEPARTMENT OF TRANSPORTATION	INDEX OF SHEETS, STATE STANDARDS & GENERAL NOTES ADDISON ST (HALSTED ST TO US 41)	F.A.U. RTE.	SECTION	COUNTY	TOTAL SHEETS	SHEET NO.
PLOT SCALE = 100,0000' / in.	DRAWN -	REVISED -			1372	2021-012-R5&SW	COOK	21	2
PLOT DATE = 11/1/2021	CHECKED -	REVISED -			CONTRACT NO. 62N71				
	DATE -	REVISED -			SCALE:		SHEET OF SHEETS		STA. TO STA.
					ILLINOIS FED. AID PROJECT				

SUMMARY OF QUANTITIES			URBAN TOTAL QUANTITIES	CONSTRUCTION TYPE CODE				
CODE NO	ITEM	UNIT		0005 80% FED 20% ST	0005 STATE 100%			
20200100	EARTH EXCAVATION	CU YD	15	15				
40600290	BITUMINOUS MATERIALS (TACK COAT)	POUND	5650	5650				
40600370	LONGITUDINAL JOINT SEALANT	FOOT	3700	3700				
40600400	MIXTURE FOR CRACKS, JOINTS, AND FLANGEWAYS	TON	13	13				
40600982	HOT-MIX ASPHALT SURFACE REMOVAL - BUTT JOINT	SO YD	145	145				
40601005	HOT-MIX ASPHALT REPLACEMENT OVER PATCHES	TON	340	340				
40602985	HOT-MIX ASPHALT BINDER COURSE, IL-9.5, N70	TON	931	931				
40604062	HOT-MIX ASPHALT SURFACE COURSE, IL-9.5, MIX "D", N70	TON	815	815				
42001300	PROTECTIVE COAT	SO YD	820	820				
42300400	PORTLAND CEMENT CONCRETE DRIVEWAY PAVEMENT, 8 INCH	SO YD	40	40				
42400410	PORTLAND CEMENT CONCRETE SIDEWALK 8 INCH	SO FT	3150	3150				
44000164	HOT-MIX ASPHALT SURFACE REMOVAL, 3 3/4"	SO YD	8310	8310				

SUMMARY OF QUANTITIES			URBAN TOTAL QUANTITIES	CONSTRUCTION TYPE CODE				
CODE NO	ITEM	UNIT		0005 80% FED 20% ST	0005 STATE 100%			
44000200	DRIVEWAY PAVEMENT REMOVAL	SO YD	40	40				
44000600	SIDEWALK REMOVAL	SO FT	3150	3150				
44002219	HOT-MIX ASPHALT REMOVAL OVER PATCHES, 4 3/4"	SO YD	1260	1260				
44201737	CLASS D PATCHES, TYPE I, 8 INCH	SO YD	15	15				
44201741	CLASS D PATCHES, TYPE II, 8 INCH	SO YD	450	450				
44201745	CLASS D PATCHES, TYPE III, 8 INCH	SO YD	228	228				
44201747	CLASS D PATCHES, TYPE IV, 8 INCH	SO YD	452	452				
60250200	CATCH BASINS TO BE ADJUSTED	EACH	15	15				
60252800	CATCH BASINS TO BE RECONSTRUCTED	EACH	7	7				
60255500	MANHOLES TO BE ADJUSTED	EACH	5	5				
60260100	INLETS TO BE ADJUSTED	EACH	10	10				
60262700	INLETS TO BE RECONSTRUCTED	EACH	3	3				
60300305	FRAMES AND LIDS TO BE ADJUSTED	EACH	16	16				
60406000	FRAMES AND LIDS, TYPE 1, OPEN LID	EACH	15	15				

FILE NAME =	USER NAME = shaha	DESIGNED -	REVISED -	STATE OF ILLINOIS DEPARTMENT OF TRANSPORTATION	ADDISON STREET (HALSTED ST TO US 41) SUMMARY OF QUANTITIES	F.A.U. RTE.	SECTION	COUNTY	TOTAL SHEETS	SHEET NO.
pw\N\dot-pw\benrey.com\PI\DOT Documents\DOT Office\Dist\12\Projects\DI\2\2\NCAD\Design\DI\2\2\sh-500	DRAWN -	REVISED -	1372			2021-012-RS&SW	COOK	21	3	
PLOT SCALE = 100,0000' / 1in	CHECKED -	REVISED -	CONTRACT NO. 62N71							
PLOT DATE = 10/21/2021	DATE -	REVISED -	FED. ROAD DIST. NO. 1 ILLINOIS FED. AID PROJECT							

* SPECIALTY ITEM

SUMMARY OF QUANTITIES			URBAN TOTAL QUANTITIES	CONSTRUCTION TYPE CODE				
CODE NO	ITEM	UNIT		0005 80% FED 20% ST	0005 STATE 100%			
60406530	FRAMES AND LIDS, CLOSED LID (CITY OF CHICAGO)	EACH	28	28				
* 66900200	NON-SPECIAL WASTE DISPOSAL	CU YD	15	15				
* 66900530	SOIL DISPOSAL ANALYSIS	EACH	5	5				
* 66901001	REGULATED SUBSTANCES PRE-CONSTRUCTION PLAN	LSUM	1	1				
* 66901003	REGULATED SUBSTANCES FINAL CONSTRUCTION REPORT	LSUM	1	1				
* 66901006	REGULATED SUBSTANCES MONITORING	CAL DA	10	10				
67000400	ENGINEER'S FIELD OFFICE, TYPE A	CAL MO	6	6				
67100100	MOBILIZATION	L SUM	1	1				
70102620	TRAFFIC CONTROL AND PROTECTION, STANDARD 701501	L SUM	1	1				
70102622	TRAFFIC CONTROL AND PROTECTION, STANDARD 701502	L SUM	1	1				
70102625	TRAFFIC CONTROL AND PROTECTION, STANDARD 701606	L SUM	1	1				
70102635	TRAFFIC CONTROL AND PROTECTION, STANDARD 701701	L SUM	1	1				

SUMMARY OF QUANTITIES			URBAN TOTAL QUANTITIES	CONSTRUCTION TYPE CODE				
CODE NO	ITEM	UNIT		0005 80% FED 20% ST	0005 STATE 100%			
70102640	TRAFFIC CONTROL AND PROTECTION, STANDARD 701801	L SUM	1	1				
70300100	SHORT TERM PAVEMENT MARKING	FOOT	5600	5600				
70300150	SHORT TERM PAVEMENT MARKING REMOVAL	SO FT	3265	3265				
70300211	TEMPORARY PAVEMENT MARKING LETTERS AND SYMBOLS - PAINT	SO FT	5	5				
70300221	TEMPORARY PAVEMENT MARKING - LINE 4" - PAINT	FOOT	4850	4850				
70300241	TEMPORARY PAVEMENT MARKING - LINE 6" - PAINT	FOOT	50	50				
70300261	TEMPORARY PAVEMENT MARKING - LINE 12" - PAINT	FOOT	390	390				
70300281	TEMPORARY PAVEMENT MARKING - LINE 24" - PAINT	FOOT	200	200				
70306120	TEMPORARY PAVEMENT MARKING - LINE 4" - TYPE III TAPE	FOOT	1500	1500				
* 72400100	REMOVE SIGN PANEL ASSEMBLY - TYPE A	EACH	2	2				
* 72400500	RELOCATE SIGN PANEL ASSEMBLY - TYPE A	EACH	2	2				
* 78000100	THERMOPLASTIC PAVEMENT MARKING - LETTERS AND SYMBOLS	SO FT	75	75				

FILE NAME =	USER NAME = shahda	DESIGNED -	REVISOR -	STATE OF ILLINOIS DEPARTMENT OF TRANSPORTATION	ADDISON STREET (HALSTED ST TO US 41) SUMMARY OF QUANTITIES	F.A.U. RTE.	SECTION	COUNTY	TOTAL SHEETS	SHEET NO.
pw\N1dot-pw\benfey.com\PW\DOT\Documents\DOT - Off\1015\Dist-101\N\Projects\DI\212\NCAD\Design\DI\212-sh-500.dwg	DRAWN -	REVISOR -	1372			2021-012-RS&SW	COOK	21	4	
PLOT SCALE = 100,0000' / 1in.	CHECKED -	REVISOR -	CONTRACT NO. 62N71							
PLOT DATE = 10/21/2021	DATE -	REVISOR -	FED. ROAD DIST. NO. 1 (ILLINOIS) FED. AID PROJECT							

* SPECIALTY ITEM

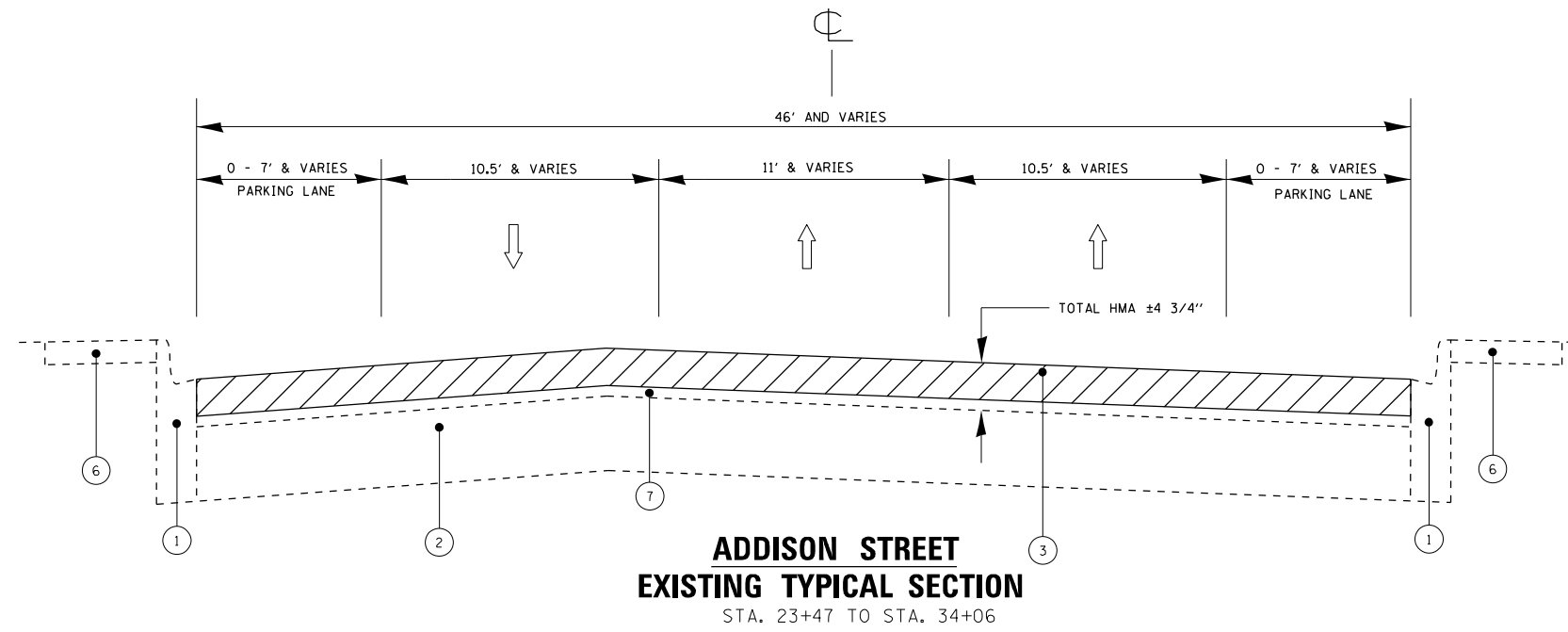

- LEGEND**
- ① EXISTING COMBINATION CONCRETE CURB AND GUTTER
 - ② EXISTING PCC PAVEMENT, ± 8"
 - ③ PROPOSED HMA SURFACE REMOVAL, 3 3/4"
 - ④ PROPOSED HMA BINDER COURSE IL-9.5, N70, 2"
 - ⑤ PROPOSED HMA SURFACE COURSE IL-9.5, MIX "D", N70, 1 3/4"
 - ⑥ EXISTING SIDEWALK
 - ⑦ EXISTING HMA PAVEMENT TO REMAIN, ± 1"

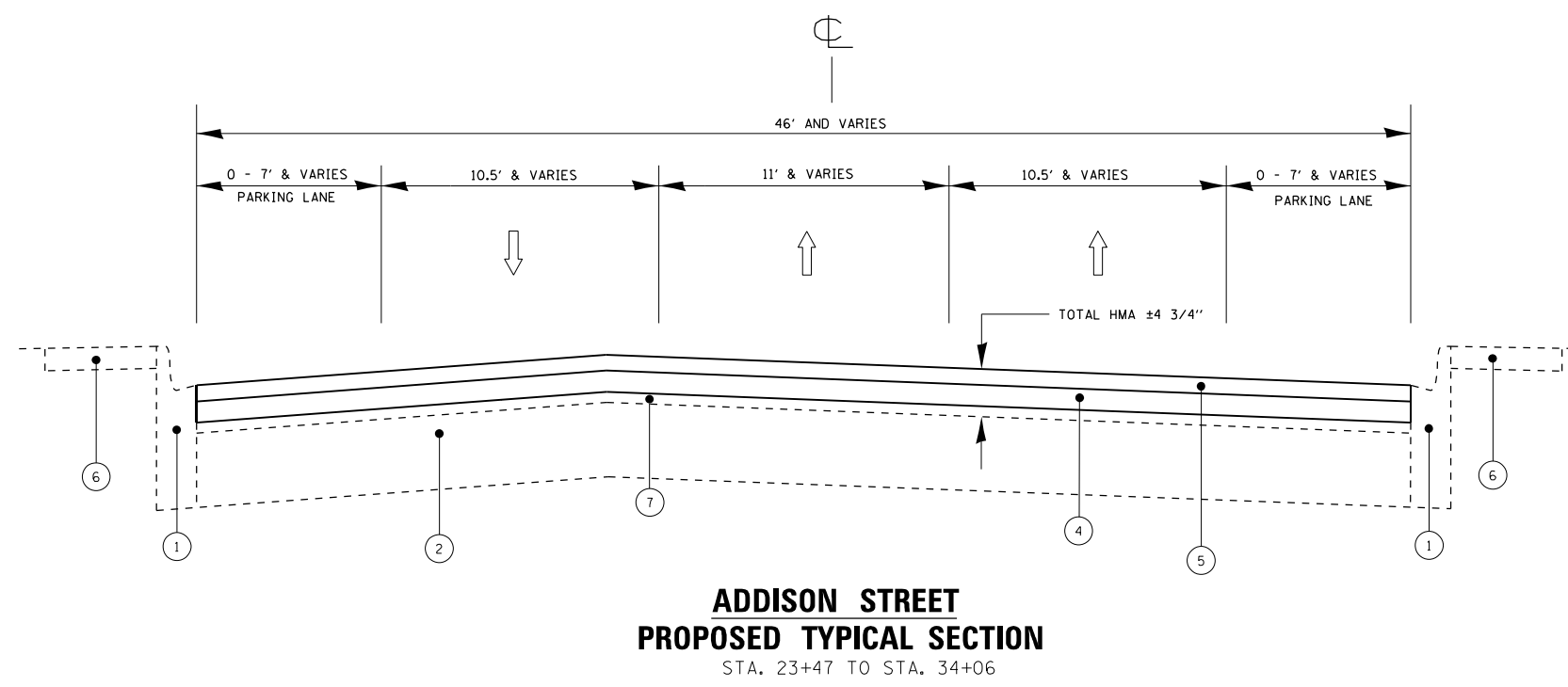

- NOTES:**
- 1 - CONTRACTOR SHALL PATCH FIRST THEN MILL.
 - 2 - THE LONGITUDINAL JOINT SEALANT SHALL BE PLACED OVER HMA BINDER IL-9.5.
 - 3 - THE TEMPORARY RAMP (SPECIAL) SHALL BE CONSTRUCTED AT ALL THE DRIVEWAYS ENTRANCES IMMEDIATELY UPON COMPLETION OF THE MILLING OPERATION AND WHEN THE DROP-OFF IS GREATER THAN 2.5 IN.

MODEL: Default
 FILE NAME: p:\project-sw-beachy.com\PIV\DOT\Documents\DOT Office\District 1\Projects\112121\CADD\data\Design\112121-shs-typrical.dgn

USER NAME = shahda	DESIGNED -	REVISED -
	DRAWN -	REVISED -
PLOT SCALE = 100,0000' / in.	CHECKED -	REVISED -
PLOT DATE = 10/21/2021	DATE -	REVISED -

**STATE OF ILLINOIS
DEPARTMENT OF TRANSPORTATION**

**ADDISON ST (HALSTED ST TO US 41)
TYPICAL SECTIONS**

SCALE: SHEET OF SHEETS STA. TO STA.

F.A.U. RTE.	SECTION	COUNTY	TOTAL SHEETS	SHEET NO.
1372	2021-012-R5&SW	COOK	21	7
CONTRACT NO. 62N71				
ILLINOIS FED. AID PROJECT				

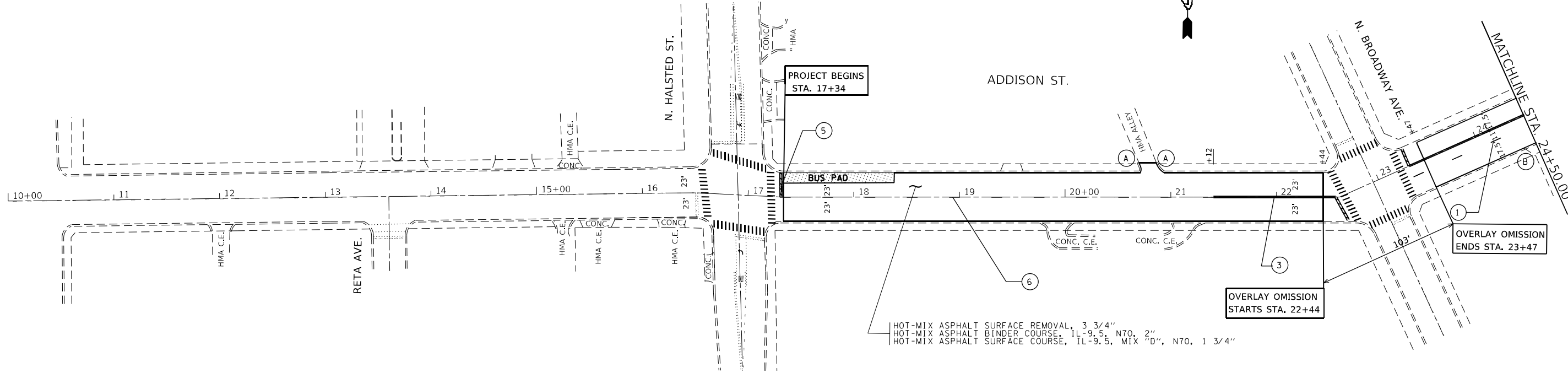

- ① PROP. THERMOPLASTIC PVMT MARKING 4", 6" DASH 18" SKIP, WHITE (TYP.)
- ② PROP. THERMOPLASTIC PVMT MARKING 6", TURN LANE, WHITE (TYP.)
- ③ PROP. THERMOPLASTIC PVMT MARKING 4", DOUBLE YELLOW @ 8" C-C (TYP.)
- ④ PROP. THERMOPLASTIC PVMT MARKING LETTERS AND SYMBOLS, WHITE (TYP.)
- ⑤ PROP. THERMOPLASTIC PVMT MARKING LINE, 24" STOPBAR, WHITE (TYP.)
- ⑥ PROP. THERMOPLASTIC PVMT MARKING 4", 6" DASH 18" SKIP, YELLOW (TYP.)
- ⑦ PROP. THERMOPLASTIC PVMT MARKING LINE 24", CROSSWALK 6" C-C 2", WHITE (TYP.)

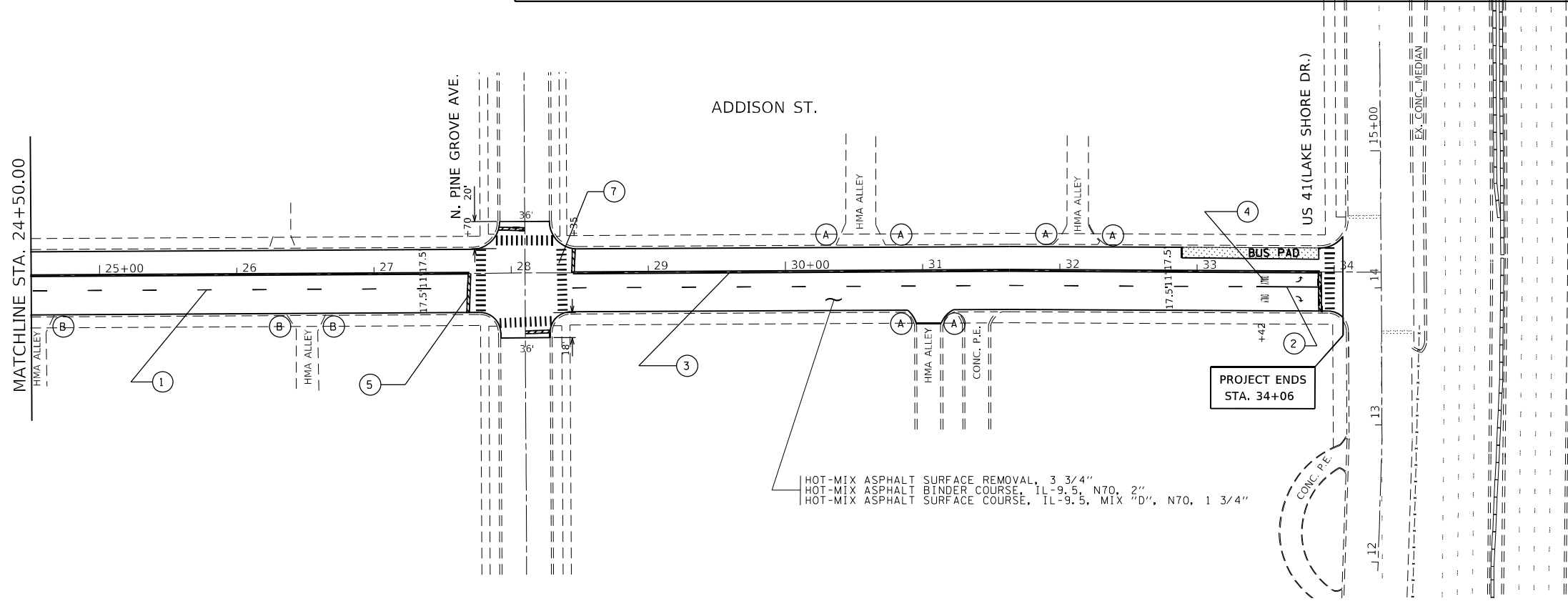

ROADWAY LEGEND

EXISTING CONCRETE BUS PAD NOT TO BE OVERLAID

SIDEWALK LEGEND

(A) PROP. PEDESTRIAN RAMP IMPROVEMENT, REFER TO PD-01A

(B) PROP. PEDESTRIAN RAMP IMPROVEMENT, REFER TO PD-01B

MODEL: Default
 FILE: Mainfile.pwd
 PROJECT: 10/21/2021
 USER: shahda

USER NAME = shahda	DESIGNED -	REVISED -
	DRAWN -	REVISED -
PLOT SCALE = 100,0000' / in.	CHECKED -	REVISED -
PLOT DATE = 10/21/2021	DATE -	REVISED -

**STATE OF ILLINOIS
DEPARTMENT OF TRANSPORTATION**

**ROADWAY PLAN
ADDISON ST. (HALSTED ST. TO US 41)**

SCALE: 1"=50'

SHEET OF SHEETS STA. TO STA.

F.A.U. RTE.	SECTION	COUNTY	TOTAL SHEETS	SHEET NO.
1372	2021-012-R5&SW	COOK	21	8
CONTRACT NO. 62N71				
ILLINOIS FED. AID PROJECT				

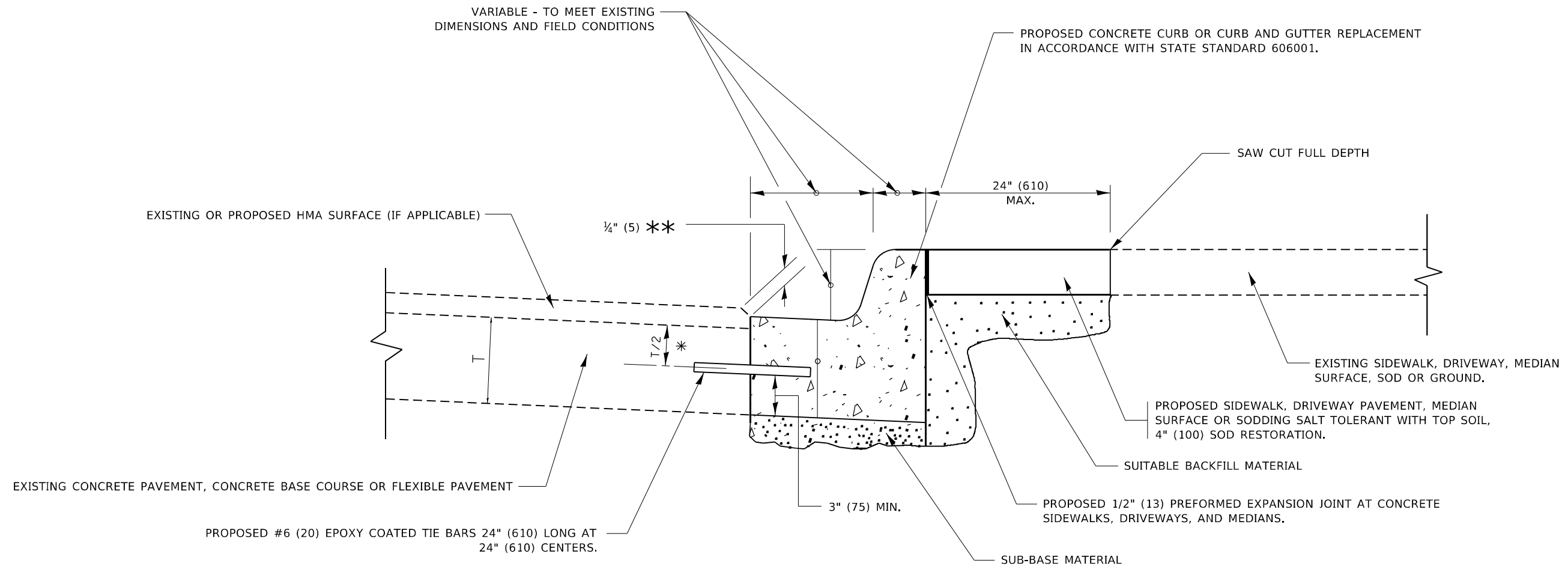

- * 3" (75) MINIMUM FROM TOP AND BOTTOM OF THE CONCRETE PAVEMENT OR BASE COURSE.
- ** IF THE FINAL SURFACE OF THE PAVEMENT IS CONCRETE, THE GUTTER IS TO BE FLUSH WITH THE PAVEMENT.

CURB OR CURB AND GUTTER REMOVAL AND REPLACEMENT

ALL DIMENSIONS ARE IN INCHES (MILLIMETERS) UNLESS OTHERWISE SHOWN.

MODEL: Default
FILE NAME: p:\ultra\paw\hcad\paw.com\PIV\DOT\Documents\DOT Office\District 3\Project\112121\CADD\DATA\Design\Bd6006.dgn

USER NAME = shahda	DESIGNED - A. HOUSEH	REVISED - A. ABBAS 03-21-97
	DRAWN -	REVISED - M. GOMEZ 01-22-01
PLOT SCALE = 100,0000 ' / in.	CHECKED -	REVISED - R. BORO 12-15-09
PLOT DATE = 10/21/2021	DATE - 03-11-94	REVISED - K. SMITH 07-11-19

**STATE OF ILLINOIS
DEPARTMENT OF TRANSPORTATION**

CURB OR CURB AND GUTTER REMOVAL AND REPLACEMENT			
SCALE: NONE	SHEET 1	OF 1 SHEETS	STA. TO STA.

F.A.U. RTE.	SECTION	COUNTY	TOTAL SHEETS	SHEET NO.
1372	2021-012-R5&SW	COOK	21	11
BD600-06 (BD-24)		CONTRACT NO. 62N71		
ILLINOIS FED. AID PROJECT				

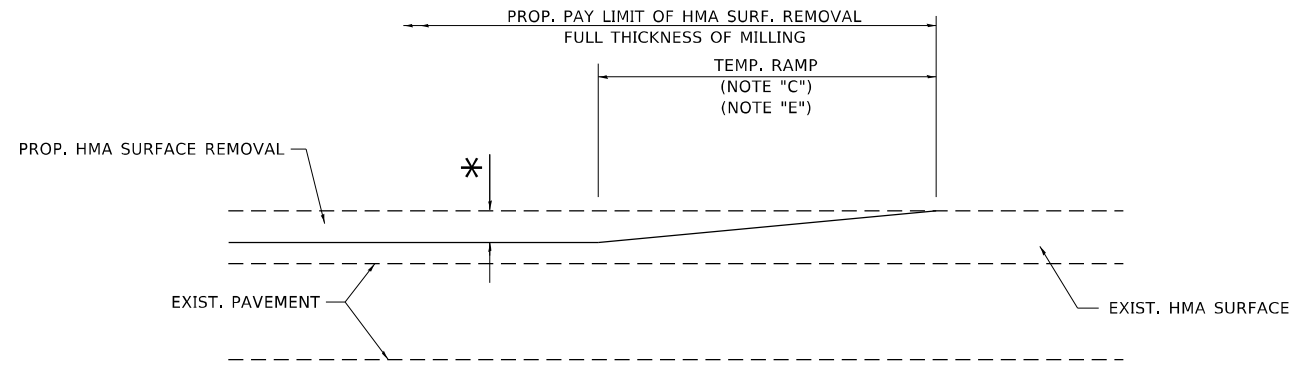

MILLED TEMPORARY RAMP

(FOR BUTT JOINT AND HMA TAPER SEE DETAIL BELOW)

OPTION 1

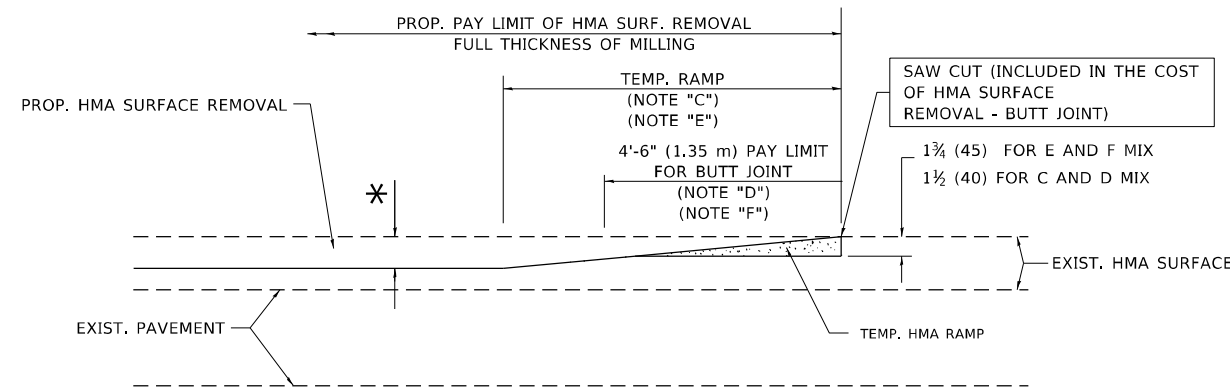

HMA CONSTRUCTED TEMPORARY RAMP

(FOR BUTT JOINT AND HMA TAPER SEE DETAIL BELOW)

OPTION 2

TYPICAL TEMPORARY RAMP

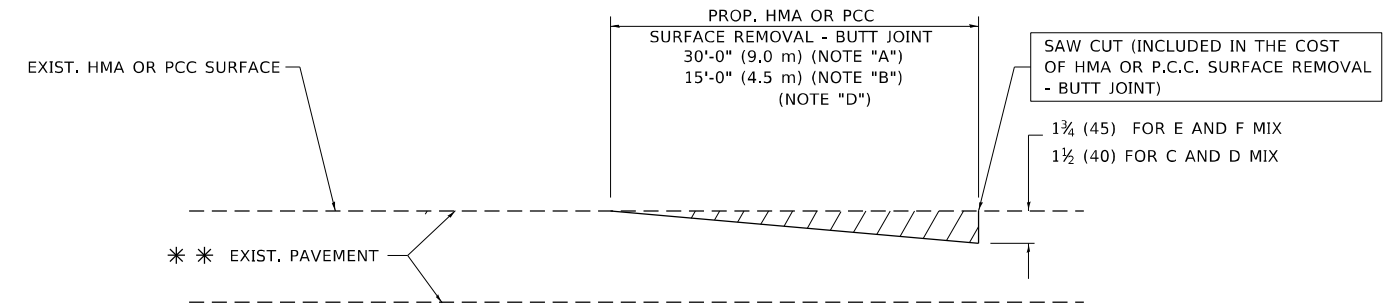

BUTT JOINT DETAIL

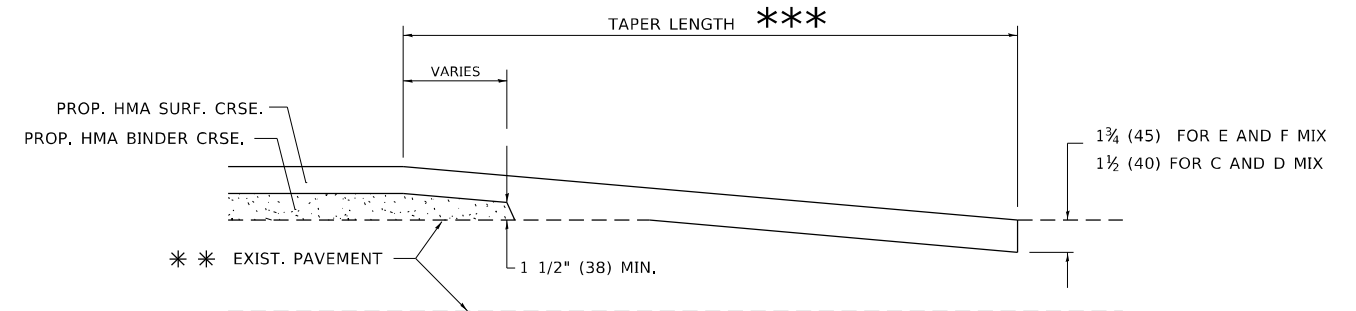

HMA TAPER DETAIL

TYPICAL BUTT JOINT AND HMA TAPER FOR RESURFACING ONLY

*** PC CONCRETE, HMA OR HMA RESURFACED PAVEMENT.

NOTES

- A. MAINLINE ROADWAYS AND MAJOR SIDE ROADS.
- B. MINOR SIDE ROADS.
- C. THE TEMP. RAMP SHALL BE CONSTRUCTED IMMEDIATELY UPON REMOVAL OF THE EXISTING HMA SURFACE.
- D. THE BUTT JOINT SHALL BE CONSTRUCTED IMMEDIATELY PRIOR TO PLACING THE PROPOSED HMA COURSES.
- E. TAPER THE TEMP. RAMP AT A RATE OF 3'-0" (900 mm) PER 1 INCH (25 mm) OF MILLING THICKNESS.
- F. INSTALLATION AND REMOVAL OF THE 4'-6" (1.35 m) TEMP. RAMP IS INCLUDED IN COST OF HMA SURFACE REMOVAL - BUTT JOINT.
* SEE TYPICAL SECTIONS FOR MILLING THICKNESS.
- G. SEE ARTICLE 406.08 AND 406.14 OF THE STANDARD SPECIFICATIONS FOR "HMA AND/OR PCC SURFACE REMOVAL, BUTT JOINT".
*** 20'-0" (6.1 m) PER 1 (25) RESURFACING (NOTE "A")
10'-0" (3.0 m) PER 1 (25) RESURFACING (NOTE "B")

BASIS OF PAYMENT

THE BUTT JOINT WILL BE PAID FOR AT THE CONTRACT UNIT PRICE PER SQUARE YARD (SQUARE METER) FOR "HOT-MIX ASPHALT SURFACE REMOVAL - BUTT JOINT" OR FOR "PORTLAND CEMENT CONCRETE SURFACE REMOVAL - BUTT JOINT".

ALL DIMENSIONS ARE IN INCHES (MILLIMETERS) UNLESS OTHERWISE SHOWN.

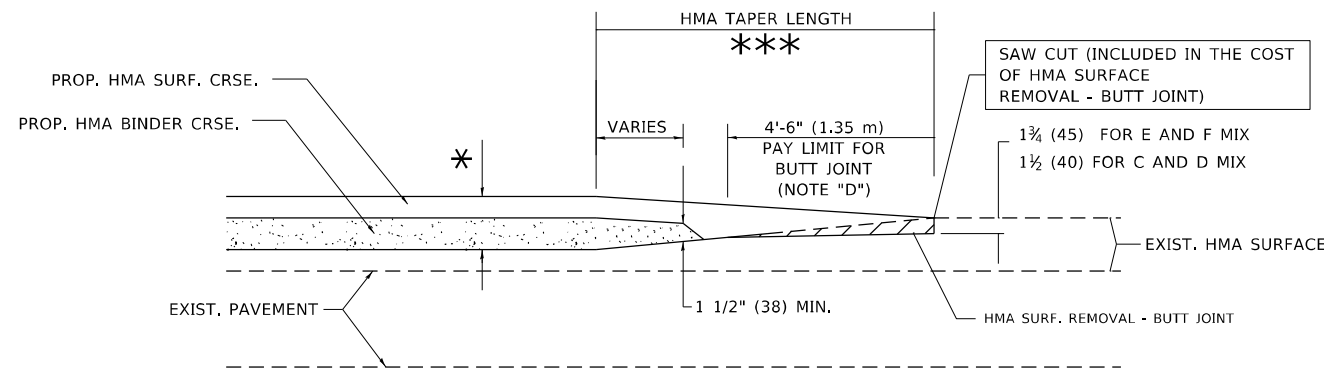

BUTT JOINT AND HMA TAPER

TYPICAL BUTT JOINT AND HMA TAPER FOR MILLING AND RESURFACING

MODEL: Default
FILE NAME: p:\projects\paw_becadefy.com\PIV\DOT\Documents\DOT Office\District 3\Projects\112121\CAD\DATA\Design\BartStEd.dgn

USER NAME = shahda	DESIGNED - M. DE YONG	REVISED - R. SHAH 10-25-94
	DRAWN -	REVISED - A. ABBAS 03-21-97
PLOT SCALE = 100,0000 ' / in.	CHECKED -	REVISED - M. GOMEZ 04-06-01
PLOT DATE = 10/21/2021	DATE - 06-13-90	REVISED - R.BORO 01-01-07

STATE OF ILLINOIS
DEPARTMENT OF TRANSPORTATION

BUTT JOINT AND
HMA TAPER DETAILS

SCALE: NONE SHEET 1 OF 1 SHEETS STA. TO STA.

F.A.U. RTE.	SECTION	COUNTY	TOTAL SHEETS	SHEET NO.
1372	2021-012-R5&SW	COOK	21	12
BD400-05 BD32		CONTRACT NO. 62N71		
ILLINOIS FED. AID PROJECT				

STRAIGHT DETECTABLE WARNING UNITS

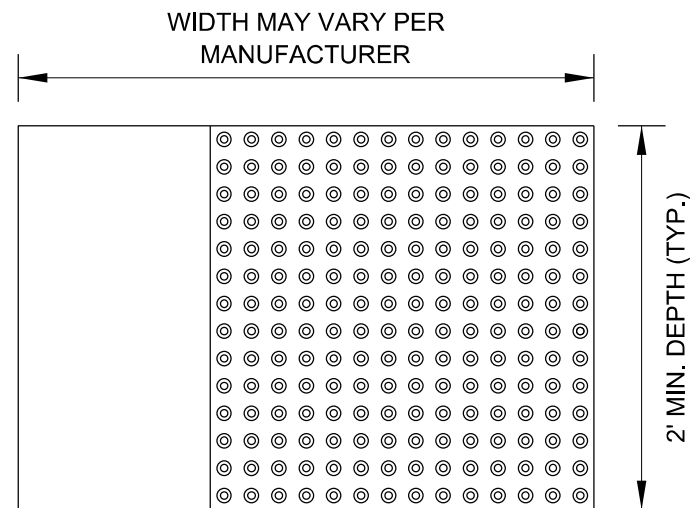

RADIAL DETECTABLE WARNING UNITS

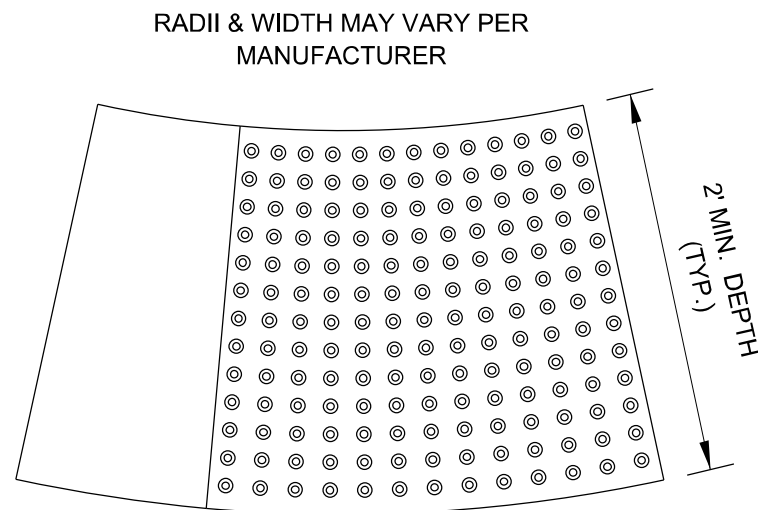

DETECTABLE WARNING UNIT SIZES

- VERIFY ALL DIMENSIONS WITH THE PRODUCT MANUFACTURER.
- IF USING RADIAL UNITS, VERIFY THAT THE CURB RADIUS MATCHES AVAILABLE UNIT RADII WITH THE PRODUCT MANUFACTURER.

GENERAL NOTE:

THE ROWS OF DOMES IN THE DETECTABLE WARNING MATERIAL MUST BE ALIGNED WITH THE PATH OF WHEELCHAIR TRAVEL WHICH IS REQUIRED TO BE PERPENDICULAR TO THE GRADE BREAK AT THE BOTTOM OF THE RAMP TO PERMIT TRACKING BETWEEN DOME ROWS. ON BLENDED TRANSITIONS OR FLUSH TRANSITIONS, WHERE RADIAL UNITS ARE SITUATED ABOUT THE CURB RADIUS, DOME ORIENTATION IS NOT SIGNIFICANT.

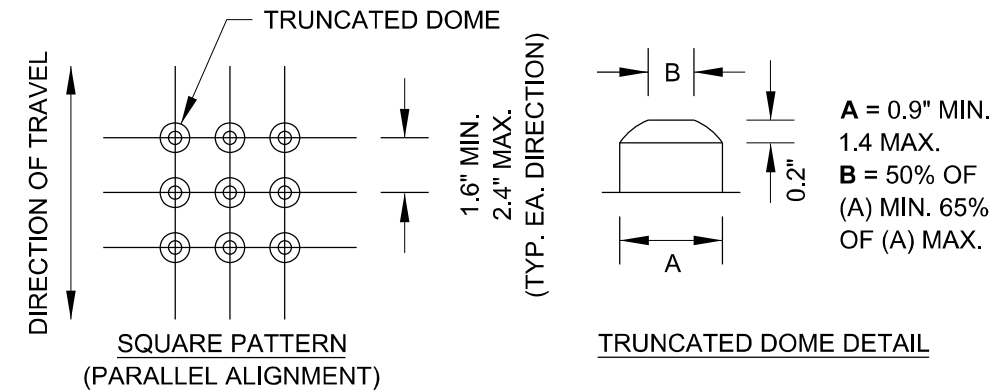

UNIT PATTERN & DOME DETAIL

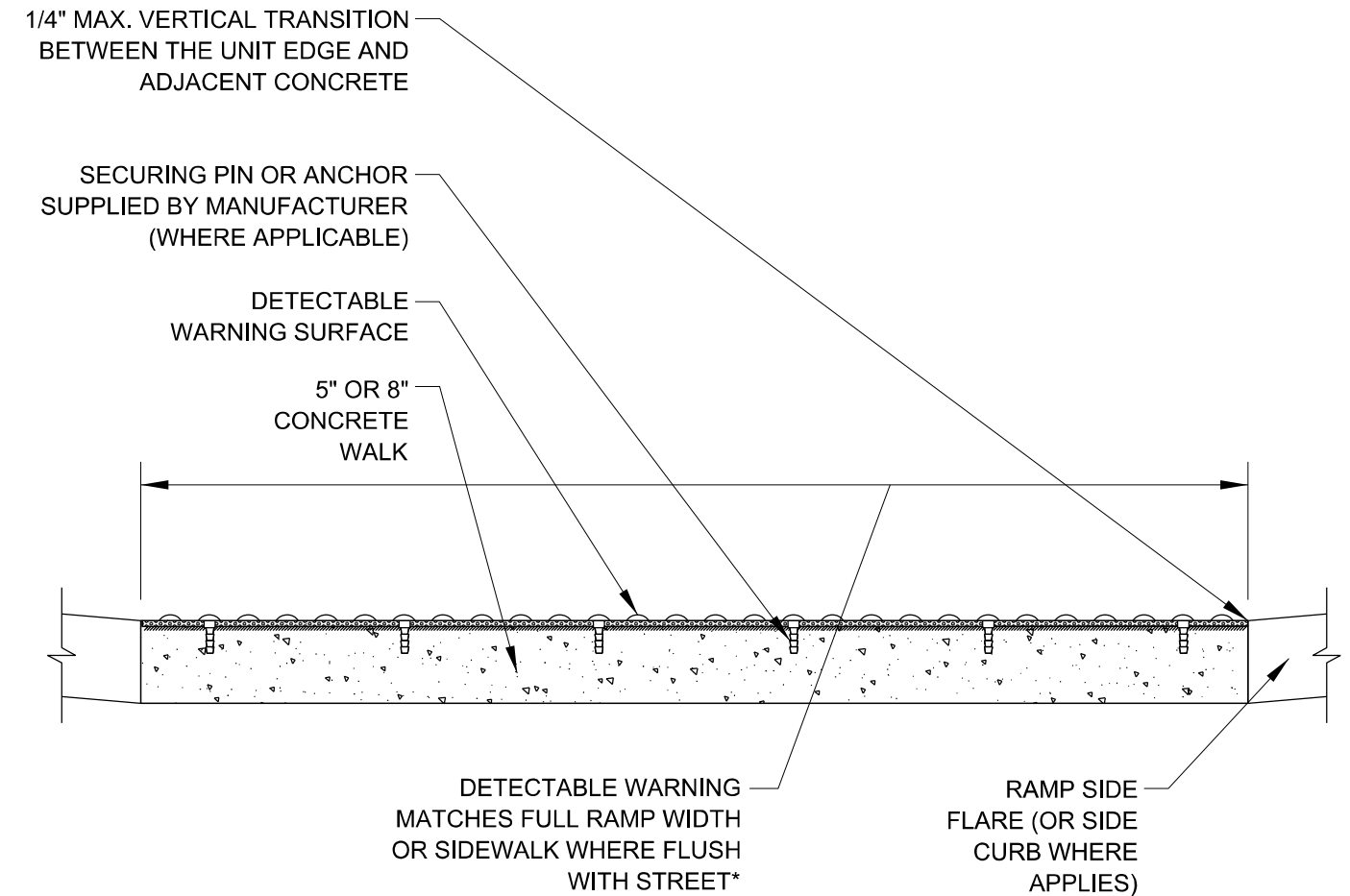

*A BORDER OF 2 INCHES OR LESS AROUND THE DETECTABLE WARNING SURFACE IS ACCEPTABLE IF REQUIRED FOR PROPER INSTALLATION OF THE DETECTABLE WARNING SURFACE PRODUCT

DETECTABLE WARNING UNIT SECTION

MODEL: P:\m\l...
 FILE NAME: P:\m\l...

USER NAME = shahda	DESIGNED -	REVISED -
	DRAWN -	REVISED -
PLOT SCALE = 100.0685' / in.	CHECKED -	REVISED -
PLOT DATE = 10/21/2021	DATE - 06-20-2017	REVISED -

**STATE OF ILLINOIS
DEPARTMENT OF TRANSPORTATION**

**CITY OF CHICAGO
DETECTABLE WARNINGS**

SCALE: NONE SHEET 1 OF 1 SHEETS STA. TO STA.

F.A.U. RTE. 1372	SECTION 2021-012-RS&SW	COUNTY COOK	TOTAL SHEETS 21	SHEET NO. 14
BD 58		CONTRACT NO. 62N71		
ILLINOIS FED. AID PROJECT				

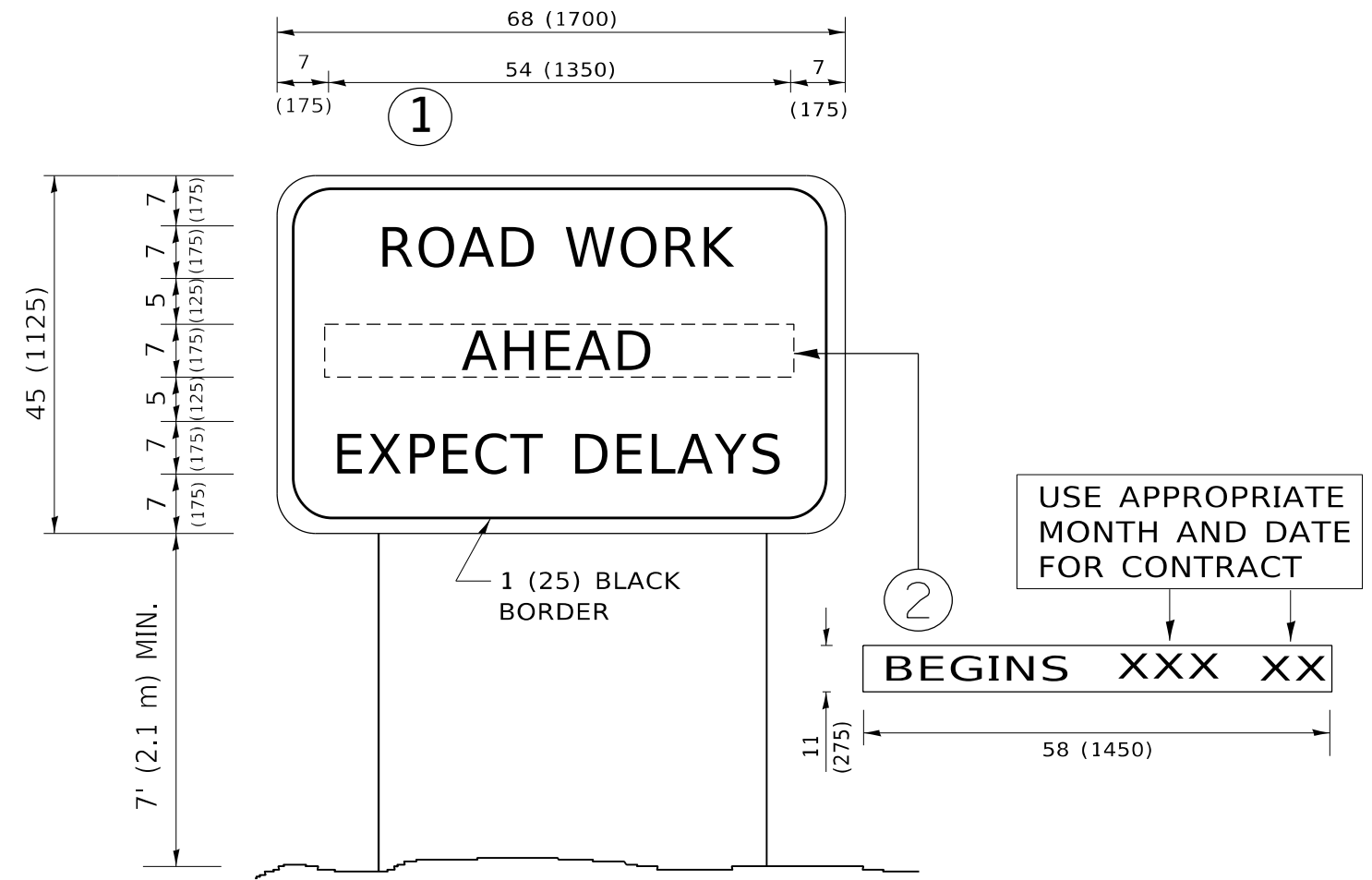

NOTES:

1. USE BLACK LETTERING ON ORANGE BACKGROUND.
2. ERECT SIGNS IN ADVANCE OF THE LOCATION FOR THE "ROAD CONSTRUCTION AHEAD" SIGN AT LOCATIONS AS DIRECTED BY THE ENGINEER.
3. ERECT SIGN ① WITH INSTALLED PANEL ② ONE WEEK PRIOR TO THE START OF CONSTRUCTION.
4. REMOVE PANEL ② SOON AFTER THE START OF CONSTRUCTION.
5. SEE SPECIAL PROVISION FOR "TEMPORARY INFORMATION SIGNING" FOR ADDITIONAL INFORMATION.
6. ONE SIGN ASSEMBLY EQUALS 25.70 SQ. FT. (2.3 SQ. M.)
7. SHALL BE PAID FOR AS TEMPORARY INFORMATION SIGNING.

ALL DIMENSIONS ARE IN INCHES (MILLIMETERS) UNLESS OTHERWISE SHOWN.

MODEL: Default
 FILE NAME: p:\project\paw\benefy.com\PW\DOT\Documents\DOT Office\District 3\Project\12121\COData\Design\BartSt.dgn

USER NAME = shahda	DESIGNED -	REVISED - R. MIRS 09-15-97
	DRAWN -	REVISED - R. MIRS 12-11-97
PLOT SCALE = 100,0000 ' / in.	CHECKED -	REVISED - T. RAMMACHER 02-02-99
PLOT DATE = 10/21/2021	DATE -	REVISED - C. JUCIUS 01-31-07

**STATE OF ILLINOIS
DEPARTMENT OF TRANSPORTATION**

**ARTERIAL ROAD
INFORMATION SIGN**

SCALE: NONE SHEET 1 OF 1 SHEETS STA. TO STA.

F.A.U. RTE.	SECTION	COUNTY	TOTAL SHEETS	SHEET NO.
1372	2021-012-R5&SW	COOK	21	17
TC-22		CONTRACT NO. 62N71		
ILLINOIS FED. AID PROJECT				

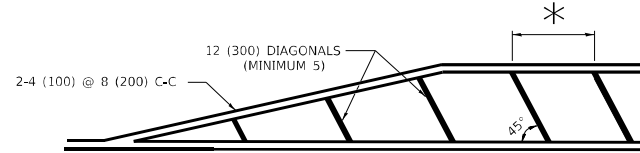
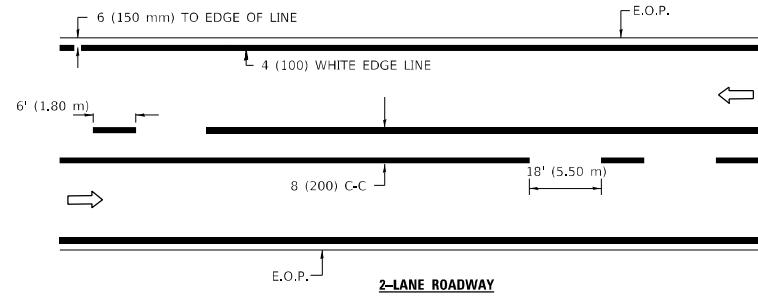

* FOR MEDIAN LENGTHS WHERE DIAGONAL SPACING CANNOT BE ATTAINED, USE 5 (FIVE) EQUALLY SPACED DIAGONAL LINES.
 * DIAGONAL LINE SPACING: 20' (6.1 m) C-C

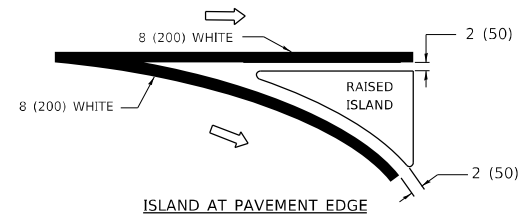
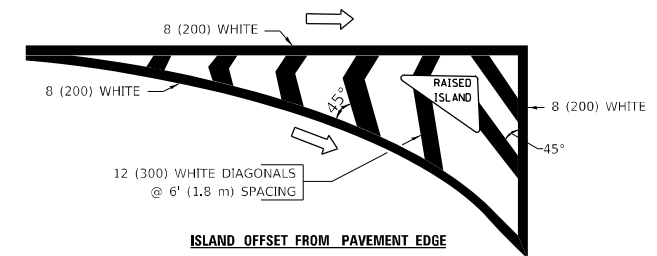

TYPICAL ISLAND MARKING

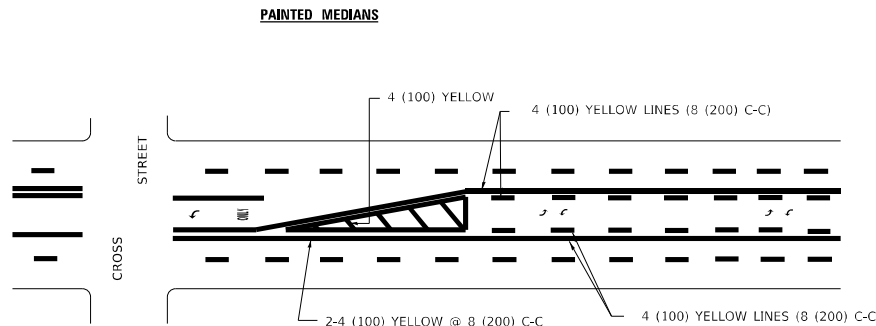
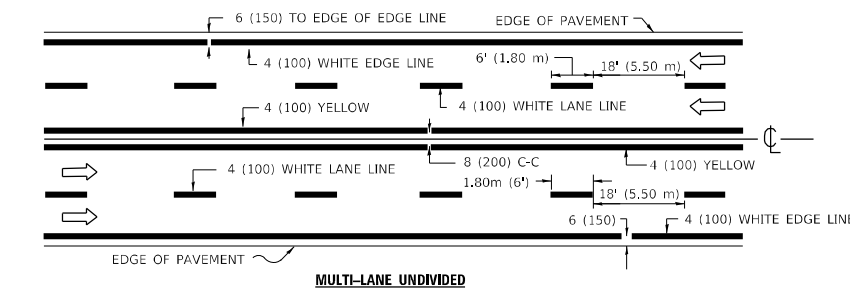

A MINIMUM OF TWO PAIRS OF TURN ARROWS SHALL BE USED, WHITE IN COLOR. ADDITIONAL PAIRS SHALL BE PLACED AT 200' (60 m) TO 300' (90 m) INTERVALS.

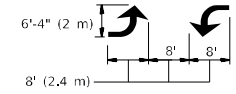

MEDIAN WITH TWO-WAY LEFT TURN LANE

TYPICAL PAINTED MEDIAN MARKING

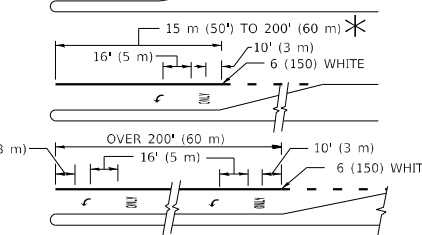
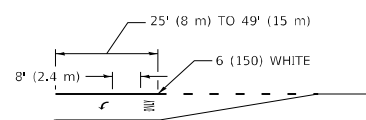
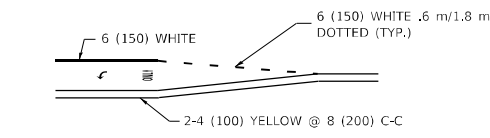

FULL SIZE LETTERS 8" (2.4 m) AND ARROWS SHALL BE USED.
 AREA = 15.8 SQ. FT. (1.47 m²) ONLY AREA = 22.9 SQ. FT. (2.13 m²)
 * TURN LANES IN EXCESS OF 400' (120 m) IN LENGTH MAY HAVE AN ADDITIONAL SET OF ARROW - "ONLY" INSTALLED MIDWAY BETWEEN THE OTHER TWO SETS OF ARROW - "ONLY".

TYPICAL LEFT (OR RIGHT) TURN LANE

TYPICAL TURN LANE MARKING

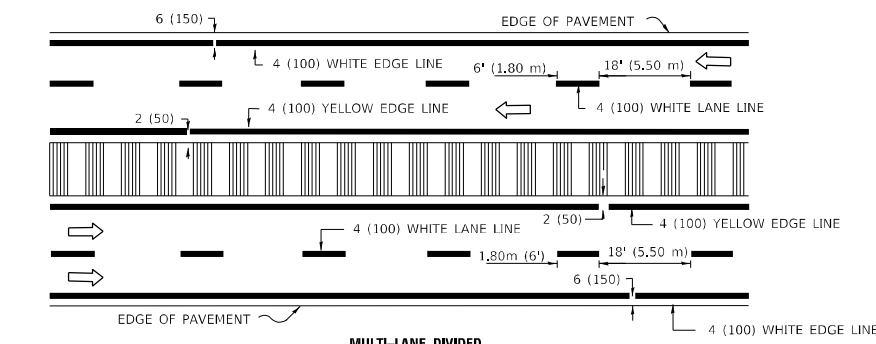

MULTI-LANE DIVIDED WITH MOUNTABLE MEDIAN

NOTE: MEDIANS WITH BARRIER CURB DO NOT REQUIRE AN EDGE LINE

TYPICAL LANE AND EDGE LINE MARKING

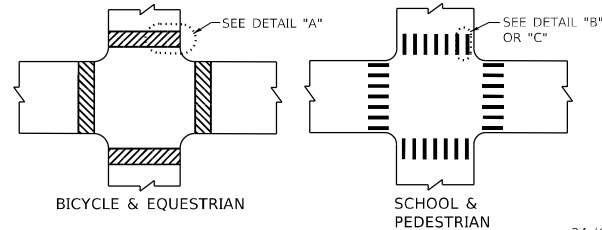

TYPICAL CROSSWALK MARKING

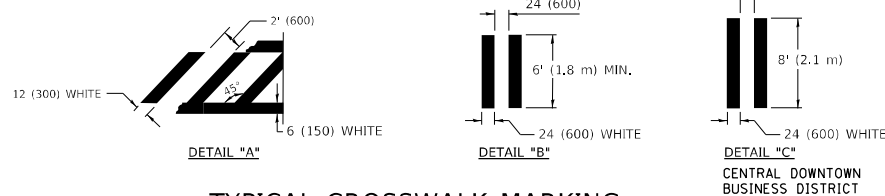

TYPE OF MARKING	WIDTH OF LINE	PATTERN	COLOR	SPACING / REMARKS
CENTERLINE ON 2 LANE PAVEMENT	4 (100)	SKIP-DASH	YELLOW	6' (1.80 m) LINE WITH 18' (5.50 m) SPACE
CENTERLINE ON MULTI-LANE UNDIVIDED PAVEMENT	2 @ 4 (100)	SOLID	YELLOW	8 (200) C-C
NO PASSING ZONE LINES: FOR ONE DIRECTION FOR BOTH DIRECTIONS	4 (100) 2 @ 4 (100)	SOLID SOLID	YELLOW YELLOW	8 (200) C-C
LANE LINES	4 (100) 5 (125) ON FREEWAYS	SKIP-DASH SKIP-DASH	WHITE WHITE	6' (1.80 m) LINE WITH 18' (5.50 m) SPACE
DOTTED LINES (EXTENSIONS OF CENTER, LANE OR TURN LANE MARKINGS)	SAME AS LINE BEING EXTENDED	SKIP-DASH	SAME AS LINE BEING EXTENDED	2' (600) LINE WITH 6' (1.8) SPACE
EDGE LINES	4 (100)	SOLID	YELLOW-LEFT WHITE-RIGHT	OUTLINE MOUNTABLE MEDIANS IN YELLOW; EDGE LINES ARE NOT USED NEXT TO BARRIER CURB
TURN LANE MARKINGS	6 (150) LINE: FULL SIZE LETTERS & SYMBOLS (8' (2.4 m))	SOLID	WHITE	SEE TYPICAL TURN LANE MARKING DETAIL
TWO WAY LEFT TURN MARKING	2 @ 4 (100) EACH DIRECTION 8' (2.4 m) LEFT ARROW	SKIP-DASH AND SOLID IN PAIRS	YELLOW WHITE	6' (1.8 m) LINE WITH 18' (5.50 m) SPACE FOR SKIP-DASH; 8 (200) C-C BETWEEN SOLID LINE AND SKIP-DASH LINE SEE TYPICAL TWO-WAY LEFT TURN MARKING DETAIL
CROSSWALK LINES A. DIAGONALS (BIKE & EQUESTRIAN) B. LONGITUDINAL BARS (SCHOOL & PEDESTRIAN)	12 (300) @ 45° 24 (600) @ 90°	SOLID SOLID	WHITE WHITE	2' (600) APART 2' (600) APART SEE TYPICAL CROSSWALK MARKING DETAILS.
STOP LINES	24 (600)	SOLID	WHITE	PLACE 4' (1.2 m) IN ADVANCE OF AND PARALLEL TO CROSSWALK, IF PRESENT, OTHERWISE, PLACE AT DESIRED STOPPING POINT, PARALLEL TO CROSSROAD CENTERLINE, WHERE POSSIBLE
PAINTED MEDIANS	2 @ 4 (100) WITH 12 (300) DIAGONALS @ 45°	SOLID	YELLOW: TWO WAY TRAFFIC WHITE: ONE WAY TRAFFIC	8 (200) C-C FOR THE DOUBLE LINE SEE TYPICAL PAINTED MEDIAN MARKING.
GORE MARKING AND CHANNELIZING LINES	8 (200) WITH 12 (300) DIAGONALS @ 45°	SOLID	WHITE	DIAGONALS: 20' (6.1 m) (LESS THAN 30 MPH (50 km/h))
RAILROAD CROSSING	24 (600) TRANSVERSE LINES; "RR" IS 6' (1.8 m) LETTERS; 16 (400) LINE FOR "X"	SOLID	WHITE	SEE STATE STANDARD 780001 AREA OF: "R"=3.6 SQ. FT. (0.33m ²) EACH "X"=54.0 SQ. FT. (5.0 m ²)

FOR FURTHER DETAILS ON PAVEMENT MARKING REFER TO STREET MARKING STANDARDS, PRINTED BY CITY OF CHICAGO, DEPARTMENT OF TRANSPORTATION, BUREAU OF TRAFFIC.

ALL DIMENSIONS ARE IN INCHES (MILLIMETERS) UNLESS OTHERWISE SHOWN.

MODEL: Default
 FILE NAME: p:\projects\paw\beachy.com\PI\DOT\Documents\DOT\Office\District_11\projects\112121\CD\Drawings\Design\BarkSt.dgn

USER NAME = shahida	DESIGNED -	REVISED - T. RAMMACHER 12-07-00
PLOT SCALE = 100,0000 ' / in.	DRAWN -	REVISED - K. ENG 02-28-12
PLOT DATE = 10/21/2021	CHECKED -	REVISED -
	DATE -	REVISED -

STATE OF ILLINOIS
 DEPARTMENT OF TRANSPORTATION

CITY OF CHICAGO
 TYPICAL PAVEMENT MARKINGS

SCALE: NONE SHEET 1 OF 3 SHEETS STA. TO STA.

F.A.U. RTE.	SECTION	COUNTY	TOTAL SHEETS	SHEET NO.
1372	2021-012-R5&SW	COOK	21	18
TC-24		CONTRACT NO.	62N71	
ILLINOIS		FED. AID PROJECT		

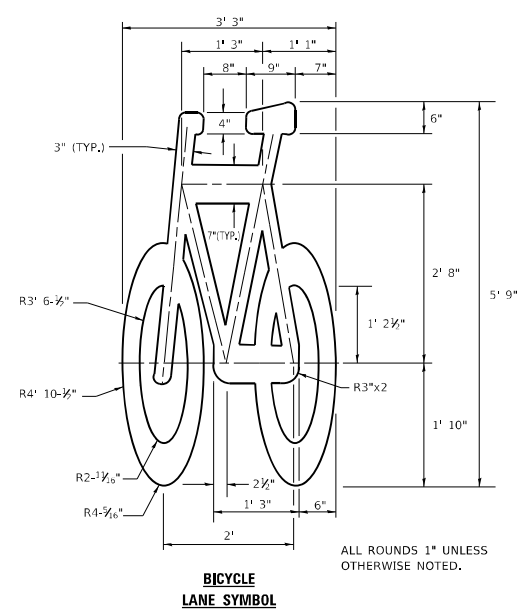
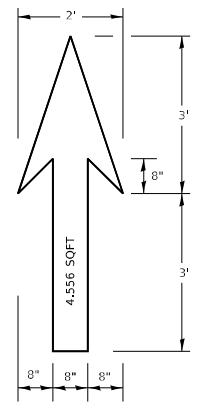

- NOTE:
1. FOR BIKE LANE SYMBOLS ONLY, USE PRE-FORMED THERMOPLASTIC WITH A MINIMUM THICKNESS OF 90 MILS, MINIMUM SKID RESISTANCE VALUE OF 60 BPN, & A MINIMUM INDEX OF REFRACTION OF 1.50.
 2. THE RESIDENT ENGINEER SHALL CONTACT MR. BEN GOMBERG AT 312-744-8093 AT LEAST ONE CALENDAR WEEK PRIOR TO INSTALLING BIKE LANE SYMBOLS.

TYPICAL BIKE LANE SYMBOLS
DRAWING #28

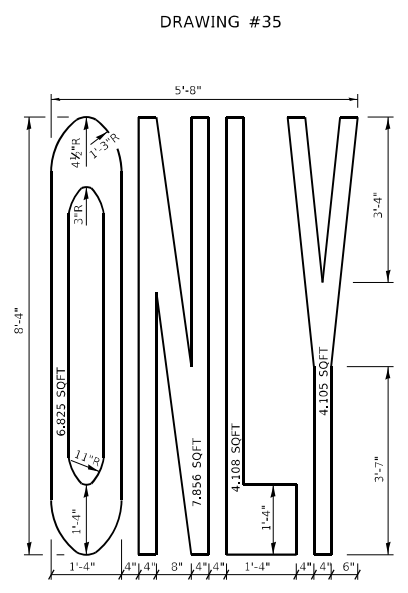
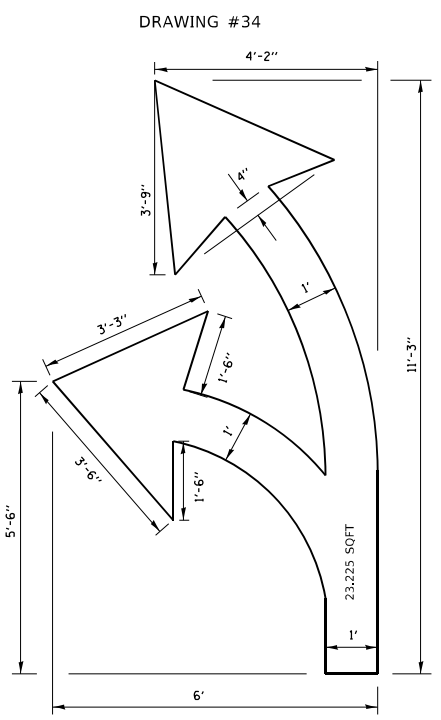
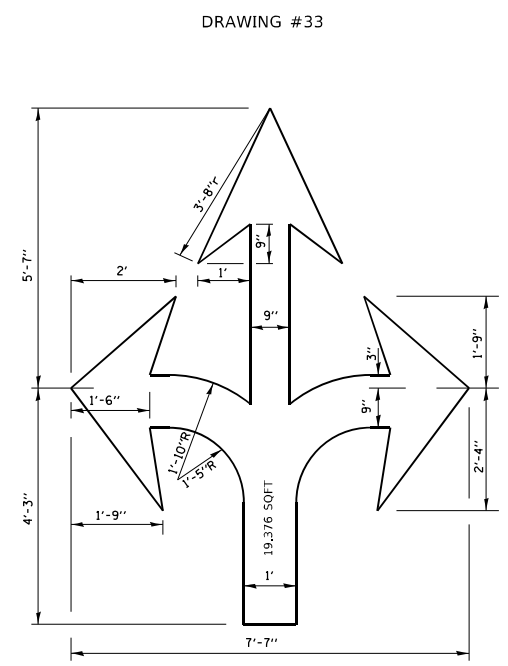
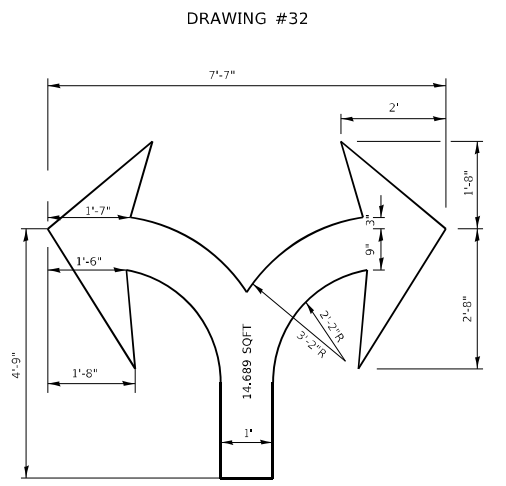
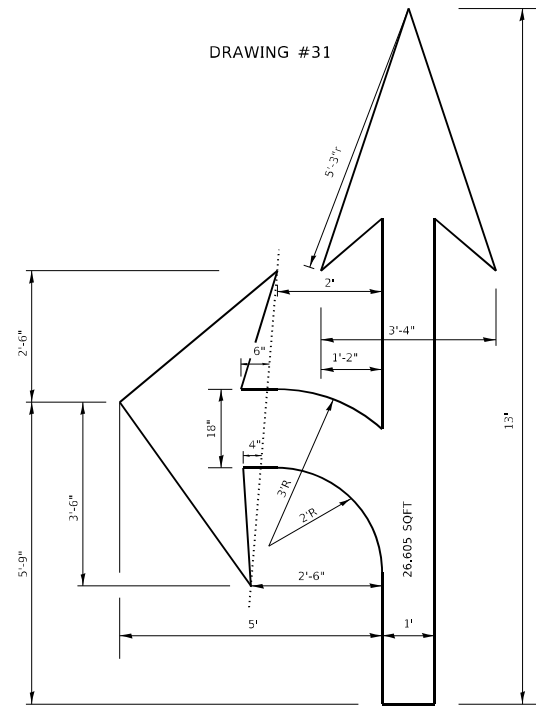
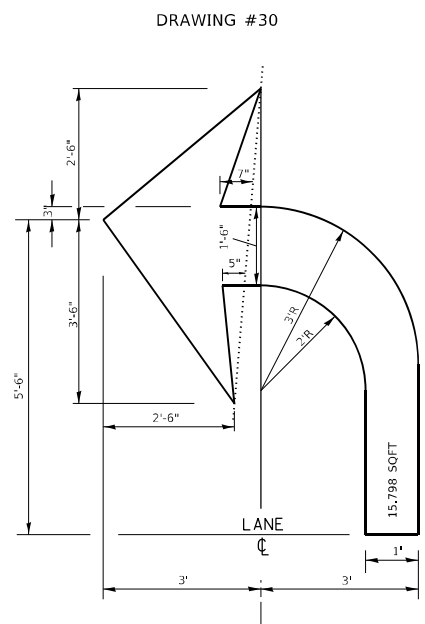
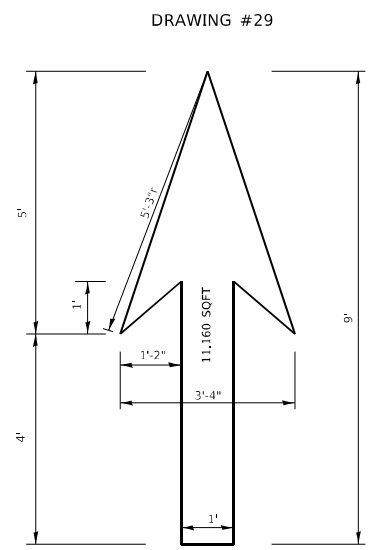

NOTE:
ALL MARKINGS SHALL BE SOLID WHITE UNLESS OTHERWISE NOTED IN THE PLANS

MODEL: Default
FILE NAME: p:\ultra\paw_bentley.com\PWD\DOT\Documents\DOT Office\District 11\Projects\112121\ICAD\data\Design\BikeStk.dgn

USER NAME = shahda	DESIGNED -	REVISED - T. RAMMACHER 12-07-00
PLOT SCALE = 100,0000 ' / in.	DRAWN -	REVISED -
PLOT DATE = 10/21/2021	CHECKED -	REVISED -
	DATE -	REVISED -

STATE OF ILLINOIS
DEPARTMENT OF TRANSPORTATION

CITY OF CHICAGO TYPICAL PAVEMENT MARKINGS			
SCALE: NONE	SHEET 2	OF 3 SHEETS	STA. TO STA.

F.A.U. RTE.	SECTION	COUNTY	TOTAL SHEETS	SHEET NO.
1372	2021-012-R5&SW	COOK	21	19
TC-24		CONTRACT NO. 62N71		
ILLINOIS		FED. AID PROJECT		

MODEL: Default
 FILE NAME: p:\ultra\paw.bentley.com\PW\DOT\Documents\DOT Offices\District 3\Projects\112121\CADD\data\Design\Dist3Std.dgn

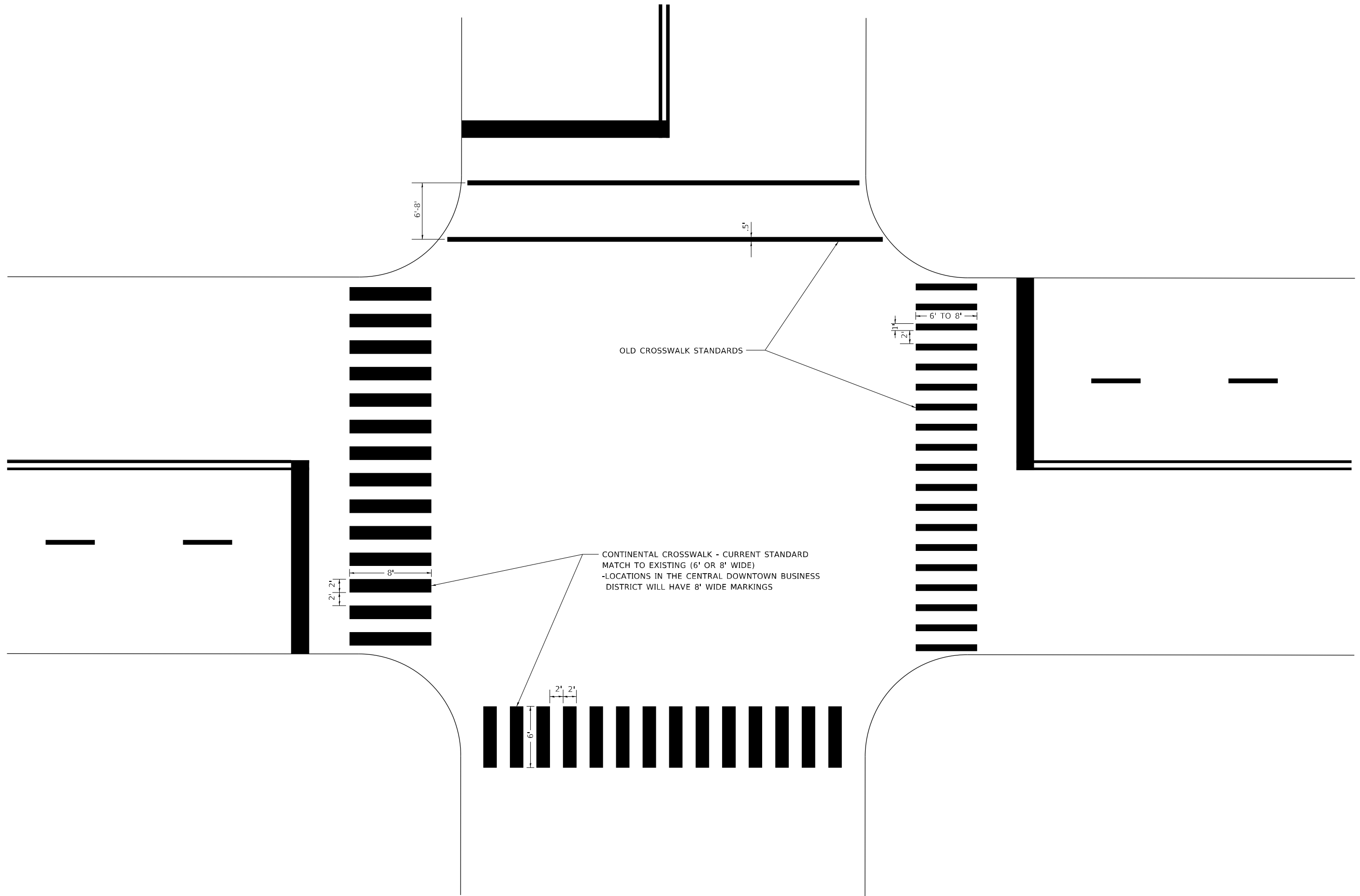

OLD CROSSWALK STANDARDS

CONTINENTAL CROSSWALK - CURRENT STANDARD
 MATCH TO EXISTING (6' OR 8' WIDE)
 -LOCATIONS IN THE CENTRAL DOWNTOWN BUSINESS
 DISTRICT WILL HAVE 8' WIDE MARKINGS

**STATE OF ILLINOIS
 DEPARTMENT OF TRANSPORTATION**

**CITY OF CHICAGO
 TYPICAL PAVEMENT MARKINGS**

USER NAME = shahda	DESIGNED -	REVISED - T. RAMMACHER 12-07-00
	DRAWN -	REVISED -
PLOT SCALE = 100,0001' / in.	CHECKED -	REVISED -
PLOT DATE = 10/21/2021	DATE -	REVISED -

SCALE: NONE SHEET 3 OF 3 SHEETS STA. TO STA.

F.A.U. RTE.	SECTION	COUNTY	TOTAL SHEETS	SHEET NO.
1372	2021-012-R5&SW	COOK	21	20
TC-24		CONTRACT NO. 62N71		
ILLINOIS FED. AID PROJECT				

