

STATE OF ILLINOIS
DEPARTMENT OF TRANSPORTATION

F.A.P. RTE.	SECTION	COUNTY	TOTAL SHEETS	SHEET NO.
643	[(11B)BR-1]TR	STARK	6	1

ILLINOIS CONTRACT NO. 68G76
* D4 TREE REMOVAL 2022

INDEX OF SHEETS

1. COVER SHEET
2. GENERAL NOTES, PROJECT SPECIFIC NOTES, & STATUS OF UTILITIES
3. SUMMARY OF QUANTITIES
4. SCHEDULE OF QUANTITIES
5. ALIGNMENT, TIES, AND BENCHMARKS
6. TREE REMOVAL PLAN

HIGHWAY STANDARDS

- 701001-02
- 701006-05
- 701011-04
- 701101-05
- 701201-05
- 701301-04
- 701901-08

ROADWAY INFO

Minor Arterial
AADT = 2000 (2019)
SU = 2.5% (2019)
MU = 2.0% (2019)

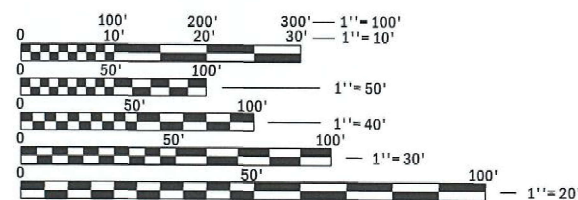

FULL SIZE PLANS HAVE BEEN PREPARED USING STANDARD ENGINEERING SCALES. REDUCED SIZED PLANS WILL NOT CONFORM TO STANDARD SCALES. IN MAKING MEASUREMENTS ON REDUCED PLANS, THE ABOVE SCALES MAY BE USED.

J.U.L.I.E.
JOINT UTILITY LOCATION INFORMATION FOR EXCAVATION
1-800-892-0123
OR 811

PROJECT ENGINEER: NICOLE FAYANT (309-671-3454)
PROJECT MANAGER ANDREW MITCHELL (309-671-3476)
CATALOG NO. 036273-00D
CONTRACT NO. 68G76

PROPOSED
HIGHWAY PLANS

F.A.P. ROUTE 643 (IL 17/91)
SECTION: [(11B)BR-1]TR
D4 TREE REMOVAL 2022
STARK COUNTY

C-94-003-22
R 6 E

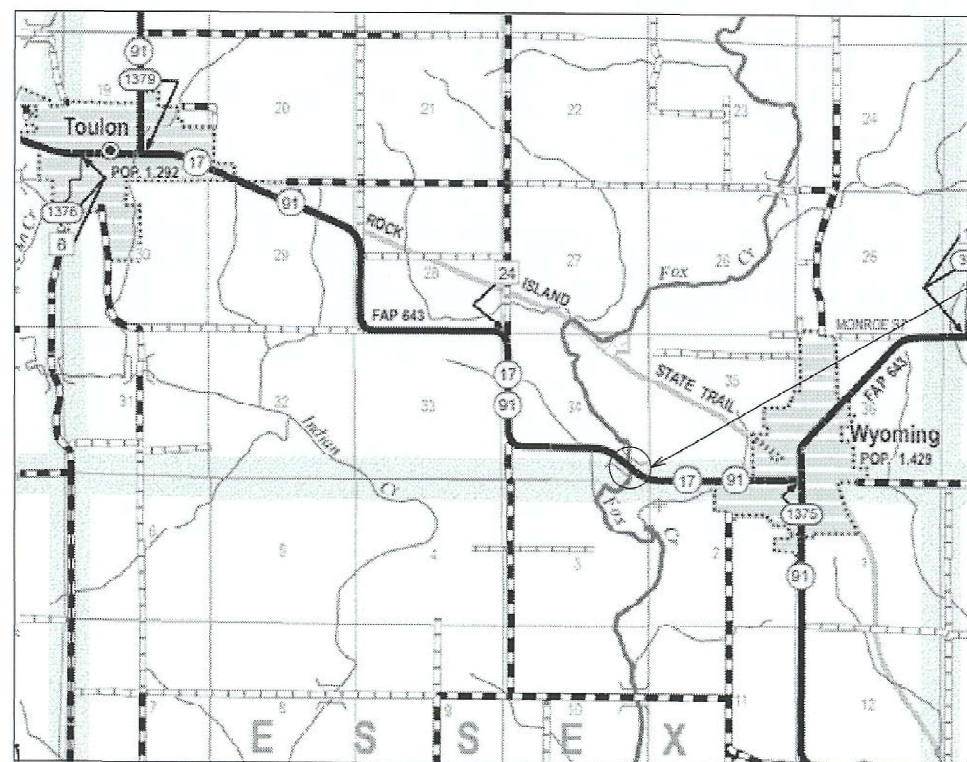

T 13 N

Project Location
IL 17/IL 91 over Spoon River
SN 088-0002



PROJECT DESCRIPTION:
TREE REMOVAL ALONG IL 17 / IL 91 ACROSS SPOON RIVER (SN 088-0002)

STATE OF ILLINOIS
DEPARTMENT OF TRANSPORTATION

SUBMITTED October 20, 2021
Paul A. Jones
REGION THREE ENGINEER

December 10, 2021
[Signature]
ENGINEER OF DESIGN AND ENVIRONMENT

December 10, 2021
[Signature]
DIRECTOR OF HIGHWAYS PROJECT IMPLEMENTATION

PRINTED BY THE AUTHORITY
OF THE STATE OF ILLINOIS

GENERAL NOTES

COMMITMENTS

There are no commitments for this project.

AVAILABILITY OF ELECTRONIC FILES

MicroStation and GEOPAK files of this project will be made available to the Contractor after contract award. If there is a conflict between the electronic files and the printed contract plans and documents, the printed contract plans and documents shall take precedence over the electronic files. The Contractor shall accept all risk associated with using the electronic files and shall hold the Department harmless for any errors or omissions in the electronic files and the data contained therein. Errors or delays resulting from the use of the electronic files by the Contractor shall not result in an extension of time for any interim or final completion date or shall not be considered cause for additional compensation. The Contractor shall not use, share, or distribute these electronic files except for the purpose of constructing this contract. Any claims by third parties due to use or errors shall be the responsibility of the Contractor. The Contractor shall include this disclaimer with the transfer of these electronic files to any other parties and shall include appropriate language binding them to similar responsibilities.

ENVIRONMENTAL REVIEWS

Prior to the use of any proposed borrow areas, use areas (temporary access roads, detours, run-arounds, etc.) and/or waste areas, the Contractor shall file the required environmental resource request surveys according to Section 107.22 of the Standard Specifications. These surveys are required in order for the Department to conduct cultural and biological resource surveys for the proposed site.

The required environmental resource documentation shall include the following:

- * BDE Form 2289 (Borrow Site Review)
- * BDE Form 2290 (Waste/Use Area Review)
- * A location map showing the size limits and location of the use area
- * Color photographs depicting the use area
- * Borrow Area Entry Agreement form – D4 PI0101

Prior to any waste materials being removed from the construction site the required environmental resource surveys shall be obtained and filed by the Contractor. Excess waste products removed from the construction site shall be disposed of as required in Section 202.03 of the Standard Specifications.

Any protruding metal bars shall be removed prior to the disposal of broken concrete at approved disposal sites.

Please note that a minimum of four weeks shall be allowed for the District to obtain the required waste site environmental clearances and six weeks for the required borrow site environmental clearances.

PROJECT SPECIFIC NOTES

TREE STUMP REMOVAL

Tree Stumps shall be removed as per article 201.04 of the "Standard Specifications for Road and Bridge Construction, adopted January 1, 2022". Trees removed under this contract fall within the definition of the fourth sentence as "All other trees and stumps that fall within the right-of-way..." of the aforementioned article. The Contractor shall remove the stump within seven (7) days of removing the tree.

ASH TREE MATERIAL

Ash tree material shall be disposed of according to the State of Illinois Regulations for Emerald Ash Borer (EAB) trees.

STATUS OF UTILITIES							
Company	Route	Offset	Location	Depth	Type of Utility	Type of Conflict	Disposition
Frontier	IL 17/ IL 91	50' LT	STA. 60+00 to 63+00	Unknown	Buried Fiber	Tree Removal	Caution
Mediacom	IL 17/ IL 91	37' LT	STA. 60+00 to 61+25	Unknown	Buried Fiber	Tree Removal	Caution
			STA. 61+25 to 63+00	n/a	Aerial Fiber		

MODEL: Default
 FILE: \\m11e-pw-bentley.com\FW\DOT\Documents\DOT Office\District 4\Project\104_68G76\CADD\Bak\CAD\Sheet\10468G76-01-01.dgn

USER NAME = \$USERS	DESIGNED -	REVISED -
PLOT SCALE = 1:100	DRAWN -	REVISED -
PLOT DATE = 10/28/2021	CHECKED -	REVISED -
	DATE -	REVISED -

STATE OF ILLINOIS
DEPARTMENT OF TRANSPORTATION

GENERAL NOTES, PROJECT SPECIFIC NOTES,
& STATUS OF UTILITIES

SCALE: SHEET OF SHEETS STA. TO STA.

F.A.P. RTE.	SECTION	COUNTY	TOTAL SHEETS	SHEET NO.
643	[(11B)BR-1]TR	STARK	6	2
CONTRACT NO. G8G76			ILLINOIS FED. AID PROJECT	

CODE NO.	ITEM	UNIT	TOTAL QUANTITY	CONST. CODE	
				0031	LANDSCAPING 100% STATE STARK RURAL
20100500	TREE REMOVAL, ACRES	ACRES	0.3	0.3	
67100100	MOBILIZATION	L SUM	1	1	
70100450	TRAFFIC CONTROL AND PROTECTION, STANDARD 701201	L SUM	1	1	
Z0013798	CONSTRUCTION LAYOUT	L SUM	1	1	

FILE NAME =	USER NAME = \$USER\$	DESIGNED -	REVISED -
pw:\ildot-pw.bentley.com\PWIDOT\Documents\IDOT Offices\District 4\Projects\04-68G76-CONTRACTS\CAD\Drawings\04-68G76-11TR\04-68G76-11TR-S00.dgn		CHECKED -	REVISED -
			DATE -

**STATE OF ILLINOIS
DEPARTMENT OF TRANSPORTATION**

SUMMARY OF QUANTITIES

F.A.P. RTE.	SECTION	COUNTY	TOTAL SHEETS	SHEET NO.
643	[[11B]BR-11TR	STARK	6	3
CONTRACT NO. 68G76				
ILLINOIS FED. AID PROJECT				

MOBILIZATION	
LOCATION	L SUM
JOBSITE	1

TRAFFIC CONTROL & PROTECTION, STANDARD 701201	
LOCATION	L SUM
JOBSITE	1

CONSTRUCTION LAYOUT	
LOCATION	L SUM
JOBSITE	1

TREE REMOVAL	
LOCATION	ACRES
STA. 61+00 to 62+24.3 LT	0.10
STA. 61+44.5 to 63+82.5 RT	0.19
TOTAL	0.3

MODEL: Default
 FILE NAME: p:\ultra-cw-beadley.com\PIV\DOT\Documents\DOT Offices\District 4\Project\ID4_68G76\CADD\DWG\CAD\Sheet\ID468G76-INT-SCH-QUANT.DWG

USER NAME = \$USER\$	DESIGNED -	REVISED -
	DRAWN -	REVISED -
PLOT SCALE = 1:100	CHECKED -	REVISED -
PLOT DATE = 10/28/2021	DATE -	REVISED -

STATE OF ILLINOIS
DEPARTMENT OF TRANSPORTATION

SCHEDULE OF QUANTITIES

SCALE: SHEET 1 OF 1 SHEETS STA. TO STA.

F.A.P. RTE.	SECTION	COUNTY	TOTAL SHEETS	SHEET NO.
643	[(11B)BR-1]TR	STARK	6	4
CONTRACT NO. 68G76			ILLINOIS FED. AID PROJECT	

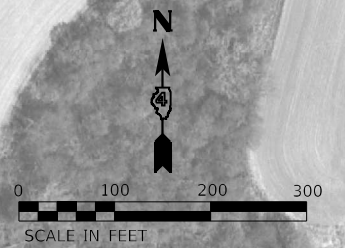

PI STA. = 74+02.99
 $\Delta = 37^\circ 03' 33''$ (LT)
 $D = 4^\circ 59' 54''$
 $R = 1,146.28'$
 $T = 384.20'$
 $L = 741.42'$
 $E = 62.67'$
 $e = 5.93\%$
 $T.R. = 39'$
 $S.E. RUN = 152'$
 $P.C. STA. = 70+18.79$
 $P.T. STA. = 77+60.21$

CONTROL POINT 3
 $N = 1601825.5760$
 $E = 2398900.3500$

B.M. 1
 SET RR SPIKE IN UTILITY POLE
 SOUTH SIDE OF IL RTE. 17,
 APPROX. STA. 52+75
 ELEVATION = 676.22

 B.M. 2
 CHISELED SQUARE ON TOP OF
 CURB IN NW QUADRANT OF
 EXISTING SPOON RIVER BRIDGE
 ELEVATION = 652.77

NOTE: ALL POINTS ARE IN GROUND COORDINATES

CONTROL POINT 5
 $N = 1601269.4840$
 $E = 2399753.9990$

PI STA. = 55+80.77
 $\Delta = 37^\circ 55' 29''$ (RT)
 $D = 3^\circ 59' 57''$
 $R = 1,432.69'$
 $T = 492.26'$
 $L = 948.31'$
 $E = 82.21'$
 $e = 5.65\%$
 $T.R. = 39'$
 $S.E. RUN = 145'$
 $P.C. STA. = 50+88.50$
 $P.T. STA. = 60+36.82$

CONTROL POINT 1
 $N = 1601074.6470$
 $E = 2399981.0480$

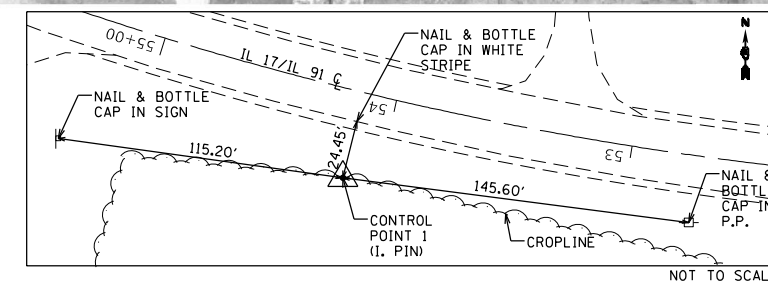
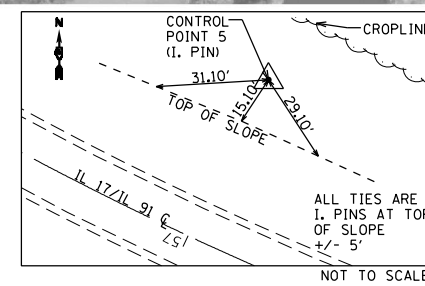
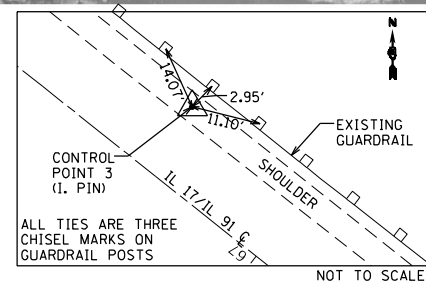

MODEL: Default
 FILE NAME: p:\project\aw_bentley.com\p\dot\documents\DOT Office\Director_4\Project\17 91 Alignment.dgn

USER NAME = \$USERS	DESIGNED -	REVISED -
PLOT SCALE = 1:200	DRAWN -	REVISED -
PLOT DATE = 10/28/2021	CHECKED -	REVISED -
	DATE -	REVISED -

**STATE OF ILLINOIS
 DEPARTMENT OF TRANSPORTATION**

IL 17/IL 91			
ALIGNMENT, TIES, AND BENCHMARKS			
SCALE:	SHEET	OF SHEETS	STA. TO STA.

F.A.P. RTE.	SECTION	COUNTY	TOTAL SHEETS	SHEET NO.
643	[[11B]BR-1]TR	STARK	6	5
CONTRACT NO. 68G76				
ILLINOIS FED. AID PROJECT				

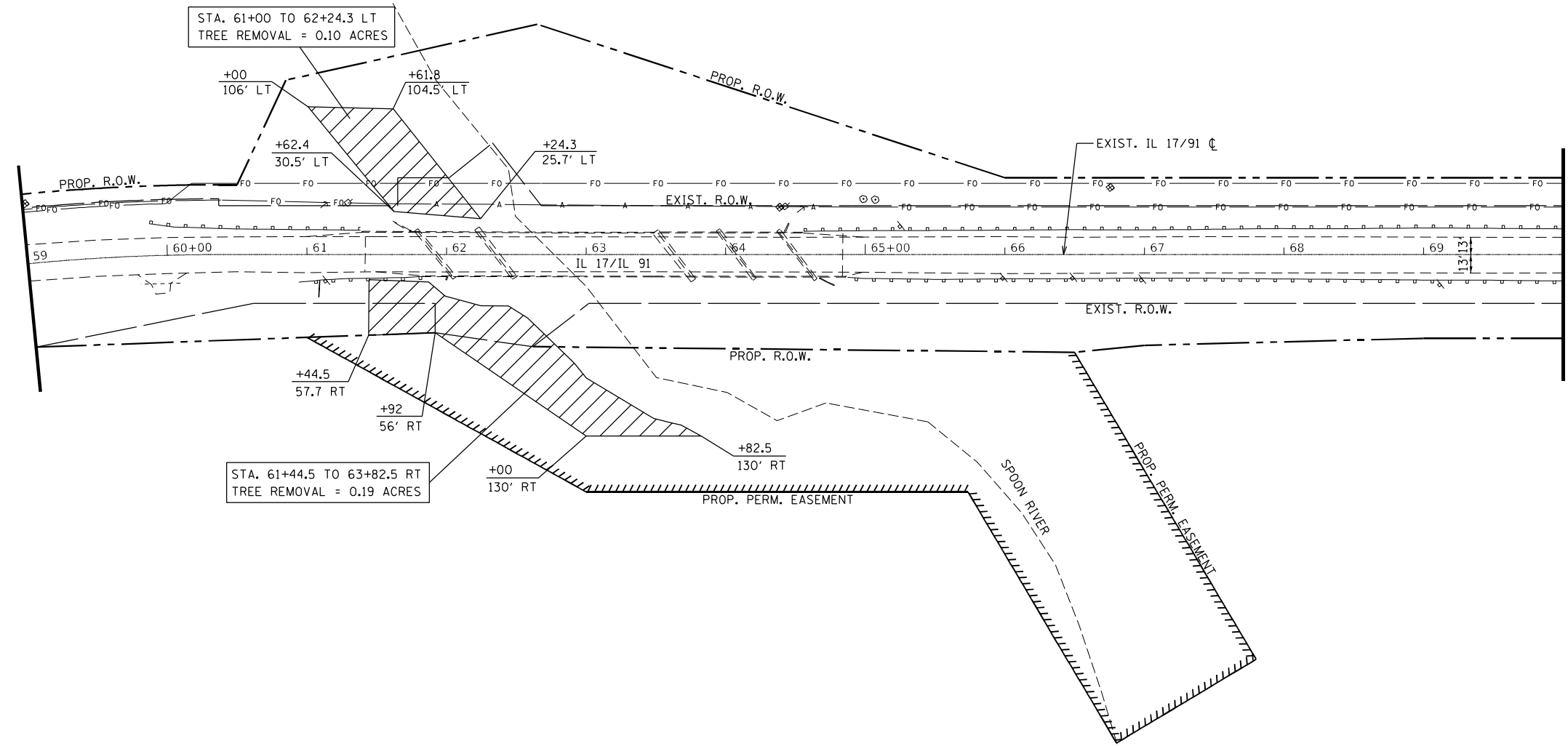

LEGEND

 TREE REMOVAL, ACRES

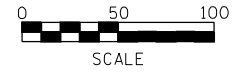

MODEL: Default
 FILE NAME: p:\ultra-cw-beachy.com\PIV\DOT\Documents\DOT Office\District 4\Projects\ID4_68G76\CADD\as\CAD\sheet\68G76\IL 17 91 Removal Plan 2.dgn

USER NAME = \$USERS	DESIGNED -	REVISED -
	DRAWN -	REVISED -
PLOT SCALE = 1:100	CHECKED -	REVISED -
PLOT DATE = 10/28/2021	DATE -	REVISED -

**STATE OF ILLINOIS
DEPARTMENT OF TRANSPORTATION**

**IL 17/L 91 OVER SPOON RIVER
REMOVAL PLAN**

SCALE: SHEET OF SHEETS STA. TO STA.

F.A.P. RTE.	SECTION	COUNTY	TOTAL SHEETS	SHEET NO.
643	[(11B)BR-1]TR	STARK	6	6
CONTRACT NO. 68G76				
ILLINOIS FED. AID PROJECT				