

STATE OF ILLINOIS  
DEPARTMENT OF TRANSPORTATION

*D6 DRAINAGE LOGAN CO 2021-1		F.A.I. RTE.	SECTION	COUNTY	TOTAL SHEETS	SHEET NO.
55/155				LOGAN	10	1
				ILLINOIS	CONTRACT NO. 72N19	

FOR INDEX OF SHEETS, SEE SHEET NO. 2

**PROPOSED IMPROVEMENTS**

FAI 55, 155 (I 55, 155)  
SECTION: D6 DRAINAGE LOGAN CO 2021-1  
PROJECT: STATE DRAINAGE LOGAN CO.

D-96-072-21

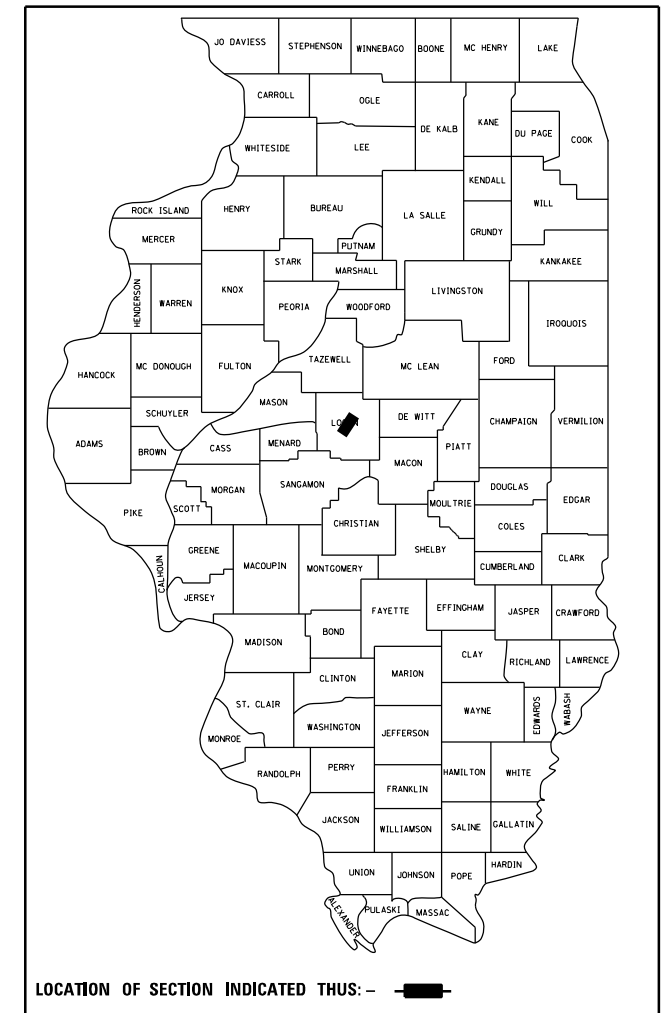

I 55 (2019)  
ADT = 16,700  
SU = 600  
MU = 4,200

C-96-145-21

R 2 W

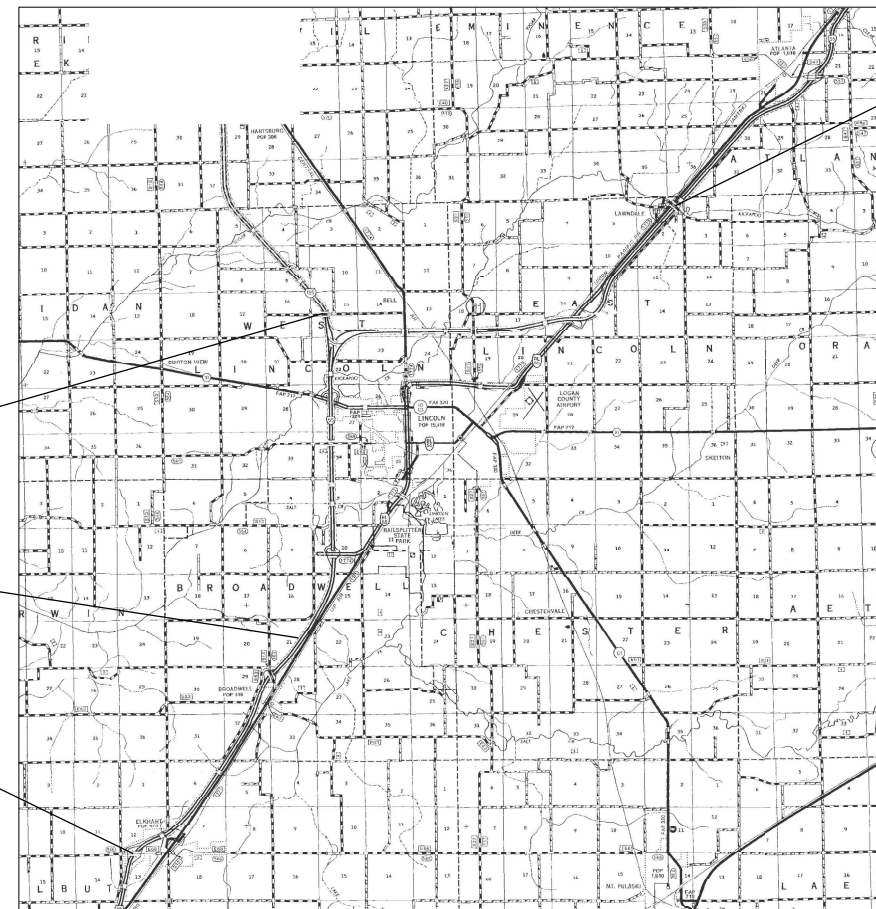

END PROJECT  
I 55 STA.  
849+76.96

T 20 N

END PROJECT  
I 155 STA.  
2+14.00

STA. EQU  
905+00.00bk  
= 46+76.85ah

BEGIN PROJECT  
I 55 STA.  
611+56.07

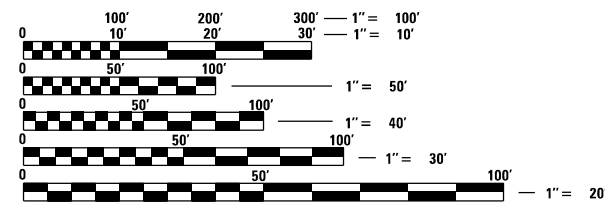

FULL SIZE PLANS HAVE BEEN PREPARED USING STANDARD ENGINEERING SCALES. REDUCED SIZED PLANS WILL NOT CONFORM TO STANDARD SCALES. IN MAKING MEASUREMENTS ON REDUCED PLANS, THE ABOVE SCALES MAY BE USED.

J.U.L.I.E.  
JOINT UTILITY LOCATION INFORMATION FOR EXCAVATION  
1-800-892-0123  
OR 811

PROJECT ENGINEER : STEVE BERAN - (217)782-7314  
PROJECT MANAGER : TIM SHARP - (217)524-9160

CONTRACT NO. 72N19

STATE OF ILLINOIS  
DEPARTMENT OF TRANSPORTATION

SUBMITTED October 20 20 21

*John P. Myer*  
REGION FOUR ENGINEER

December 10 20 21  
ENGINEER OF DESIGN AND ENVIRONMENT

December 10 20 21  
*Stephen M. Lewis*  
DIRECTOR OF HIGHWAYS PROJECT IMPLEMENTATION 2



PRINTED BY THE AUTHORITY OF THE STATE OF ILLINOIS

## INDEX OF SHEETS

SHEET NO.	DESCRIPTION
1.	COVER SHEET
2.	INDEX OF SHEETS, STANDARDS, GENERAL NOTES & SIGNATURE
3.	SUMMARY OF QUANTITIES
4.	PROJECT LOCATION MAP
5.	SCHEDULES
6-10.	EXISTING CULVERT PLANS

## STANDARDS

STANDARD NO.	DESCRIPTION
701101-05	OFF-RD OPERATIONS, MULTILANE 15' (4.5m) TO 24" (600mm) FROM PAVEMENT EDGE
701106-02	OFF-RD OPERATIONS, MULTILANE, MORE THAN 15' (4.5m) AWAY
701400-11	APPROACH TO LANE CLOSURE, FREEWAY / EXPRESSWAY
701406-13	LANE CLOSURE FREEWAY / EXPRESSWAY, DAY OPERATIONS ONLY
701901-08	TRAFFIC CONTROL DEVICES
000001-08	STANDARD SYMBOLS, ABBREVIATIONS AND PATTERNS
001006	DECIMAL OF AN INCH AND OF A FOOT

STATE OF ILLINOIS DEPARTMENT OF TRANSPORTATION DIVISION OF HIGHWAYS DISTRICT 6	
EXAMINED	October 29 20 21
	
ENGINEER OF OPERATIONS	
EXAMINED	October 29 20 21
	
ENGINEER OF PROJECT IMPLEMENTATION	
EXAMINED	October 29 20 21
	
ENGINEER OF PROGRAM DEVELOPMENT	

REV. - MS

FILE NAME =	USER NAME = sharptd	DESIGNED -	REVISED -	<b>STATE OF ILLINOIS DEPARTMENT OF TRANSPORTATION</b>	<b>INDEX OF SHEETS, STANDARDS GENERAL NOTES, SIGNATURES</b>	SCALE: _____ SHEET _____ OF _____ SHEETS STA. _____ TO STA. _____	*D6 DRAINAGE LOGAN CO 2021-1
S:\CONTRMAINT_CAD\72N19 - FAI 55,155 (1-5,155) - DRAINAGE - Logan Co-11-21-2022\PLAN	DRW						F.A.I. RTE. SECTION COUNTY TOTAL SHEETS SHEET NO.
Default	PLOT SCALE = 40.0000' / in.	CHECKED -	REVISED -				55,155 * LOGAN 10 2
	PLOT DATE = 10/25/2021	DATE -	REVISED -				CONTRACT NO. 72N19
							ILLINOIS FED. AID PROJECT



CULVERT #9  
 STA 2+14 (I-155)  
 STA 601+00 (ITR-87)

CULVERT #8  
 STA. 2+14.00 (I-155)  
 STA. 599+00 (TR-87)

CULVERT #4  
 STA. 15+80 (I-155)  
 STA 25+94.04 (I-55)

CULVERT #3  
 STA 867+32.79 (I-55)  
 STA 48+75 (CH-22)

CULVERT #2  
 STA 611+56.07 (I-55)  
 STA. 51+31 (CH-10)

CULVERT #1  
 STA 611+56.07 (I-55)  
 STA 48+71 (CH-10)

CULVERT #7  
 STA 849+76+96 (I-55)  
 STA 851+30 (TR-244)

CULVERT #6  
 STA 700+89.92 (I-55)  
 STA 702+18 (I-55 BUS)

CULVERT #5  
 STA 590+75.03 (I-55)  
 STA 48+83 (1250th)

STA EQ  
 905+00.00bk  
 = 46+76.96ah



FILE NAME =	USER NAME = sharptd	DESIGNED -	REVISED -
S:\CONTRMAINT_CAD\72N19 - FAI 55, 155 (I-55, 155) - DRAINAGE - Logan Co-11-21-2022\PLAN		DRAWN -	REVISED -
Default	PLOT SCALE = 40.0000' / in.	CHECKED -	REVISED -
	PLOT DATE = 10/25/2021	DATE -	REVISED -

**STATE OF ILLINOIS  
 DEPARTMENT OF TRANSPORTATION**

**LOCATION MAP**

SCALE: \_\_\_\_\_ SHEET \_\_\_\_\_ OF \_\_\_\_\_ SHEETS STA. \_\_\_\_\_ TO STA. \_\_\_\_\_

• FAI 55, 155 (I 55, 155)

F.A.I. RTE.	SECTION	COUNTY	TOTAL SHEETS	SHEET NO.
55,155	*	LOGAN	10	4
CONTRACT NO. 72N19				
ILLINOIS FED. AID PROJECT				

**CURED-IN PLACE PIPE LINER**

Key Route Sta.	ROUTE	Alt Route Sta.	ROUTE	MM	Lane/Location	Location Description	Pipe Type	Pipe Size (in.)	Pipe Length (Ft)
611+56.07	I-55	48+71	CH-10	114.6	SB	054-0038 EXIT 115 ELKHART	CMP	36	332
611+56.07	I-55	51+31	CH-10	114.6	NB	054-0038 EXIT 115 ELKHART	CMP	36	270
867+32.79	I-55	48+75	CH-22	119.5	NB	054-0039 EXIT 119 BROADWELL	CMP	36	243
15+80	I-155	25+94.04	I-55	126.9	SB	054-0050 & -0051 TRI-LEVEL W/ I-155 NB; I-55 SB; I-155 SB to I-55 NB	CMP	36	356
590+75.03	I-55	48+83	1250th	130.2	SB	054-0059 1250th AVE	CMP	36	160
700+89.92	I-55	702+18	I-55 BUS	132.4	NB	054-0060 & -0061 EXIT 133 I-55 OVER BUS. 55 & LAWNSDALE	CMP	36	416
849+76.96	I-55	851+30	TR-244	135.7	NB	054-0062 @ LAWNSDALE	CMP	36	228
2+14.00	I-155	599+00	TR-87	0.9	NB	054-0071 OVERHEAD STR. 1850th ST.	CMP	36	120
2+14.00	I-155	601+00	TR-87	0.9	SB	054-0071 OVERHEAD STR. 1850th ST.	CMP	36	126
								TOTAL:	2251

• D6 DRAINAGE LOGAN CO 2021-1

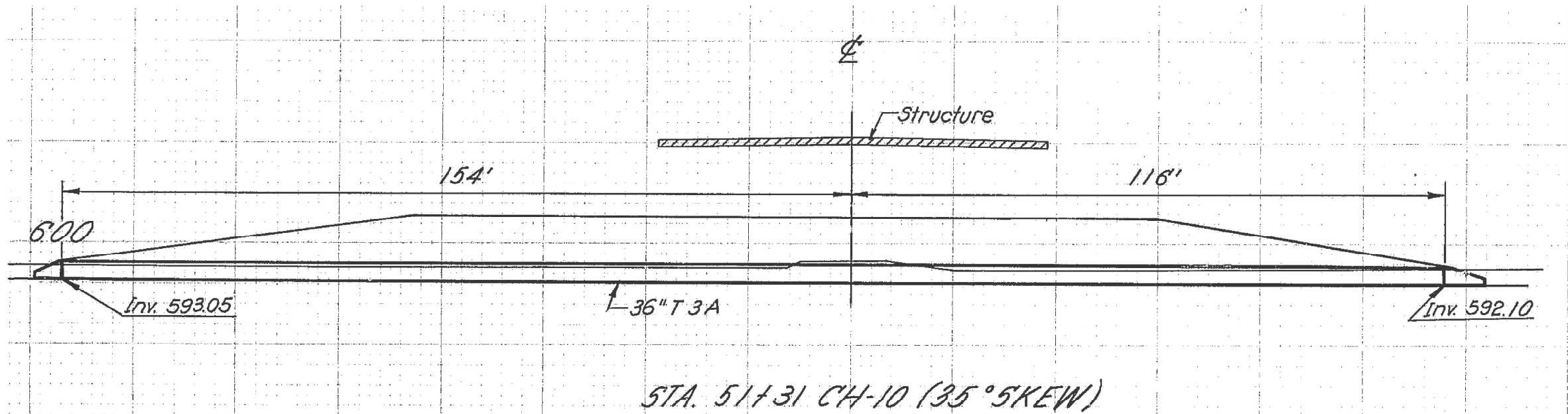
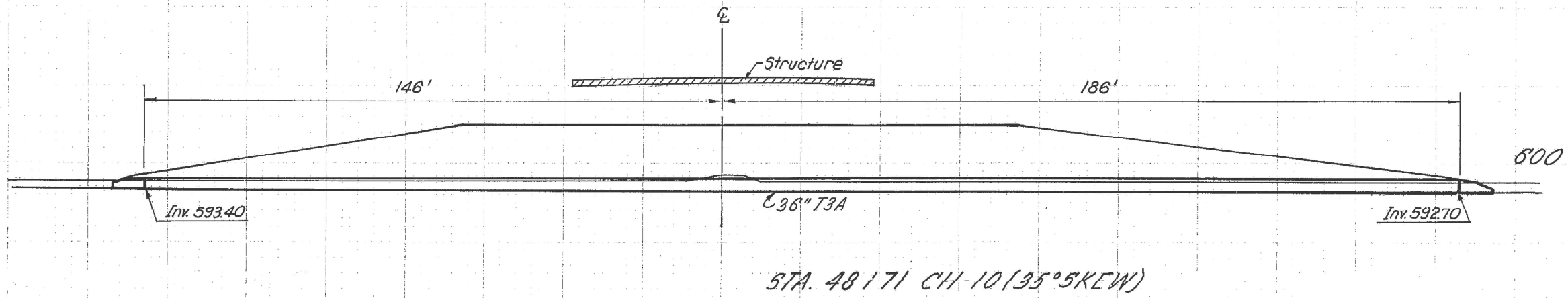

FOR INFORMATIONAL PURPOSES ONLY

FILE NAME =	USER NAME = sharptd	DESIGNED -	REVISED -
S:\CONTRMAINT_CAD\72N19 - FAI 55,155 (1-5,155) - DRAINAGE - Logan Co-11-21-2022\PLAN	5,155) - DRAINAGE - Logan Co-11-21-2022\PLAN	DRAWN	REVISED -
Default	PLOT SCALE = 20.0000' / in.	CHECKED -	REVISED -
	PLOT DATE = 10/25/2021	DATE -	REVISED -

STATE OF ILLINOIS  
DEPARTMENT OF TRANSPORTATION

EXISTING CULVERT PLAN  
SCALE: \_\_\_\_\_ SHEET \_\_\_\_\_ OF \_\_\_\_\_ SHEETS STA. \_\_\_\_\_ TO STA. \_\_\_\_\_

*D6 DRAINAGE LOGAN CO 2021-1				
F.A.I. RTE.	SECTION	COUNTY	TOTAL SHEETS	SHEET NO.
55,155	*	LOGAN	10	6
CONTRACT NO. 72N19				
ILLINOIS FED. AID PROJECT				

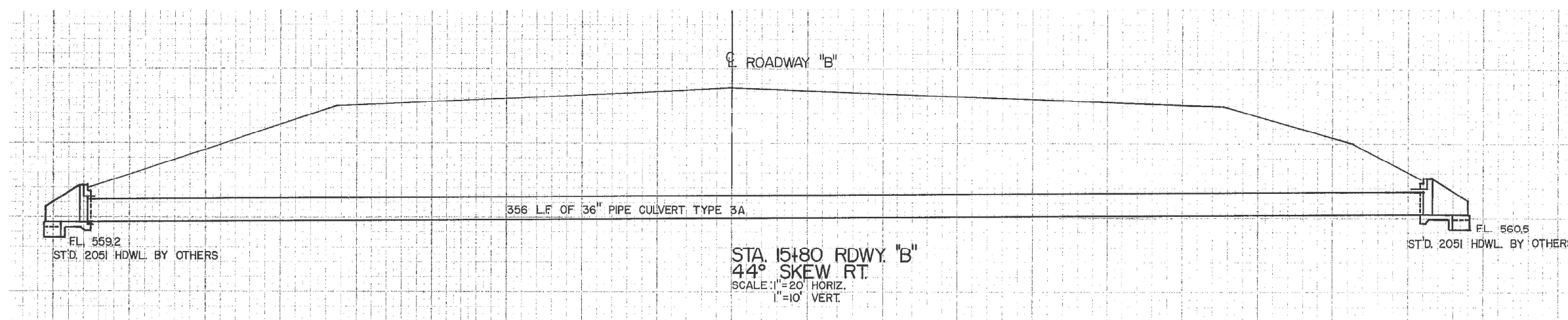
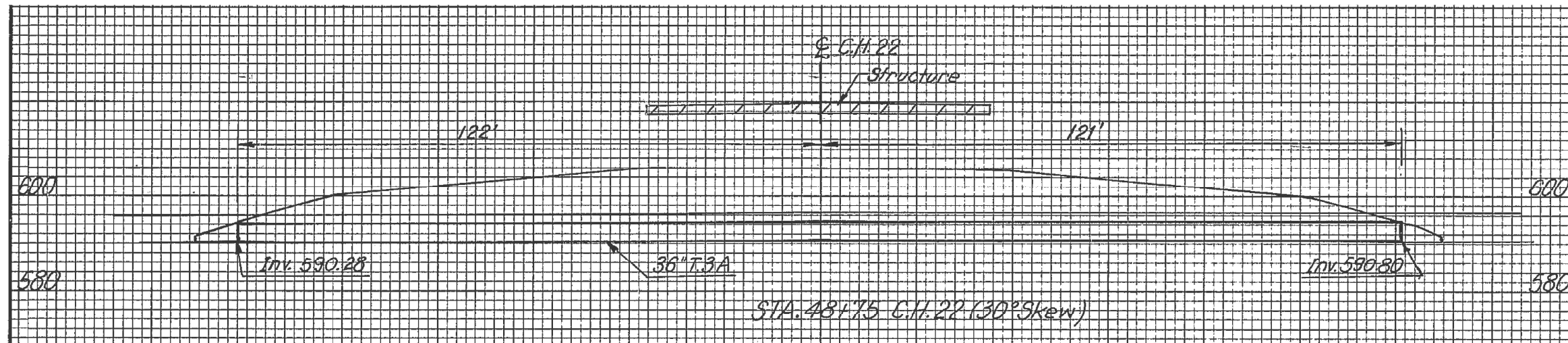

FOR INFORMATIONAL PURPOSES ONLY

FILE NAME =	USER NAME = sharptd	DESIGNED -	REVISED -
S:\CONTRMAINT_CAD\72N19 - FAI 55,155 (1-5,155) - DRAINAGE - Logan Co-(11-21-2022)\PLAN		DRAWN	REVISED -
Default	PLOT SCALE = 20.0000' / in.	CHECKED -	REVISED -
	PLOT DATE = 10/25/2021	DATE -	REVISED -

**STATE OF ILLINOIS  
DEPARTMENT OF TRANSPORTATION**

**EXISTING CULVERT PLAN**

SCALE: \_\_\_\_\_ SHEET \_\_\_\_\_ OF \_\_\_\_\_ SHEETS STA. \_\_\_\_\_ TO STA. \_\_\_\_\_

*D6 DRAINAGE LOGAN CO 2021-1				
F.A.I. RTE.	SECTION	COUNTY	TOTAL SHEETS	SHEET NO.
55,155	*	LOGAN	10	7
CONTRACT NO. 72N19				
ILLINOIS FED. AID PROJECT				

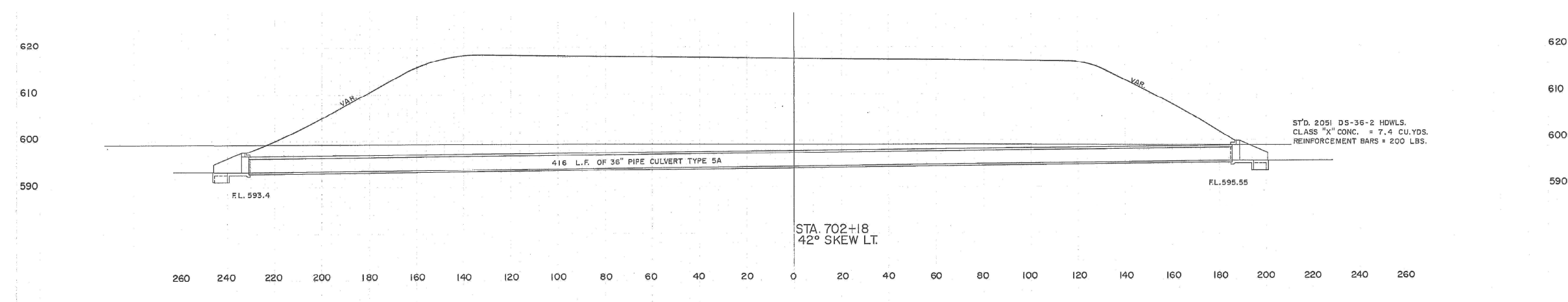
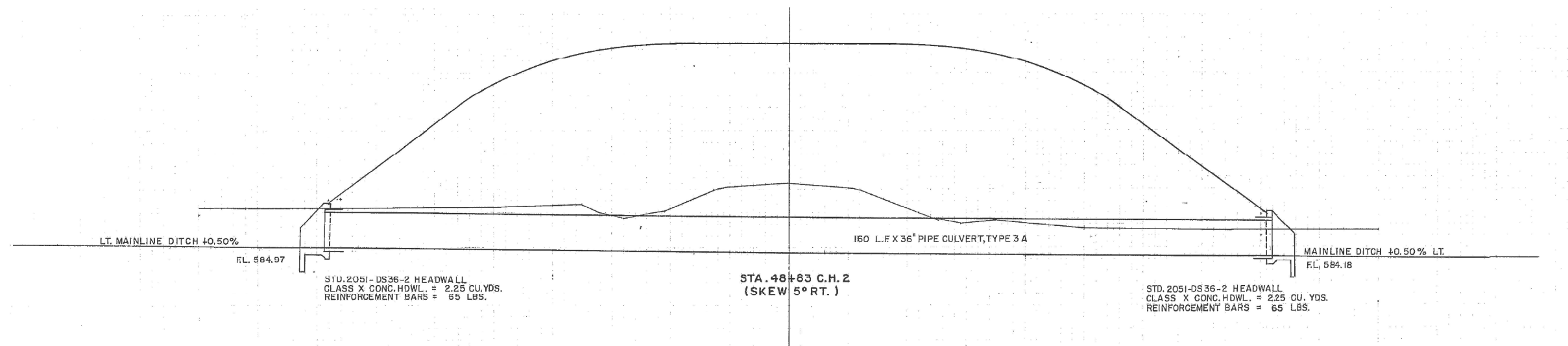

FOR INFORMATIONAL PURPOSES ONLY

FILE NAME = S:\CONTRMAINT_CAD\72N19 - FAI 55,155 (1-5,155) - DRAINAGE - Logan Co-11-21-2022\PLAN SHEET-6-10-plen.dgn	USER NAME = sharptd	DESIGNED - _____	REVISED - _____
Default	PLOT SCALE = 20.0000' / in.	CHECKED - _____	REVISED - _____
	PLOT DATE = 10/25/2021	DATE - _____	REVISED - _____

**STATE OF ILLINOIS  
DEPARTMENT OF TRANSPORTATION**

**EXISTING CULVERT PLAN**

SCALE: \_\_\_\_\_ SHEET \_\_\_\_\_ OF \_\_\_\_\_ SHEETS STA. \_\_\_\_\_ TO STA. \_\_\_\_\_

*D6 DRAINAGE LOGAN CO 2021-1				
F.A.I. RTE.	SECTION	COUNTY	TOTAL SHEETS	SHEET NO.
55,155	*	LOGAN	10	8
CONTRACT NO. 72N19				
ILLINOIS FED. AID PROJECT				



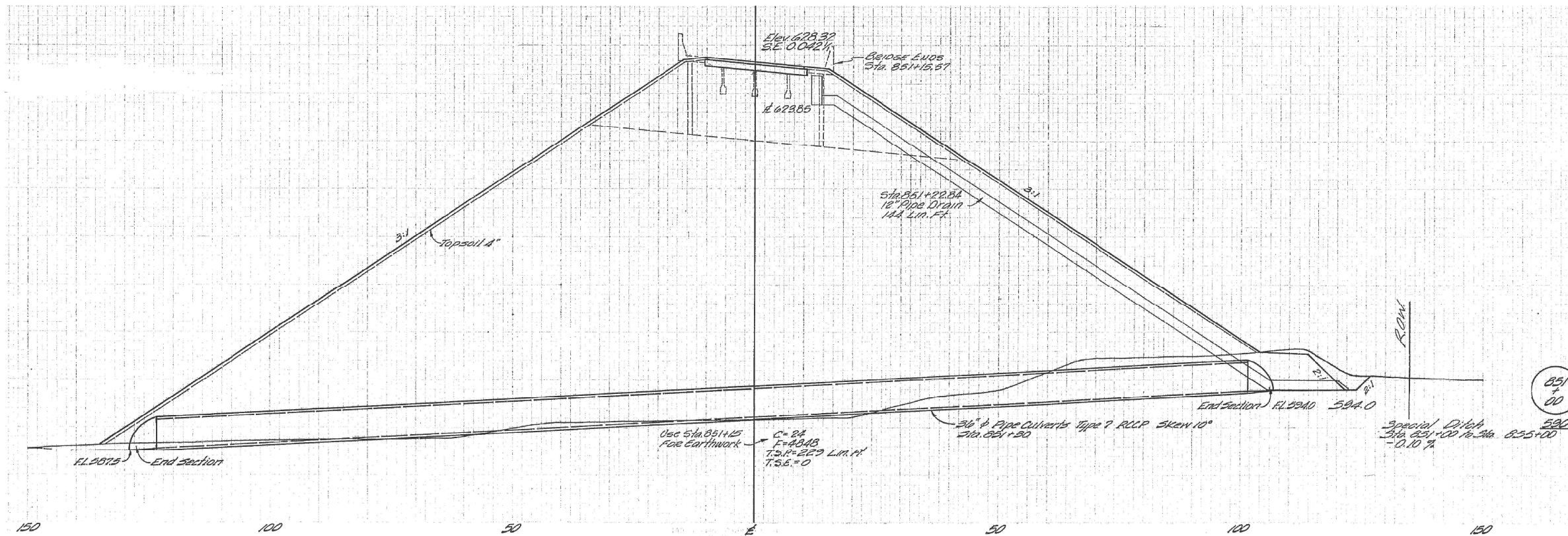

FOR INFORMATIONAL PURPOSES ONLY

FILE NAME =	USER NAME = sharptd	DESIGNED -	REVISED -
S:\CONTRMAINT_CAD\72N19 - FAI 55,155 (1-	5,155) - DRAINAGE - Logan Co-11-21-2022\PLAN	DRAWN	REVISED
Default	PLOT SCALE = 20.0000' / in.	CHECKED -	REVISED -
	PLOT DATE = 10/25/2021	DATE -	REVISED -

STATE OF ILLINOIS  
DEPARTMENT OF TRANSPORTATION

EXISTING CULVERT PLAN  
SCALE: \_\_\_\_\_ SHEET \_\_\_\_\_ OF \_\_\_\_\_ SHEETS STA. \_\_\_\_\_ TO STA. \_\_\_\_\_

*D6 DRAINAGE LOGAN CO 2021-1				
F.A.I. RTE.	SECTION	COUNTY	TOTAL SHEETS	SHEET NO.
55,155	*	LOGAN	10	9
CONTRACT NO. 72N19				
ILLINOIS FED. AID PROJECT				

STD. 2051 HDWL.  
DS-36-2 (45° SKEW)

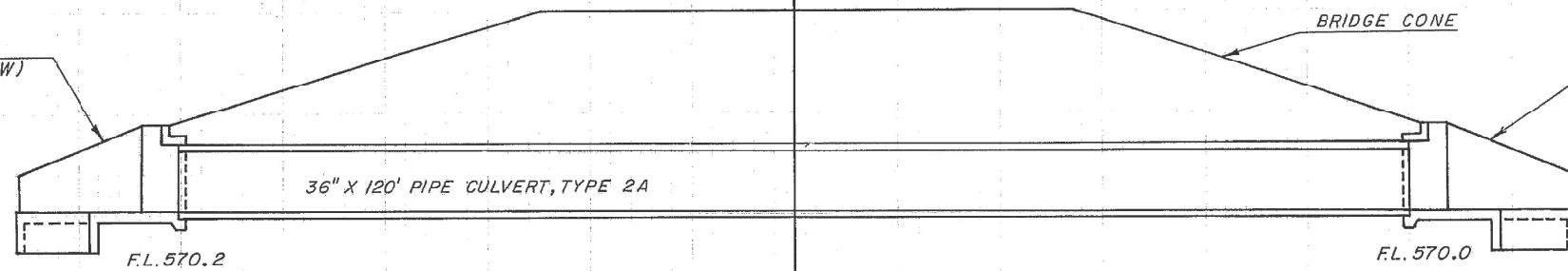

STD. 2051 HDWL.  
DS-36-2 (45° SKEW)

CLASS X CONCRETE HEADWALL = 3.7 CU. YDS.  
REINFORCEMENT BARS = 100 POUNDS

STA. 599+00 (T.R. 87)  
7°-49' SKEW RT.

CLASS X CONCRETE HEADWALL = 3.7 CU. YDS.  
REINFORCEMENT BARS = 100 POUNDS

STD. 2051 HDWL.  
DS-36-2 (45° SKEW)

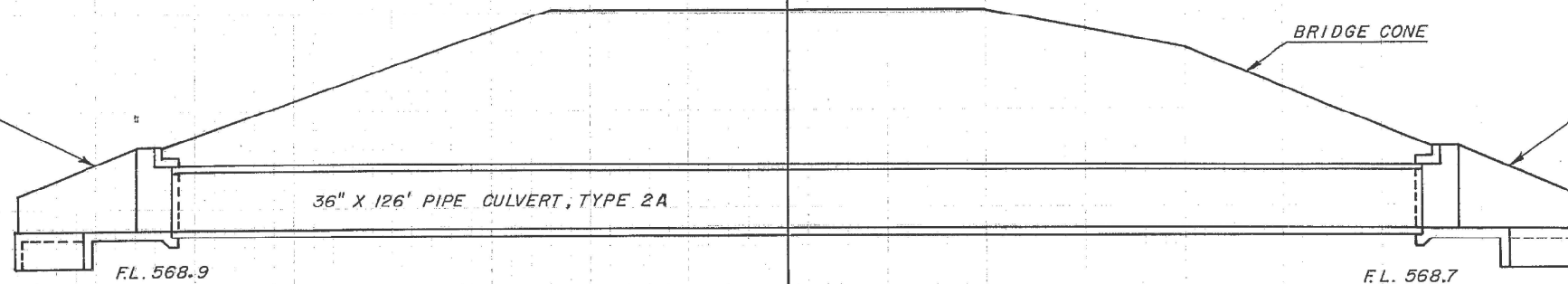

STD. 2051 HDWL.  
DS-36-2 (45° SKEW)

CLASS X CONCRETE HEADWALL = 3.7 CU. YDS.  
REINFORCEMENT BARS = 100 POUNDS

STA. 601+00 (T.R. 87)  
7°-49' SKEW RT.

CLASS X CONCRETE HEADWALL = 3.7 CU. YDS.  
REINFORCEMENT BARS = 100 POUNDS

FOR INFORMATIONAL PURPOSES ONLY

FILE NAME = S:\CONTRMAINT_CAD\72N19 - FAI 55,155 (1-5,155) - DRAINAGE - Logan Co-11-21-2022\PLAN SHEET\ht-6-10-plen.dgn	USER NAME = sharptd	DESIGNED - _____	REVISED - _____
	PLOT SCALE = 20.0000' / in.	CHECKED - _____	REVISED - _____
Default	PLOT DATE = 10/25/2021	DATE - _____	REVISED - _____

STATE OF ILLINOIS  
DEPARTMENT OF TRANSPORTATION

EXISTING CULVERT PLAN	
SCALE: _____	SHEET _____ OF _____ SHEETS
STA. _____	TO STA. _____

*D6 DRAINAGE LOGAN CO 2021-1				
F.A.I. RTE.	SECTION	COUNTY	TOTAL SHEETS	SHEET NO.
55,155	*	LOGAN	10	10
CONTRACT NO. 72N19				
ILLINOIS FED. AID PROJECT				