

PROPOSED CONSTRUCTION SEQUENCE FOR EACH PHASE

1. Provide seven (7) day notice to the Airport for coordination.
2. Install Temporary Fence.
3. Remove existing fence including backfill of post holes.
4. Clear and grade the new fence line in accordance with Section 162-3.2, Clearing Fence Line, of the Standard Specifications.
5. Install new fence.
6. Restore the disturbed areas.
7. Seeding and Mulching.
8. Remove Temporary Fencing including any additional restoration.

PHASING NOTES

1. Maintaining the security requirements of the Airport shall be a primary concern for the Contractor.
2. At no time shall there be unsupervised openings or gaps permitted in the Airport fence line.
3. The Contractor shall provide and install Temporary Fencing as required by the specifications.
4. The proposed phases are approximately 500' long.
5. No more than three consecutive phases may be constructed simultaneously.
6. The Contractor shall provide a seven (7) day notice prior to starting a new phase to allow Airport coordination with adjacent property owners.
7. The Contractor shall place Temporary Fencing at an offset that does not encroach on adjacent agricultural fields.
8. When working near Phases 4 and 5, the Contractor shall coordinate with the Drainage Improvements construction project through the Resident Engineer.
9. When working near Phases 13 and 14, the Contractor shall coordinate with the Airport Rescue & Fire Fighting (ARFF) Facility construction project through the Resident Engineer.
10. Phase 14 will require Contractor coordination with the Federal Aviation Administration (FAA) through the Resident Engineer.
11. Phases 30, 31 and 32 will not require the use of Temporary Fencing.

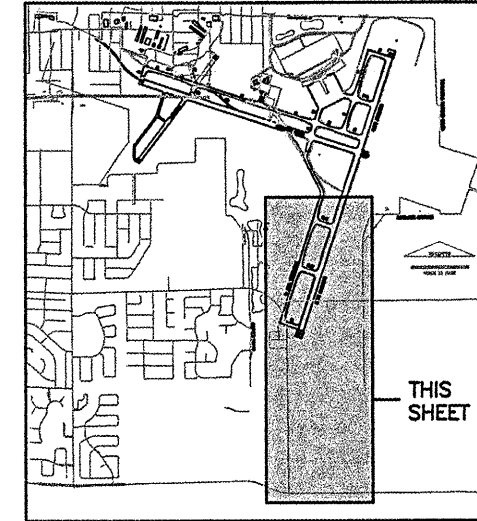

KEYMAP

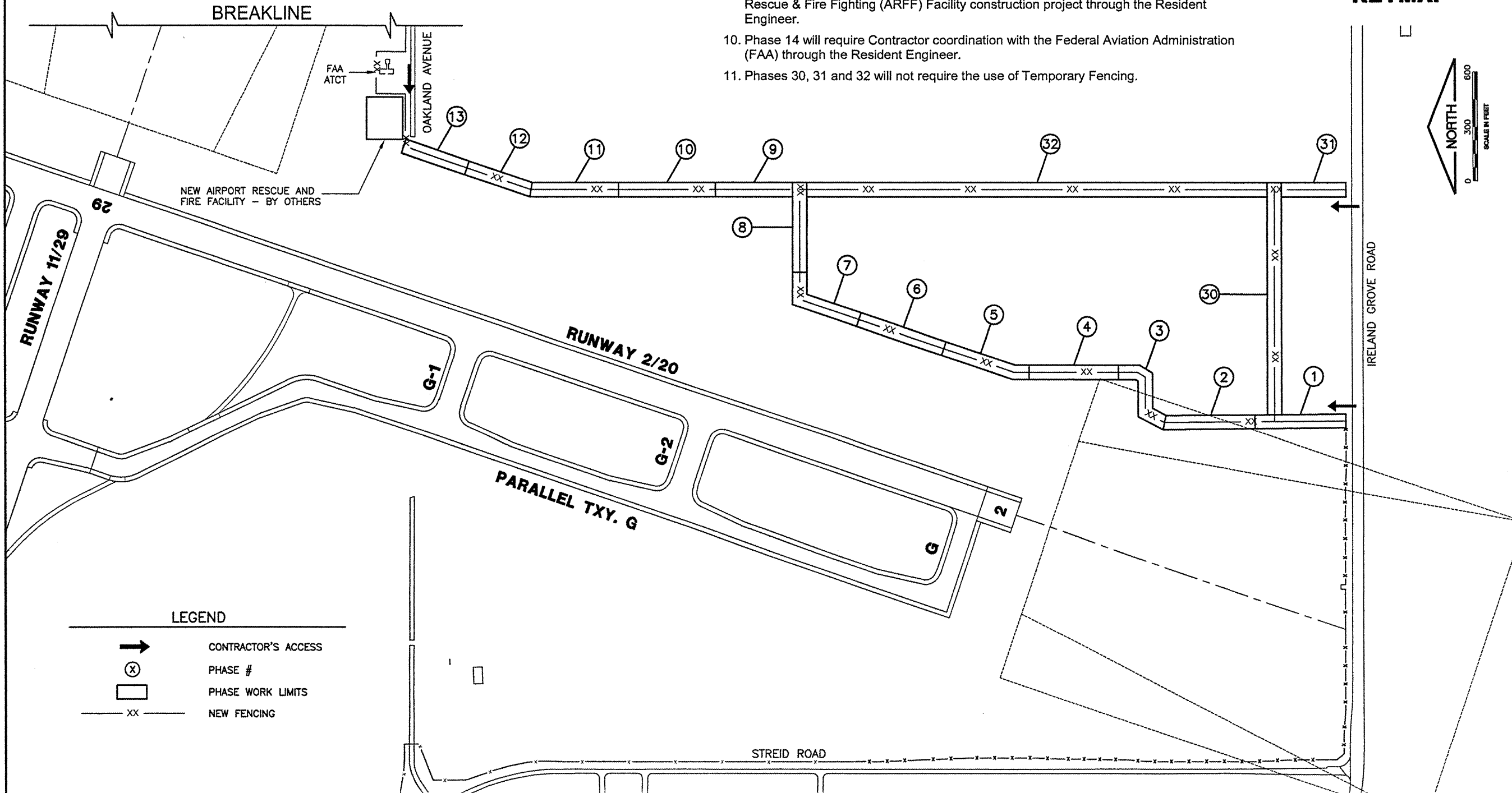
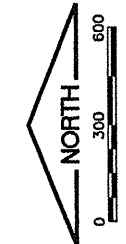

K:\Bloomington\0808503\Draw\Sheets
 FILE: CAP-1.dwg
 UPDATE BY: Dave Allen
 PLOT DATE: 1/5/2009 3:00 PM
 AERIAL
 BASE_EXISTGEO
 KEYMAP

BL065

REVISIONS		
NUMBER	BY	DATE

0 1 2
 THIS BAR IS EQUAL TO 2'
 AT FULL SCALE (34X22).

BLOOMINGTON-NORMAL AIRPORT AUTHORITY
 CENTRAL ILLINOIS REGIONAL AIRPORT
 BLOOMINGTON, ILLINOIS

UPGRADE PERIMETER FENCE 3
 CONSTRUCTION ACTIVITY PLAN 1

© copyright cmt, inc.
CMT
 CRAWFORD, MURPHY & TILLY, INC.
 CONSULTING ENGINEERS
 License No. 184-000613

DESIGN BY:	RLV
DRAWN BY:	CMT
CHECKED BY:	RLV
APPROVED BY:	RLV
DATE:	01/1/2009
JOB No:	0808503
IL PROJ NO.	BMI-XXXX
AIP PROJ NO.	XXX
SHEET	4 OF 13 SHEETS