

**BL065**

REVISIONS		
NUMBER	BY	DATE

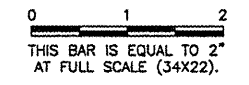

**BLOOMINGTON-NORMAL AIRPORT AUTHORITY**  
**CENTRAL ILLINOIS REGIONAL AIRPORT**  
**BLOOMINGTON, ILLINOIS**

**UPGRADE PERIMETER FENCE 3**  
**GATE PLAN AND SCHEDULE**

© Copyright CMT, Inc.  
**CMT**  
 CRAWFORD, MURPHY & TILLY, INC.  
 CONSULTING ENGINEERS  
 License No. 184-000613

DESIGN BY:	RLV
DRAWN BY:	CMT
CHECKED BY:	REV
APPROVED BY:	REV
DATE:	01/11/2009
JOB No:	0808503
IL PROJ NO.	BMI-XXXX
AIP PROJ NO.	XXX
SHEET 10 OF 13 SHEETS	

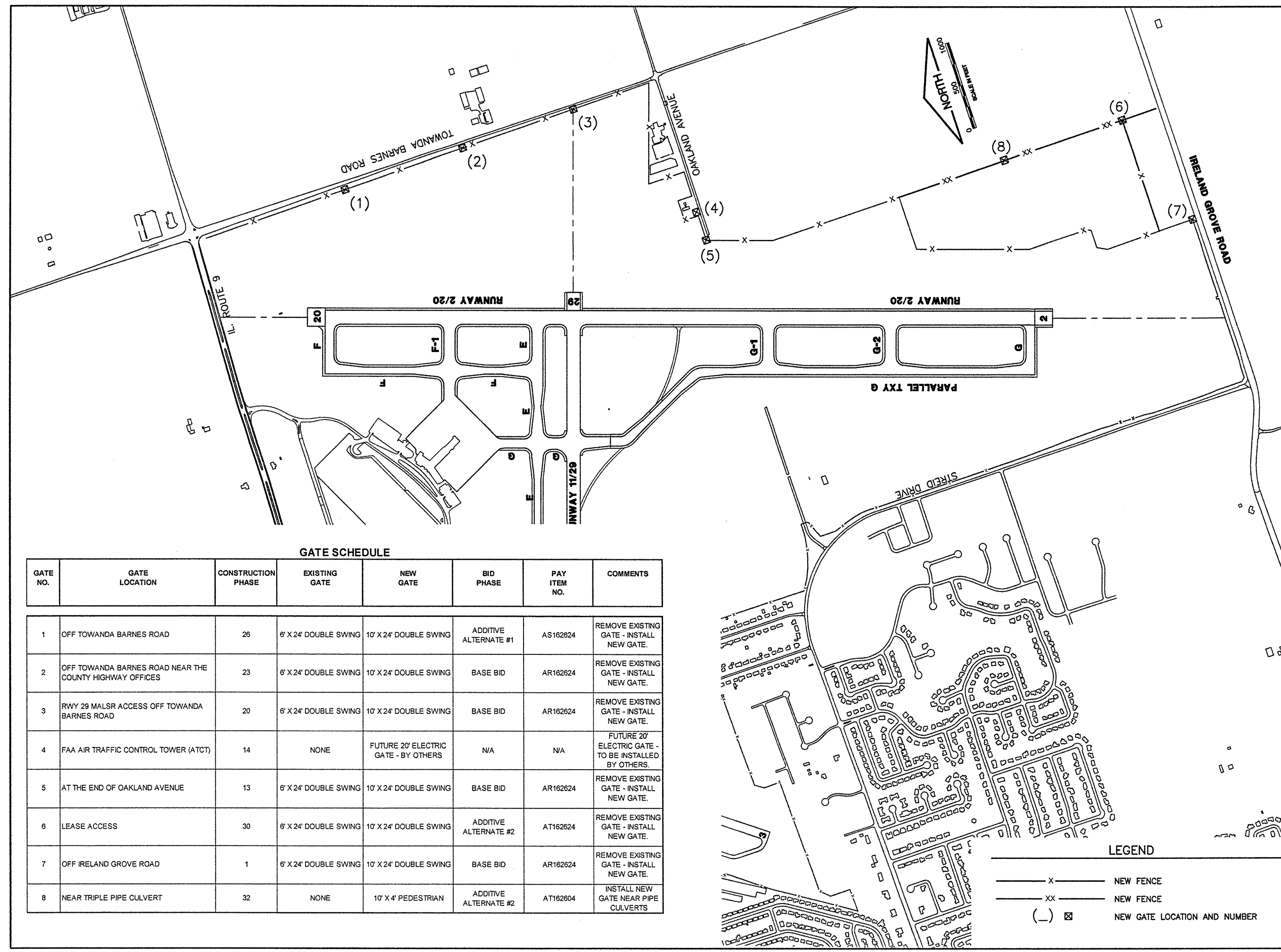

**GATE SCHEDULE**

GATE NO.	GATE LOCATION	CONSTRUCTION PHASE	EXISTING GATE	NEW GATE	BID PHASE	PAY ITEM NO.	COMMENTS
1	OFF TOWANDA BARNES ROAD	26	6' X 24' DOUBLE SWING	10' X 24' DOUBLE SWING	ADDITIVE ALTERNATE #1	AS162624	REMOVE EXISTING GATE - INSTALL NEW GATE.
2	OFF TOWANDA BARNES ROAD NEAR THE COUNTY HIGHWAY OFFICES	23	6' X 24' DOUBLE SWING	10' X 24' DOUBLE SWING	BASE BID	AR162624	REMOVE EXISTING GATE - INSTALL NEW GATE.
3	RWY 29 MALSR ACCESS OFF TOWANDA BARNES ROAD	20	6' X 24' DOUBLE SWING	10' X 24' DOUBLE SWING	BASE BID	AR162624	REMOVE EXISTING GATE - INSTALL NEW GATE.
4	FAA AIR TRAFFIC CONTROL TOWER (ATCT)	14	NONE	FUTURE 20' ELECTRIC GATE - BY OTHERS	N/A	N/A	FUTURE 20' ELECTRIC GATE - TO BE INSTALLED BY OTHERS.
5	AT THE END OF OAKLAND AVENUE	13	6' X 24' DOUBLE SWING	10' X 24' DOUBLE SWING	BASE BID	AR162624	REMOVE EXISTING GATE - INSTALL NEW GATE.
6	LEASE ACCESS	30	6' X 24' DOUBLE SWING	10' X 24' DOUBLE SWING	ADDITIVE ALTERNATE #2	AT162624	REMOVE EXISTING GATE - INSTALL NEW GATE.
7	OFF IRELAND GROVE ROAD	1	6' X 24' DOUBLE SWING	10' X 24' DOUBLE SWING	BASE BID	AR162624	REMOVE EXISTING GATE - INSTALL NEW GATE.
8	NEAR TRIPLE PIPE CULVERT	32	NONE	10' X 4' PEDESTRIAN	ADDITIVE ALTERNATE #2	AT162604	INSTALL NEW GATE NEAR PIPE CULVERTS

**LEGEND**

— X —	NEW FENCE
— XX —	NEW FENCE
( ) X	NEW GATE LOCATION AND NUMBER