

POLYMERIZED HOT-MIX ASPHALT SURFACE COURSE,
MIX "F", N90, 1-3/4"
POLYMERIZED HOT-MIX ASPHALT BINDER COURSE,
IL-19.0, N90, 2-1/4"
HOT-MIX ASPHALT SURFACE REMOVAL, 4"

HOT-MIX ASPHALT SURFACE COURSE,
MIX "D", N70, 1-1/2"
HOT-MIX ASPHALT BINDER COURSE,
IL-19.0, N70, 2-1/4"
HOT-MIX ASPHALT SURFACE REMOVAL, 3-3/4"

POLYMERIZED HOT-MIX ASPHALT SURFACE COURSE,
MIX "F", N90, 1-3/4"
POLYMERIZED HOT-MIX ASPHALT BINDER COURSE,
IL-19.0, N90, 2-1/4"
HOT-MIX ASPHALT SURFACE REMOVAL, 4"

HOT-MIX ASPHALT SURFACE COURSE,
MIX "D", N70, 1-1/2"
HOT-MIX ASPHALT BINDER COURSE,
IL-19.0, N70, 2-1/4"
HOT-MIX ASPHALT SURFACE REMOVAL, 3-3/4"

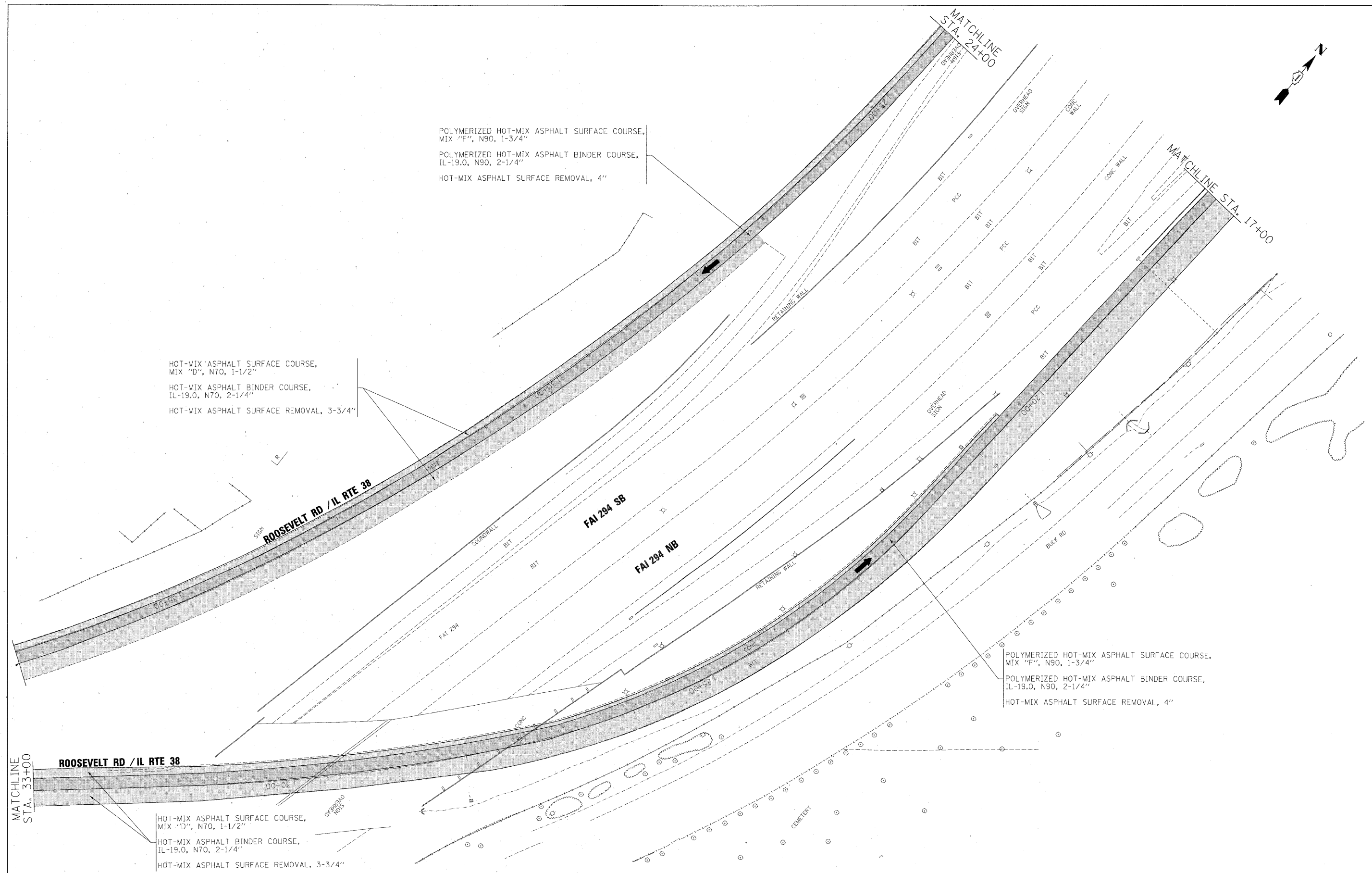

FILE NAME = ...prpln_ABC.C2.138.pln.03.dgn	DESIGNED - AJP	REVISED -
USER NAME = tblank	DRAWN - TMB	REVISED -
PLOT DATE = 1/25/2010	CHECKED - JMM	REVISED -
	DATE - 1/25/10	REVISED -

benesch

**STATE OF ILLINOIS
DEPARTMENT OF TRANSPORTATION**

**ROADWAY PLAN
ROOSEVELT ROAD/IL RTE 38**

SCALE: 1"=50' SHEET NO. 15 OF 17 SHEETS STA. TO STA.

F.A.I. RTE.	SECTION	COUNTY	TOTAL SHEETS	SHEET NO.
290	(3435, ETC., 3838)RS-5	COOK	264	62
FED. ROAD DIST. NO.			ILLINOIS FED. AID PROJECT	
			CONTRACT NO. 60C52	