

**EASTBOUND**  
STA 484+49 TO STA 490+41

**I-290 MAINTENANCE OF TRAFFIC**  
**TYPICAL SECTION**  
STAGE 2

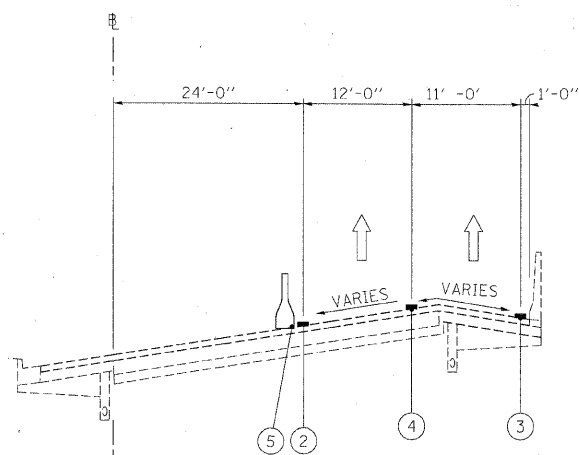

**EASTBOUND**  
STA 490+41 TO STA 494+42

**I-290 MAINTENANCE OF TRAFFIC**  
**TYPICAL SECTION**  
STAGE 2

BRIDGE OMISSION: STA 490+41 to STA 494+42

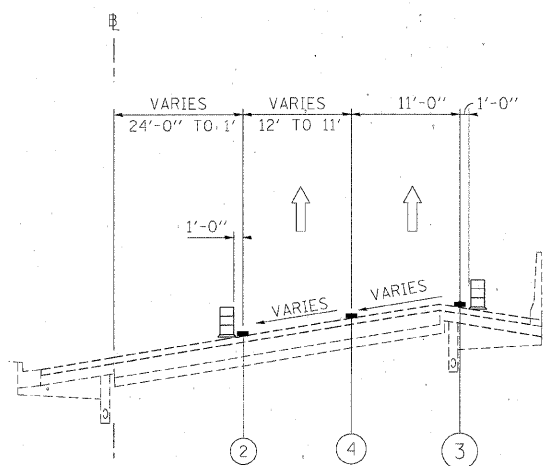

**EASTBOUND**  
STA 494+42 TO STA 505+97

**I-290 MAINTENANCE OF TRAFFIC**  
**TYPICAL SECTION**  
STAGE 2

- LEGEND**
- ① EXISTING PAVEMENT MARKING
  - ② WET REFLECTIVE TEMPORARY TAPE, - TYPE III, 4 INCH (YELLOW)
  - ③ WET REFLECTIVE TEMPORARY TAPE, - TYPE III, 4 INCH (WHITE)
  - ④ WET REFLECTIVE TEMPORARY TAPE, - TYPE III, 5 INCH (WHITE)
  - ⑤ TEMPORARY PAVEMENT MARKING - LINE 6" (YELLOW) (ON BARRIER)
  - ⑥ TEMPORARY PAVEMENT MARKING - LINE 6" (WHITE) (ON BARRIER)
  - ⑦ WET REFLECTIVE TEMPORARY TAPE - TYPE III, 8 INCH (WHITE)
  - TEMPORARY CONCRETE BARRIER
  - TYPE II BARRIER, DRUM, OR VERTICAL BARRICADE WITH STEADY BURN MONODIRECTIONAL LIGHT
  - WORK ZONE

FILE NAME =	DESIGNED - AJP	REVISED -
...NrpIn ARC C2.m.mot.t.p.st.2.01.dgn	DRAWN - TMB	REVISED -
USER NAME = tblank	CHECKED - JJT	REVISED -
PLOT DATE = 1/25/2010	DATE - 1/25/10	REVISED -

**benesch**

**STATE OF ILLINOIS**  
**DEPARTMENT OF TRANSPORTATION**

**MAINTENANCE OF TRAFFIC**  
**TYPICAL SECTION - STAGE 2**

SCALE: SHEET NO. 26 OF 62 SHEETS STA. TO STA.

F.A.I. RTE.	SECTION	COUNTY	TOTAL SHEETS	SHEET NO.
290	(3435, ETC., 3838RS-5	COOK	264	90
FED. ROAD DIST. NO. ILLINOIS FED. AID PROJECT			CONTRACT NO. 60G52	