

**FOR INFORMATION ONLY**

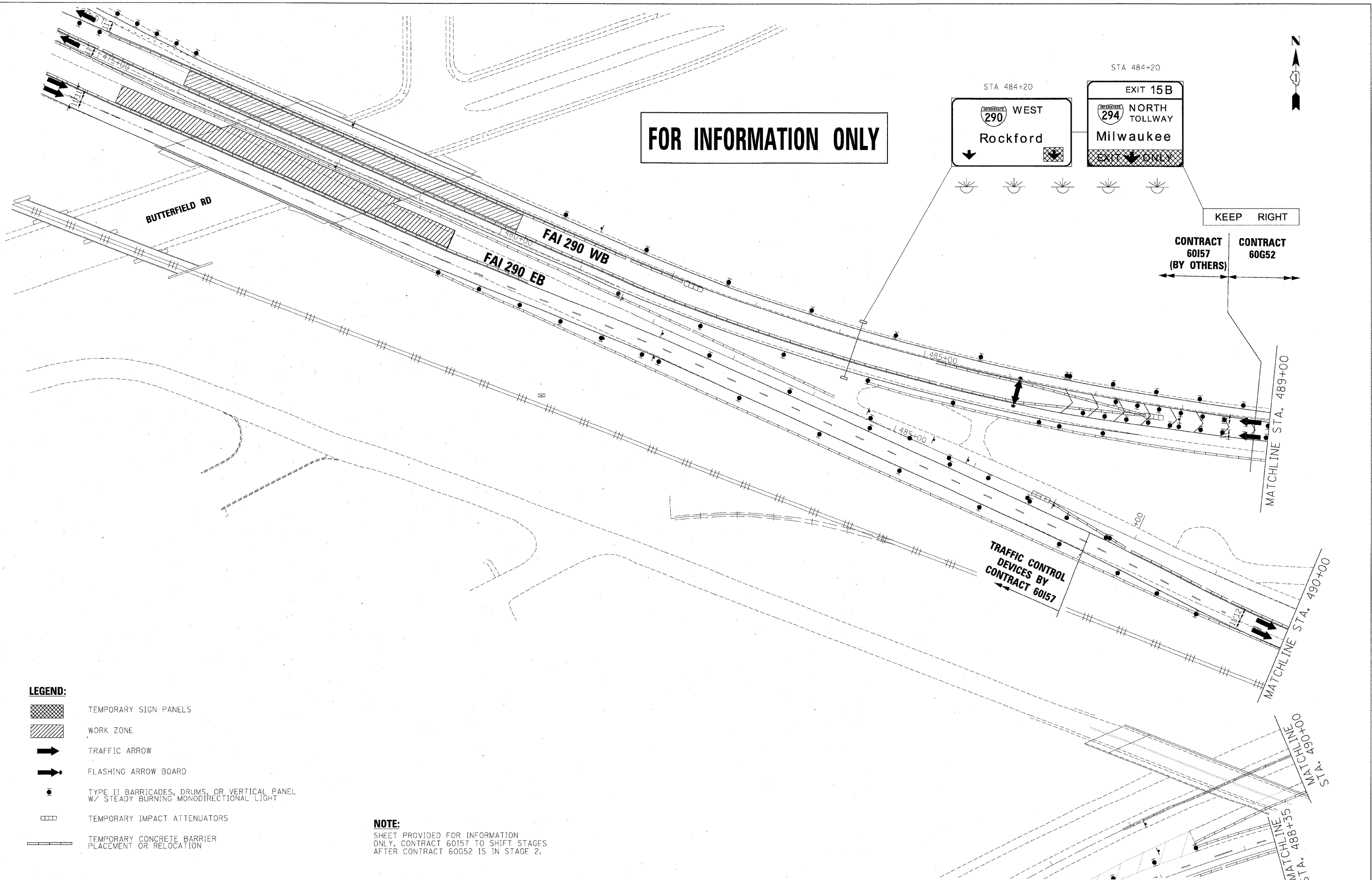

**LEGEND:**

- TEMPORARY SIGN PANELS
- WORK ZONE
- TRAFFIC ARROW
- FLASHING ARROW BOARD
- TYPE II BARRICADES, DRUMS, OR VERTICAL PANEL W/ STEADY BURNING MONODIRECTIONAL LIGHT
- TEMPORARY IMPACT ATTENUATORS
- TEMPORARY CONCRETE BARRIER PLACEMENT OR RELOCATION

**NOTE:**

SHEET PROVIDED FOR INFORMATION ONLY. CONTRACT 60157 TO SHIFT STAGES AFTER CONTRACT 60652 IS IN STAGE 2.

FILE NAME =	DESIGNED - AJP	REVISED -
...\\ppln\ABC\22\292_mot\ST_2_06B.dgn	DRAWN - TMB	REVISED -
USER NAME = tblank	CHECKED - JJT	REVISED -
PLOT DATE = 1/25/2010	DATE - 1/25/10	REVISED -

**benesch**

**STATE OF ILLINOIS  
DEPARTMENT OF TRANSPORTATION**

**MAINTENANCE OF TRAFFIC  
PLAN - STAGE 2**

SCALE: 1"=50' SHEET NO. 34 OF 62 SHEETS STA. TO STA.

F.A.I. RTE.	SECTION	COUNTY	TOTAL SHEETS	SHEET NO.
290	(3435, ETC., 3838)RS-5	COOK	264	98
FED. ROAD DIST. NO.			ILLINOIS FED. AID PROJECT	
			CONTRACT NO. 60652	