

LEGEND

- | | |
|--|--|
| ① THERMOPLASTIC PAVEMENT MARKING - LETTERS AND SYMBOLS (WHITE) | ⑭ POLYUREA PAVEMENT MARKING TYPE 1, LINE 4" (YELLOW EDGE LINE) |
| ② THERMOPLASTIC PAVEMENT MARKING - LINE 4" (WHITE EDGE LINE) | ⑮ POLYUREA PAVEMENT MARKING TYPE 1, LINE 8" (WHITE EDGE LINE) |
| ③ THERMOPLASTIC PAVEMENT MARKING - LINE 4" (YELLOW EDGE LINE) | ⑯ POLYUREA PAVEMENT MARKING TYPE 1, LINE 5" (WHITE 10' DASH, 30' SKIP) |
| ④ THERMOPLASTIC PAVEMENT MARKING - LINE 8" (WHITE EDGE LINE) | ⑰ POLYUREA PAVEMENT MARKING TYPE 1, LINE 12" (WHITE GORE DIAGONALS SPACED @ 30' CENTERS) |
| ⑤ THERMOPLASTIC PAVEMENT MARKING - LINE 8" (WHITE DIAGONALS SPACED @ 10' CENTERS) | ⑱ RAISED REFLECTIVE PAVEMENT MARKER (1-WAY YELLOW / OPAQUE) |
| ⑥ THERMOPLASTIC PAVEMENT MARKING - LINE 12" (WHITE DIAGONALS SPACED @ 500' CENTERS) | ⑲ RAISED REFLECTIVE PAVEMENT MARKER (1-WAY CRYSTAL / OPAQUE) |
| ⑦ THERMOPLASTIC PAVEMENT MARKING - LINE 12" (YELLOW DIAGONALS SPACED @ 500' CENTERS) | ⑳ THERMOPLASTIC PAVEMENT MARKING - LINE 12" (WHITE EDGE LINE) |
| ⑧ THERMOPLASTIC PAVEMENT MARKING - LINE 12" (WHITE GORE DIAGONALS SPACED @ 30' CENTERS) | ㉑ THERMOPLASTIC PAVEMENT MARKING - LINE 6" (WHITE THRU LANE LINE) |
| ⑨ THERMOPLASTIC PAVEMENT MARKING - LINE 24" (WHITE) | ㉒ POLYUREA PAVEMENT MARKING TYPE 1, LINE 12" (YELLOW DIAGONALS SPACED @ 500' CENTERS) |
| ⑩ PREFORMED PLASTIC PAVEMENT MARKING, TYPE B, INLAID, LINE 4" (WHITE 2' DASH, 6' SKIP) | ㉓ POLYUREA PAVEMENT MARKING TYPE 1, LINE 12" (WHITE DIAGONALS SPACED @ 500' CENTERS) |
| ⑪ PREFORMED PLASTIC PAVEMENT MARKING, TYPE B, INLAID, LINE 8" (WHITE 3' DASH, 9' SKIP) | ㉔ POLYUREA PAVEMENT MARKING TYPE 1, LETTERS AND SYMBOLS (WHITE) |
| ⑫ PREFORMED PLASTIC PAVEMENT MARKING, TYPE B, INLAID, LINE 5" (WHITE 10' DASH, 30' SKIP) | ㉕ POLYUREA PAVEMENT MARKING TYPE 1, LINE 8" (WHITE 3' DASH, 9' SKIP) |
| ⑬ POLYUREA PAVEMENT MARKING TYPE 1, LINE 4" (WHITE EDGE LINE) | ㉖ POLYUREA PAVEMENT MARKING TYPE 1, LINE 4" (WHITE 2' DASH, 6' SKIP) |

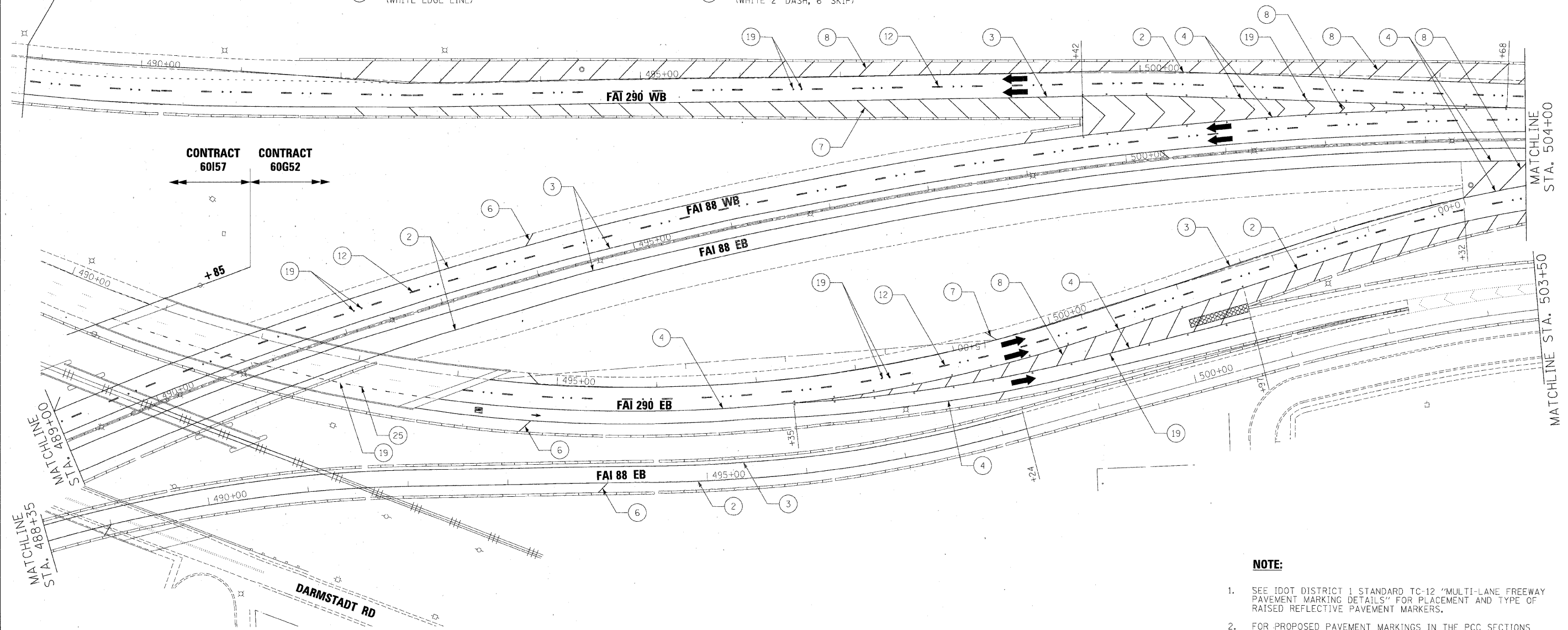

CONTRACT 60157 CONTRACT 60652

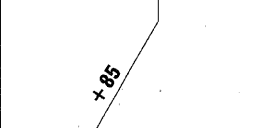

CONTRACT 60157 CONTRACT 60652



NOTE:

- SEE IDOT DISTRICT 1 STANDARD TC-12 "MULTI-LANE FREEWAY PAVEMENT MARKING DETAILS" FOR PLACEMENT AND TYPE OF RAISED REFLECTIVE PAVEMENT MARKERS.
- FOR PROPOSED PAVEMENT MARKINGS IN THE PCC SECTIONS USE POLYUREA PAVEMENT MARKINGS ACCORDING TO STANDARD TC-12.
- REFER TO ROADWAY PLANS FOR LIMITS OF RESURFACING.

FILE NAME =	DESIGNED - AJP	REVISED -
...\\pp\in_abc\c2_292_pvm\mkg_07.dgn	DRAWN - TMB	REVISED -
USER NAME = tblank	CHECKED - JMM	REVISED -
PLOT DATE = 1/25/2010	DATE - 1/25/10	REVISED -



STATE OF ILLINOIS
DEPARTMENT OF TRANSPORTATION

PAVEMENT MARKING PLANS
I-290 MAINLINE POB TO STA 504+00

SCALE: 1"=50' SHEET NO. 1 OF 17 SHEETS STA. TO STA.

F.A.I. RTE.	SECTION	COUNTY	TOTAL SHEETS	SHEET NO.
290	(3435, ETC., 3838)RS-5	COOK	264	127
CONTRACT NO. 60652			ILLINOIS FED. AID PROJECT	