

### SCOPE OF WORK

1. AT IDOT BUILDING E, THE CONTRACTOR SHALL COORDINATE, FURNISH, AND INSTALL ALL REQUIRED EQUIPMENT TO COMPLETE THE EXISTING SONET NODE. THE SONET NODE SHALL BE UPGRADED TO AUTOMATIC PATH SWITCHOVER FROM MICROWAVE (PRIMARY MODE) TO FIBER AND VICE VERSA WHEN ACTIVE PATH EXPERIENCES AN OUTAGE. SEE SPECIAL PROVISION FOR DETAILS.

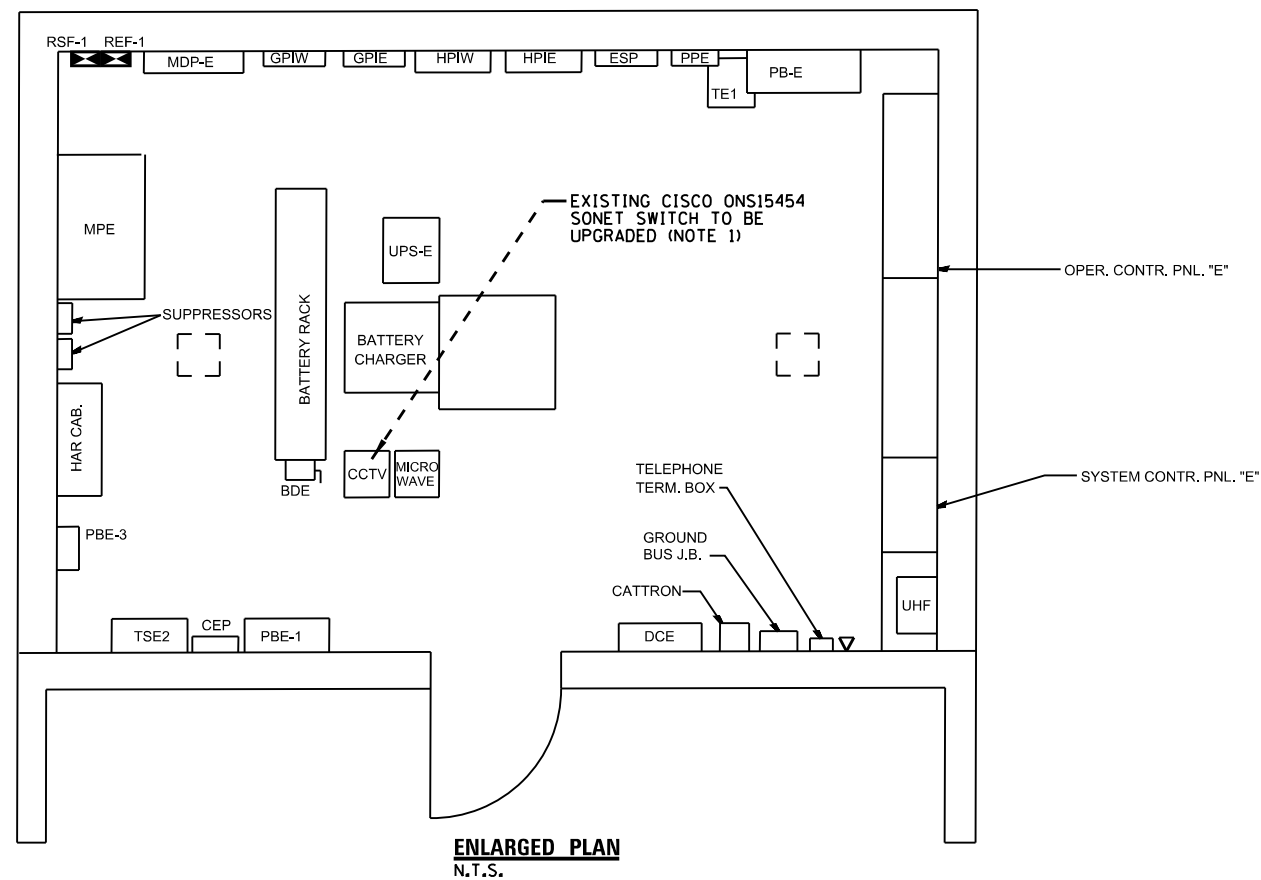
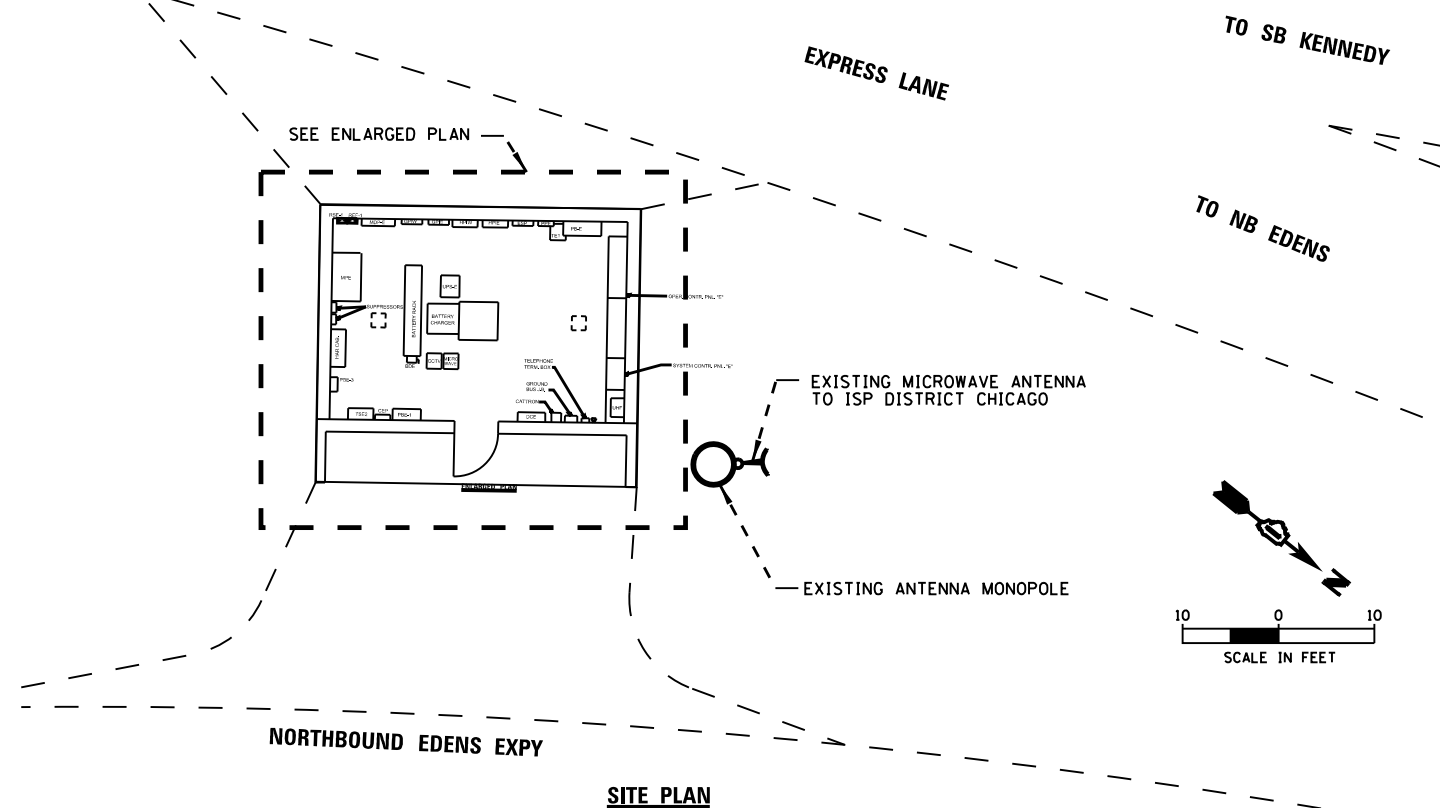

### IDOT BUILDING E (KENNEDY / EDENS)

FOR ADDITIONAL DETAIL, SEE SHEET 7A

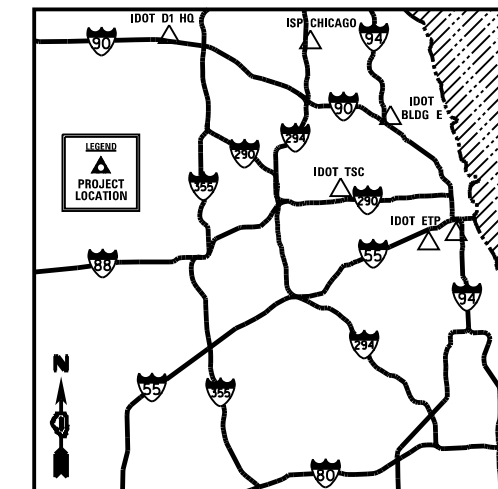

FILE NAME * #FILES	USER NAME * #USERS	DESIGNED <i>R.T.</i>	REVISED -	STATE OF ILLINOIS DEPARTMENT OF TRANSPORTATION	ITS CENTER-TO-CENTER INTEGRATION PROJECT IDOT BUILDING E (KENNEDY / EDENS)		F.A. RTE.	SECTION	COUNTY	TOTAL SHEETS	SHEET NO.
	PLOT SCALE * #SCALE#	DRAWN <i>G.M.</i>	REVISED -		SCALE: AS SHOWN	SHEET NO. ___ OF ___ SHEETS	STA. _____ TO STA. _____	2009-0871	COOK	25	7
	PLOT DATE * #DATE#	CHECKED <i>R.T.</i>	REVISED -		CONTRACT NO. 60134						
		DATE <i>12/11/2013</i>	REVISED -		ILLINOIS FED. AID PROJECT						