

PLAN	SURVEYED	DATE
	PLOTTED	
	NOTE BOOK	
	CHECKED	
	STRUCTURE	
	NOT AT THIS OFFICE	

PROFILE	SURVEYED	DATE
	GRADES CHECKED	
	NOTE BOOK	
	CHECKED	
	STRUCTURE	
	NOT AT THIS OFFICE	

FILE PATH = p:\388035-p\m\1\escom\1\me\Local\PAE\CD\000\Documents\01_Americas\Transportation\60269938_Circle\Phase 1\1\000_CAD\005_Roadway_Sheets\60W29_Sht-Drain-01.dgn

ADJUSTMENT AND REMOVAL LEGEND

- A-ADJO** ATT ADJUST BY OTHERS
- CE-RELO** COMED RELOCATE BY OTHERS
- CE-ADJO** COMED ADJUST BY OTHERS
- P-RELO** PEOPLE'S ENERGY RELOCATE BY OTHERS
- E-R** CITY ELECTRIC REMOVAL
- E-ADJ** CITY ELECTRIC ADJUST
- W-ADJ** CITY WATER ABANDON BY CONTRACTOR (FILLING VALVE VAULTS)
- UIC-ADJ** UNIVERSITY OF ILLINOIS AT CHICAGO ADJUST BY CONTRACTOR
- R** REMOVAL BY CONTRACTOR
- ADJ** ADJUST BY CONTRACTOR

NOTES:

1. SEE SHEET NO. 28 TO 29 FOR DRAINAGE STRUCTURE AND PIPE SCHEDULES.
2. SEE SHEET NO. 77 TO 80 FOR I-290 DRAINAGE AND REMOVALS.
3. SEE STRUCTURAL SHEETS FOR DS-11 SCUPPER DETAILS.
4. COST OF PAVEMENT PATCHING TO BE INCLUDED IN COST OF STRUCTURE ADJUSTMENT OR PROPOSED STRUCTURE. SEE SHEET 86 FOR DIMENSIONS.
5. REMOVAL OF EXISTING SIPHON OUTLET STRUCTURE (TO BE PAID FOR AS REMOVAL OF EXISTING STRUCTURES)
6. FOR EMERGENCY TELEPHONE UNIT RELOCATION DETAILS SEE LIGHTING PLANS.
7. THE 54" COMBINED SEWER SHALL NOT BE REMOVED OR DISCONNECTED UNTIL THE TEMPORARY BYPASS LINES FOR THE SIPHON HAVE BEEN INSTALLED AND FLOW HAS BEEN DIVERTED TO THE TEMPORARY LINES. COORDINATION WITH THE CONSTRUCTION OF THE TEMPORARY SOIL RETENTION SYSTEMS WILL BE REQUIRED.
8. THE TEMPORARY SOIL RETENTION SYSTEM IN THIS AREA CANNOT BE CONSTRUCTED UNTIL THE TEMPORARY BYPASS LINES FOR THE SIPHON HAVE BEEN CONSTRUCTED AND FLOW IS DIVERTED TO THE TEMPORARY LINES.
9. THE CONTRACTOR SHALL CUT AND CAP THE WATER MAIN AT THE LIMITS SHOWN ON THE PLANS. THE WORK REQUIRED TO CAP THE ENDS OF THE EXISTING WATER MAIN SHALL BE INCLUDED IN THE COST OF WATER MAIN REMOVAL, 12", AND SHALL NOT BE PAID FOR SEPARATELY.
10. THE LIMITS FOR REMOVAL AND ABANDONMENT OF EXISTING WATER MAIN PIPES MUST BE DETERMINED AS PART OF STAGING REQUIREMENTS AND CONSTRUCTION LIMITS FOR SEWER AND WATER MAIN CONSTRUCTION.

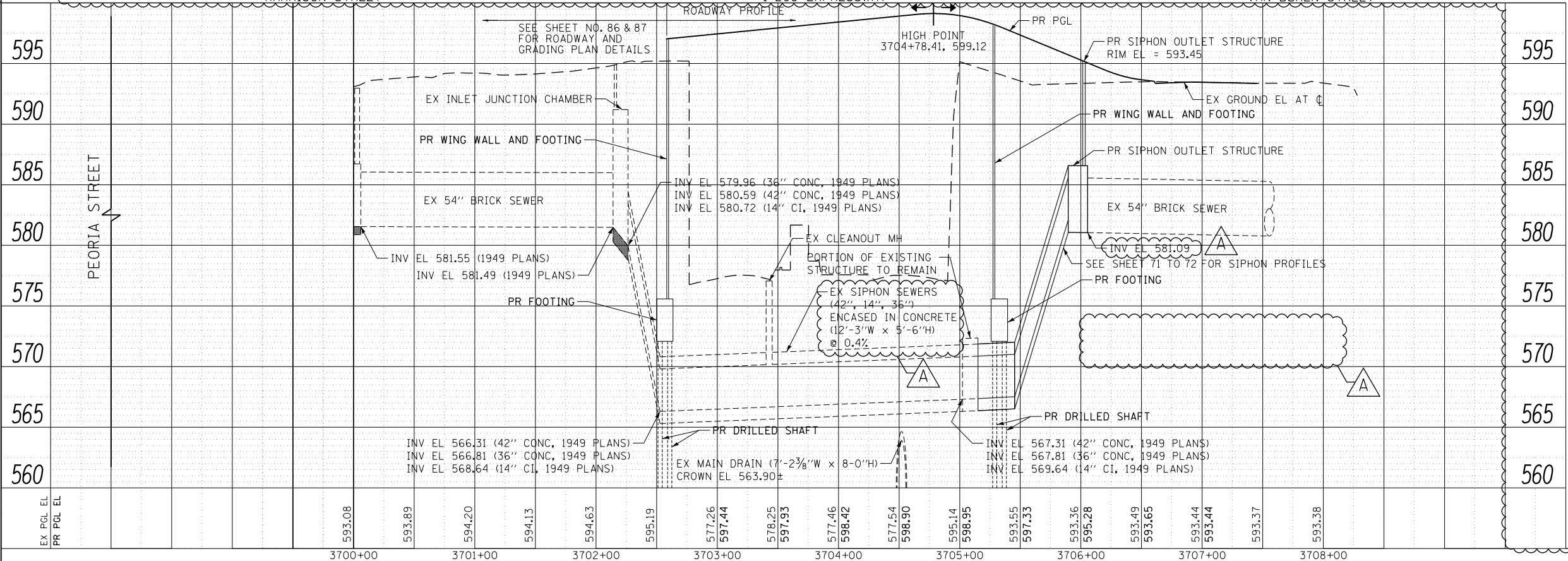
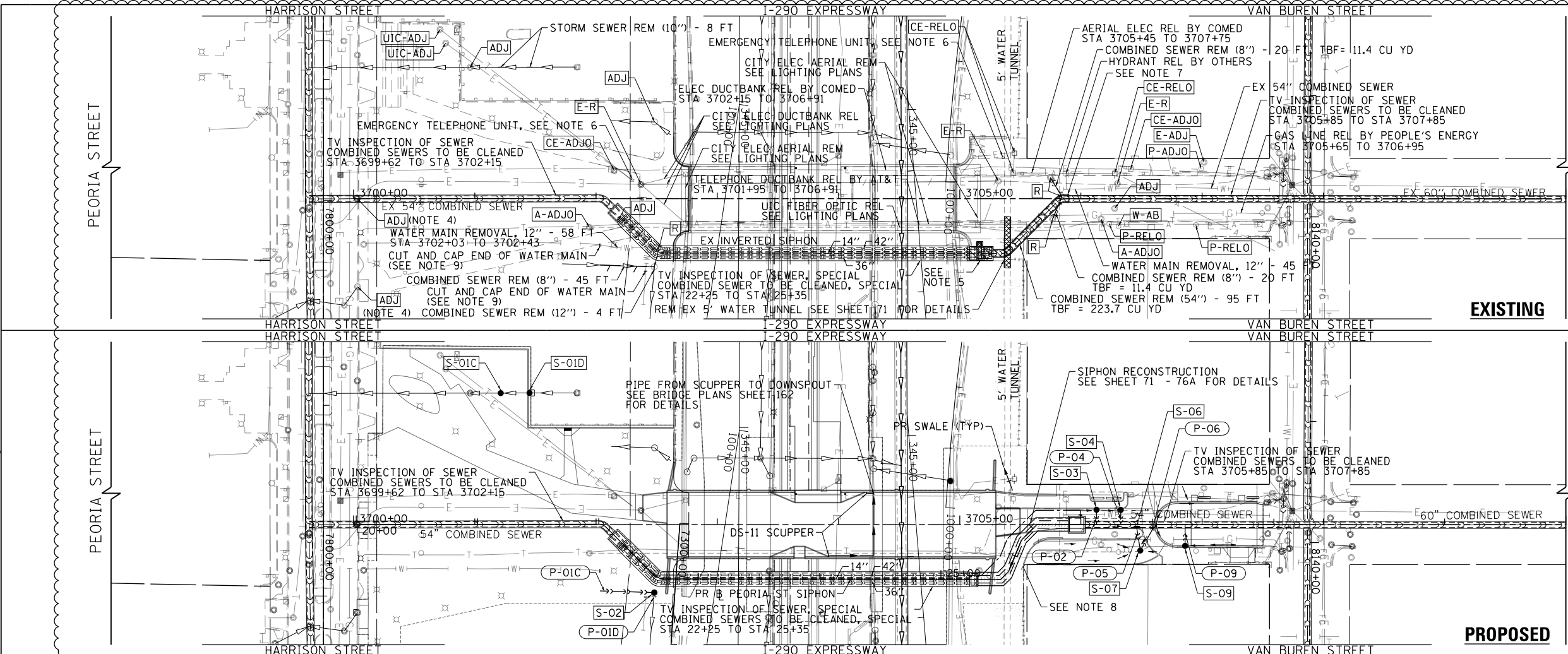
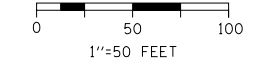

	D160W29-Sht-Drain-01.dgn	DESIGNED - JSL	REVISED - A 12/18/2013	STATE OF ILLINOIS DEPARTMENT OF TRANSPORTATION	DRAINAGE AND UTILITY PLAN AND PROFILE PEORIA STREET	F.A.I. RTE.	SECTION	COUNTY	TOTAL SHEETS	SHEET NO.
	USER NAME = BAWtor1	DRAWN - BAW	REVISED -			90/94/290	2013-011R	COOK	356	70
	PLOT SCALE = 100.0000' / in.	CHECKED - JWC	REVISED -	SCALE: 1"=50'		SHEET 1 OF 11 SHEETS		STA. 3700+00 TO STA. 3710+00	CONTRACT NO. 60W29	
	PLOT DATE = 12/19/2013	DATE - 10/30/2013	REVISED -			ILLINOIS		FED. AID PROJECT		